

**ODORIZATION NOTE:**  
 Project is over 2500 feet in length. Please contact I&R prior to executing the project for supplemental odorization.  
 INR06002 - Supplemental Odorization for New Piping

MATCH LINE W/ SH 07

MATCH LINE W/ SH 05

|             |        |
|-------------|--------|
| PROJECT NO. | 128-23 |
| DRAWING NO. | C-003  |
| SHEET NO.   | 06     |

66-245 VALENTINE ST  
 GAS MAIN REPLACEMENT  
 VALENTINE ST, HOWLAND RD, BOND RD, BIGELOW RD, ELLIS RD  
 & OAK CLIFF RD, NEWTON, MA  
**LAYOUT SHEET**

|             |                      |             |          |
|-------------|----------------------|-------------|----------|
| DATE        | 02/25/23             | DATE        | 02/25/23 |
| DESIGNED BY | MM                   | CHECKED BY  | MM       |
| DRAWN BY    | MM                   | DATE        | 02/25/23 |
| DATE        | 02/25/23             | DATE        | 02/25/23 |
| DESCRIPTION | GAS MAIN REPLACEMENT |             |          |
| NO.         | 0                    | DESCRIPTION | 0        |



BOSTON GAS COMPANY  
 476 N  
**nationalgrid**  
 WALTHAM, MA 02451

IFC

**THE DDS GROUP**  
 45 HAVENWOOD ROAD  
 WEST BOSTON, MA 02186  
 PHONE: (617) 552-7500  
 FAX: (617) 552-7501

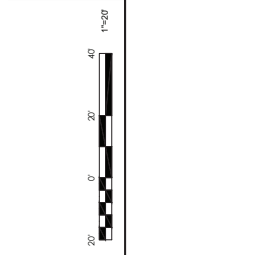

|             |        |
|-------------|--------|
| PROJECT NO. | 128-23 |
| DRAWING NO. | C-003  |
| SHEET NO.   | 06     |



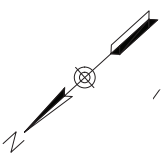

**ODORIZATION NOTE:**  
 Project is over 2500 feet in length. Please contact I&R prior to executing the project for supplemental odORIZATION.  
 INR06.002 - Supplemental OdORIZATION for New Piping

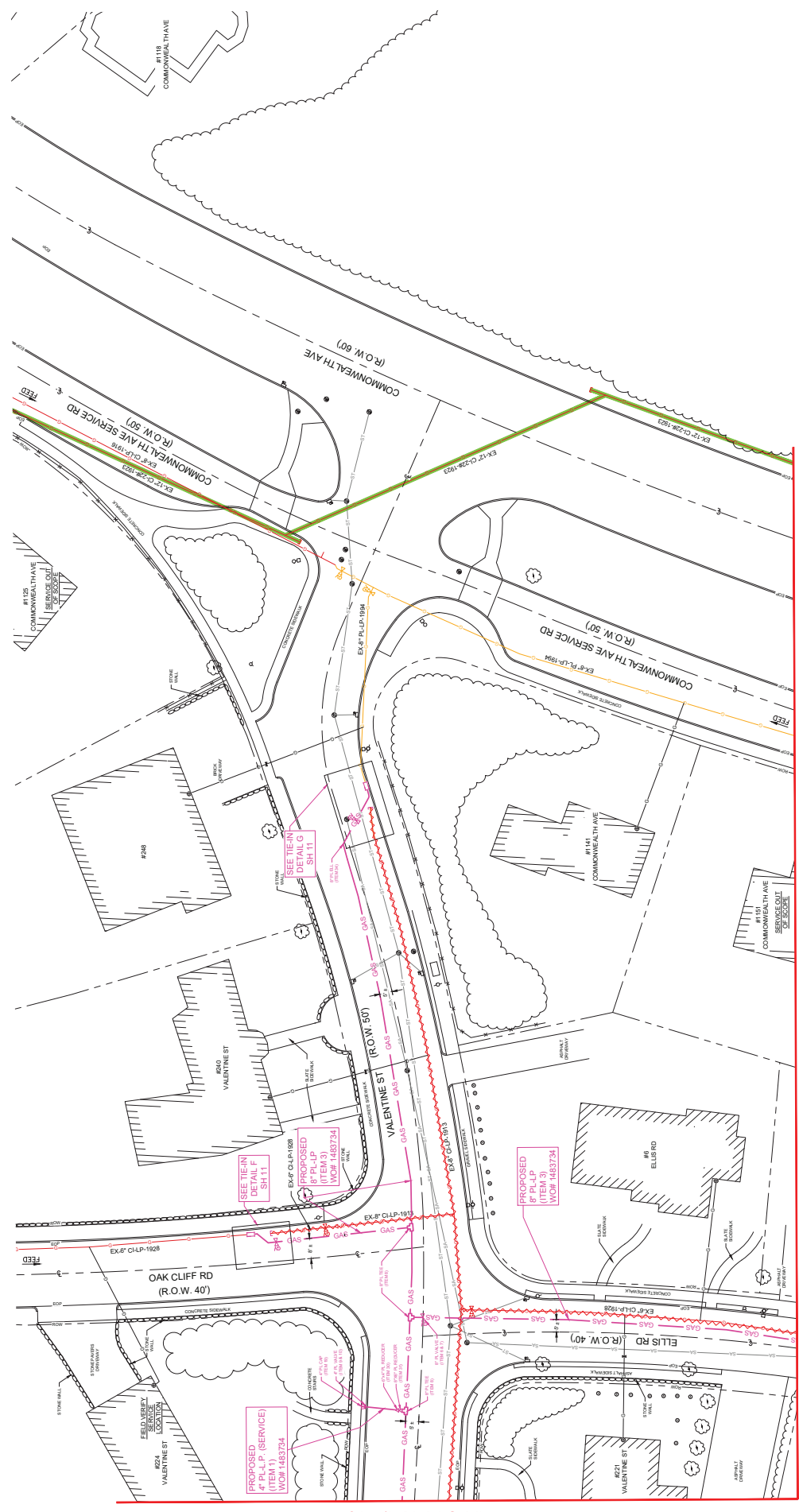

MATCH LINE W/ SH 07

MATCH LINE W/ SH 09



BOSTON GAS COMPANY  
 476 N  
**nationalgrid**  
 100 STATE STREET  
 WALTHAM, MA 02451

IFC



| NO. | DESCRIPTION             | DATE | DESIGNED | CHECKED | DATE | DESIGNED FOR CONSTRUCTION | DATE |
|-----|-------------------------|------|----------|---------|------|---------------------------|------|
| 0   | ISSUED FOR CONSTRUCTION |      |          |         |      |                           |      |

PROJECT: 128-23 VALENTINE ST  
 GAS MAIN REPLACEMENT  
 VALENTINE ST, HOWLAND RD, BOND RD, BIGELOW RD, ELLIS RD  
 & OAK CLIFF RD, NEWTON, MA  
**LAYOUT SHEET**

DESIGNER: DJS/COMPANIES, INC. DATE: 08/11/2023  
 ENGINEER: DAVID J. KELLY, P.E. NO. 10154  
 DIVER SIZE: 27" GAS  
 ASSET ID: 000000000  
 I.D. NO.: 1483734

|                |       |
|----------------|-------|
| PHASE OR OF 15 | 08    |
| DRAWING NO.    | C-005 |
| SHEET NO.      | 08    |

