

101.0 - PROPOSED ELEVATION

ZONING DISTRICT: BU-1

	REQ.	EXIST.	PROP.
FRONT SETBACK:	10'	27.0'	15.2'
SIDE SETBACK:	1/2 HT. (14.28)	36.4'	14.3'
REAR SETBACK	0'	22.5'	5.1'
MAX. LOT COVERAGE:	NA	11.8%	32.6%
MIN. OPEN SPACE:	NA	84.8%	56.2%
IMPERVIOUS AREA:		18.5%	

NOTE: THIS LOT WAS CREATED OCT. 26, 1938.

I HEREBY CERTIFY THAT THE BUILDING IS LOCATED AS SHOWN.

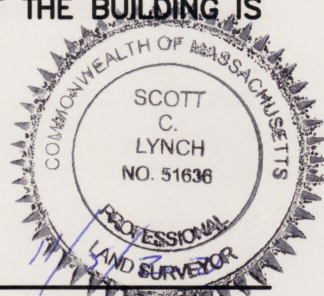

SCOTT LYNCH, PLS

DATE

PREPARED FOR: MICHAEL LOHIN

PROPOSED PLOT PLAN
 #55 COLELLA ROAD
 IN
NEWTON, MA
 (MIDDLESEX COUNTY)

SCALE: 1" = 30' DATE: 11/5/2021

ROBER SURVEY
 1072A MASSACHUSETTS AVENUE
 ARLINGTON, MA 02476
 (781) 648-5533
 6157PP11.DWG