

**CITY OF NEWTON
MASSACHUSETTS**

PETITION for GRANT OF LOCATION

To the Petitioner:

City of Newton Ordinance Section 23-52 requires that each petition for grant of location be submitted to the City Council before it is sent to the Public Works Department for a preliminary review. The comments of the Public Works Commissioner will be part of the record submitted to the City Council. Upon filing with the City Council, the petition will be scheduled for a public hearing before the Public Facilities Committee of the City Council. **The petitioner is responsible for ensuring that the petition is complete, and all required materials are for review.** Attached please find the City Engineer's Standard Requirements for Plans and the Department of Public Works Permit Processing brochure.

Grant of Location Process:

1. Applicant submits completed Petition Form and required materials to the City Council
2. Public Works Department conducts preliminary review and gives written comments to the applicant
3. Engineering Division files Petition Form with comments with the Clerk of the City Council
4. City Council schedules petition for a public hearing before the Public Facilities Committee of the City Council
5. Public Facilities Committee recommendations are forwarded to the City Council for a final decision

Questions may be directed to:

Lou Taverna, City Engineer, 617-796-1020

Cassidy Flynn, Clerk of the Public Facilities Committee 617-796-1213

I. IDENTIFICATION (Please Type or Print Clearly)

Company Name NSTAR ELECTRIC DBA EVERSOURCE ENGERGY
Address 180 Calvary Street Waltham, MA 02453

Phone Number 617-776-7300

Fax Number 781-314-5165

Contact Person Richard M. Schifone

Title Supervisor Rights and Permits

Signature Richard M. Schifone

Date 06/23/2022

If a telecommunications company, indicate how certified by the Department of Telecommunications and Energy:

II. DESCRIPTION OF PROJECT: to be completed by petitioner

A. Write here or attach a description of the project including, location, proposed time frame for completion, type of materials to be used, benefit provided to the City, project mitigation plan as applicable, street reconstruction plan including timetable for completion.

Eversource to install 888± feet of conduit in Farlow Road & Waverley Avenu, Newton W.O.# 7370442.

B. Include or attach a sketch to provide a visual description of the project. If plans are attached, provide: Title of Plan FARLOW ROAD, NEWTON Date of plan 06/20/2022.

III. PUBLIC WORKS DEPARTMENT REVIEW

Date received by Public Works Department July 12, 2022

Check One:
 Minor Project Major Project Lateral

(Refer to City Engineer Standard Requirements for Plans for definition of minor and major project)

Plans Submitted:
 Certified Plot Plan Stamped Plans

DATE AND COMMENTS:	RECOMMENDATIONS:
See attached comments & recommendations.	
	<i>John Daghtian</i>
	<i>Associate City Engineer</i>
	<i>July 15, 2022</i>

V. RECOMMENDATION TO PUBLIC FACILITIES COMMITTEE:

Shawna Sullivan
 Commissioner, Public Works

Digitally signed by Shawna Sullivan
 Date: 2022.07.15 10:47:11 -04'00'

_____ Date

PETITION OF NSTAR ELECTRIC COMPANY dba EVERSOURCE ENERGY FOR LOCATION FOR CONDUITS AND MANHOLES

To the City Council of the City of Newton Massachusetts

Respectfully represents **NSTAR ELECTRIC COMPANY dba EVERSOURCE ENERGY** a company incorporated for the transmission of electricity for lighting, heating or power, that it desires to construct a line for such transmission under the public way or ways hereinafter specified.

WHEREFORE, your petitioner prays that, after due notice and hearing as provided by law, the Council may by Order grant to your petitioner permission to construct, and a location for, such a line of conduits and manholes with the necessary wires and cables therein, said conduits and manholes to be located substantially as shown on the plan made by **T. Thibault** dated **June 20, 2022** and filed herewith, under the following public way or ways of said City.

Waverley Road - Easterly from pole 9/31, at Farlow Road, install approximately 50 feet of conduit, thus continuing.

Farlow Road - Easterly, at Waverley, to pole 149/9, install approximately 790 feet of conduit.

Northwesterly from pole 149/17, at Chamberlain Road, install approximately 48 feet of conduit.

Install one (1) man hole - MH31500

W.O.# 7370442

NSTAR ELECTRIC COMPANY
dba EVERSOURCE ENERGY

By: Richard M. Schifone

Richard M. Schifone
Rights and Permits, Supervisor

Dated this _____, 2022

City of Newton, Massachusetts

Received and filed _____, 2022



432-22

180 Calvary Street
Waltham, Ma 02453

June 23, 2022

City Council
City of Newton
1000 Commonwealth Avenue
Newton, MA 02459

RE: Farlow Road
Newton, MA
W.O.# 7370442

Dear Members of the Council:

The enclosed petition and plan are being presented by the NSTAR ELECTRIC COMPANY dba EVERSOURCE ENERGY for the purpose of obtaining a Grant of Location to install approximately 888± feet of conduit in Farlow Road and Waverley Avenue.

This work is necessary to provide underground service to 132 Farlow Road.

If you have any further questions, contact Joanne Callender at (781) 314-5054. Your prompt attention to this matter would be greatly appreciated.

Very truly yours,

Richard M. Schifone

Richard M. Schifone
Right and Permits, Supervisor

RMS/wls
Attachments

City of Newton Massachusetts, June 23, 2022

In City Council

WHEREAS, **NSTAR ELECTRIC COMPANY dba EVERSOURCE ENERGY** has petitioned for permission to construct a line for the transmission of electricity for lighting, heating, or power under the public way or ways of the City hereinafter specified, and notice has been given and a hearing held on said petition as provided by law.

It is ORDERED that **NSTAR ELECTRIC COMPANY dba EVERSOURCE ENERGY** be and hereby is granted permission to construct, and a location for, such a line of conduits and manholes with the necessary wires and cables therein under the following public way or ways of said City:

Waverley Road - Easterly from pole 9/31, at Farlow Road, install approximately 50 feet of conduit, thus continuing

Farlow Road - Easterly, at Waverley, to pole 149/9, install approximately 790 feet of conduit.

Northwesterly from pole 149/17, at Chamberlain Road, install approximately 48 feet of conduit.

Install one (1) man hole - MH31500

W.O.# 7370442

All construction work under this Order shall be in accordance with the following conditions:

1. Conduits and manholes shall be located as shown on plan made by T. Thibault dated June 20, 2022.
2. Said Company shall comply with the requirements of existing ordinances and such as may hereafter be adopted governing the construction and maintenance of conduits and manholes.
3. All work shall be done to satisfaction of the City Council or such officer or officers as it may appoint to supervise the work.

A True Record. Attest: _____
City Clerk

Approved _____ 2022

Mayor

CERTIFICATE

I hereby certify that the foregoing Order was adopted after due notice and public hearing as prescribed by Section 22 of Chapter 166 of the General Laws (Ter. Ed.) and any additions thereto or amendments thereof, to wit:-after written notice of the time and place of the hearing mailed at least seven days prior to the date of the hearing by the City Clerk to all owners of real estate abutting upon that part of the way or ways upon, along or across which the line is to be constructed under said Order, as determined by the last preceding assessment for taxation and a public hearing held on the ___ day of _____ 2022, at City Council in the said City

City Clerk

CERTIFICATE

I hereby certify that the foregoing are true copies of the Order of the City Council of the City of NEWTON Massachusetts duly adopted on the _____ day of _____, 2022 and recorded with the records of location Orders of said City. Book _____ Page _____ and of the certificate of notice of hearing thereon required by Section 22 of Chapter 166 of the General Laws (Ter. Ed.), and any additions thereto or amendments thereof, as the same appear of record.

Attest: _____
Clerk of City of NEWTON, Massachusetts

N:\SHARED-nmas-4\2\2\0\IMAGE\BASELINE\NEW-FARLOWAB.dwg

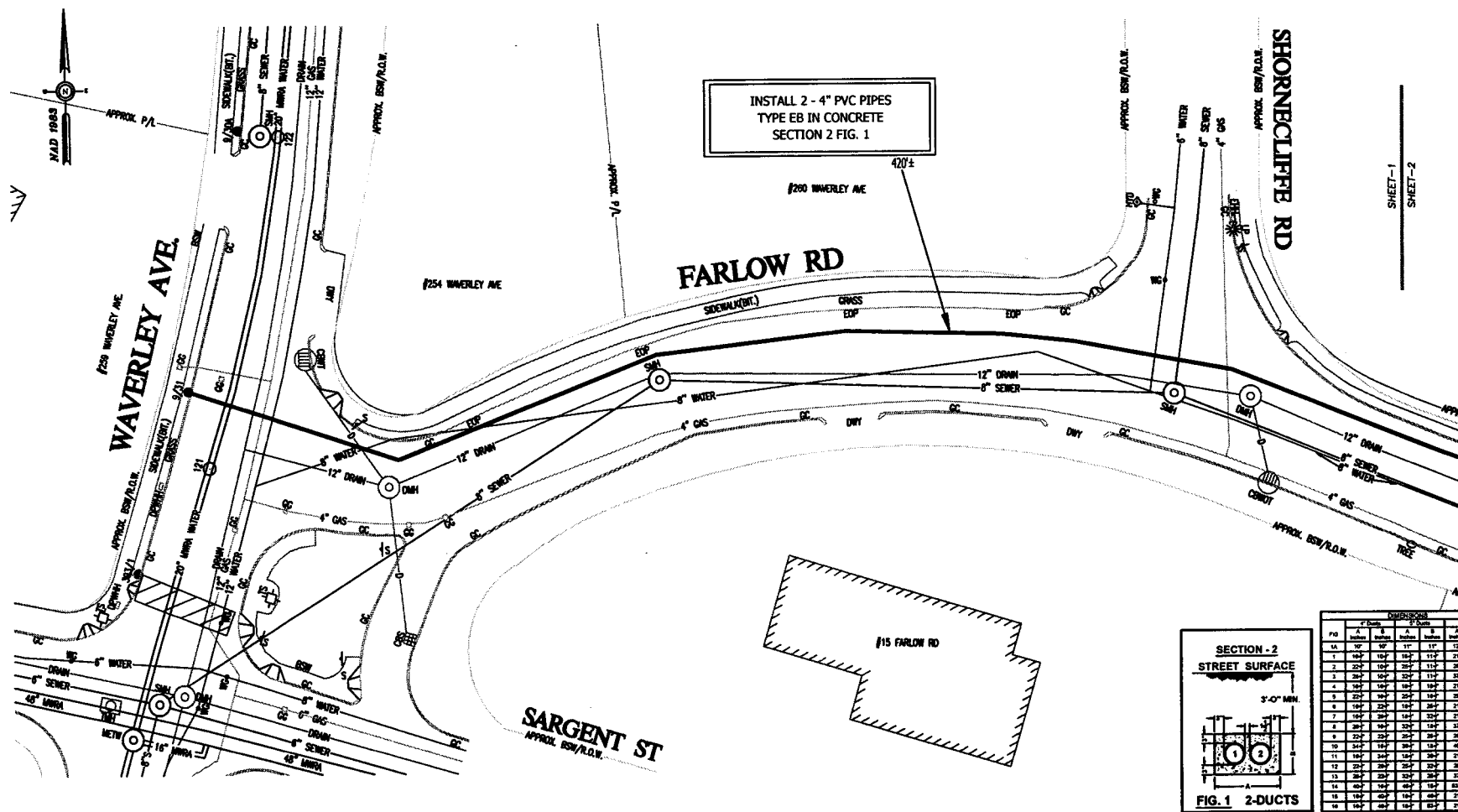

INSTALL 2 - 4" PVC PIPES
TYPE EB IN CONCRETE
SECTION 2 FIG. 1

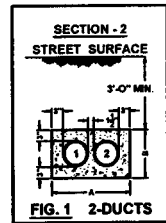

P/O	OVERSIZES			
	1/4"	3/8"	1/2"	3/4"
1	100	100	100	100
2	200	200	200	200
3	300	300	300	300
4	400	400	400	400
5	500	500	500	500
6	600	600	600	600
7	700	700	700	700
8	800	800	800	800
9	900	900	900	900
10	1000	1000	1000	1000
11	1100	1100	1100	1100
12	1200	1200	1200	1200
13	1300	1300	1300	1300
14	1400	1400	1400	1400
15	1500	1500	1500	1500
16	1600	1600	1600	1600
17	1700	1700	1700	1700
18	1800	1800	1800	1800

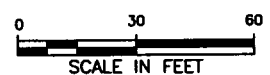

BY YOUR USE OF THE INFORMATION CONTAINED IN THIS MAP YOU AGREE THAT NO WARRANTY OF ANY KIND, EXPRESS OR IMPLIED, IS MADE WITH RESPECT TO THE INFORMATION. NEITHER SOURCE ELECTRIC COMPANY, NOR ITS CONTRACTORS OR FIELD OFFICIALS, OFFICIALS, ENGINEERS, SURVEYORS, EMPLOYEES OR AGENTS, SHALL BE LIABLE FOR ANY LOSS OR DAMAGE CAUSED IN WHOLE OR IN PART BY USE OF THIS INFORMATION OR IN RELIANCE UPON IT IN THE EXERCISE OF ANY PROFESSIONAL SERVICE. YOU AGREE TO HOLD THE INFORMATION CONTAINED HEREIN IN STRICT CONFIDENCE AND TO RELEASE, DISSEMINATE AND HOLD THE INFORMATION FROM ANY SUCH LOSS OR DAMAGE.

THE INFORMATION MAY NOT REPRESENT A SERVICE, MAY NOT BE THE MOST COMPLETE AND IS SUBJECT TO CHANGE WITHOUT NOTICE, AND LIABILITY IS LIMITED FOR THE ACCURACY OF THE INFORMATION. SOURCE ELECTRIC OR ITS FIELD REPRESENTATIVES ATTEMPT TO VERIFY THE INFORMATION BY USE OF THE INFORMATION FOR OTHER THAN ITS INTENDED PURPOSES ARE PROHIBITED.

MASS LAW
REQUIRES 72 HOURS ADVANCE NOTICE TO UTILITY COMPANIES BEFORE DIGGING BY ANYONE. CALL DIG-SAFE 1-888-344-7233

CP	165-22	NEVERSOURCE 1180 WASHINGTON ST., BOSTON, MASS. 02118
Ward #		
Work Order #	737042	Plan of FARLOW ROAD, NEWTON
Surveyed by:	GR/SJ	Showing PROPOSED CONDUIT LOCATION
Research by:	JC	
Plotted by:	GR	
Proposed Structure:	GR	
Approved:	T THIBAUT	Scale 1"=30'
DATE		Date JUNE 20, 2022
PS		SHEET 1 of 3

SHEET-1
SHEET-2

N:\SHARED-rmas-4\2\IMAGE\BASELINE\NEW\FARLOWAB.dwg

SHEET-1
SHEET-2

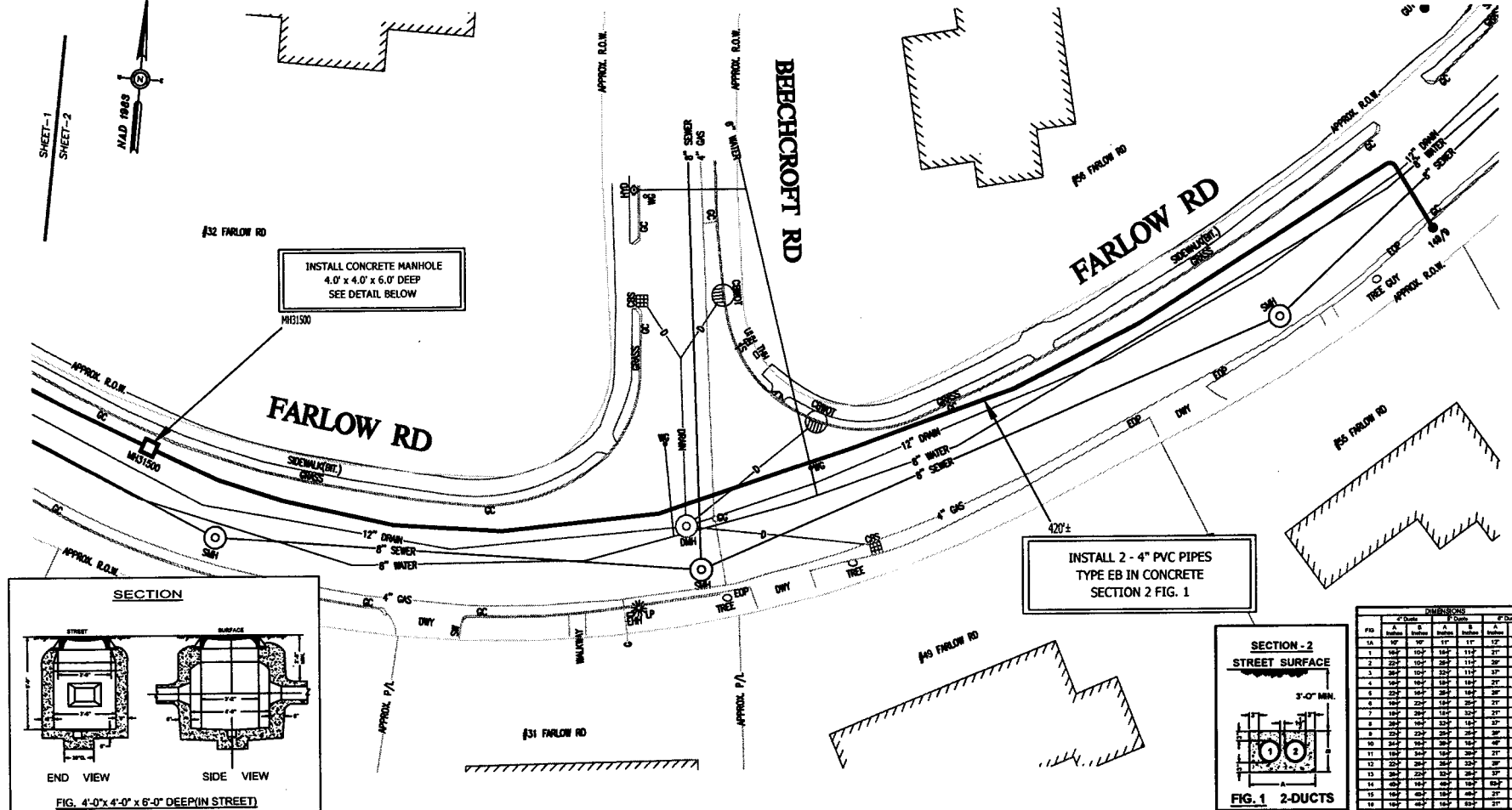
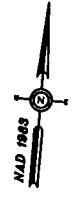

INSTALL CONCRETE MANHOLE
4.0' x 4.0' x 6.0' DEEP
SEE DETAIL BELOW

INSTALL 2 - 4" PVC PIPES
TYPE EB IN CONCRETE
SECTION 2 FIG. 1

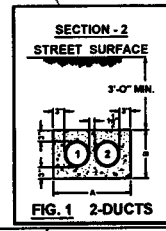
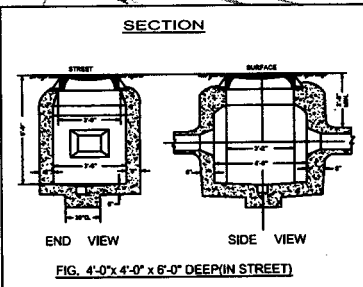

P.O.	DIMENSIONS			
	A	B	C	D
1A	10'	10'	11'	12'
1	10'	10'	11'	12'
2	10'	10'	11'	12'
3	10'	10'	11'	12'
4	10'	10'	11'	12'
5	10'	10'	11'	12'
6	10'	10'	11'	12'
7	10'	10'	11'	12'
8	10'	10'	11'	12'
9	10'	10'	11'	12'
10	10'	10'	11'	12'
11	10'	10'	11'	12'
12	10'	10'	11'	12'
13	10'	10'	11'	12'
14	10'	10'	11'	12'
15	10'	10'	11'	12'
16	10'	10'	11'	12'

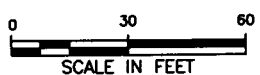

BY THIS USE OF THE INFORMATION CONTAINED IN THIS MAP, YOU AGREE THAT NO WARRANTY OF ANY KIND, EXPRESS OR IMPLIED, IS MADE WITH RESPECT TO THE INFORMATION. THE USER SHALL BE RESPONSIBLE FOR THE ACCURACY OF THE INFORMATION. THE USER SHALL BE RESPONSIBLE FOR THE ACCURACY OF THE INFORMATION. THE USER SHALL BE RESPONSIBLE FOR THE ACCURACY OF THE INFORMATION.

MASS LAW
REQUIRES 72 HOURS ADVANCE NOTICE TO UTILITY COMPANIES BEFORE DIGGING BY ANYONE. CALL DIG-SAFE 1-888-344-7233

Co	165-22
Ward #	
Work Order #	737042
Surveyed by:	GR/SJ
Research by:	JC
Plotted by:	GR
Proposed Structures:	GR
Approved:	T THEBAULT
P#	

EVERSOURCE
1180 WASHINGTON AVE, BOSTON, MASS 02108

Plan of FARLOW ROAD, NEUTON

Showing PROPOSED CONDUIT LOCATION

Scale 1"=30'

Date JUNE 20, 2022

SHEET 2 of 3

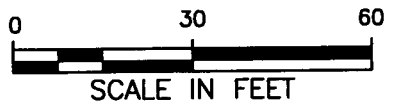
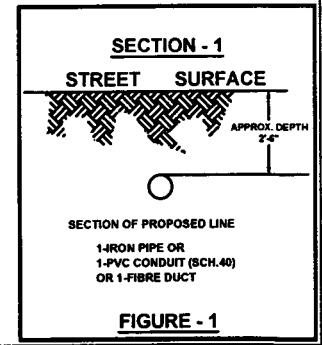
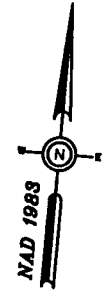
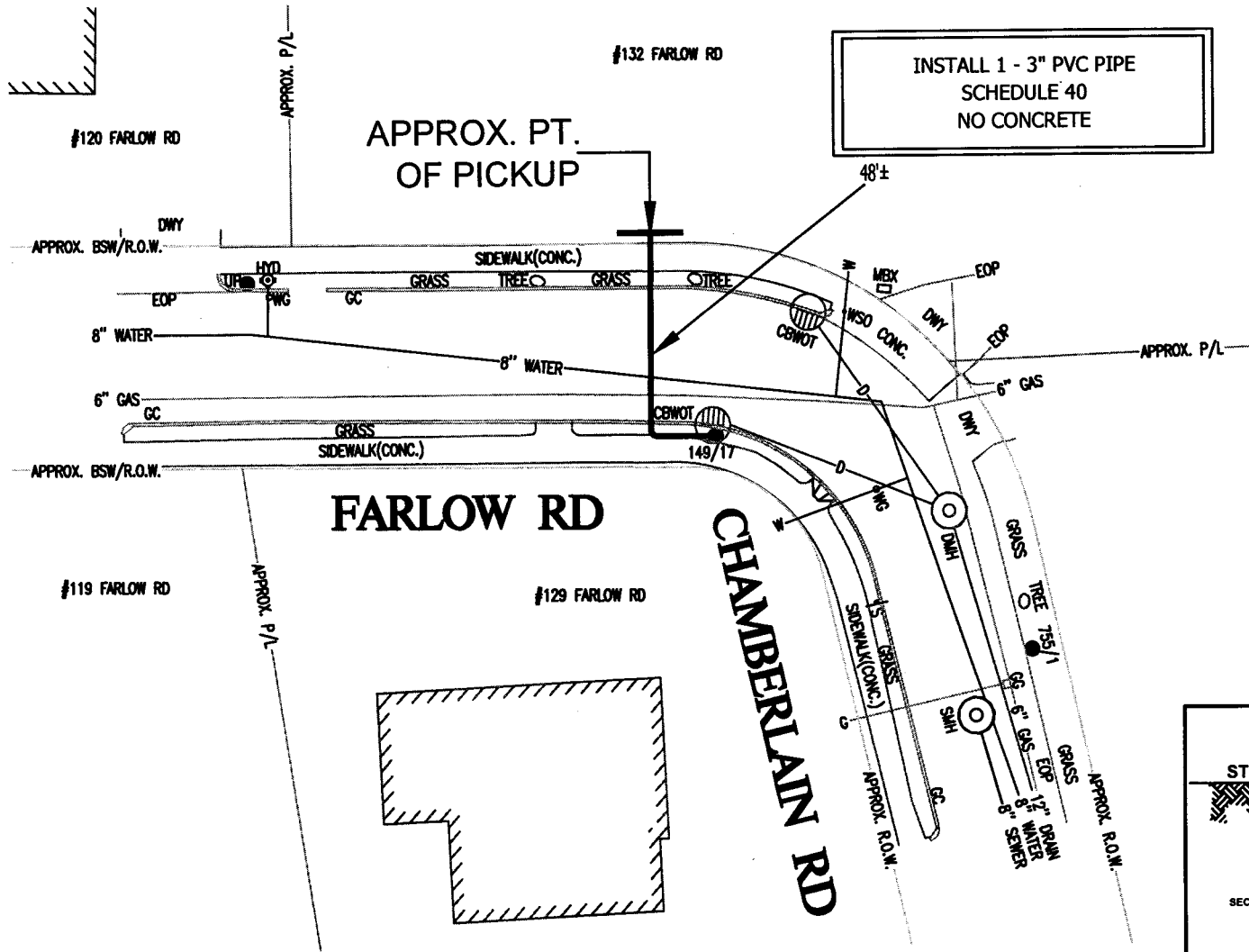

BY YOUR USE OF THE INFORMATION CONTAINED IN THIS MAP, YOU AGREE THAT NO WARRANTY OF ANY KIND, EXPRESS OR IMPLIED, IS GIVEN WITH RESPECT TO THE INFORMATION. NEITHER NSTAR ELECTRIC COMPANY, NSTAR GAS COMPANY NOR ITS PARENTS, AFFILIATES, OFFICERS, DIRECTORS, SHAREHOLDERS, EMPLOYEES OR AGENTS (COLLECTIVELY THE "NSTAR ENTITIES") SHALL BE LIABLE FOR ANY LOSS OR INJURY CAUSED IN WHOLE OR IN PART BY USE OF THIS INFORMATION OR IN RELIANCE UPON IT, TO THE MAXIMUM EXTENT ALLOWED BY LAW. YOU AGREE BY YOUR ACCEPTANCE OF THE INFORMATION TO RELEASE, INDEMNIFY AND HOLD THE NSTAR ENTITIES HARMLESS FROM ANY SUCH LOSS OR INJURY.

THE INFORMATION MAY NOT REPRESENT A SURVEY, MAY NOT BE THE MOST COMPLETE AND IS SUBJECT TO CHANGE WITHOUT NOTICE. NO LIABILITY IS ASSUMED FOR THE ACCURACY OF THE INFORMATION, EITHER EXPRESSED OR IMPLIED. UNAUTHORIZED ATTEMPTS TO MODIFY THE INFORMATION OR USE THE INFORMATION FOR OTHER THAN ITS INTENDED PURPOSES ARE PROHIBITED.

MASS. LAW

REQUIRES 72 HOURS ADVANCE NOTICE TO UTILITY COMPANIES BEFORE DIGGING BY ANYONE. CALL DIG-SAFE 1-888-344-7233

C#	165-22	
Ward #		
Work Order #	7370442	1185 MASSACHUSETTS AVE. DORCHESTER, MASS. 02125
Surveyed by:	GR/SJ	Plan of FARLOW ROAD, NEWTON
Research by:	JC	
Plotted by:	GR	Showing PROPOSED CONDUIT LOCATION
Proposed Structures:	GR	
Approved:	T THIBAUT	Scale 1"=30' Date JUNE 20, 2022
P#		SHEET 3 of 3

CITY OF NEWTON
Department of Public Works
ENGINEERING DIVISION

Memorandum

To: Councilor Alison Leary, Facilities Committee Chair.
From: John Daghlian, Associate City Engineer
Re: Grant of Location Farlow Road
Date: July 15, 2022
CC: Jim Mcgonagle, Commissioner
Shawna Sullivan, Chief of Staff
Lou Taverna, PE City Engineer
Cassidy Flynn, Associate City Clerk
Marc Welch, Superintendent of Urban Forestry

In reference to the above location, the following are my comments for a plan entitled:

Proposed Conduit Location Farlow Road
Prepared by: Eversource
Dated: June 20, 2022

Executive Summary:

Sheets 1 & 2 of the plan set indicate installation of underground conduit start at pole 9/31 at the intersection of Waverley Avenue & Farlow Road and extending eastly approximately 888-feet and terminating at pole 149/9 near #55 Farlow Road. The portion of Farlow Road from Beechcroft Road to the end is in very good condition and restoration should be full width curb line to curb line from the transition joint in the pavement to pole 149/9, see photo. All catch basins within the construction zone shall have silt socks installed and maintained for the duration, the contractor of record shall ensure no flooding of the streets nor private property occur during heavy rainstorms.

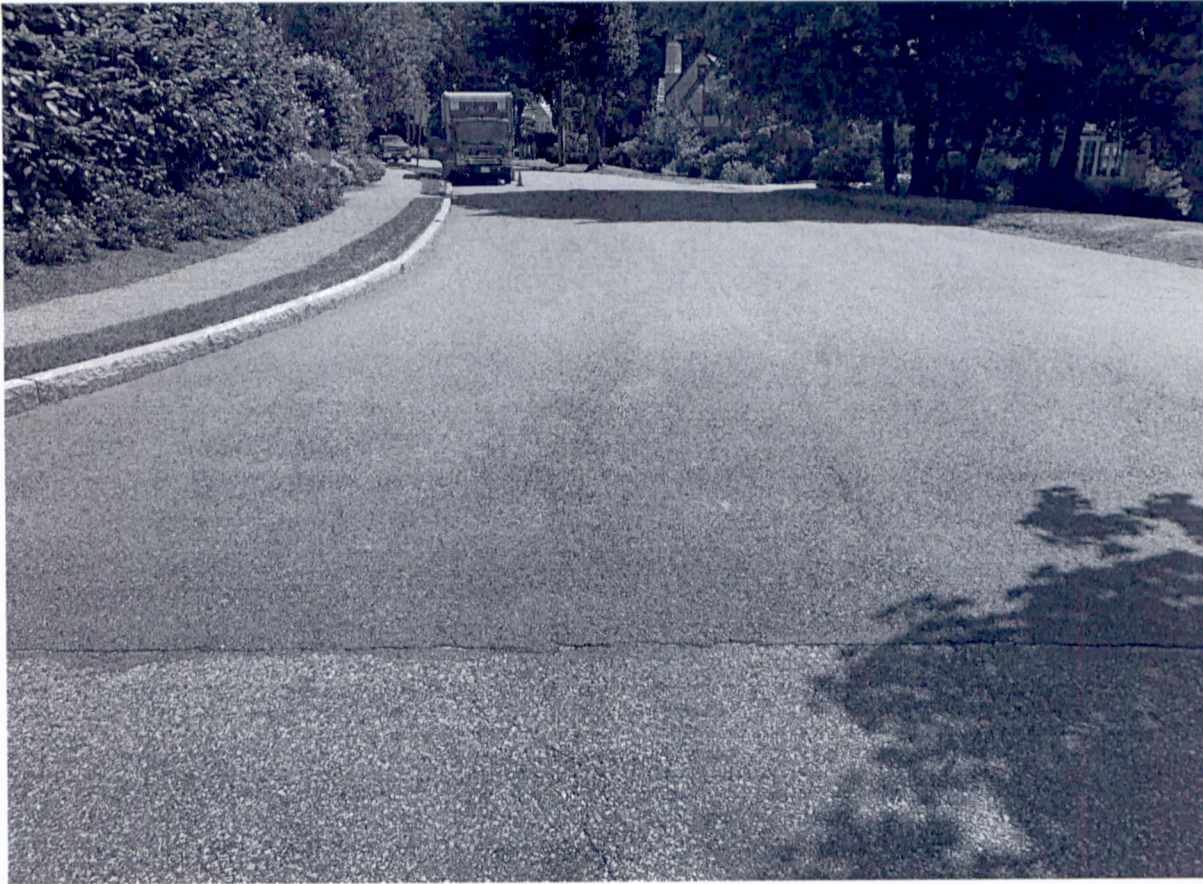

Look east towards pole 149/9 from Beechcroft Road

During the site visit a guy wire was discovered from pole #149/9 wrapped around the base of a 30" red maple.



Pole 149/9 with guy wire anchored to a 30" red maple.

Placing a guy wire around a tree is prohibited. Eversource will have to request an amendment to the GOL incorporate an anchor placed within the right of way, so the guy wire is removed from the tree that is being girdled.

Pedestrian access will have to be accommodated in accordance with the DPW Pedestrian Access Checklist, any detours shall first be reviewed and approved by the Construction Inspector.

Sheet 3 of 3 is an underground lateral from pole #149/17 to across the street to #132 Farlow Road, see photo.

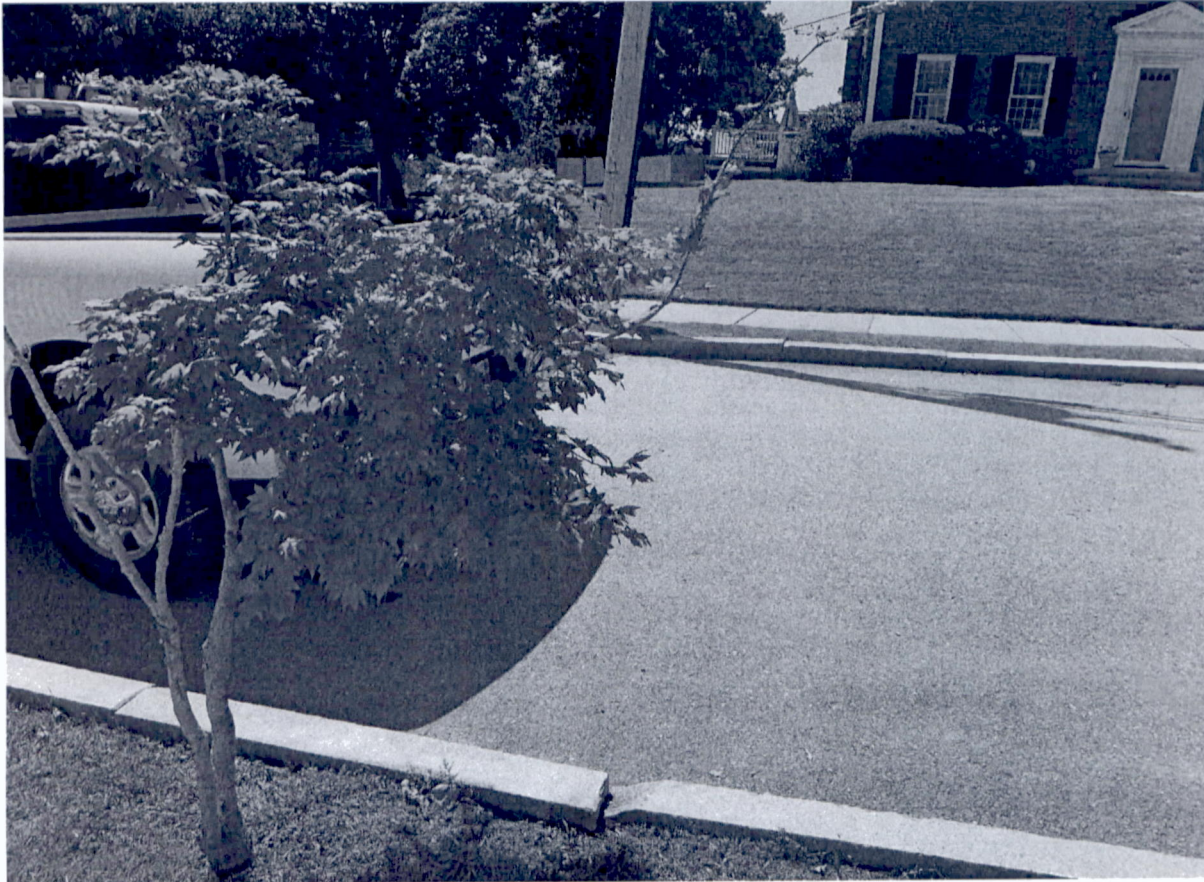

The same pavement restoration shall be required to mill curb to curb 25 feet on either side of the trench.

The contractor of record shall obtain Street Opening, Sidewalk crossing and Trench Permits with the DPW with appropriate Bonding & Insurance and Dig Safe clearance.

Upon completion an as built plan shall be submitted to the DPW in PDF format.

Conditions & Special Provisions:

1. Finalized utility connection plan reflecting the above changes that meets the minimal design standards of the City of Newton must be submitted for approval by the contractor of record with appropriate Bonds & Insurance. The Engineering Division makes no representations and assumes no responsibility for the design(s) in terms of suitability for the particular site conditions or of the functionality or performance of any items

constructed in accordance with the design(s). The City of Newton assumes no liabilities for design assumption, error or omissions by the Engineer of Record.

2. All trenches within the roadway shall be milled 1-1/2" deep and overlaid with Type I-1 HMA curb line to curb line and 25' beyond the limits of the trench in both directions. The limits will be determined in the field by the City Engineer.
3. If any service connections are disturbed by the contractor of record during construction, they shall be updated and replaced to the City's current Construction Standards.
4. All downstream catch basins shall be retrofitted with an approved type of siltation control devices, details of this shall be submitted to the City Engineer. The contractor of record shall maintain these catch basins throughout the construction process and ensure that street and property flooding does not occur during construction.
5. The contractor of record shall obtain appropriate Permits with the Inspectional Services Department for all electrical, telecommunications construction.
6. The contractor of record shall contact the Newton Police Department 48 hours in advanced and arrange for Police detail to help residents & commuters navigate around the construction activity.

If you have any questions or concerns, please call me at 617-796-1023.