

**PLANTING SCHEMATIC FOR
ENHANCEMENT PLANTING AREA
109 HARWICH ROAD, NEWTON**

PREPARED BY ECOTEC, INC.
SEPTEMBER 9, 2023

Enhancement Planting Area (1,491± S.F.)

| Stratum; Species; Size; Spacing | |
|---|----|
| Saplings; as noted; 12' on-center | 10 |
| E Balsam Fir (<i>Abies balsamea</i>) or Atlantic White Cedar (<i>Chamaecyparis thyoides</i>) | 2 |
| N Northern Red Oak (<i>Quercus rubra</i>) | 3 |
| M Red Maple (<i>Acer rubrum</i>) | 3 |
| H Shag-bark Hickory (<i>Carya ovata</i>) or Pin Oak (<i>Quercus palustris</i>) | 2 |
| Shrubs; 3-4' height; 7' on-center | 30 |
| c Chokecherry (<i>Prunus virginiana</i>) | 5 |
| s Serviceberry (<i>Amelanchier canadensis</i>) | 5 |
| v American Witch-hazel (<i>Hamamelis virginiana</i>) | 5 |
| d Gray Dogwood (<i>Cornus racemosa</i>) | 5 |
| h Highbush Blueberry (<i>Vaccinium corymbosum</i>) | 5 |
| p Sweet Pepper-bush (<i>Clethra alnifolia</i>) | 5 |
| Small Shrubs; 18-24" height; four clusters of four on slope | 16 |
| a Pink Azalea (<i>Rhododendron periclymenoides</i>) | 4 |
| m Maple-leaf Viburnum (<i>Viburnum acerifolium</i>) | 4 |
| b Northern Bush Honeysuckle (<i>Diervilla lonicera</i>) | 4 |
| i Inkberry (<i>Ilex glabra</i>) or Sheep Laurel (<i>Kalmia angustifolia</i>) | 4 |

- The wire fence and stakes at the northern edge of the planting area will be removed.
- The Norway maple and common buckthorn saplings/shrubs and oriental bitter-sweet vines/ground cover in the area will be cut and blotted with glyphosate or triclopyr. Such invasives species treatment will continue through the two-year monitoring period and will be detailed in the annual monitoring reports.
- The dead 18" deciduous tree will be cut to 10' height for safety purposes.
- Plant substitutions are subject to approval by Conservation Staff.
- Plants must be natives; cultivars and varieties will not be accepted.
- All excess soil must be removed and disposed of off-site.
- After plantings, the existing leaf litter will be used to mulch the plantings.
- The plants must be watered in well and watered periodically until they are established.

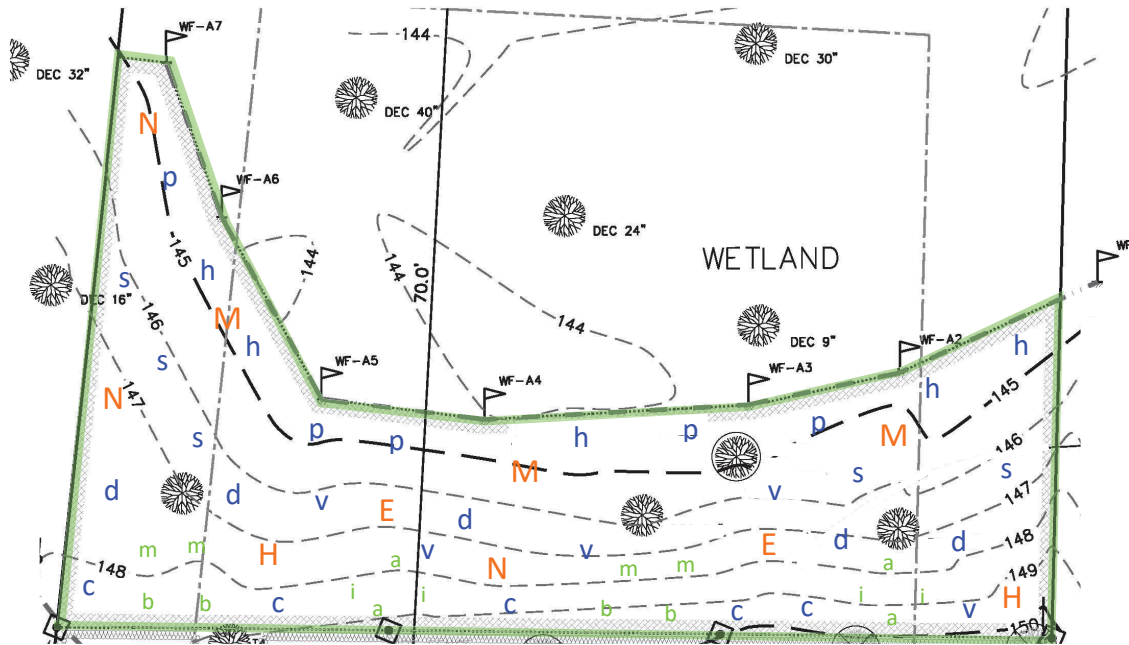

Note: The locations of the individual saplings and shrubs are shown for permitting and review purposes; the locations of the plantings in the field will be based on this plan subject to the discretion of the overseeing wetland scientist.