

Location & Parcel Maps in Support of Proposal to the CPC for Acquisition & Demolition at 30 Wabasso Street

30 Wabasso St.	Assessors Parcel ID: 41031 0053
Auburndale, MA 02466	Lot Size: 5,184 sq ft (0.12 acres)
	Funds Requested: \$405,100

Current ownership of properties along Wabasso St.

30 WABASSO ST	Thomas Donald Wightman Tr
68 WABASSO ST	CITY OF NEWTON
71 WABASSO ST	CITY OF NEWTON
WABASSO ST OFF	CITY OF NEWTON
WABASSO ST REAR	CITY OF NEWTON

- ◆ acquisition of 3 private lots along Wabasso St. identified as top priority in the City of Newton's 2003-2007 *Recreation and Open Space Plan* (p. 94, "Action Program")
- ◆ since 1998, City has acquired and demolished houses on 2 of these lots (#68 and #71 Wabasso St.)-this is 3rd and last lot mentioned in *Plan*
- ◆ fronts directly on Purgatory Cove in the Charles River
- ◆ connects with path from Auburndale Park (Commonwealth Ave.) to Waltham

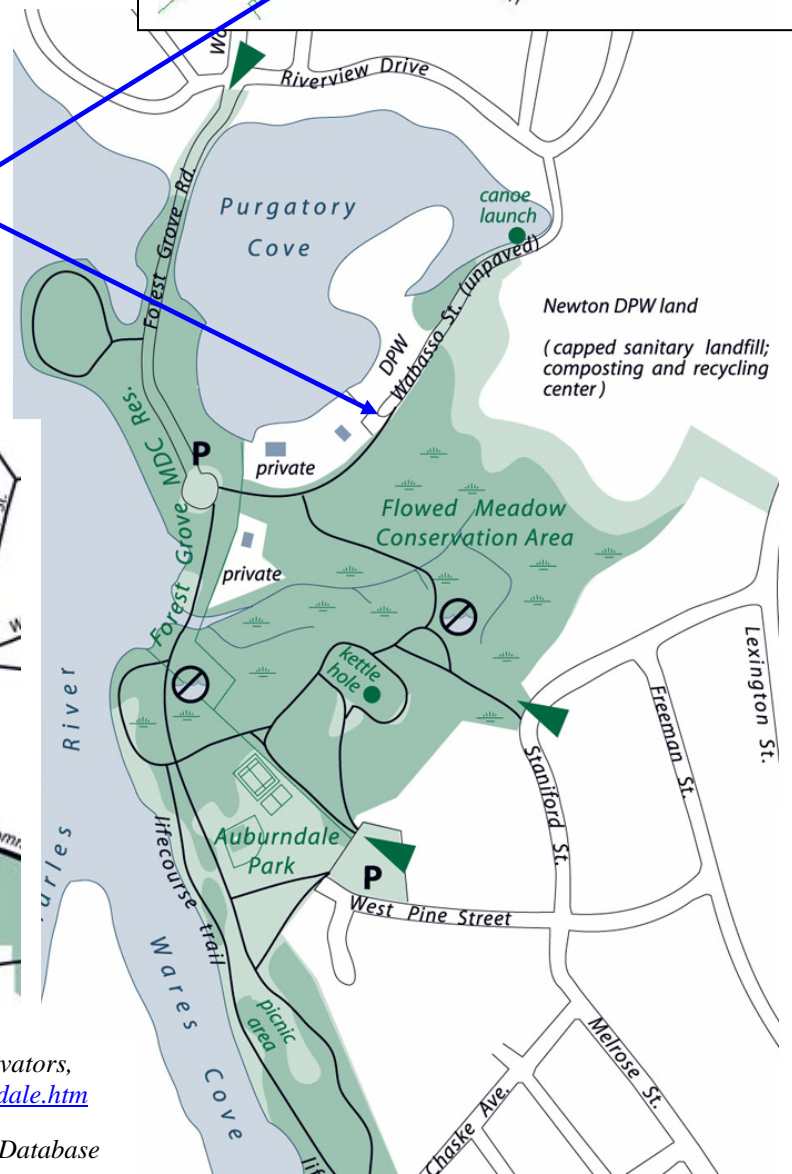
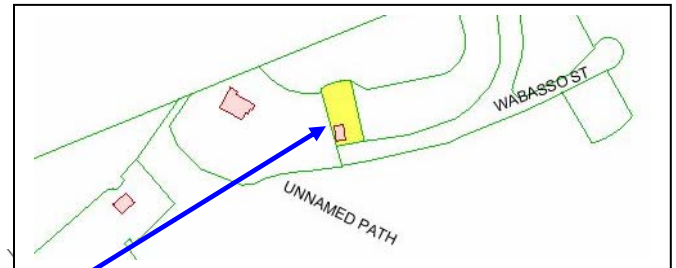

Location & trail maps from Newton Conservators, www.newtonconservators.org/map2auburndale.htm

Parcel map from City of Newton Assessors Database