



NEWTON LIFE

Resurrecting a playground

Neglected West Newton park gets much-needed face lift

By Matthew Call
TAB STAFF WRITER

The gradual deterioration of Wellington Park, tucked into a residential area between Cherry and Waltham streets in West Newton, is easily

"It's like a step back in time. don't see this kind of thing anymore."

Jane Quinn

evident in the cracks in the basketball and tennis courts and the neglected playground equipment.

In response, an ad hoc group of neighbors has raised more than \$16,500 to save

it. "It was a park that kind of went to sleep," said Jane Quinn, who has spent her entire life living in and around the small pocket park. "It died for a while, but it's coming back to life again."

The group formed a little more than a year ago to fix up the old playground, left to the city by Somerville resident T. F. Wellington in 1937, according to Quinn.

With a grant of \$12,500 from the city and their own fund-raising efforts, the group bought a new swing set and a new structure that residents installed themselves over the weekend.

The group met for months picking out a seller — GameTime of Alabama — and selecting colors for the new structures.

"It's been a really interactive process and people know each other better now," said Ted Kuklinski, who lives on Henshaw Terrace. "It was a very democratic process. The neighborhood was participatory in this."

Volunteers spent the weekend building a play structure and a swing set. Concrete will be poured to stabilize them and soft wood chips will be laid down later this week.

"It's like a step back in time. You don't see this kind of thing anymore," Quinn said, watching her neighbors lug planks of wood across the field. "I've seen it come from nothing."

The park was the center of activity for the neighborhood in the 1950s, Quinn said, with informal day camps and summer festivals. Lately, though, few have bothered to use it; the tennis court lacks a net and the basketball court is uneven and split.

An item has been docketed for the Board of Aldermen to spend \$60,000 on the two courts, according to Alderman Richard Bullwinkle, who joined the residents on Saturday. The group has already succeeded in putting up a shiny new,

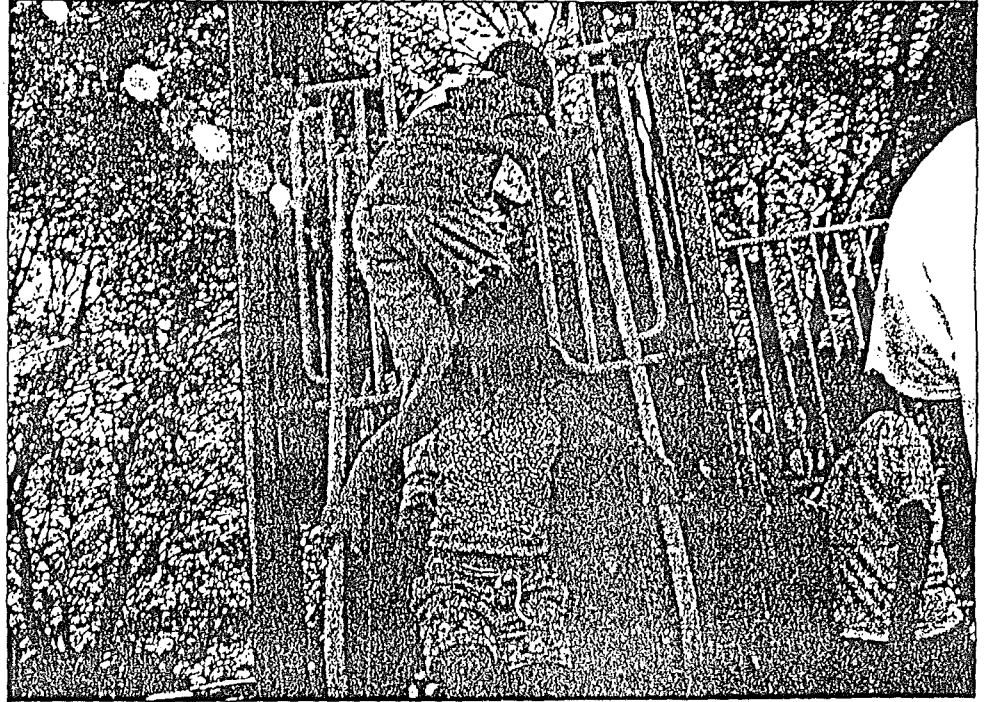

STAFF PHOTO BY JAMIE LACROIX

Above, Alexa Rlobueno and other children played on the new playground equipment after it was put up at Wellington Park last weekend.



Volunteers and a few hired professional builders put the finishing touches on a new structure at Wellington Park.



Left, Peter Budhish and Bruce Nelson worked with a crowd of volunteers to put up a roof at the newly revitalized playground.

plastic structure.

"We're still fund-raising, we're not done yet," said Lorraine Miller, who lives

on Waltham Street.

The Parks and Recreation Department has promised a couple of trees for the inside of the field, according to Quinn.

"I think it's interesting that someone from another town [donated] this," Quinn said, adding that the field is in a key area — no one from the surrounding roads has to cross a major street to get to it. "It was the kindest, sweetest gesture."

The community park has served as a focal point to galvanize neighbors, Kuklinski said. Through their fund-raising and building events, the group has started a newsletter and a Web site, <http://www.wellingtonpark.org>.

"We're sort of a high-tech neighborhood organization," Kuklinski said. "We try to keep everyone informed about what's going on."

After a grand opening on Sunday, Oct. 15, the group will move into further making the park what it once was, a central point for the neighborhood. Kuklinski is lobbying for a detachable tennis net, so hockey games can still be played on it, and is thinking of installing a baggie system so people can clean up after their dogs.

"We're hoping it can be a place where everyone can us it peacefully," he said.

Citizens for Wellington Park
24 Henshaw Terrace
West Newton, MA 02465
www.wellingtonpark.org
info@wellingtonpark.org
617-969-6222

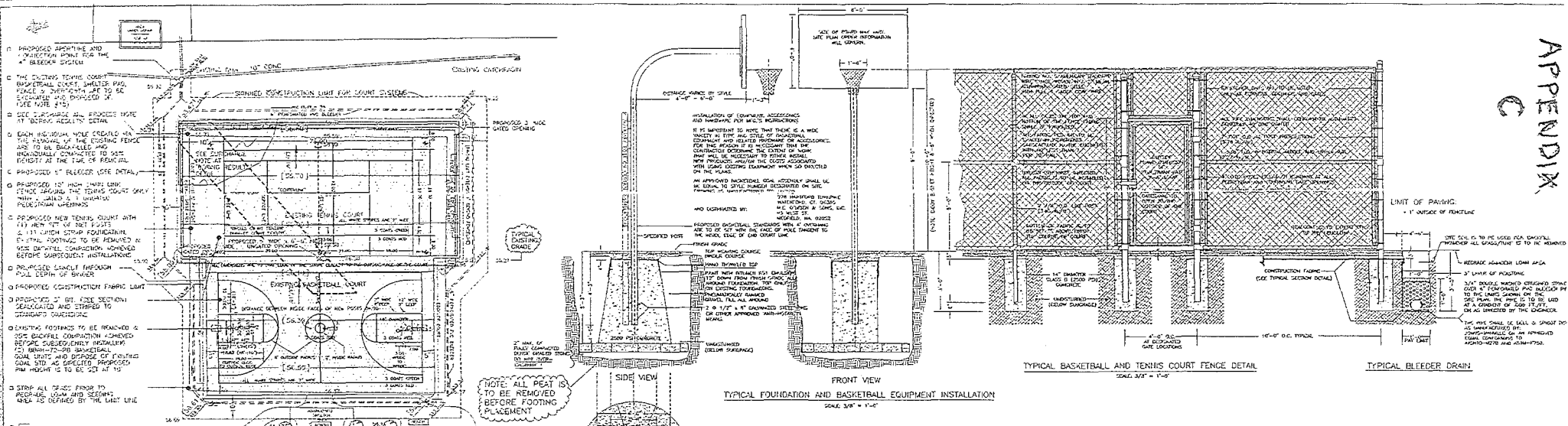

- 1. PROPOSED LIGHTING AND CONNECTION POINTS FOR THE BLEACHER SYSTEM.
- 2. THE EXISTING TENSIS COURT SURFACE SHALL BE REMOVED AND REPLACED WITH NEW ASPHALT TO BE 2" THICK AND FINISHED WITH A FINISH AS SHOWN ON SHEET 10-1.
- 3. SEE "PROPOSED" ALL PROPOSED WORK SHALL BE COMPLETED BY THE CONTRACTOR.
- 4. EACH REVISION MADE CREATES A NEW SET OF DRAWINGS. THE CONTRACTOR SHALL BE RESPONSIBLE FOR THE REMOVAL OF THE EXISTING FENCE AND THE INSTALLATION OF THE NEW FENCE. THE CONTRACTOR SHALL BE RESPONSIBLE FOR THE REMOVAL OF THE EXISTING FENCE AND THE INSTALLATION OF THE NEW FENCE.
- 5. PROPOSED 12" HIGH WOODEN BLEACHER SYSTEM SHALL BE INSTALLED AS SHOWN ON SHEET 10-1.
- 6. PROPOSED NEW TENSIS COURT WITH 1 1/2" NEW 1/2" OF SET EDGE.
- 7. 1 1/2" NEW STRIP FOUNDATION SHALL BE INSTALLED TO BE REMOVED TO REVEAL EXISTING FOUNDATION. EXISTING FOUNDATION SHALL BE REPAIRED AND REFINISHED TO BE EQUAL TO THE NEW FOUNDATION.
- 8. PROPOSED LANDSCAPE INFILTRATION POOL DEPTH OF 18" TO 24" SHALL BE INSTALLED AS SHOWN ON SHEET 10-1.
- 9. PROPOSED CONSTRUCTION FENCE SHALL BE INSTALLED AS SHOWN ON SHEET 10-1.
- 10. PROPOSED 12" BIT WALK SHALL BE INSTALLED AS SHOWN ON SHEET 10-1.
- 11. EXISTING PROPOSED TO BE REMOVED & REPLACED WITH NEW ASPHALT TO BE 2" THICK AND FINISHED WITH A FINISH AS SHOWN ON SHEET 10-1.
- 12. STRIP ALL EXISTING FENCE TO REVEAL FOUNDATION AND REPAIR AS SHOWN ON SHEET 10-1.

- 13. PROPOSED WALKS, BENCHES & RAMP BY OTHERS (NOTE NOT IN CONTRACT).
- 14. FINISHED 12" DEPTH - 1" RISE BIT WALK.
- 15. 12" DEPTH WALKWAY SHALL BE INSTALLED AS SHOWN ON SHEET 10-1.
- 16. PROPOSED WALKWAY SHALL BE INSTALLED AS SHOWN ON SHEET 10-1.
- 17. (CONSTRUCTION ACCESS TO BE PROVIDED BY THE CONTRACTOR'S EXPENSE.)

- CONSTRUCTION NOTES:**
1. THE CONTRACTOR IS REQUIRED TO ATTEND A PRE-CONSTRUCTION CONFERENCE AT WHICH TIME A CONSTRUCTION MANAGEMENT PLAN AND TIMELINE MUST BE FURNISHED TO THE CITY.
 2. THE CONTRACTOR IS RESPONSIBLE FOR THE IDENTIFICATION OF ALL EXISTING CONDITIONS.
 3. THE CONTRACTOR IS TO SET HIS OWN CONSTRUCTION MARKS, LINES AND GRADES TO COMPLETE THE PROJECT.
 4. THE CONTRACTOR SHALL CONTACT THE CITY OF NEWTON GENERAL CONSTRUCTION DETAILS AT 781-552-3433 AND SHALL NOT OCCUPY ANY AREAS UNTIL THE AUTHORIZATION DATE HAS BEEN OBTAINED.
 5. FOR FURTHER UTILITY SUPPORT AND EXISTING UTILITY REQUESTS, THE CONTRACTOR IS ADVISED TO CONTACT: NEWSPH @ GAS, N-STAR @ ELECTRIC, VERIZON @ TELEPHONE, AT&T @ CABLE, RCN @ CABLE, NEWTON WATER, NEWTON SEWER & DRAIN.
 6. ANY UTILITY RELATIONS, ANY/OR UTILITY ISSUES, ARE TO BE DIRECTLY ADDRESSED AND COORDINATED BY THE CONTRACTOR WITH THE RESPECTIVE UTILITY COMPANY.
 7. ALL EXCESS EXCAVATION MATERIAL AND/OR ASBESTOS ITEMS OF ANY TYPE OR MATERIAL, ARE TO BE DISPOSED OF AT A LEGAL DUMPING SITE AT THE CONTRACTOR'S OWN EXPENSE. NO DISPOSAL SITE SHALL BE PROVIDED BY THE CITY.
 8. ALL DEBRIS IS TO BE REMOVED FROM THE SITE ON A DAILY BASIS. HOWEVER, IF SITE CONDITIONS ARE NOT AN ISSUE THEN THE CONTRACTOR MAY MAINTAIN A LIMITED LOT QUANTITY AT THE DISCRETION OF THE ENGINEER AND BY PERMIT ONLY.
 9. AREAS AND/OR STRUCTURES BEYOND THE LIMITS OF THE CONTRACT DISTURBED AND/OR DAMAGED BY THE CONTRACTOR, ARE TO BE REPAIRED AND/OR REPLACED BY THE CONTRACTOR AT HIS OWN EXPENSE AND AS APPROVED BY THE ENGINEER.
 10. THE CONTRACTOR IS EXCLUSIVELY RESPONSIBLE FOR ALL SAFETY ASPECTS OF THIS PROJECT.
 11. HOURS OF OPERATIONS ARE SET BY LAW. NO MACHINES OR EQUIPMENT ARE TO BE ACTIVATED BEFORE 7:00 A.M. & NO WORK IS TO EXTEND BEYOND 4:30 P.M. NO WORKING ON HOLIDAY IS ALLOWED WITHOUT SPECIAL PERMISSION.
 12. FOR FURTHER DETAILS NOT SHOWN ON THESE PLANS SEE "CITY OF NEWTON GENERAL CONSTRUCTION DETAILS". A COPY OF WHICH CAN BE OBTAINED AT THE OFFICE OF THE CITY ENGINEER.
 13. ALL EXISTING UNDERGROUND UTILITIES, DRAINAGE, BACKFLOW OR OTHER COURSE MATERIAL IS TO BE COMPACTED TO THE ORIGINAL. THIS WORK, UNLESS OTHERWISE NOTED, IS TO BE PERFORMED AT THE CONTRACTOR'S OWN EXPENSE.
 14. THE FINAL DETERMINATION OF THE PROJECT LAYOUT, AND/OR STAKING/SUPPORTING AREAS, SHALL BE ESTABLISHED IN THE FIELD BY THE ENGINEER AND/OR SUBJECT TO HIS APPROVAL.
 15. ALL BACKFILL IS TO BE COMPACTED WITH VIBRATING ROLLERS/COMPACTORS EQUIPPED WITH AN ELECTRIC PUMP COMPACTING FOOT. (INCLUDES ALL ABANDONED HOLES/POST HOLES, ETC) ALL COMPACTATION OF DENSE GRADED MATERIAL, GRAVEL BACKFILL OR OTHER COURSE MATERIAL IS TO BE COMPACTED TO 95% DENSITY.
 16. ALL COMPACTATION BY DENSE GRADED MATERIAL, GRAVEL BACKFILL OR OTHER COURSE MATERIAL IS TO BE COMPACTED TO 95% DENSITY.
 17. ALL TRENCHING AND SOFTENS EXCAVATIONS ARE TO BE CARRIED OUT ONLY WITH A 1' WIDE TRENCHING BUCKET IN ORDER TO MAINTAIN SETTLEMENT PROBLEMS AND COMPACTATION PROCEDURES.
 18. ALL ITEMS SPECIFIED AS FURNISHING TO THE CITY OR "AS SHOWN" ARE TO BE OBTAINED AT THE CONTRACTOR'S OWN EXPENSE AND STOCKPILING ITEMS AT LOCATIONS DESIGNATED BY THE ENGINEER.
 19. ALL ITEMS SPECIFIED AS FURNISHING TO THE CITY OR "AS SHOWN" ARE TO BE OBTAINED AT THE CONTRACTOR'S OWN EXPENSE AND STOCKPILING ITEMS AT LOCATIONS DESIGNATED BY THE ENGINEER.
 20. THE CITY RESERVES THE RIGHT TO EXISTING FENCE APPURTENANCES. HOWEVER, THE CONTRACTOR IS RESPONSIBLE FOR THE REMOVAL OF ALL FENCE POSTS AND FOOTINGS/TIMBER. THE CONTRACTOR WILL BE RESPONSIBLE FOR DISPOSING OF ALL UNREMOVED FENCE APPURTENANCES, ALL FOOTINGS, AND THE SUBSEQUENT FILLING IN AND COMPACTING OF ALL WALKS WHICH ARE SAVED TO BE ABANDONED.
 21. WHEN EXISTING EQUIPMENT IS TO BE REMOVED ALL CONCRETE IS TO BE THOROUGHLY REMOVED PRIOR TO THE RESULTING OF SUPPORT POSTS.
 22. ANY PORTION OF EXISTING EQUIPMENT WHICH IS TO BE REMOVED IS TO BE ADJUSTED IN A MANNER ACCEPTABLE TO THE ENGINEER.
 23. ALL ADJUSTMENTS ARE TO BE MADE AND APPROVED PRIOR TO THE INSTALLATION OF THE SUBSEQUENT TOP COURSE.
 24. NO EXPOSURES AND/OR TENSIS NETS ARE TO BE INSTALLED UNTIL 14 DAYS HAVE ELAPSED SINCE THE LAST APPLICATION OF SEALCOAT.

THE CONTRACTOR IS TO STRIP THE ENTIRE EXISTING COURT SURFACE AREA AND IS TO FILL THE SURCHARGE CONCRETE IN THE DESIGNATED ZONE FOR THE PURPOSE OF SURCHARGING THE AREA. THE CONTRACTOR IS TO EXPOSED OFF THE AREA FOR TWO WEEKS BY INSTALLING A TEMPORARY FENCE TO RESTRICT ACCESS. IMMEDIATELY UPON THE EXPIRATION OF THE TWO WEEK SURCHARGE PERIOD THE CONTRACTOR IS TO REMOVE THE SURCHARGE MATERIAL AND IS TO COMPLY WITH THE DRAINAGE OF THE RECONSTRUCTION ACTIVITIES. THIS WORK IS NOT TO BE PERFORMED IN FRIGID WEATHER CONDITIONS.

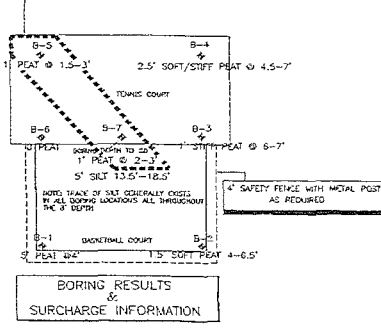

CITY OF NEWTON
CONTRACT PLAN
FOR THE
RECONSTRUCTION OF THE
**WELLINGTON PLAYGROUND
BASKETBALL & TENNIS COURT SYSTEM**
(KILBURN ROAD WEST NEWTON)
SCALE AS NOTED
JUNE 13, 2003
DAVID WILLET, P.E.
CITY ENGINEER

BASKETBALL COURT, SHELTER PAD, FENCE & OVERGROWTH ARE TO BE EXCAVATED AND DISPOSED OF. (SEE NOTE #15)

SEE SURCHARGE AND PROCESS NOTE AT 'BORING RESULTS' DETAIL

EACH INDIVIDUAL HOLE CREATED VIA THE REMOVAL OF THE EXISTING FENCE ARE TO BE BACKFILLED AND INDIVIDUALLY COMPACTED TO 95% DENSITY AT THE TIME OF REMOVAL.

PROPOSED 6" BLEEDER (SEE DETAIL)

PROPOSED 10' HIGH CHAIN LINK FENCE AROUND THE TENNIS COURT ONLY WITH 2 GATED & 1 UNGATED PEDESTRIAN OPENINGS

PROPOSED NEW TENNIS COURT WITH (1) NEW SET OF NET POSTS & (1) CINCH STRAP FOUNDATION. EXISTING FOOTINGS TO BE REMOVED & 95% BACKFILL COMPACTION ACHIEVED BEFORE SUBSEQUENT INSTALLATIONS

PROPOSED SAWCUT THROUGH FULL DEPTH OF BINDER

PROPOSED CONSTRUCTION FABRIC LIMIT

PROPOSED 3" BIT. (SEE SECTION) SEALCOATED AND STRIPED TO STANDARD DIMENSIONS

EXISTING FOOTINGS TO BE REMOVED & 95% BACKFILL COMPACTION ACHIEVED BEFORE SUBSEQUENTLY INSTALLING (2) BBAH-72-RB BASKETBALL GOAL UNITS AND DISPOSE OF EXISTING GOAL STD. AS DIRECTED. PROPOSED FINISH HEIGHT IS TO BE SET AT 10'.

STRIP ALL GRASS PRIOR TO REGRADE, LOAM AND SEEDING AREA AS DEFINED BY THE LIMIT LINE

PROPOSED WALKS, BENCHES & RAMP BY OTHERS
(NOTE: NOT IN CONTRACT)

PROPOSED 3" DEPTH x 5' WIDE BIT. WALK

7.5% SLOPED ACCESS PATH (FIELD FIT REQUIRED)

PROPOSED HANDICAP RAMP INSTALLATION (GRANITE CURB, 4" CONC., BIT. PATCH)

(CONSTRUCTION ACCESS MUST BE RESTORED AT THE CONTRACTOR'S EXPENSE. LOAM AND SEED WILL BE REQUIRED. SOME SKINNING OF EXISTING GRASS AREA

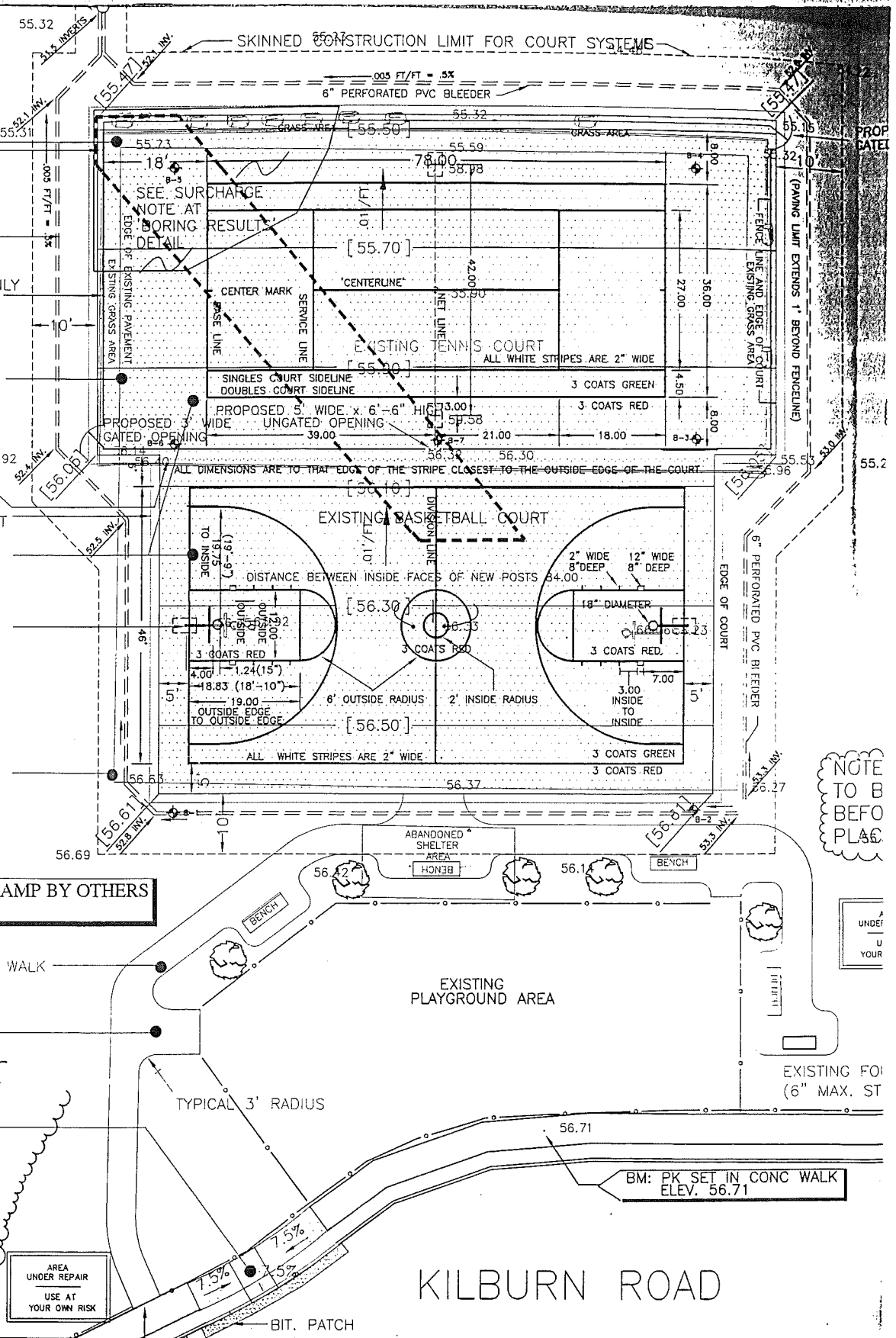

AREA UNDER REPAIR
USE AT YOUR OWN RISK

NOTE TO B BEFO PLAC

UNDER YOUR

BM: PK SET IN CONC WALK
ELEV. 56.71

KILBURN ROAD



- Legend:
- A - Courts
 - B - Accessible Path
 - C - Path to So. Kilburn Entrance
 - D - Path to Princess Road
 - E - Accessible Water Fountain
 - F - Garden Hose / Backflow Valve
 - G - Play Equipment (Ladder Climb)
 - H - Benches
 - I - Tree (Sugar Maple)
 - J - Bulletin Board
 - K - Signage
 - L - Miscellaneous

Wellington Park
 Kilburn Road
 West Newton, MA

Plan
 (New Features)

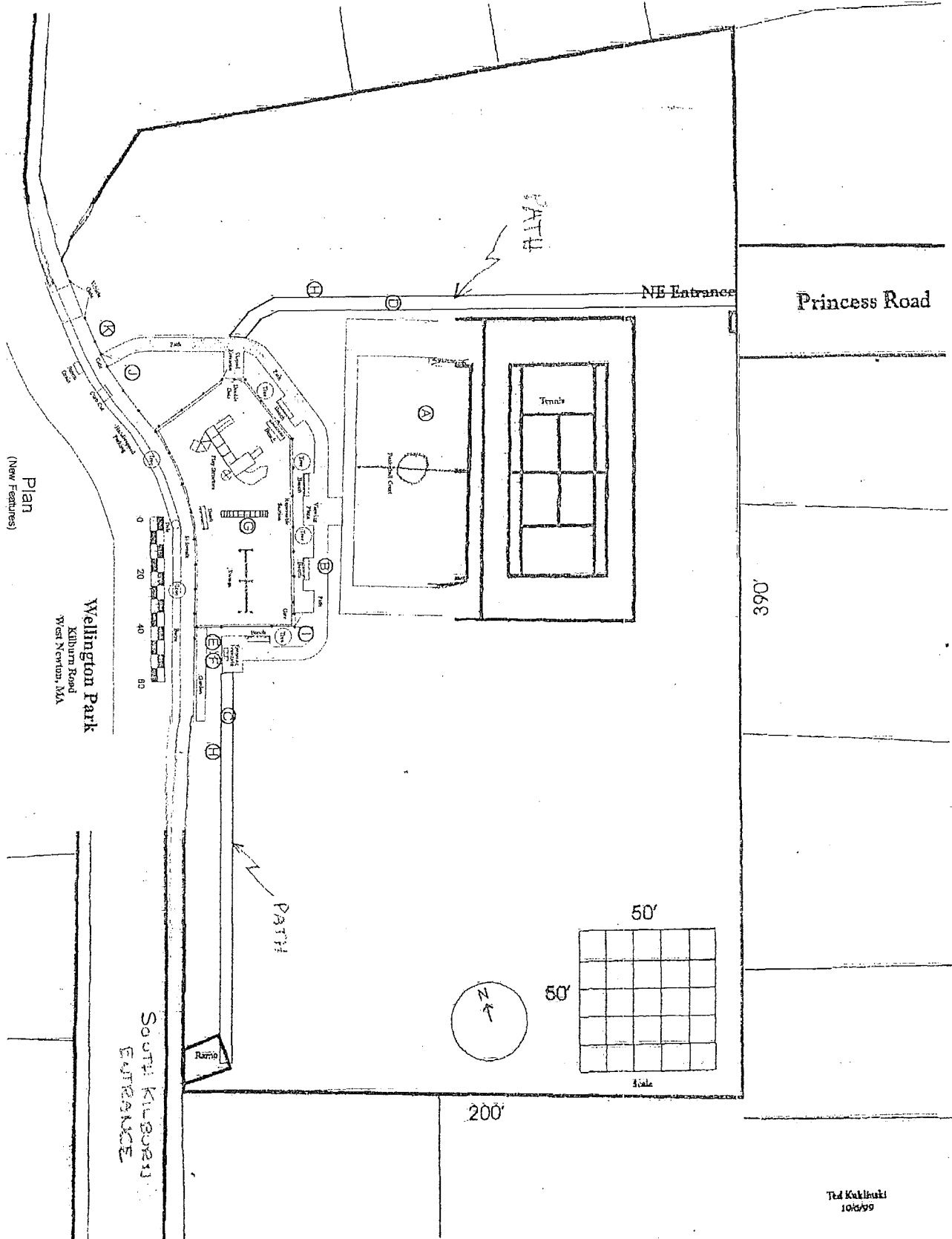

Plan
(New Features)

Wellington Park
Kilburn Road
West Newton, MA

SOUTH KILBOURN
ENTRANCE

NE Entrance

Princess Road

PATH

A

50'

50'

Scale



200'

390'

Ted Kukulski
10/8/99

Wellington Aerial View

Note: (Prior to Play Area)

