

# Reservoir Park at Heartbreak Hill

Reuse Concept by the  
Waban Hill Reservoir Advisory Group (WHRAG)

19 June 2013  
presentation

by Katy Hax Holmes, Senior Planner  
City of Newton, Massachusetts  
Dept. of Planning & Development

to Board of Aldermen, Programs & Services Committee

# THE RESERVOIR'S LOCATION IN NEWTON

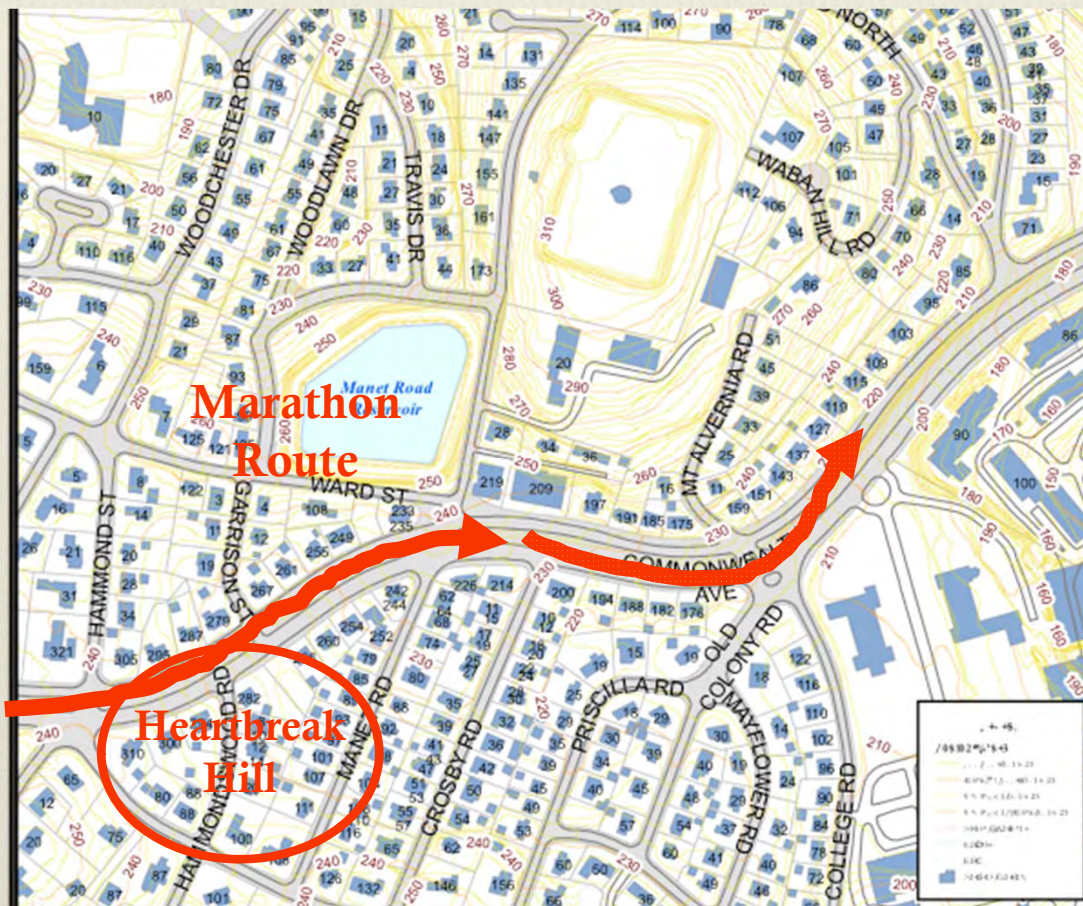

Reservoir Park at Heartbreak Hill

From Manet and Reservoir Road looking toward Commonwealth Avenue



Reservoir Park at Heartbreak Hill

From Manet and Reservoir Road  
toward Woodlawn Drive

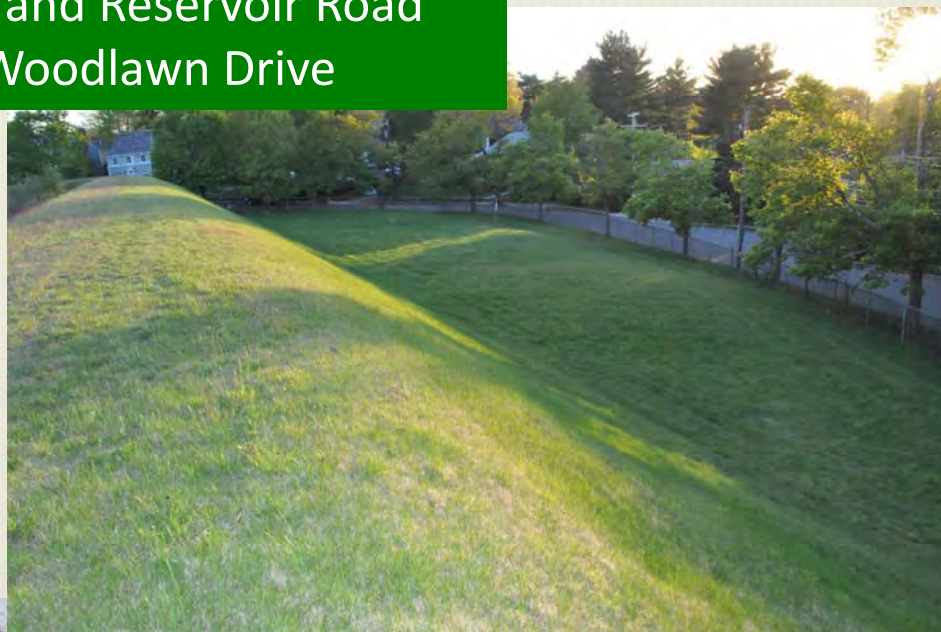

Reservoir Park at Heartbreak Hill

The Gatehouse at Ward Street and  
Woodlawn Drive

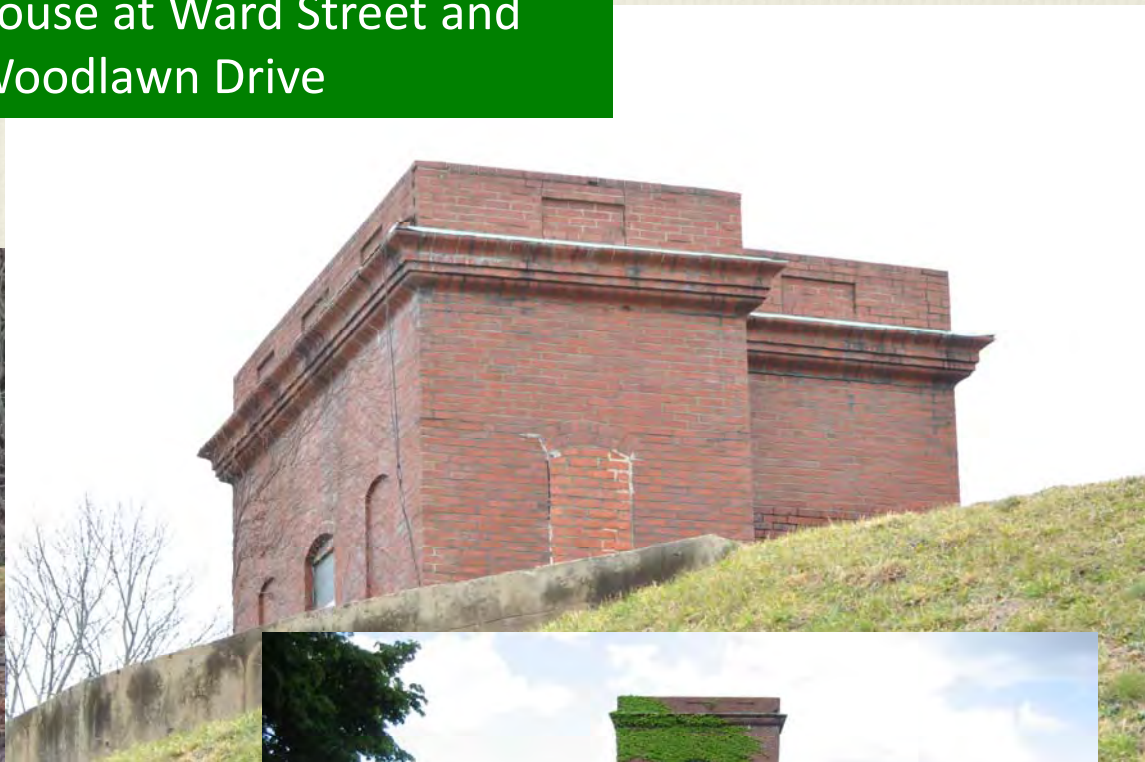

Reservoir Park at Heartbreak Hill

# IMPORTANT CHARACTERISTICS

- ❖ Water
- ❖ Sunsets
- ❖ Half-Mile Loop Path
- ❖ Open Lawn Area
- ❖ Heartbreak Hill
- ❖ History
- ❖ Neighborhood that Wants to Share this Resource



Reservoir Park at Heartbreak Hill

# RETAIN WATER AS A SIGNATURE FEATURE



Reservoir Park at Heartbreak Hill



Examples of water features that can act as a magnet

Reservoir Park at Heartbreak Hill



CREATE PATHWAYS AND  
OVERLOOKS TO SHARE SPACE  
AND ART



Benches and pergolas to  
provide seating and  
shade



Reservoir Park at Heartbreak Hill

# A GATEWAY TO NEWTON AND A POWERFUL MARATHON CONNECTION TO THE WORLD



Establish a permanent marathon connection

Reservoir Park at Heartbreak Hill

# NEWTON'S FIRST PLAYGROUND WITH A WATER THEME



Possible additional water features



Reservoir Park at Heartbreak Hill



A waterpark for the  
youngest residents of  
Newton



Reservoir Park at Heartbreak Hill



Incorporate the berm  
into the play area

INSTALL AN  
IMAGINATIVE  
PLAYGROUND



Reservoir Park at Heartbreak Hill

TAKE ADVANTAGE OF A  
UNIQUE  
LOCATION TO VIEW THE  
SUNRISE  
AND SUNSET

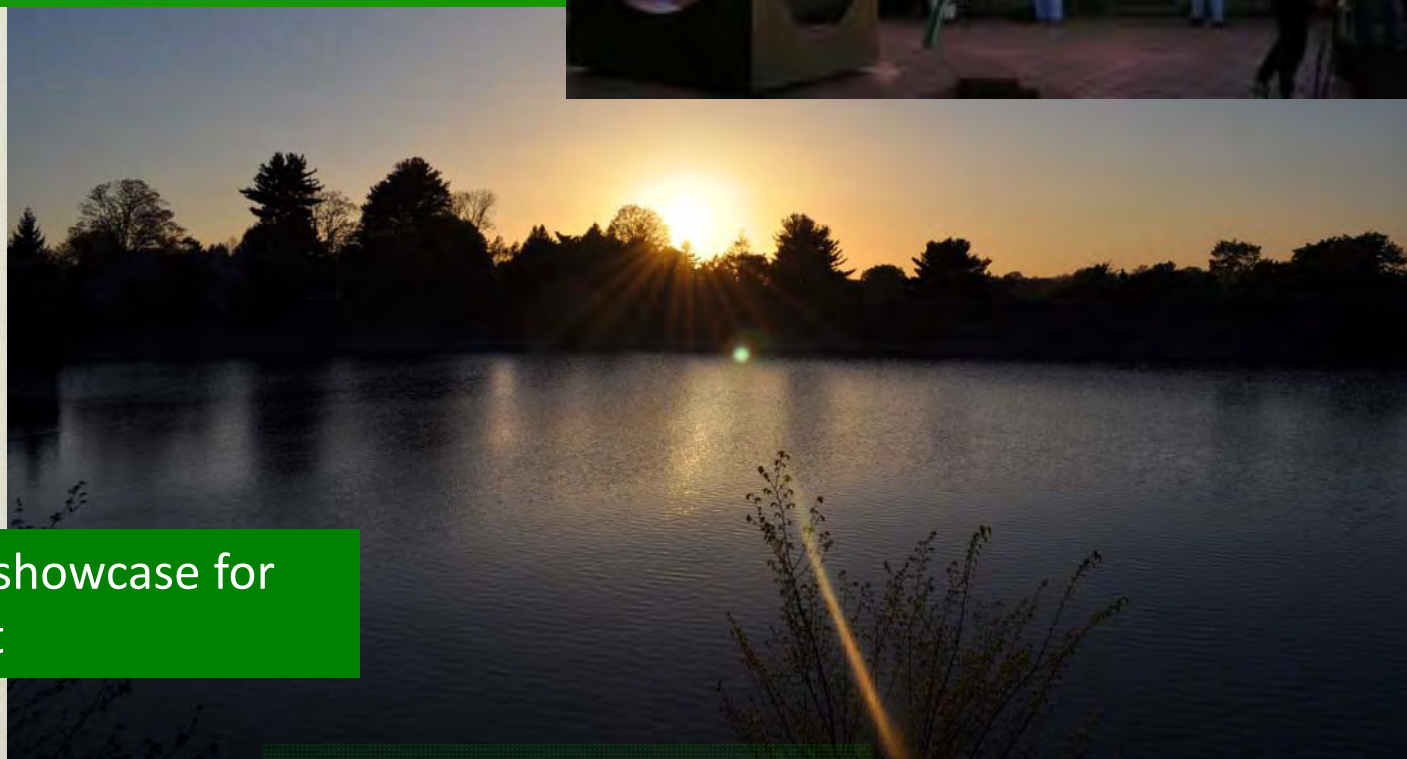

Create a showcase for  
public art

Reservoir Park at Heartbreak Hill

TAKE ADVANTAGE OF A  
NATURAL HIGH SPOT WITH  
SEATING IN A  
MINI-AMPHITHEATER



Create a new citywide  
gathering spot

Reservoir Park at Heartbreak Hill

CONVEY HISTORY OF SITE  
THROUGH SIGNAGE



Reservoir Park at Heartbreak Hill



## PARTNER WITH OTHER ORGANIZATIONS



NEWTON COMMUNITY FARM

GREEN DECADE

BOSTON ATHLETIC ASSOCIATION

Reservoir Park at Heartbreak Hill

# A Future Site Plan

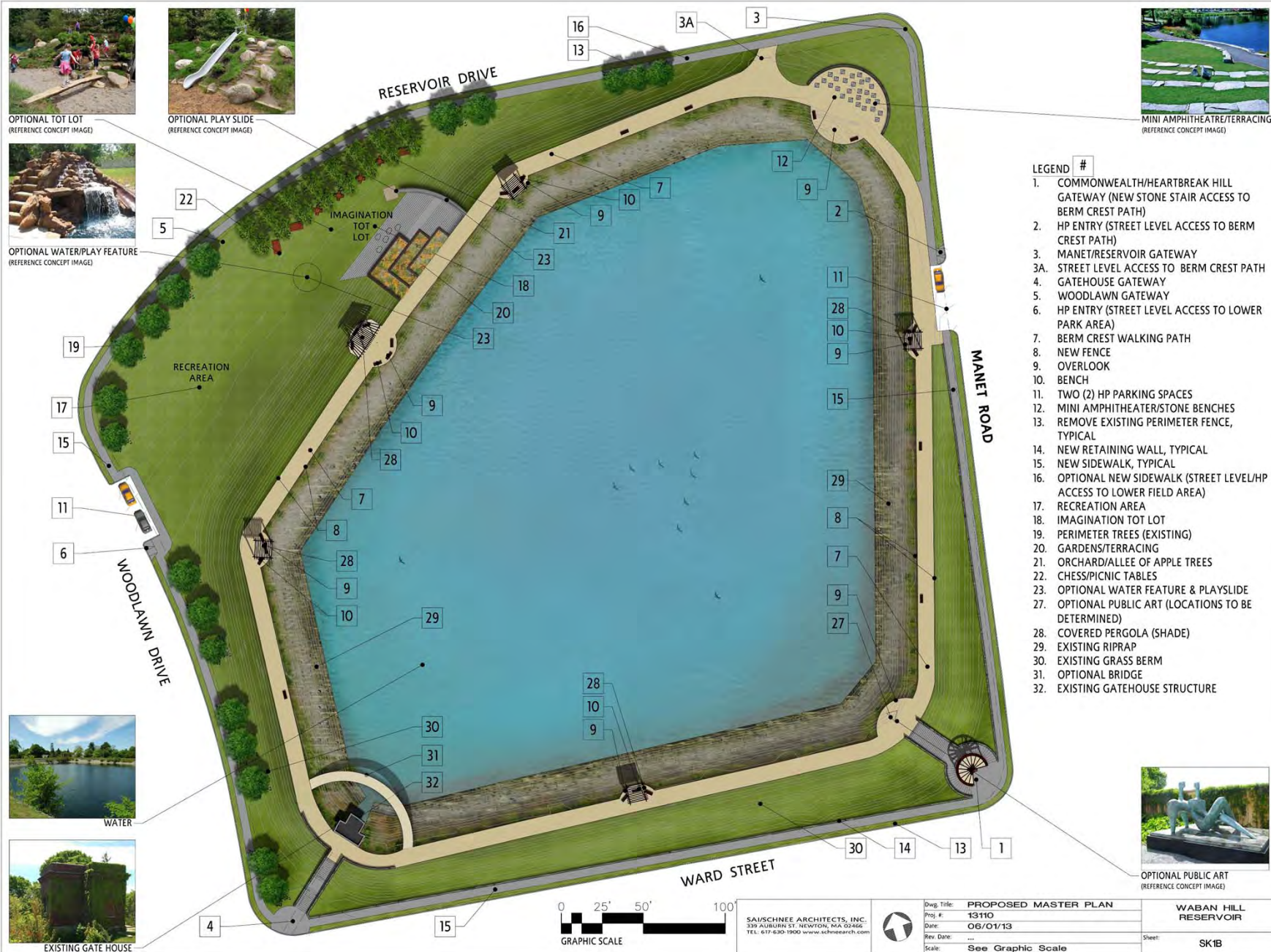

- LEGEND #**
1. COMMONWEALTH/HEARTBREAK HILL GATEWAY (NEW STONE STAIR ACCESS TO BERM CREST PATH)
  2. HP ENTRY (STREET LEVEL ACCESS TO BERM CREST PATH)
  3. MANET/RESERVOIR GATEWAY
  - 3A. STREET LEVEL ACCESS TO BERM CREST PATH
  4. GATEHOUSE GATEWAY
  5. WOODLAWN GATEWAY
  6. HP ENTRY (STREET LEVEL ACCESS TO LOWER PARK AREA)
  7. BERM CREST WALKING PATH
  8. NEW FENCE
  9. OVERLOOK
  10. BENCH
  11. TWO (2) HP PARKING SPACES
  12. MINI AMPHITHEATER/STONE BENCHES
  13. REMOVE EXISTING PERIMETER FENCE, TYPICAL
  14. NEW RETAINING WALL, TYPICAL
  15. NEW SIDEWALK, TYPICAL
  16. OPTIONAL NEW SIDEWALK (STREET LEVEL/HP ACCESS TO LOWER FIELD AREA)
  17. RECREATION AREA
  18. IMAGINATION TOT LOT
  19. PERIMETER TREES (EXISTING)
  20. GARDENS/TERRACING
  21. ORCHARD/ALLEE OF APPLE TREES
  22. CHESS/PICNIC TABLES
  23. OPTIONAL WATER FEATURE & PLAYSLIDE
  27. OPTIONAL PUBLIC ART (LOCATIONS TO BE DETERMINED)
  28. COVERED PERGOLA (SHADE)
  29. EXISTING RIPRAP
  30. EXISTING GRASS BERM
  31. OPTIONAL BRIDGE
  32. EXISTING GATEHOUSE STRUCTURE



OPTIONAL TOT LOT  
(REFERENCE CONCEPT IMAGE)



OPTIONAL PLAY SLIDE  
(REFERENCE CONCEPT IMAGE)



OPTIONAL WATER/PLAY FEATURE  
(REFERENCE CONCEPT IMAGE)



MINI AMPHITHEATRE/TERRACING  
(REFERENCE CONCEPT IMAGE)



WATER



EXISTING GATE HOUSE



OPTIONAL PUBLIC ART  
(REFERENCE CONCEPT IMAGE)



SAI/SCHNEE ARCHITECTS, INC.  
139 ALBURN ST. NEWTON, MA 02466  
TEL. 617-630-1900 www.sairesearch.com



Dwg. Title: PROPOSED MASTER PLAN  
Proj. #: 13110  
Date: 06/01/13  
Rev. Date: ...  
Scale: See Graphic Scale

WABAN HILL RESERVOIR  
Sheet: SK1B

The reservoir is an important resource that should belong to the City of Newton



SA/SCHNEE ARCHITECTS, INC. 329 AUBURN ST. NEWTON, MA 02466 TEL: 617-630-1900 www.schneearch.com		Dwg. Title: <b>PROPOSED PLAN-PHASE 1</b>	Sheet
		Proj. #: <b>13110</b>	
		Date: <b>06/01/13</b>	
		Rev. Date: ...	
		Scale: ...	

Reservoir Park at Heartbreak Hill