

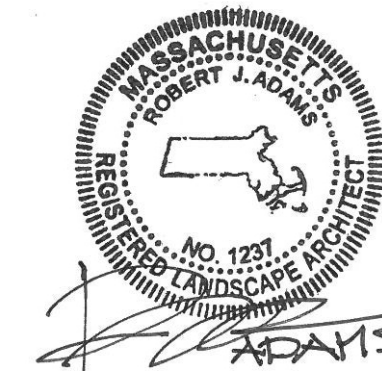

101 Walnut Street
PO Box 9151
Watertown, MA 02471
617.924.1770

HALVORSON
Tighe & Bond STUDIO

25 KINGSTON ST. BOSTON MA 02111-2200
(PHONE) 617.556.0380
WWW.HALVORSONDESIGN.COM



Riverside Station
Grove Street
Newton, Massachusetts

No.	Revision	Date	App'd.
1	RESPONSE TO COMMENTS	04/28/2020	RSH
2	RESPONSE TO COMMENTS	07/07/2020	RSH

Designed by SRL Checked by RJA
Issued for Date
Dec. 9, 2019

Special Permit & Zone Change
Not Approved for Construction

LANDSCAPE PLAN

Drawing Number

L1.1

Sheet of

25

Project Number
10865.03

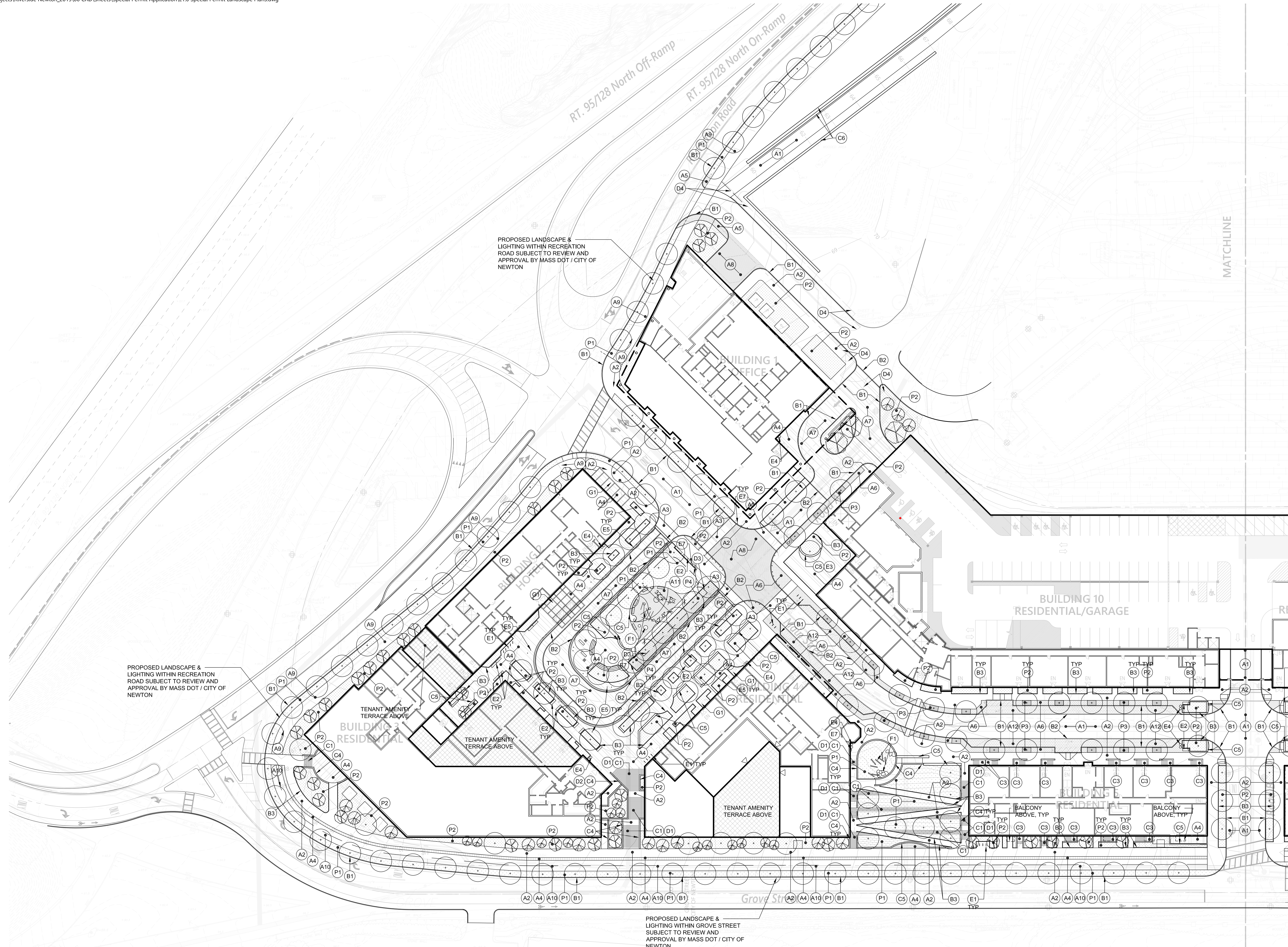

PROPOSED LANDSCAPE & LIGHTING WITHIN RECREATION ROAD SUBJECT TO REVIEW AND APPROVAL BY MASS DOT / CITY OF NEWTON

PROPOSED LANDSCAPE & LIGHTING WITHIN RECREATION ROAD SUBJECT TO REVIEW AND APPROVAL BY MASS DOT / CITY OF NEWTON

PROPOSED LANDSCAPE & LIGHTING WITHIN GROVE STREET SUBJECT TO REVIEW AND APPROVAL BY MASS DOT / CITY OF NEWTON

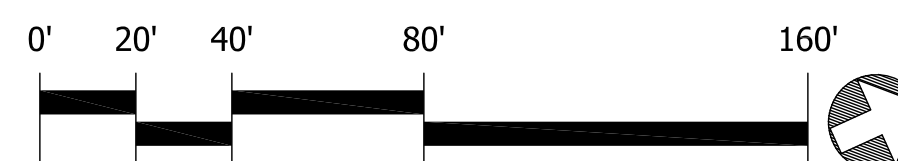

Saved Monday, July 6, 2020 7:47:37 PM SLANE Plotted Tuesday, July 7, 2020 11:00:52 AM Shannon Lane

MATERIALS LEGEND

TAG	DESCRIPTION	DETAIL	TAG	DESCRIPTION	DETAIL
PAVING					
A1	BITUMINOUS CONCRETE PAVING - SEE CIVIL DRAWINGS		C1	INTEGRALLY COLORED PRECAST CONCRETE STAIR TREADS - 12" WIDTH	
A2	POURED IN PLACE CONCRETE PAVING - PEDESTRIAN		C2	INTEGRALLY COLORED PRECAST CONCRETE STAIR TREADS - 15" WIDTH	
A3	POURED IN PLACE CONCRETE PAVING - VEHICULAR		C3	RESIDENTIAL ENTRY STOOP - MASONRY WALL, PRECAST STAIRS AND METAL GUARDRAIL/RAILING	
A4	PRECAST CONCRETE UNIT PAVERS - PEDESTRIAN		C4	STAIR & RAMP RETAINING WALL - 12" WIDE CAST IN PLACE COLORED CONCRETE WITH FORMLINER	
A5	PRECAST CONCRETE UNIT PAVERS - VEHICULAR		C5	LANDSCAPE FEATURE SEATWALL - 18" WIDE GRANITE CAP WITH GRANITE VENEER	
A6	PERMEABLE UNIT PAVERS (WITH STRUCTURAL SOIL BELOW) - PEDESTRIAN CONDITION		C6	MBTA YARD ACCESS RETAINING WALL & GUARDRAIL - SEE CIVIL DRAWINGS	
A7	PERMEABLE UNIT PAVERS - VEHICULAR CONDITION		FENCES & RAILS		
A8	ASPHALT BLOCK		D1	EXTERIOR STAIR HANDRAIL - STAINLESS STEEL WITH NON-DIRECTIONAL FINISH	
A9	MULTI-USE PATH: 10' WIDE BITUMINOUS PATH WITH PAINTED PAVEMENT MARKINGS		D2	METAL GUARDRAIL: MOUNT TO TOP OF WALL	
A10	TWO-WAY CYCLE TRACK - BITUMINOUS PATH WITH PAINTED PAVEMENT MARKING		D3	48" HGT DECORATIVE METAL FENCE AT PERIMETER OF PLAY AREA	
A11	RESILIENT PLAY SURFACING		D4	MBTA YARD ACCESS FENCE & GATES - SEE CIVIL DRAWINGS	
A12	POROUS ASPHALT PAVING		STREETSCAPE & SITE FURNISHINGS		
CURBS & EDGING					
B1	VEHICULAR GRANITE CURB - 6" WIDTH		E1	BIKE RACKS	
B2	VEHICULAR GRANITE CURB - FLUSH OR MOUNTABLE - 6" WIDTH - SEE CIVIL DWGS		E2	WOOD AND METAL BACKED BENCH	
B3	4" WIDTH GRANITE LANDSCAPE CURB		E3	WOOD AND METAL BACKLESS BENCH - WALL MOUNTED	
B4	4" WIDTH FLUSH GRANITE PAVING EDGE		E4	LITTER & RECYCLING RECEPTACLES (PAIRS)	
			E5	VEHICULAR BOLLARD - FIXED	
			E6	VEHICULAR BOLLARD - OPERABLE	
			E7	PET WASTE BAG DISPENSER	

TAG	DESCRIPTION	DETAIL
FEATURES		
F1	PLAY EQUIPMENT - ACTUAL TYPE/LAYOUT TBD	
PLANTING		
P1	SODDED LAWN	
P2	SITE PLANTING BED - 24" SOIL DEPTH - SHRUB, PERENNIAL AND GROUND COVER BEDS	
P3	TREEWAY AT STREETSCAPE: PERMEABLE PAVERS ON STRUCTURAL SOIL WITH 4'X8" CRUSHED STONE TREE PITS	
P4	RAIN GARDEN WITH 24" DEPTH OF WELL DRAINING PLANTING MEDIUM	
	DECIDUOUS SHADE TREE - 3.5" - 4" CALIPER	
	ORNAMENTAL TREE - 12' HGT - MULTISTEM	
	EVERGREEN TREE - 12' HGT	
STRUCTURES & PLAY		
G1	BUILDING OVERHANG / CANOPY	
G2	BUS SHELTER	

NOTES:
1. SITE LIGHTING: FOR LOCATION AND TYPE, PLEASE REFER TO SITE LIGHTING PHOTOMETRIC PLANS

REPRESENTATIVE PLANT LIST

Botanical Name	Common Name
TREES	
<i>Acer x freemanii</i> 'Jeffersred'	Autumn Blaze Maple
<i>Acer rubrum</i> 'Karpick'	Karpick Maple
<i>Amelanchier x grandiflora</i> 'Autumn Brilliance'	Autumn Brilliance Serviceberry
<i>Betula nigra</i> 'Cully'	Heritage River Birch
<i>Celtis occidentalis</i>	Hackberry
<i>Crataegus viridis</i> 'Winter King'	Winter King Hawthorn
<i>Ginkgo biloba</i>	Ginkgo
<i>Hamamelis x intermedia</i> 'Arnold Promise'	Arnold Promise Witch Hazel
<i>Hamamelis vernalis</i> 'Autumn Embers'	Autumn Embers Witch Hazel
<i>Ulmus</i> 'Patriot'	Patriot Elm
<i>Ulmus</i> 'Patriot'	Patriot Elm
<i>Sassafras albidum</i>	Sassafras
SHRUBS	
<i>Buxus</i> 'Green Mountain'	Green Mountain Boxwood
<i>Buxus microphylla japonica</i> 'Winter Gem'	Winter Gem Boxwood
<i>Cornus alba</i> 'Ivory Halo'	Variegated Red Twig Dogwood
<i>Cotinus coggygria</i>	Smoke Tree
<i>Cotoneaster apiculatus</i>	Cranberry Cotoneaster
<i>Cotoneaster horizontalis</i> 'Perpusilla'	Compact Rock Cotoneaster
<i>Euonymus fortunei</i> 'Sarcocoe'	Sarcocoe Wintercreeper
<i>Fothergilla major</i> 'Mount Airy'	Mt. Airy Dwarf Fothergilla
<i>Hydrangea macrophylla</i> 'Lady in Red'	Lady in Red Hydrangea
<i>Hydrangea quercifolia</i> 'Snow Queen'	Snow Queen Oakleaf Hydrangea
<i>Hypericum frondosum</i> 'Sunburst'	Sunburst St. John's Wort
<i>Ilex glabra</i> 'Shamrock'	Shamrock Inkberry
<i>Microbiota decussata</i>	Siberian Carpet Cypress
<i>Rhododendron</i> 'Dora Amateis'	Dora Amateis Rhododendron
<i>Rhus aromatica</i> 'Gro-Low'	Gro-Low Fragrant Sumac
<i>Rosa</i> 'Blushing Knock Out'	Blushing Knock Out Rose
<i>Taxus baccata</i> 'Repandens'	Spreading English Yew
<i>Viburnum x 'Juddii'</i>	Judd Viburnum
<i>Viburnum carlesii</i> 'SMVCB' P.P. 25872	Spice Baby Viburnum

PERENNIALS	
<i>Agastache</i> 'Black Adder'	Black Adder Hyssop
<i>Alchemilla mollis</i>	Common Lady's Mantle
<i>Amsonia</i> x 'Blue Ice'	Blue Star Flower
<i>Anemone</i> x 'September Charm'	September Charm Windflower
<i>Baptisia australis</i>	False Indigo
<i>Demissa punctilobula</i>	Hay Scented Fern
<i>Echinacea purpurea</i>	Purple Coneflower
<i>Geranium</i> x 'Rozanne'	Rozanne Cranesbill
<i>Hemerocallis</i> 'Fragrant Returns'	Fragrant Returns Daylily
<i>Hemerocallis</i> 'Happy Returns'	Happy Returns Daylily
<i>Heuchera</i> 'Stormy Seas'	Coral Bells
<i>Iris sibirica</i> 'Silver Edge'	Silver Edge Siberian Iris
<i>Nepeta</i> x 'faassenii 'Walkers Low'	Walkers Low Catmint
<i>Rudbeckia fulgida</i> 'Goldsturm'	Black Eyed Susan
<i>Salvia</i> 'May Night'	May Night Salvia
GRASSES & GROUND COVERS	
<i>Bouteloua gracilis</i> 'Blonde Ambition'	Side Oats Grama
<i>Calamagrostis acutiflora</i> 'Karl Foerster'	Karl Foerster Feather Reed Grass
<i>Carex pendula</i>	Drooping Sedge
<i>Chasmanthium latifolium</i>	Northern Sea Oats
<i>Chasmanthium latifolium</i> 'River Mist'	Variegated Northern Sea Oats
<i>Deschampsia cespitosa</i> 'Pixie Fountain'	Tufted Hair Grass
<i>Epimedium x rubrum</i>	Red Barrenwort
<i>Euonymus coloratus</i>	Wintercreeper Euonymus
<i>Hakonechloa macra</i> 'All Gold'	All Gold Hakoke Grass
<i>Liriope spicata</i>	Lilyturf
<i>Miscanthus sinensis</i> 'Adagio'	Dwarf Silver Grass
<i>Pennisetum alopecuroides</i> 'Hamel'	Hamel Dwarf Fountain Grass



101 Walnut Street
PO Box 9151
Watertown, MA 02471
617.924.1770

HALVORSON
Tighe&Bond STUDIO

25 KINGSTON ST. BOSTON MA 02111-2200
(PHONE) 617.536.0380
WWW.HALVORSONDESIGN.COM

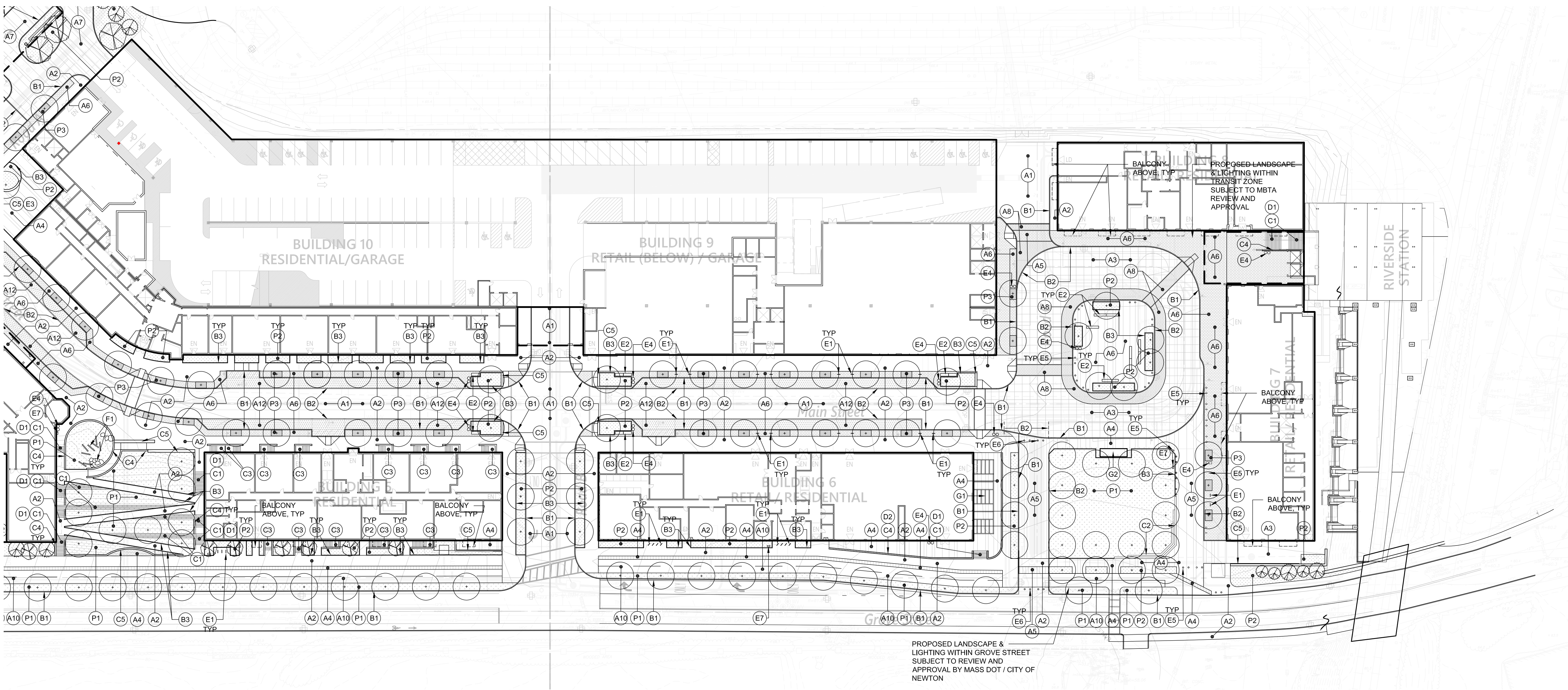

PROPOSED LANDSCAPE & LIGHTING WITHIN GROVE STREET SUBJECT TO REVIEW AND APPROVAL BY MASS DOT / CITY OF NEWTON

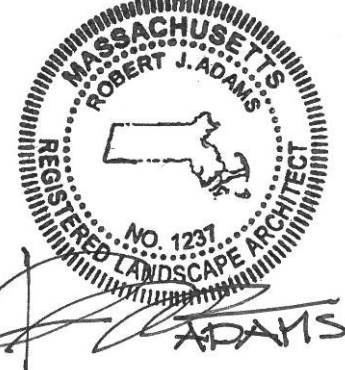

Riverside Station
Grove Street
Newton, Massachusetts

No.	Revision	Date	Apprd.
1	RESPONSE TO COMMENTS	04/28/2020	RSH
2	RESPONSE TO COMMENTS	07/07/2020	RSH

Designed by SRL Checked by RJA
Issued for Date
Dec. 9, 2019

Special Permit & Zone Change
Not Approved for Construction

LANDSCAPE PLAN

Drawing Number

L1.2
Sheet of 25

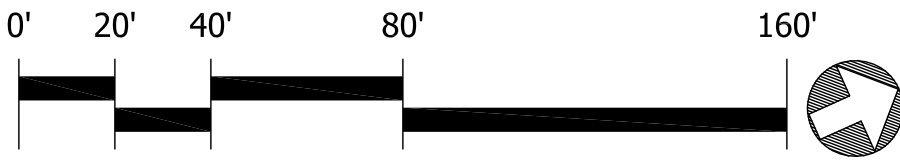

Project Number
10865.03