

Newton Historical Commission • Preservation Restriction Review

6 October 2020 • Lisa Dady, Director of Historic Newton / Jackson Homestead



Project Description

The Jackson Homestead site dates to the mid-17th century as the Jacksons were among the first European immigrants to the area. The current house was built in 1809 for Timothy Jackson. The site is owned by the City of Newton and operates as a museum. The proposed work is not physically connected to the building, rather it is the fence that runs along the property's western border, along Jackson Road.

The current fence has reached the end of its useful life and needs to be replaced. The replacement design is based on four pieces of evidence: 1. the existing fence is a wooden picket fence with a scalloped top, 2. The 1935 HABS-HAER site plan indicates a wooden picket fence in that location, 3. a 1940s photo shows the design that we wish to replicate (again with a scalloped top), 4. Two photos from 1997; while they do not exactly match the 1940s design, they are quite similar and help us to understand the history of the design.

As seen in the 1940s photo, the posts only go up to the top rail and the pickets are entirely in front of the entire frame, rails and posts alike, with the scalloping of the pickets continuous along the street face, including in front of the posts. Steelco fence (City vendor) has given us a quote for the 4' tall, cedar picket fence. We are requesting an installation that has longevity, so Steelco has recommended: "Put post sleeves on all gate & terminal posts, also put a sleeve on one line post in 50' run and three line posts in 100' run." "That way you'll have a post set rock solid every 3 panels max and on all swing posts."

Thank you for your consideration of this proposal for one of Newton's most important historic sites.

A handwritten signature in black ink that reads "Lisa Dady".

Lisa Dady
Director, Historic Newton / Jackson Homestead
527 Washington Street, Newton MA 02458
617-796-1450
ldady@newtonma.gov

- LEGEND -

- OLD STRUCTURE
- NEW STRUCTURE
- WIRE FENCE
- PICKET FENCE
- RETAINING WALL
- GRASS AREA
- * - LIGHT
- ⊙ C.B. - CATCH BASIN
- ⊙ - FIRE HYDRANT

LIST OF PLANTS

COMMON NAME	BOTANIC NAME
Gray Birch	Betula populifolia
Butternut	Juglans cinerea
Cherry	Prunus, in variety
American Elm	Ulmus americana
English Elm	Ulmus campestris
Common Honeylocust	Gleditsia triacanthos
Horschestnut	Aesculus hippocastanum
Common Linden	Tilia vulgaris
Common Locust	Robinia pseudoacacia
Red Maple	Acer rubrum
Silver Maple	Acer dasycarpum
Sugar Maple	Acer saccharum
Sycamore Maple	Acer pseudoplatanus
Pear	Pyrus, in variety
Norway Spruce	Picea excelsa
Black Walnut	Juglans nigra
SHRUBS	
Border Forsythia	Forsythia intermedia
Goldenchain	Laburnum vulgare
Common Lilac	Syringa vulgaris
Persian Lilac	Syringa persica
Sweet Mockorange	Philadelphus coronarius
Common Ninebark	Physocarpus opulifolius
Thunberg Spirea	Spiraea thunbergi

REFERENCE FOR PLANT MATERIAL - "STANDARDIZED PLANT NAMES, 1923"

NOTES (CONT.) - The walk along the front of the house and to Jackson Rd. are recent additions. All walks and the drive have gravel surface. A garden is said to have occupied the lawn area southeast and west of the house. The old layout was doubtless contemporary with the house.

RECORDED APRIL 1936.

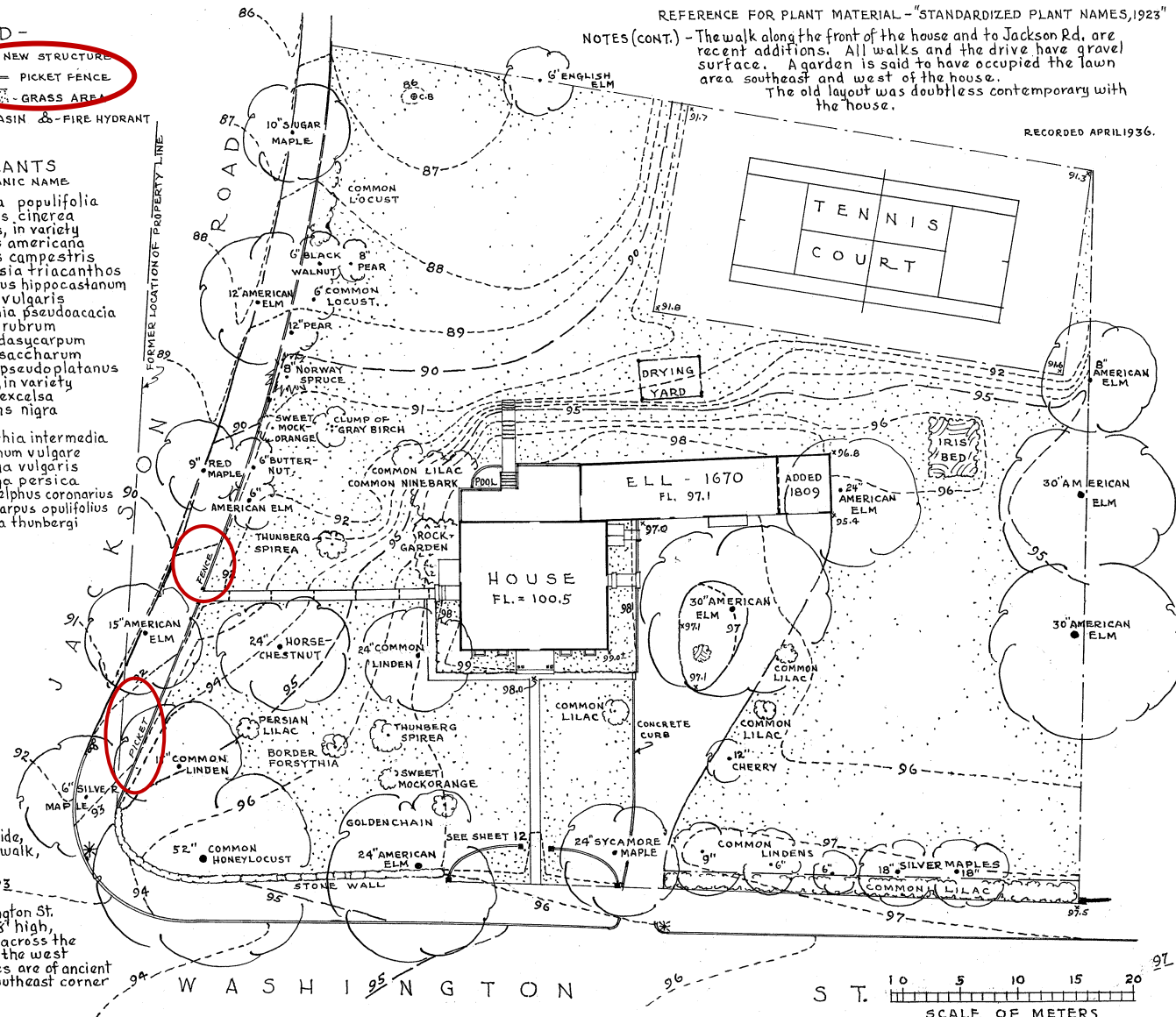

- NOTES -

Little remains of the original treatment of the grounds. A trace of a perennial border 3' wide, on either side of the entrance walk, may be seen. Details of the fence and gate at the entrance 93 are shown on SHEET 12.

The lilac hedge along Washington St. is a part of the old hedge, 8' high, which formerly extended across the Washington St. frontage and the west property line. Several trees are of ancient origin as is the lilac near southeast corner of the house.

WORK DONE WITH MASS. E.R.A. FUNDS

GEORGE JENNESS } DEL.
R. NEWTON MAYALL }

GENERAL PLAN
HOUSE BUILT 1809

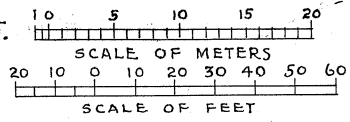

HABS-HAER
Site Plan for
Jackson
Homestead,
1935.

UNDER DIRECTION OF UNITED STATES DEPARTMENT OF THE INTERIOR
NATIONAL PARK SERVICE, BRANCH OF PLANS AND DESIGN

NAME OF STRUCTURE
TIMOTHY JACKSON HOUSE - NEWTON, MIDDLESEX CO., MASS

SURVEY NO.
MASS.
139

HISTORIC AMERICAN
BUILDINGS SURVEY
SHEET 13 OF 13 SHEETS

LIBRARY OF CONGRESS
INDEX NUMBER



Jackson Homestead, 1940s



**Jackson Homestead, 1940s.
Detail, west picket fence**



**Jackson Homestead, 1997.
West picket fence**



**Jackson Homestead, 1997.
West picket fence**



Jackson Homestead, 2020. West picket fence





Jackson Homestead, 2020. West picket fence



Jackson Homestead, 2020. West picket fence

HISTORIC
Newton