



SPRUHAN ENGINEERING, P.C.

80 JEWETT ST. (SUITE 1)
NEWTON, MA 02458
Tel: 617-816-0722
Email: edmond@spruhaneng.com



**432 DEDHAM STREET
NEWTON,
MASSACHUSETTS**

REVISION BLOCK

DESCRIPTION	DATE

All legal rights including, but not limited to, copyright and design patent rights, in the designs, arrangements and plans shown on this document are the property of Peter Nolan & Associates, LLC, or Spruhan Engineering, P.C. They may not be used or reused in whole or in part, except in connection with this project, without the prior written consent of Spruhan Engineering, P.C.. Written dimensions on these drawings shall have precedence over scaled dimensions. Contractors shall verify and be responsible for all dimensions and conditions on this project, and Spruhan Engineering, P.C., must be notified of any variation from the dimensions and conditions shown by these drawings.

**EXISTING - PROPOSED
PAVEMENT
COMPARISON**

SCALE:	1" = 20'
DATE:	9-22-20
DRAWN BY:	PS
CHECKED BY:	ES
APPROVED BY:	ES

SHEET:

1 OF 1

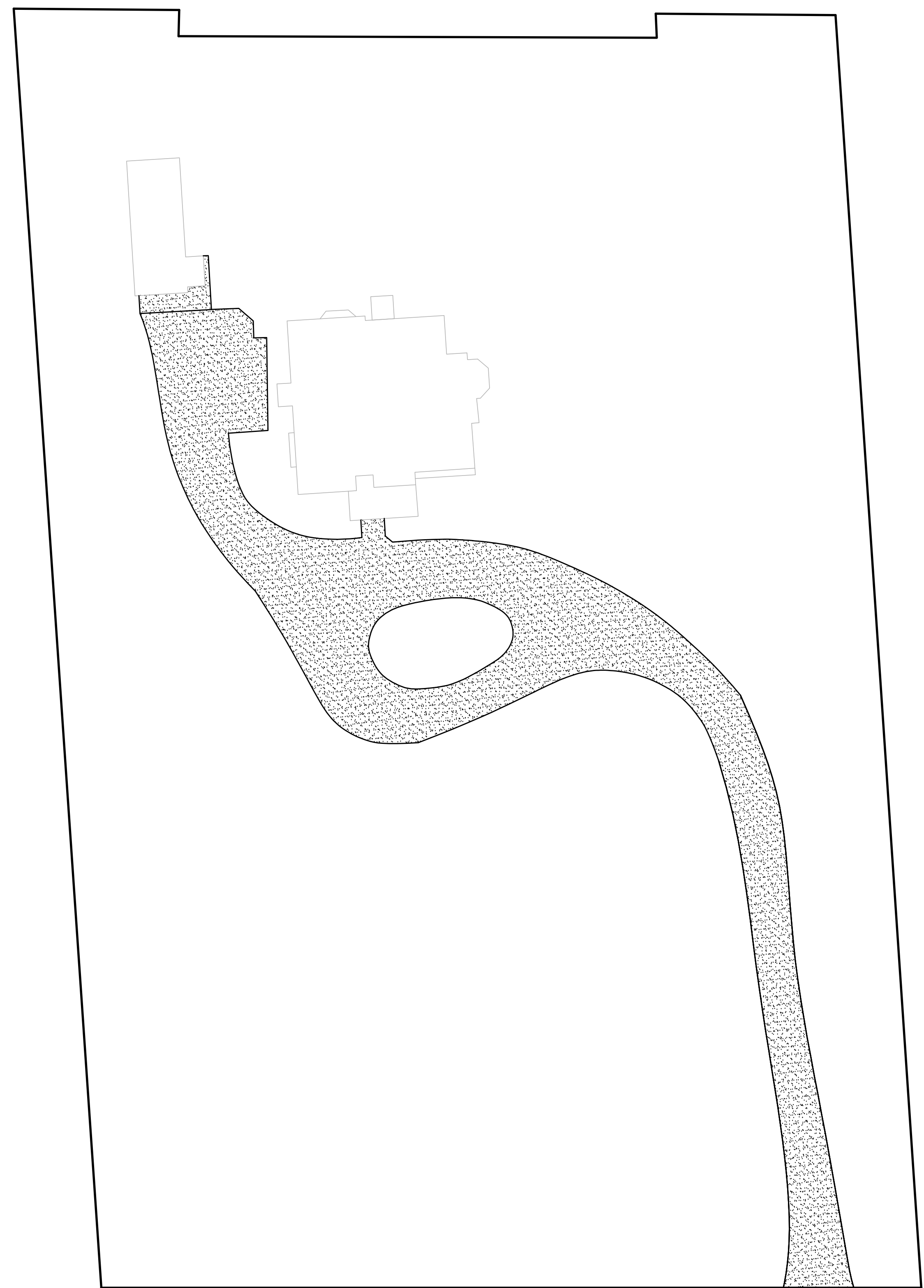

EXISTING PAVEMENT=
6,581.67 SF

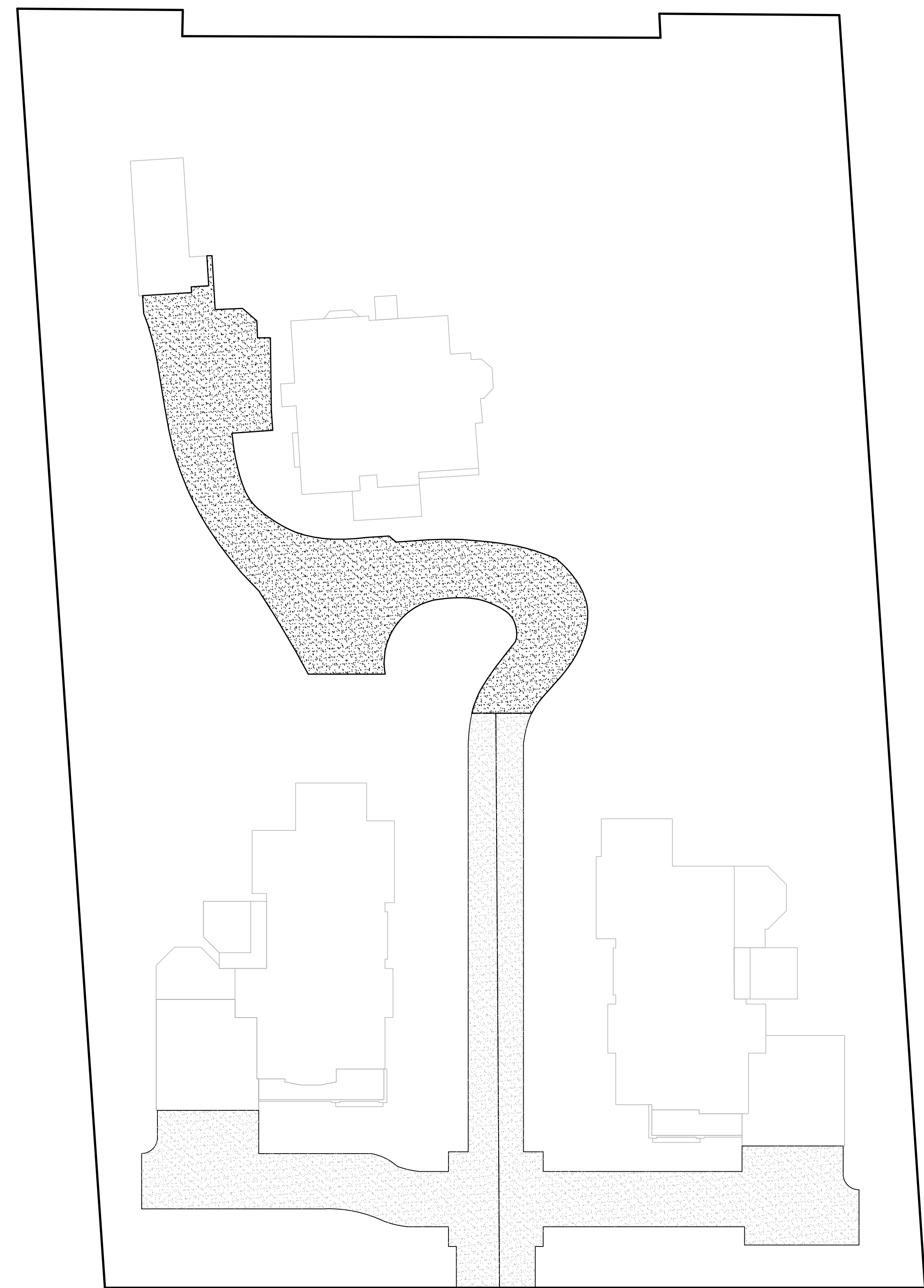

EXISTING PAVEMENT (3,666.80 SF)+
PROPOSED PAVEMENT (5,145.99 SF)=
8,812.79 SF

PAVEMENT INCREASE=2,231.12 SF
3.3% OF LOT AREA