



- Slim frame and sash profile maximize the field of view
- Excellent for creating window combinations
- Easy to clean.
- Low maintenance.

**Contents**

**Tilt-Wash Double-Hung Windows**

Basic Unit Details - Tilt-Wash Double-Hung .....3-2

Basic Unit Details - Double-Hung Picture and Transom Window .....3-3

Options / Accessories

    Andersen® Grilles .....3-4

    Stools and Extension Jambs for Tilt-Wash Basic Units .....3-6

    Stools and Extension Jambs for Double-Hung Picture Units .....3-7

    Stools and Extension Jambs for Double-Hung Transom Units .....3-8

    Combination Unit.....3-8

Joining Details .....3-9

Anchoring Methods .....3-12

Suggested Product Applications .....3-13

**NOTE: this is the entire set of literature for the 400-series windows.**

**Basic Unit Details - Tilt-Wash Double-Hung**

**Basic Unit**

Scale 3" = 1'-0" (1:4)

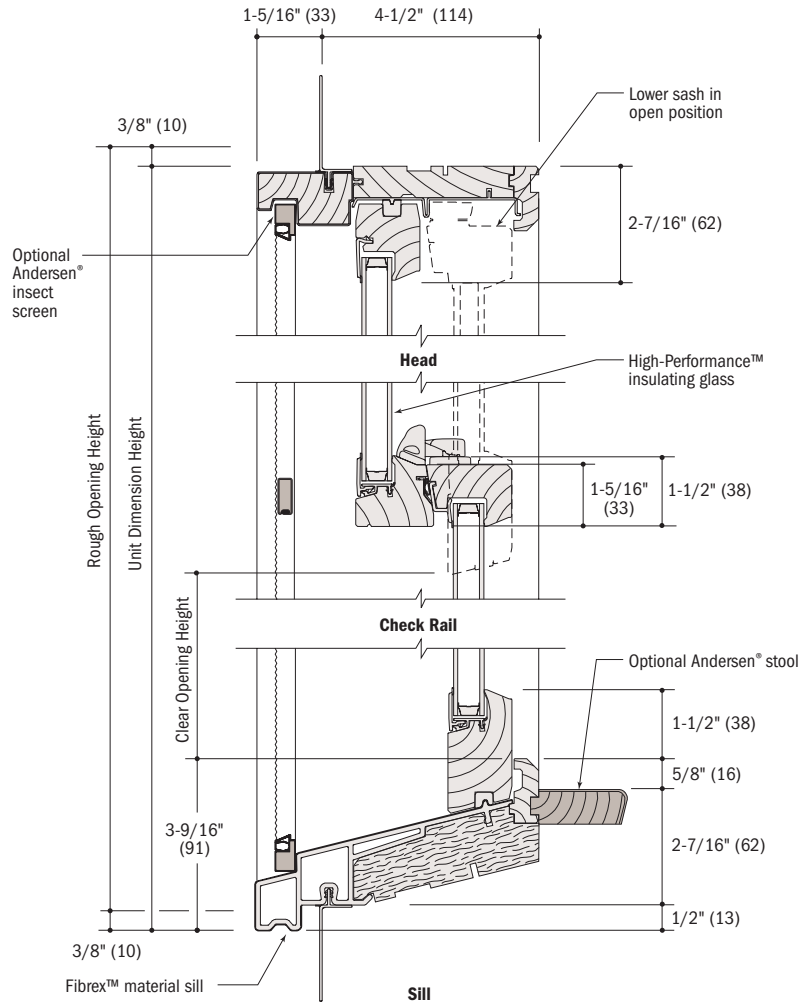

**Vertical Section**

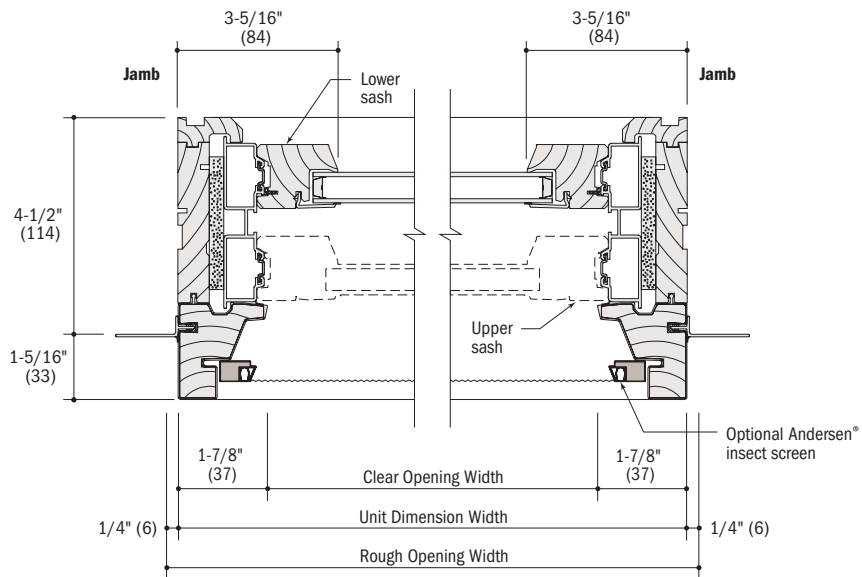

**Horizontal Section**

**Basic Unit Details - Double-Hung Picture (DHP) and Transom (DHT) Window**

**Picture Unit**

Scale 3" = 1'-0" (1:4)

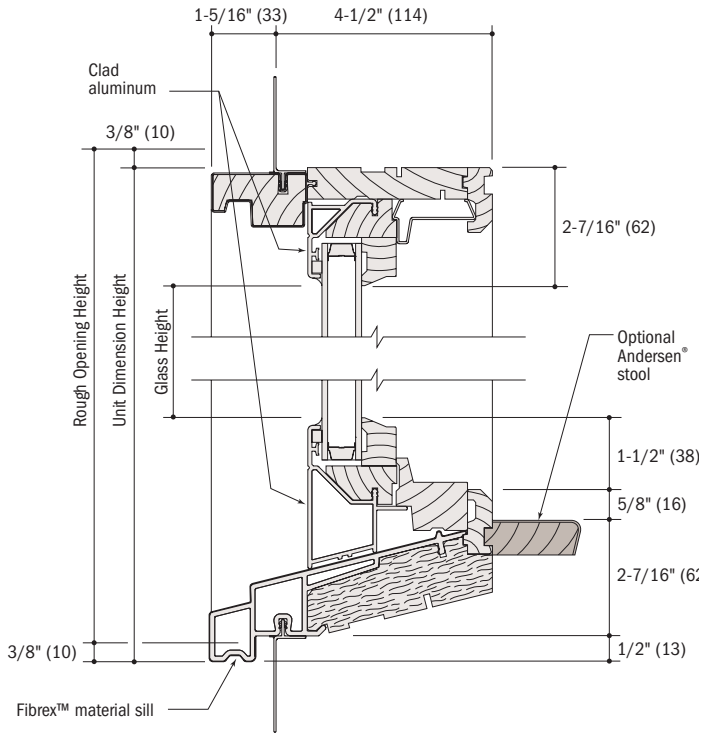

**Vertical Section**

**Transom Unit**

Scale 3" = 1'-0" (1:4)

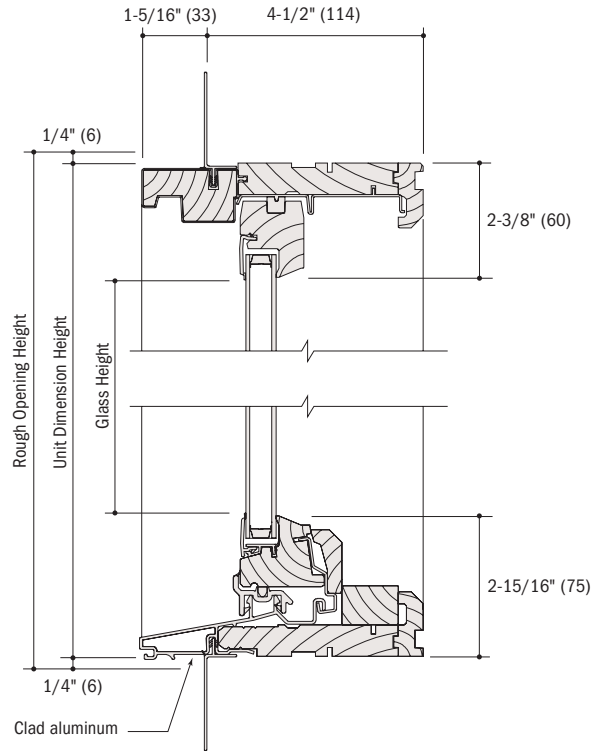

**Vertical Section**

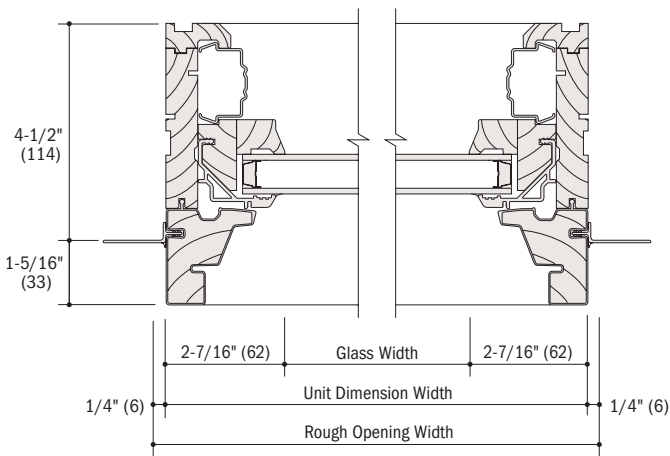

**Horizontal Section**

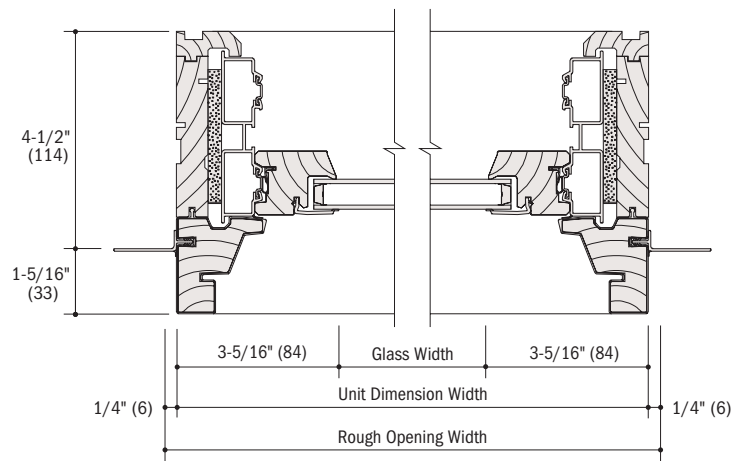

**Horizontal Section**



**Options / Accessories**

**Andersen® Divided Light Grilles**

- Available now
- Available only with 3/8" glass through the Andersen Divided Light program
- Please check with Andersen for availability

		Andersen® 400 Series Windows														Andersen® 400 Series Doors						
		Casement & Awning	Casement Picture Window	Gliding Window	Woodwright® Double-Hung & Transom	Woodwright® Picture Window	Woodwright® Archtop & Unequal Leg Archtop	Woodwright® Springline™ Single-Hung	Tilt-Wash Double-Hung & Transom	Tilt-Wash Picture Window	Circle Top™ & Quarter Round	Arch	Springline™	Flexiframe®	Elliptical	Circle & Oval	Gothic	200 Series Narrowline® Double-Hung & Transom	Frenchwood® Gliding	Frenchwood® Hinged Inswing	Frenchwood® Hinged Outswing	Frenchwood® Patio Door Sidelights & Transoms
Exterior Color	White	●	●	●	●	●	●	●	●	●	●	●	●	●	●	●	●	○	●	●	●	●
	Sandtone	●	●	●	●	●	●	●	●	●	●	●	●	●	●	●	●	○	●	●	●	●
	Terratone®	●	●	●	●	●	●	●	●	●	●	●	●	●	●	●	●	○	●	●	●	●
	Forest Green	●	●	●	●	●	●	●	●	●	●	●	●	●	●	●	●	○	●	●	●	●
Width	3/4"	●	●	●	●	●	●	●	●	●	●	●	●	●	●	●	●	○	●	●	●	●
	7/8"	●	●	●	●	●	●	●	●	●	●	●	●	●	●	●	●	○	●	●	●	●
	1-1/8"	●	●	●	●	●	●	●	●	●	●	●	●	●	●	●	●	○	●	●	●	●
	2-1/4"	●	●	●	●	●	●	●	●	●	●	↙	●	●	↙	↙	●	○	●	●	●	●
Type	With Spacer	●	●	●	●	●	●	●	●	●	●	●	●	●	●	●	●	○	●	●	●	●
	Without Spacer	●	●	●	●	●	●	●	●	●	●	●	●	●	●	●	●	○	●	●	●	●
Interior	Maple	●	●	●	●	●	●	●	●	●	●	●	●	●	●	●	●	○	●	●	●	●
	Oak	●	●	●	●	●	●	●	●	●	●	●	●	●	●	●	●	○	●	●	●	●
	Prefinished	●	●	●	●	●	●	●	●	●	●	●	●	●	●	●	●	○	●	●	●	●
	Pine	●	●	●	●	●	●	●	●	●	●	●	●	●	●	●	●	○	●	●	●	●
Patterns	Colonial	●	●	●	●	●	●	●	●	●	●	●	●	●	●	●	●	○	●	●	●	●
	Modified Colonial	●	●	●	●	●	●	●	●	●	●	●	●	●	●	●	●	○	●	●	●	●
	Modified Col W/Check Rail	●	●	●	●	●	●	●	●	●	●	●	●	●	●	●	●	○	●	●	●	●
	Prairie A	●	●	●	●	●	●	●	●	●	●	●	●	●	●	●	●	○	●	●	●	●
	Short Fractional	●	●	●	●	●	●	●	●	●	●	●	●	●	●	●	●	○	●	●	●	●
	Short Fractional W/Check Rail	●	●	●	●	●	●	●	●	●	●	●	●	●	●	●	●	○	●	●	●	●
	Tall Fractional	●	●	●	●	●	●	●	●	●	●	●	●	●	●	●	●	○	●	●	●	●
	Tall Fractional W/Check Rail	●	●	●	●	●	●	●	●	●	●	●	●	●	●	●	●	○	●	●	●	●
	Victorian	●	●	●	●	●	●	●	●	●	●	●	●	●	●	●	●	○	●	●	●	●
	Renaissance	●	●	●	●	●	●	●	●	●	●	●	●	●	●	●	●	○	●	●	●	●
	Sunburst	●	●	●	●	●	●	●	●	●	●	●	●	●	●	●	●	○	●	●	●	●
	Glass	HP/HP Tempered	●	●	●	●	●	●	●	●	●	●	●	●	●	●	●	●	○	●	●	●
HP Sun/HP Sun Temp		●	●	●	●	●	●	●	●	●	●	●	●	●	●	●	●	○	●	●	●	●
3/8" Low-E/Temp		●	●	●	●	●	●	●	●	●	●	●	●	●	●	●	●	○	●	●	●	●
Single-Pane Impact		●	●	●	●	●	●	●	●	●	●	●	●	●	●	●	●	○	●	●	●	●

**Options / Accessories**

**400 Series Grille Options**

Andersen® Divided Light Grille  
Permanent Exterior  
Permanent Interior  
with Spacer

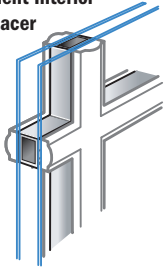

Andersen® Divided Light Grille  
Permanent Exterior  
Permanent Interior

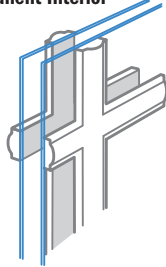

Andersen® Divided Light Grille  
Permanent Exterior  
Removable Interior

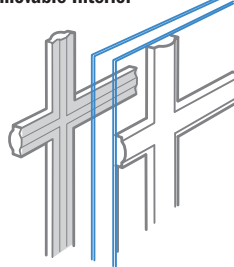

Removable  
Interior

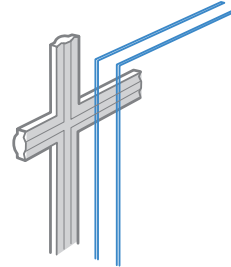

Andersen® Finelight™  
Grilles-Between-the-Glass

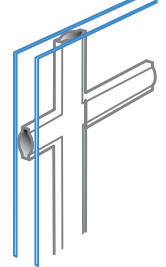

**Grille Profiles** · Scale = Full · Dimensions include thickness of tape.

**Permanent Exterior Fibrex® Material Grille Profiles** (chamfer profile). Also used for pre-finished interior, except 400 Series Woodwright® double-hung windows.

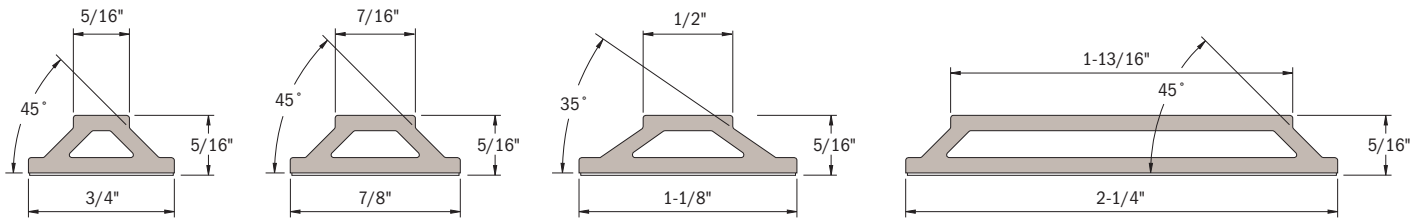

**Permanent Interior Wood Grille Profiles** (chamfer profile).

The Fibrex® material exterior grille is used when a permanent prefinished grille is specified, except with 400 Series Woodwright® double-hung windows.

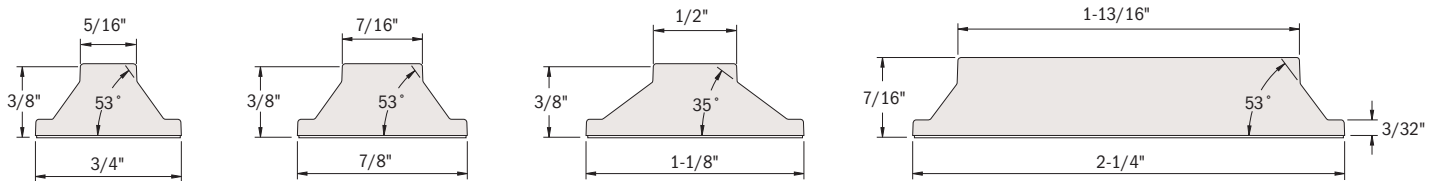

**Removable Interior Wood Grille Profile** (roman ogee profile).

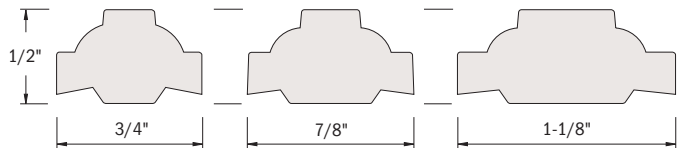

**Removable Interior Wood Grille Profile** (Chamfer profile).

400 Series Woodwright® double-hung windows only.

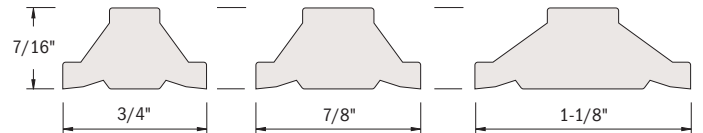

**Permanent Full Divided Light Grille spacer location.**

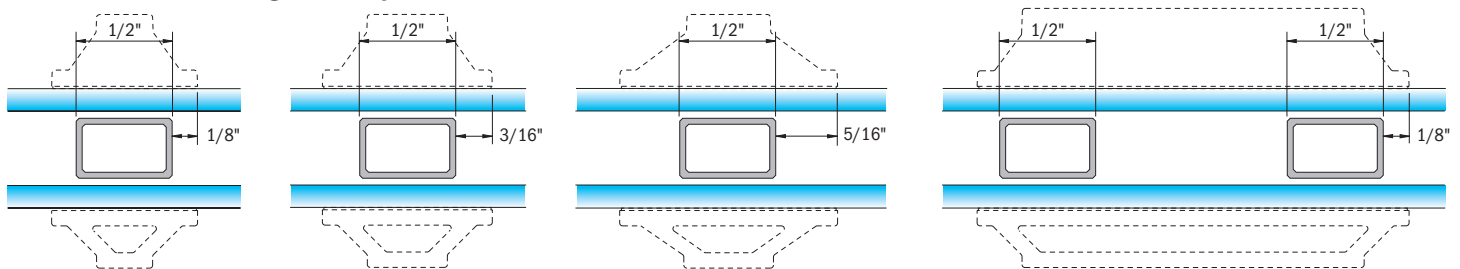

**Andersen® Finelight™ Grilles-Between-the-Glass.**

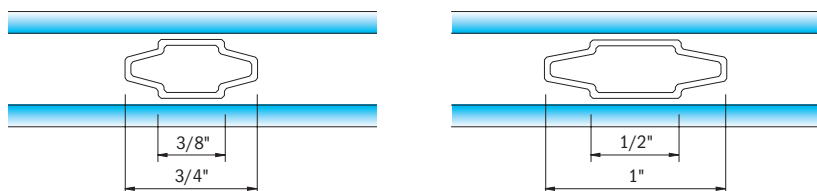

**Options / Accessories**

**Stools and Extension Jambs for Tilt-Wash Basic Units**

Scale 3" = 1'-0" (1:4)

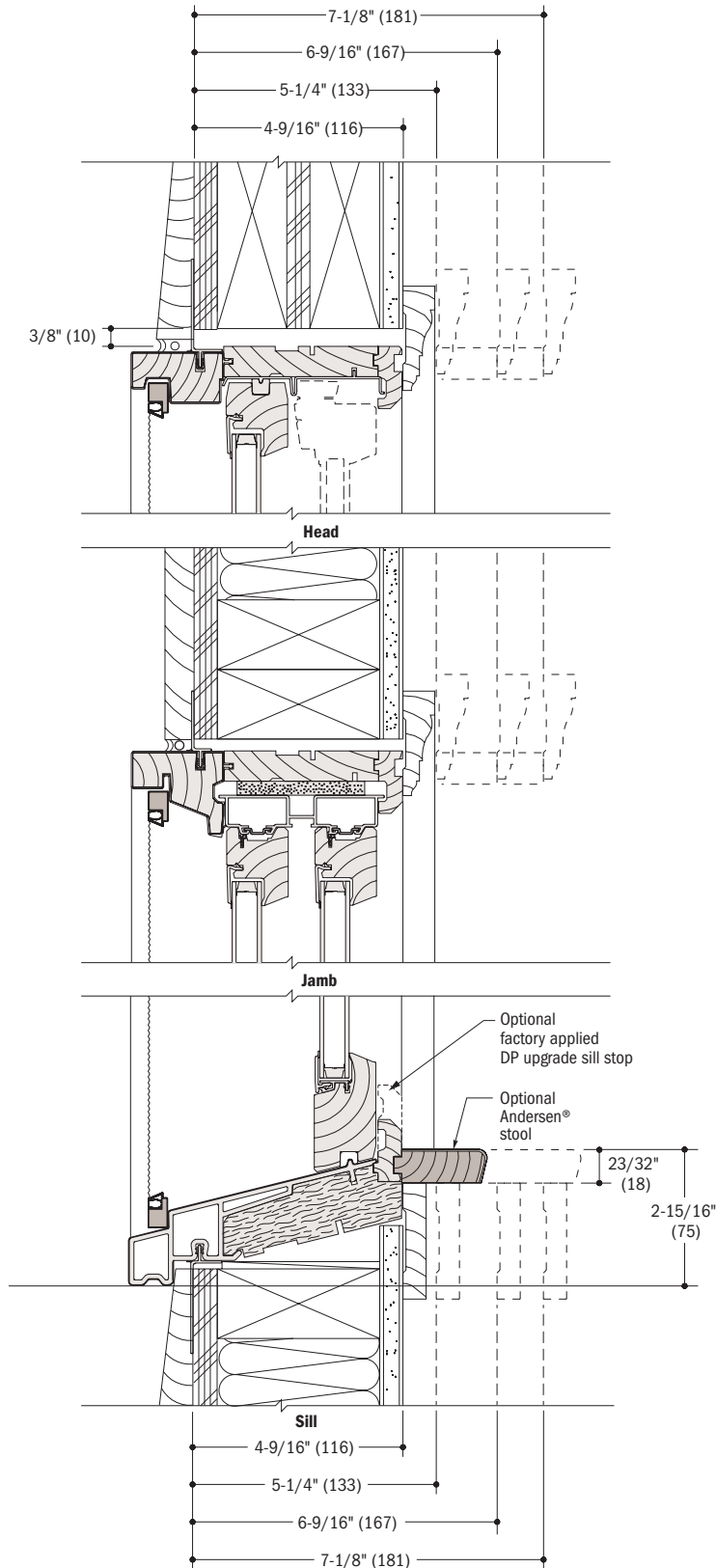

**Extension Jambs**

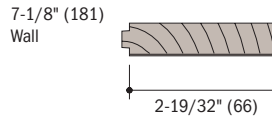
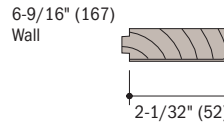
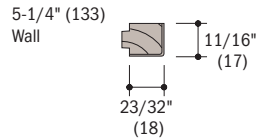

**Stools**

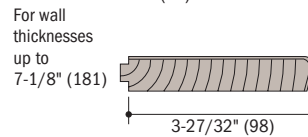
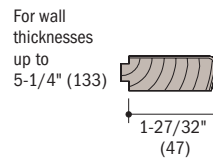

Extension jambs available for 5-1/4" (133), 6-9/16" (167) or 7-1/8" (181) wall thickness. Stools are available for wall thicknesses up to 5-1/4" (133) or 7-1/8" (181) thick. Other wall dimensions can be accommodated with stool and extension jamb modification. Extension jambs are predrilled for easy application (except for 5-1/4" (133) sizes).

**Vertical Section**

**Options / Accessories**

**Stools and Extension Jamb for Double-Hung Picture Units (DHP)**

Scale 3" = 1'-0" (1:4)

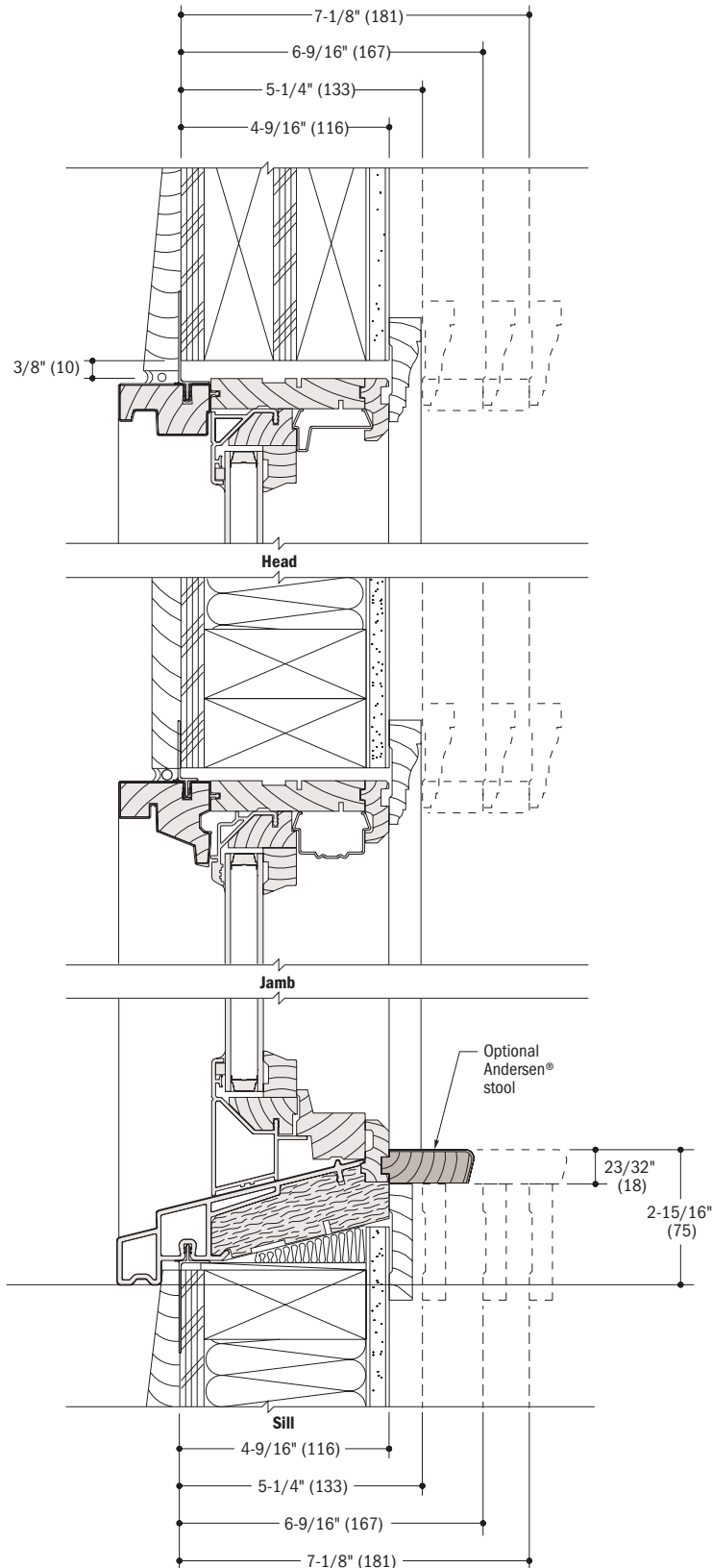

**Extension Jamb**

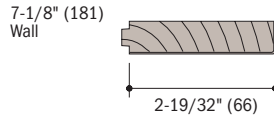
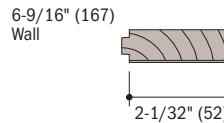
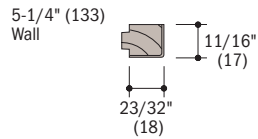

**Stools**

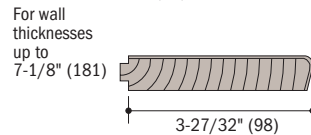
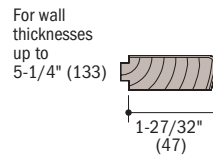

Extension jamb available for 5-1/4" (133), 6-9/16" (167) or 7-1/8" (181) wall thickness. Stools are available for wall thicknesses up to 5-1/4" (133) or 7-1/8" (181) thick. Other wall dimensions can be accommodated with stool and extension jamb modification. Extension jamb are predrilled for easy application (except for 5-1/4" (133) sizes).

**Vertical Section**

Options / Accessories

**Stools and Extension Jamb** for Double-Hung Transom

**Units (DHT)** Scale 3" = 1'-0" (1:4)

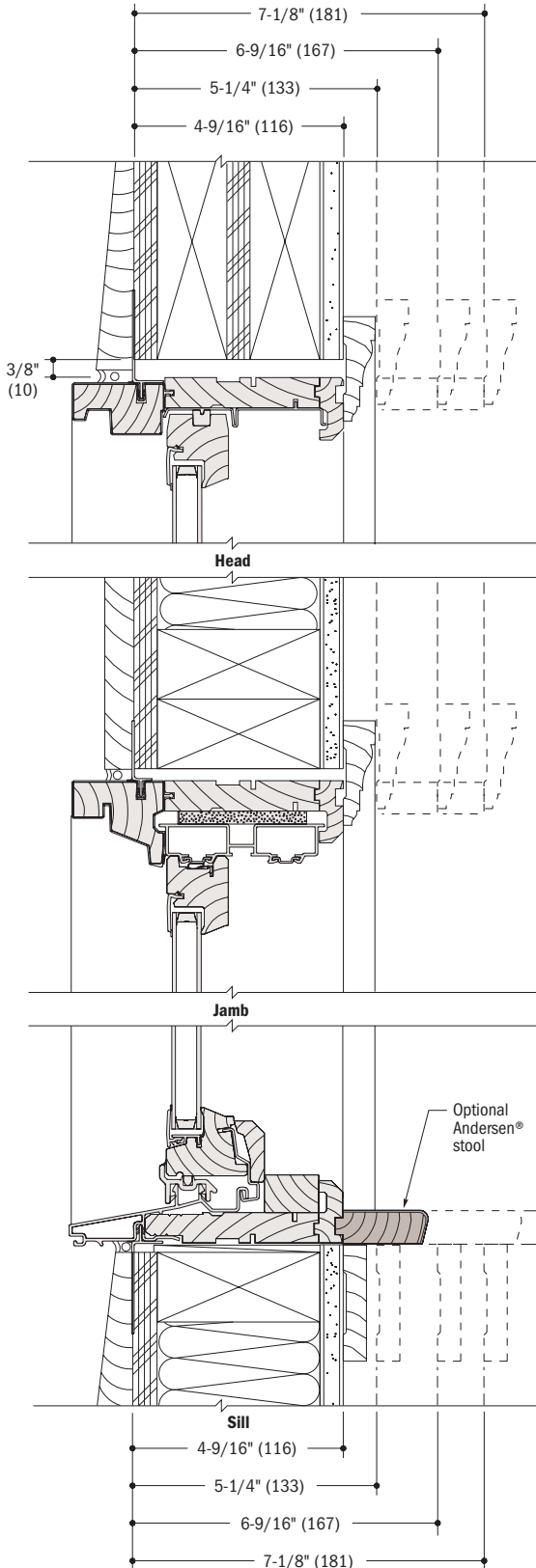

**Vertical Section**

**Extension Jamb**

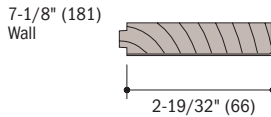
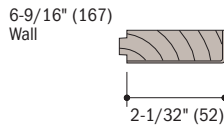
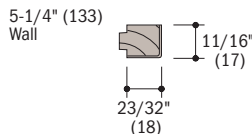

Extension jambs available for 5-1/4" (133), 6-9/16" (167) or 7-1/8" (181) wall thickness. Stools are available for wall thicknesses up to 5-1/4" (133) or 7-1/8" (181) thick. Other wall dimensions can be accommodated with stool and extension jamb modification. Extension jambs are predrilled for easy application (except for 5-1/4" (133) sizes).

**Stools**

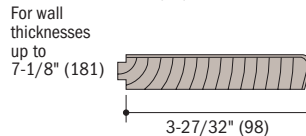
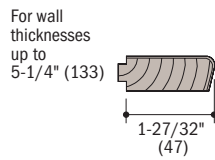

**Combination Unit** Scale 3" = 1'-0" (1:4)  
1-5/16" (33) 4-1/2" (114)

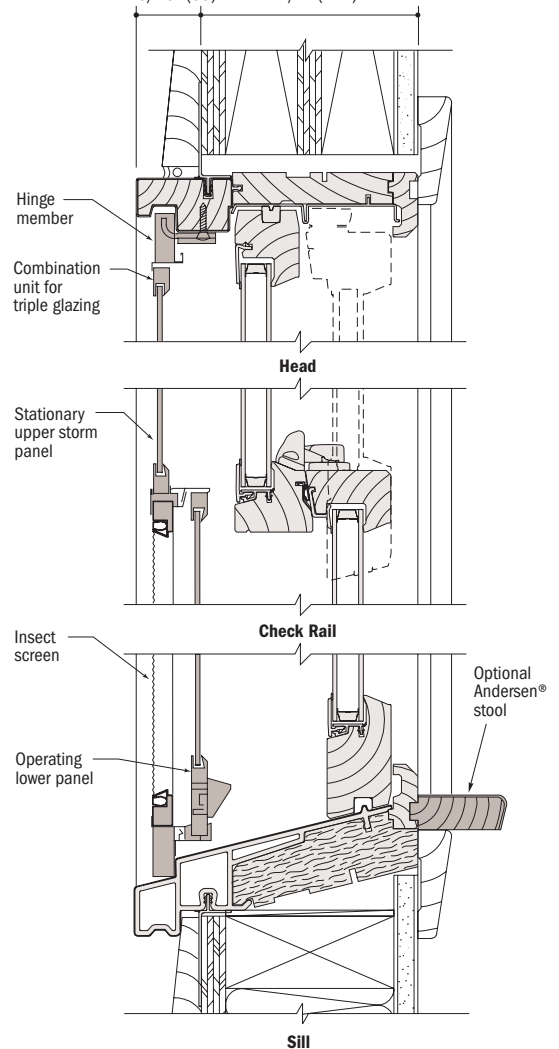

**Vertical Section**

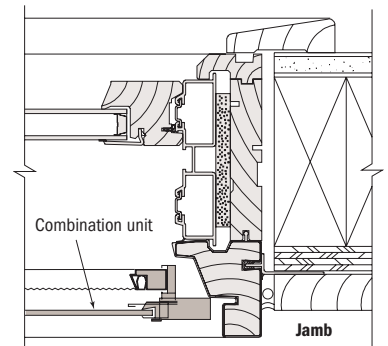

**Horizontal Section**

At Head - Outer frame of combination unit fits into head jamb window unit. Hinges fastened to the exterior of the head jamb enables easy cleaning of the sill.

At Check Rail - Strong aluminum check rail with stationary storm panel, insect screen and lower operating panel.

At Jamb - Storm panel operates on smooth vinyl channels within the side stile frame members. Insect screen is located outside the storm panel.

At Sill - Combination unit frame bottom rail with insect screen in place and operating lower panel in closed position.

Complete unit furnished by Andersen, not applied to window unit.



**Joining Details**

**Tilt-Wash Double-Hung to Tilt-Wash Double-Hung**

Scale 3" = 1'-0" (1:4)

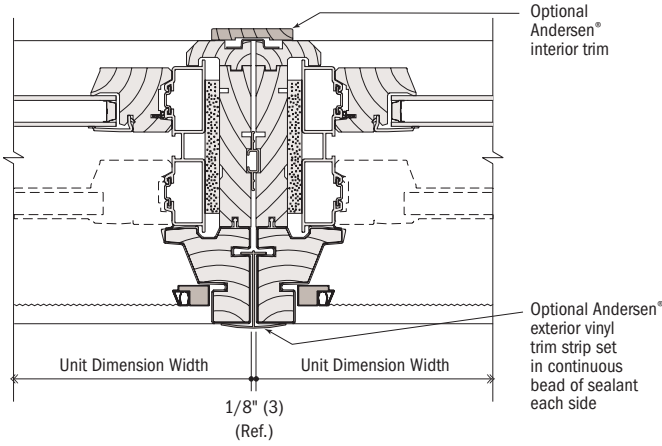

**Non-Reinforced Mullion**

**Double-Hung Picture to Double-Hung Picture**

Scale 3" = 1'-0" (1:4)

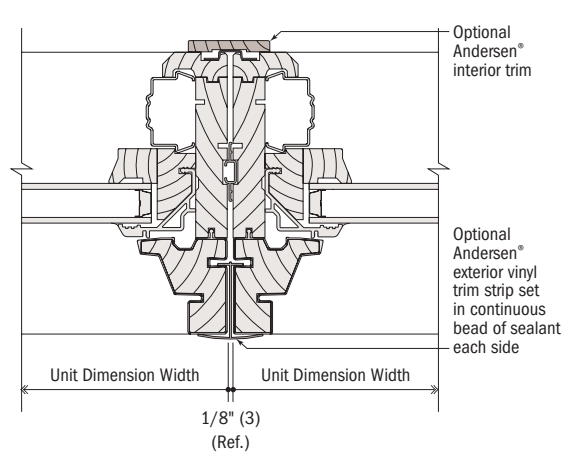

**Non-Reinforced Mullion**

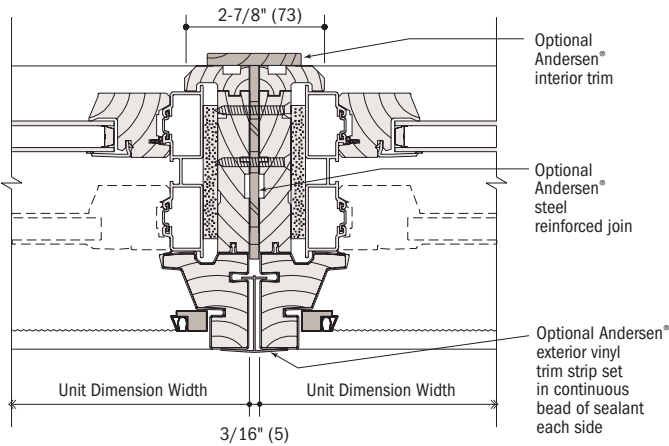

**Steel Reinforced Mullion**

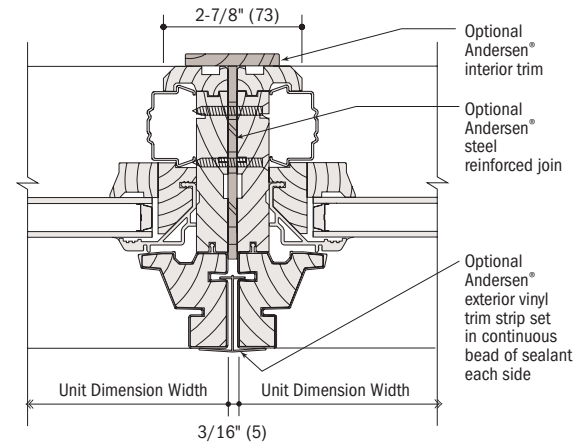

**Steel Reinforced Mullion**

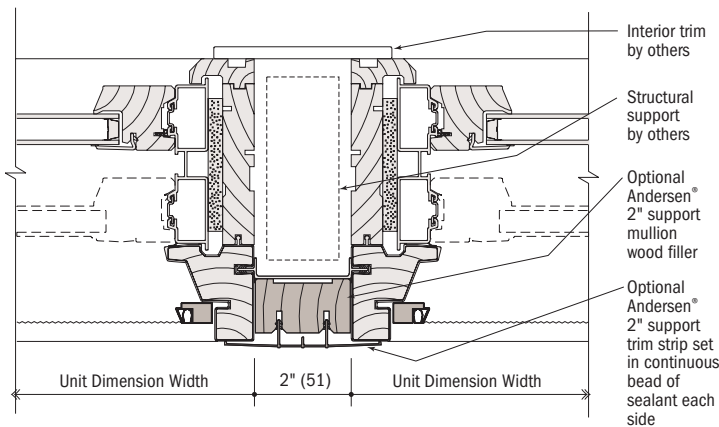

**Support Mullion**

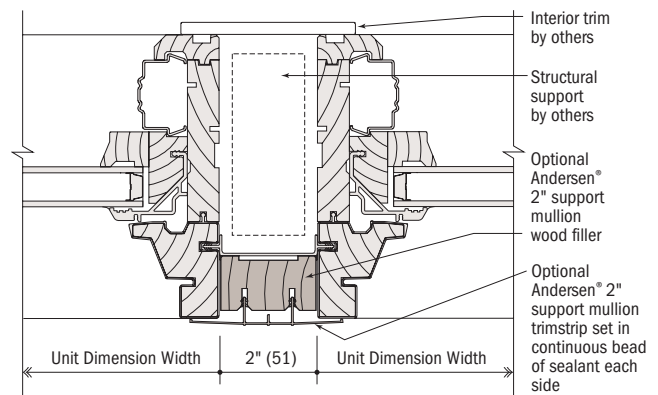

**Support Mullion**

**Joining Compatibility**

Many Andersen® units are designed to be joined with other Andersen units in a variety of non-reinforced and reinforced combinations. Other combination types and joining methods can be viewed in the *Andersen® Product Guide for Professionals*, in Andersen Window Studio® software, and by visiting [www.andersenwindows.com](http://www.andersenwindows.com). Combination designs should always be checked for design pressure performance requirements to ensure the appropriate joining method is specified.

**Joining Details**

**Double-Hung Transom to Double-Hung Transom**

Scale 3" = 1'-0" (1:4)

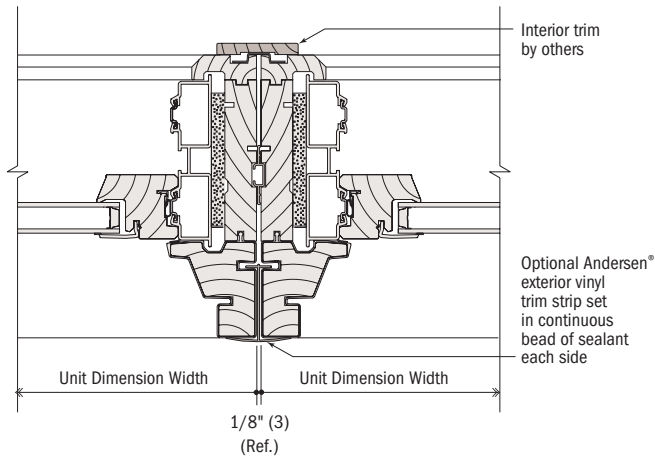

**Non-Reinforced Mullion**

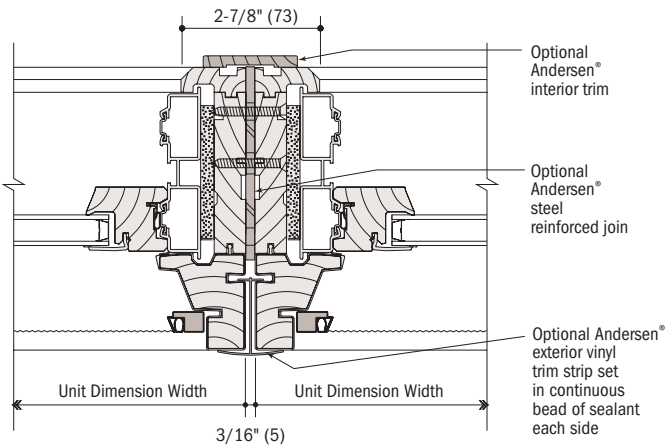

**Steel Reinforced Mullion**

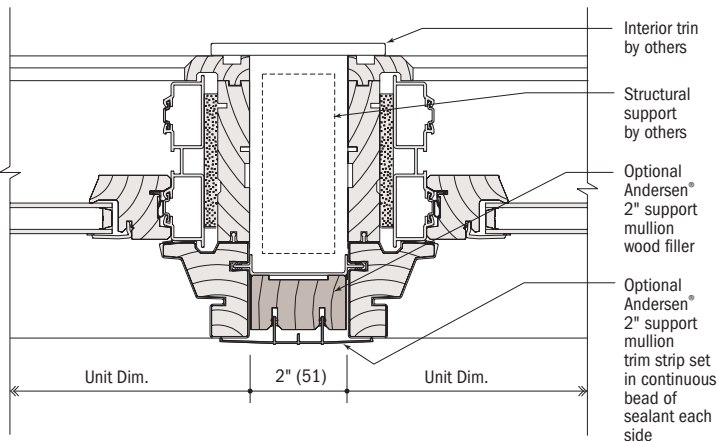

**Support Mullion**

**Joining Compatibility**  
 Many Andersen® units are designed to be joined with other Andersen units in a variety of non-reinforced and reinforced combinations. Other combination types and joining methods can be viewed in the *Andersen® Product Guide for Professionals*, in Andersen Window Studio® software, and by visiting [www.andersenwindows.com](http://www.andersenwindows.com). Combination designs should always be checked for design pressure performance requirements to ensure the appropriate joining method is specified.

**Joining Details**

**Double-Hung Transom (DHT) over Tilt-Wash Double-Hung**

Scale 3" = 1'-0" (1:4)

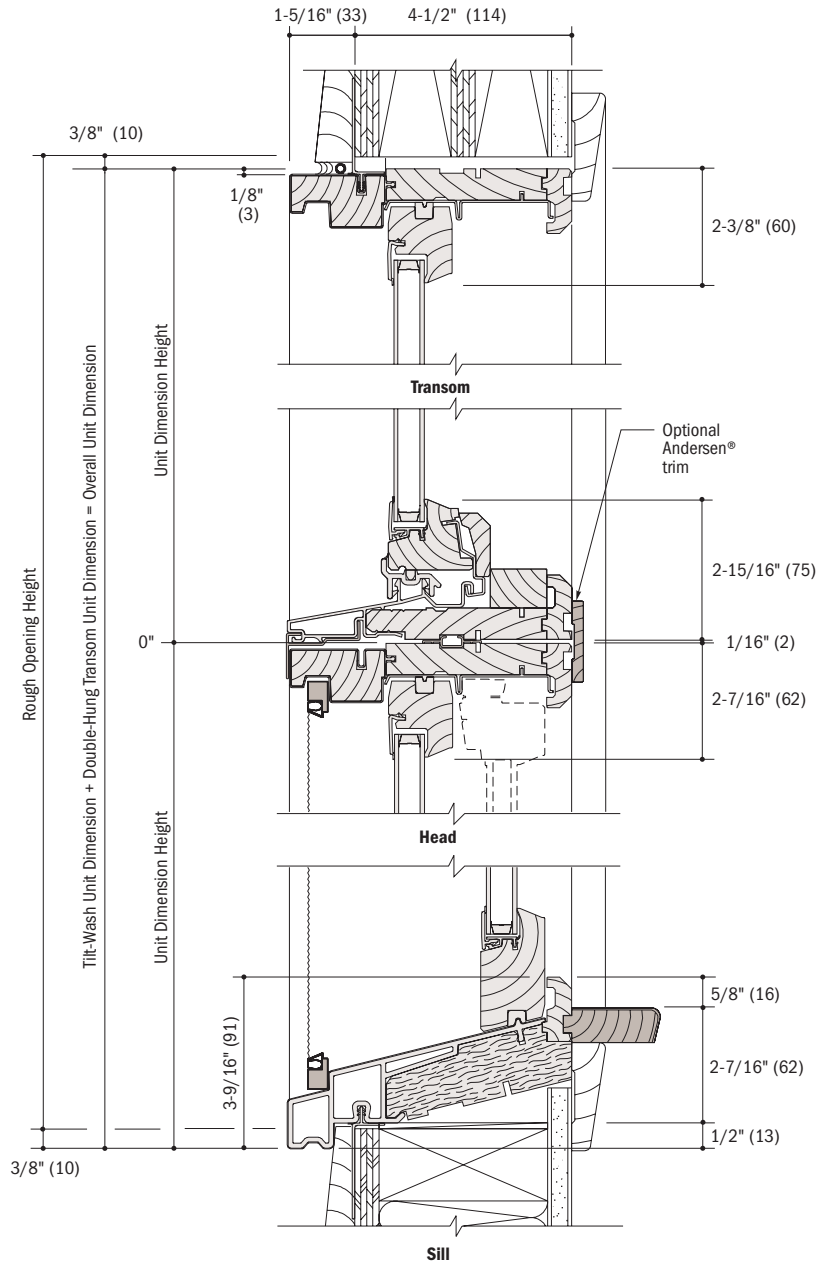

**Vertical Section**

**Anchoring Methods**

**Installation Flange**

Scale 3" = 1'-0" (1:4)

Standard application of installation flanges as shipped from Andersen to be used for 4-1/2" (105) wall construction. Tilt-wash double-hung window is secured in the opening by using threaded fasteners through the installation flange.

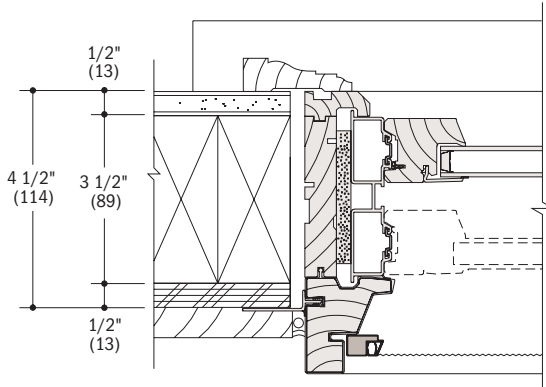

**Standard Installation Flange Reversed**

Scale 3" = 1'-0" (1:4)

Regular installation flange in reverse position to accommodate a 4-1/8" (105) wall.

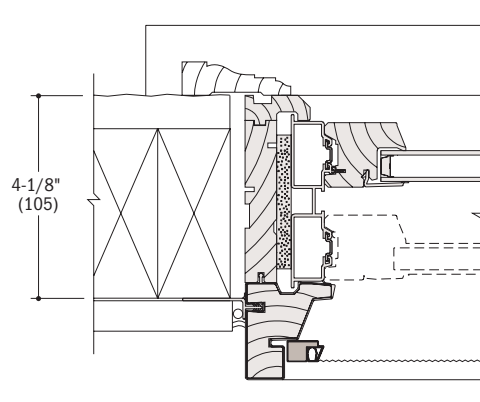

**Jamb Clip**

Scale 3" = 1'-0" (1:4)

Double-hung window unit secured in opening by others using Andersen® 302 stainless steel sheet metal jamb clips and stainless steel screws. Bend the jamb clips to secure unit fit in opening. Installation flange can be cut, or removed, as required to accommodate the jamb clips.

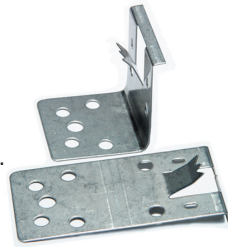

**APPLICATION:**

- First secure jamb clip to back side of window unit jamb(s)
- Apply 1' from corners of head jamb, sill and side jambs
- Space jamb clips evenly (maximum distance apart 32" on center)
- Jamb clip lateral design load capacity: maximum 200 lb.

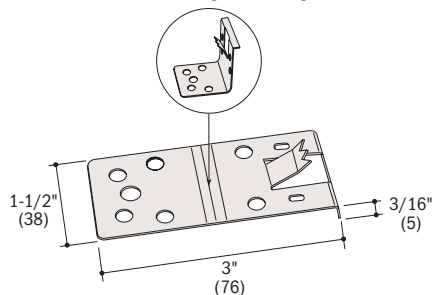
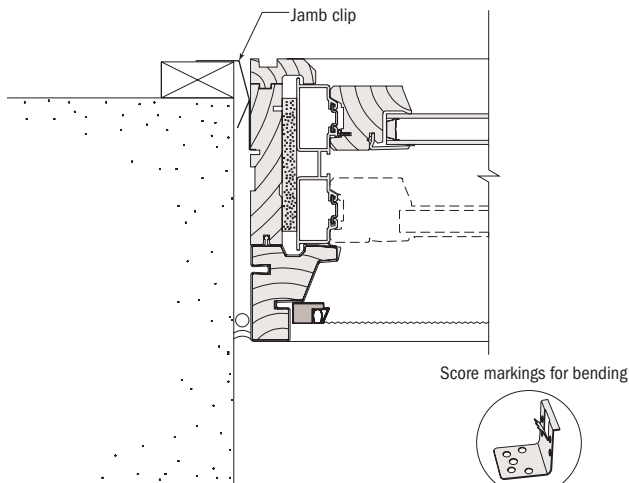

**Threaded Masonry Fastener / Expansion Sleeve**

Scale 3" = 1'-0" (1:4)

Tilt-wash double-hung and double-hung transom (DHT) windows are secured in opening by removing the sash and jamb liners and drilling through the side jamb into the masonry. For double-hung picture (DHP) windows, remove the side jamb liner cover only.

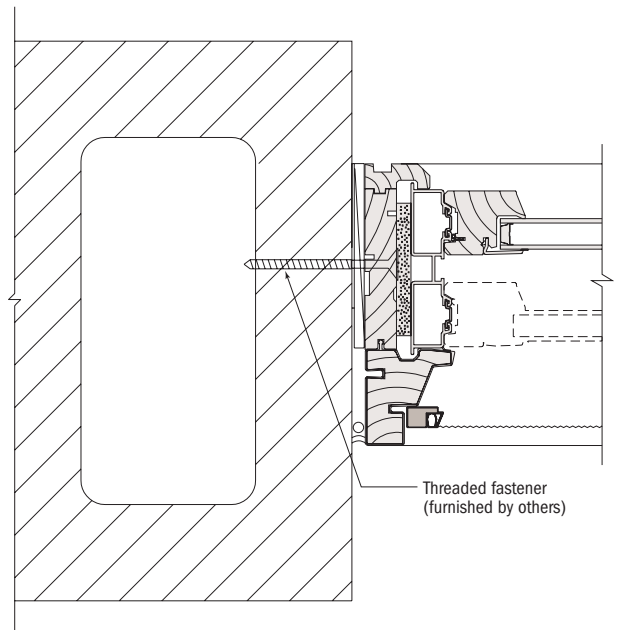

**CAUTION**

Make sure that the unit frame parts do not become bowed when using anchoring methods. Unit will not operate properly if frame parts are stressed.

**Suggested Product Applications**

**Wall Types** Scale 1-1/2" = 1'-0" (1:8)

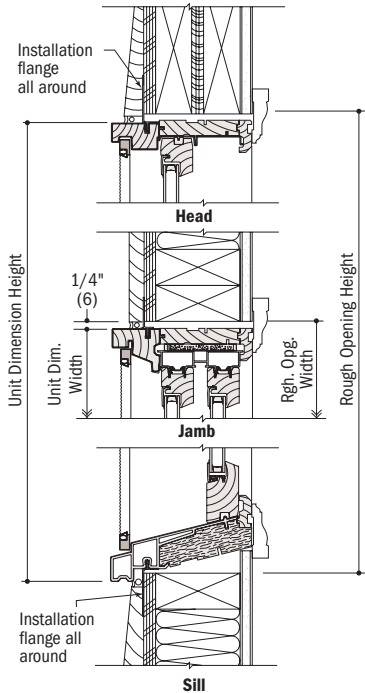

**Vertical Section**

Wood Siding / 2 x 4 Wood Stud Framing

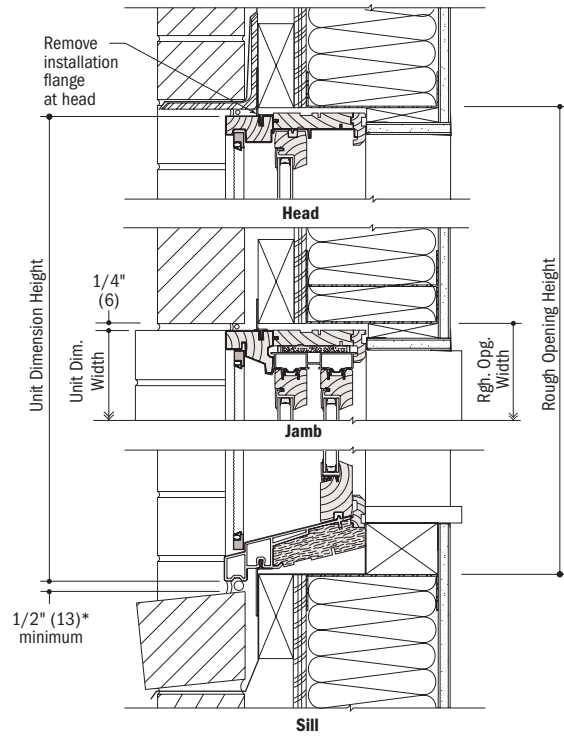

**Vertical Section**

Brick Veneer / 2 x 6 Metal Stud Framing

\*1/2" (13) minimum to accommodate differential shrinkage/expansion when brick is used with wood framing.

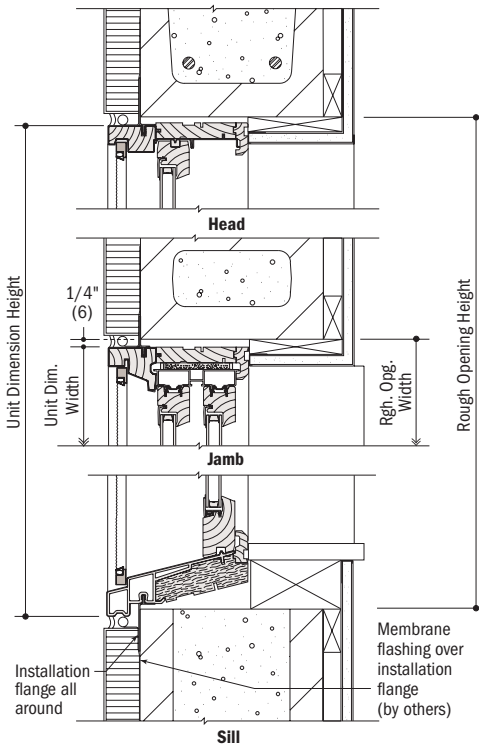

**Vertical Section**

E.I.F.S. / Concrete Masonry Unit (CMU)

**Importance of Proper Installation**

Proper installation and maintenance of Andersen® products are essential if optimum performance is to be fully attained. Written installation instructions which provide guidelines for proper installation are available for Andersen products from your local Andersen supplier or by writing to: Andersen Windows, Inc., Box 12, Bayport, MN 55003 or by visiting our website at [www.andersenwindows.com](http://www.andersenwindows.com). Remember that every installation is different. Andersen strongly recommends consultation with an Andersen product representative and with an experienced contractor, architect, or structural engineer prior to the installation of any Andersen product. Installation of Andersen products, including method of attachment, fastener selection, and code compliance is the sole responsibility of the architect, building owner, contractor, and/or consumer.

**Construction by Others**

Andersen Corporation is not responsible for the design of, conditions in, or performance of, adjacent wall or roof construction beyond the perimeter of the Andersen units. Proper integration of the Andersen units with the weather-repellent system of the building is the responsibility of others.

NOTE: Where E.I.F.S. wall finish is adjacent to window units, contact E.I.F.S. manufacturer for installation instructions, including the use of appropriate flashing, the proper use of sealant and backer rod, and the proper width of sealant joint around the perimeter of the window.

NOTE: Leave adequate clearance between sill and masonry for caulking and dimensional change of framework. Installation flange may be removed where construction sequence/ detailing requires no flange.

**Suggested Product Applications**

**Wall Types**

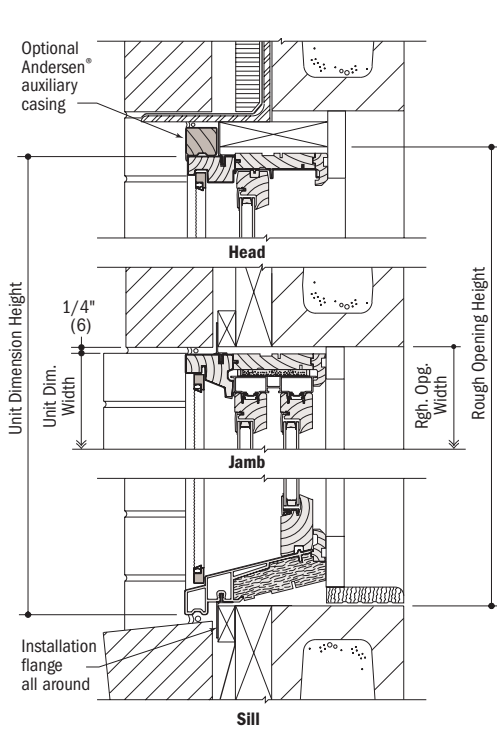

**Vertical Section**

Brick / Concrete Masonry Unit (CMU)

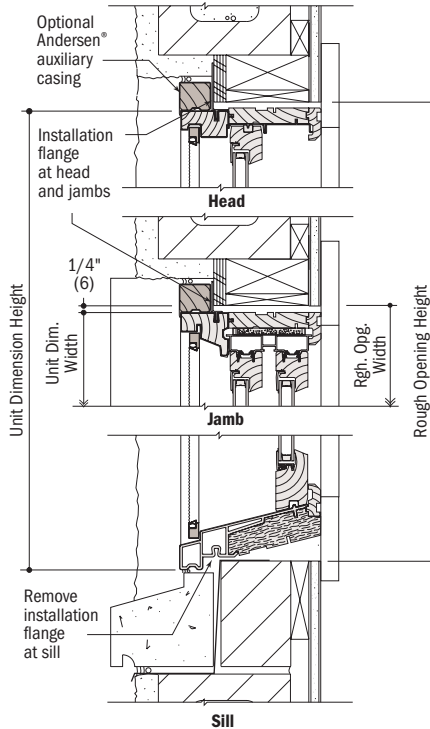

**Vertical Section**

Stucco / Concrete Masonry Unit (CMU) Inset Window

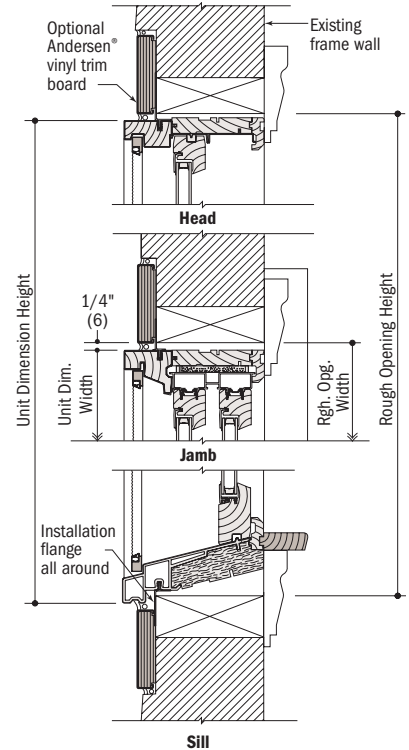

**Vertical Section**

Existing Stud Wall

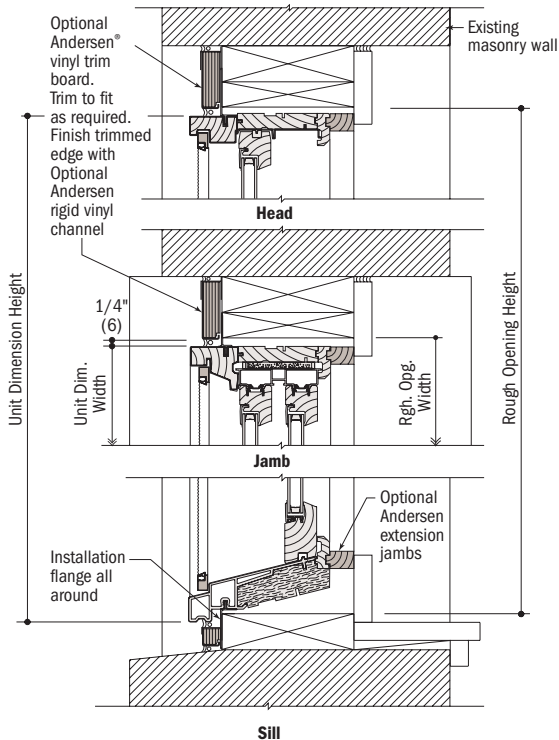

**Vertical Section**

Existing Masonry Wall

**Importance of Proper Installation**

Proper installation and maintenance of Andersen® products are essential if optimum performance is to be fully attained. Written installation instructions which provide guidelines for proper installation are available for Andersen products from your local Andersen supplier or by writing to: Andersen Windows, Inc., Box 12, Bayport, MN 55003 or by visiting our website at [www.andersenwindows.com](http://www.andersenwindows.com). Remember that every installation is different. Andersen strongly recommends consultation with an Andersen product representative and with an experienced contractor, architect, or structural engineer prior to the installation of any Andersen product. Installation of Andersen products, including method of attachment, fastener selection, and code compliance is the sole responsibility of the architect, building owner, contractor, and/or consumer.

**Construction by Others**

Andersen Corporation is not responsible for the design of, conditions in, or performance of, adjacent wall or roof construction beyond the perimeter of the Andersen units. Proper integration of the Andersen units with the weather-repellent system of the building is the responsibility of others.

NOTE: Where E.I.F.S. wall finish is adjacent to window units, contact E.I.F.S. manufacturer for installation instructions, including the use of appropriate flashing, the proper use of sealant and backer rod, and the proper width of sealant joint around the perimeter of the window.

NOTE: Leave adequate clearance between sill and masonry for caulking and dimensional change of framework. Installation flange may be removed where construction sequence/ detailing requires no flange.