

UTILITY NOTES:

ALL NEW INSTALLATION OF SEWER CONNECTIONS AND STRUCTURES WILL HAVE TO BE PRESSURE TESTED PRIOR TO OCCUPANCY. THE SEWER SERVICES AND WATER SERVICES TO BE COMPLETELY REMOVED FROM THE MAINS TO THE EXISTING DWELLING AND PROPERTY...

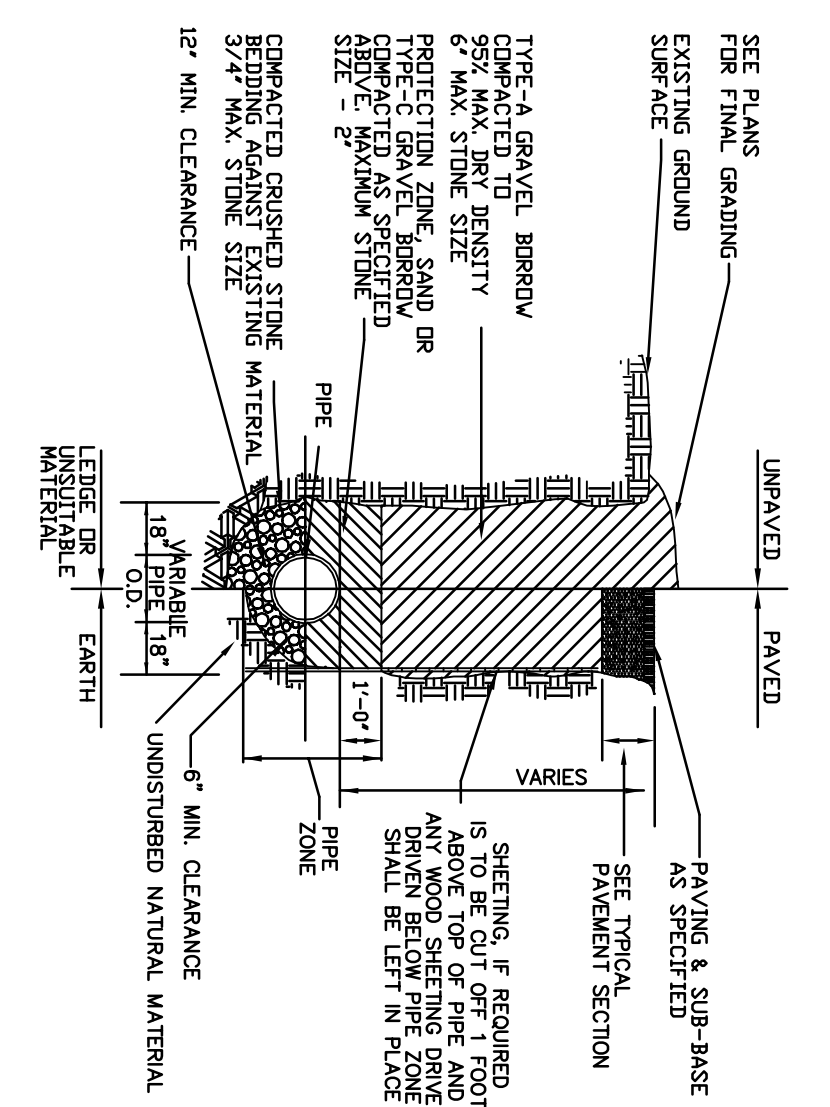

TYPICAL P.V.C. DRAIN TRENCH DETAIL

- 1. GRAVEL BORROW SHALL CONFORM TO MASS HIGHWAY SPECIFICATION M.03.0. 2. CRUSHED STONE BEDDING SHALL CONFORM TO MASS HIGHWAY SPECIFICATION M.20.1.1.

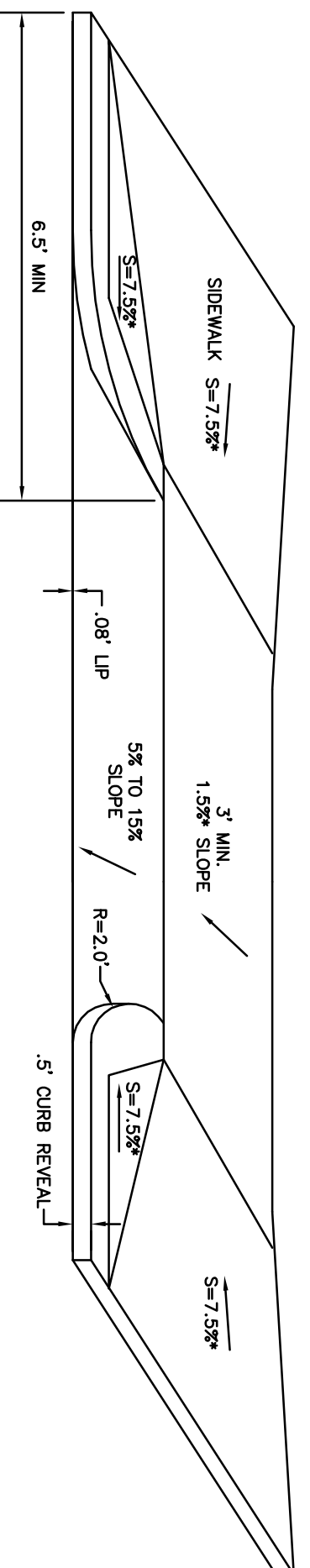

THROUGH SIDEWALK DRIVEWAYS W/ CURB RETURNS DETAIL

- ITEM NO. T7-500PC STANDARD 6,000LBS ITEM NO. T7-500PH H-20 6,000LBS 1) CONCRETE 4,000PSI MINIMUM AFTER 28 DAYS 2) DESIGN CONFORMS WITH 310 OR 15,000 DEP TITLE 5 REGS. FOR PUMP CHAMBERS 3) ALL REINFORCEMENT PER ASTM C1277-93 4) ALSO AVAILABLE IN H-20 LOADING 5) JOINT SEALED WITH BUTYL RESIN 6) PUMPS AND ACCESSORIES OPTIONAL.

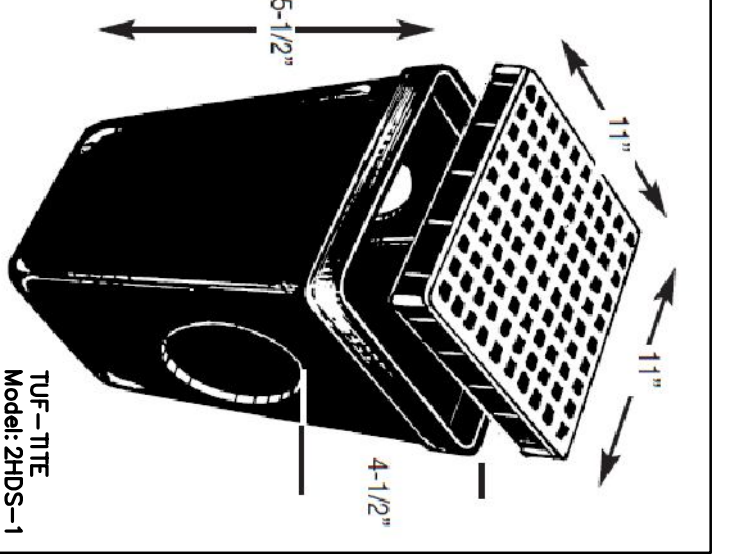

AREA DRAIN DETAIL

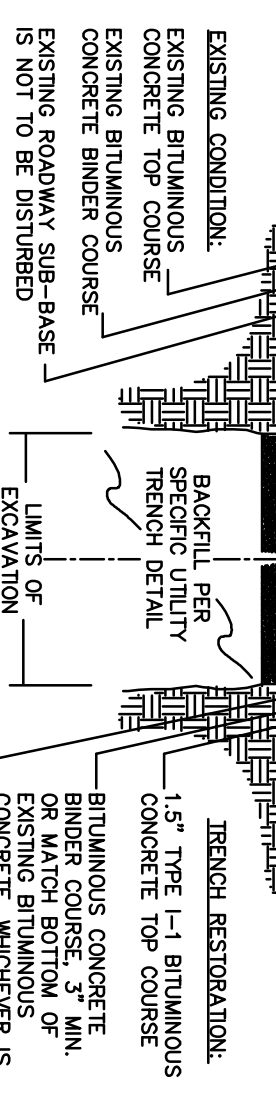

TYPICAL PRECAST CONCRETE CATCH BASIN WITH GAS TRAP

NOTE: ALL CATCH BASINS SHALL MEET THE REQUIREMENTS OF PUBLIC WORKS DEPARTMENT OF THE CITY OF NEWTON TO GRANITE CURBING MUST RECEIVE GRANITE THROAT STUDS.

TYPICAL TRENCH REPAIR & PAVEMENT SECTION DETAIL (1/2)

- 1. ALL INSTALLATION AND MATERIAL SPECIFICATIONS PER MASS HIGHWAY DEPARTMENT STANDARD SPECIFICATIONS FOR HIGHWAYS AND BRIDGES, 1988 AS AMENDED. 2. FOUNDATION SHALL BE INSTALLED TO BE TACKED PER WID PROUR TO NEW BITUMINOUS CONCRETE. 3. ALL EXPOSED JOINTS ARE TO BE SEALED WITH TACK AND STONE DUST. 4. ANY TOP COURSE APPLIED AT A WIDTH OF 6\"/>

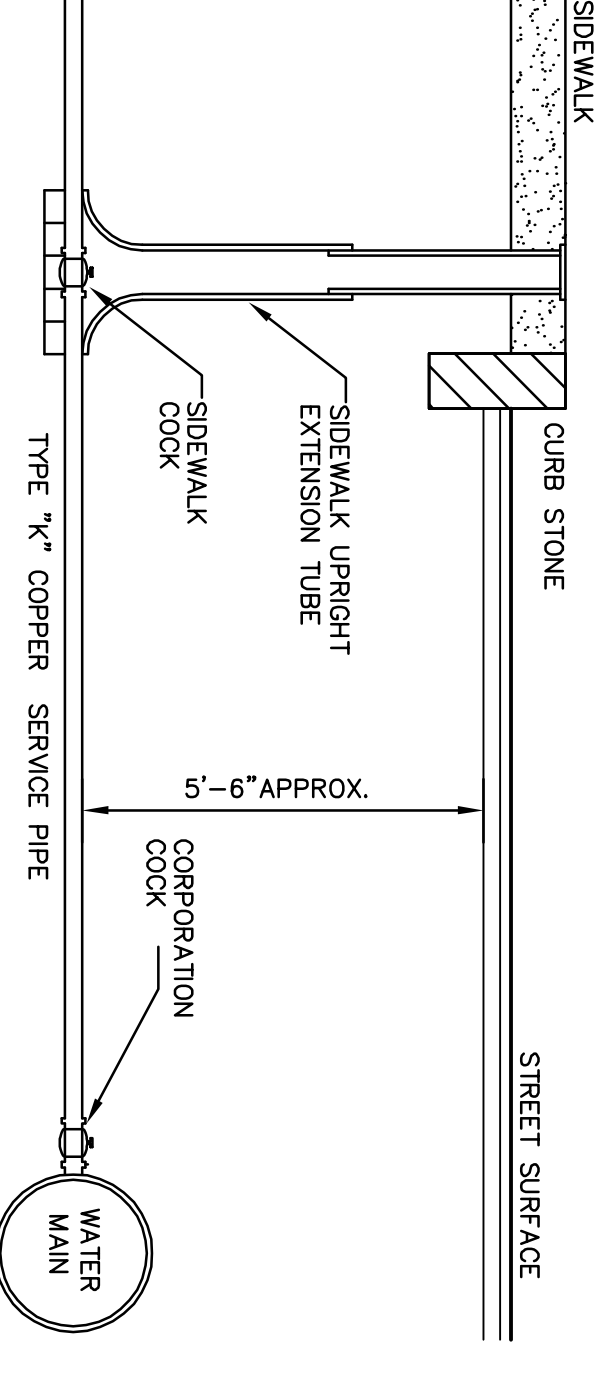

WATER CONNECTION 1\"/>

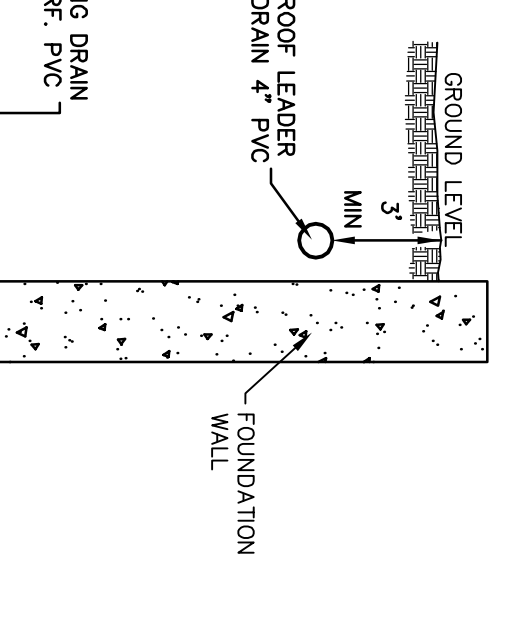

FOUNDATION DRAIN

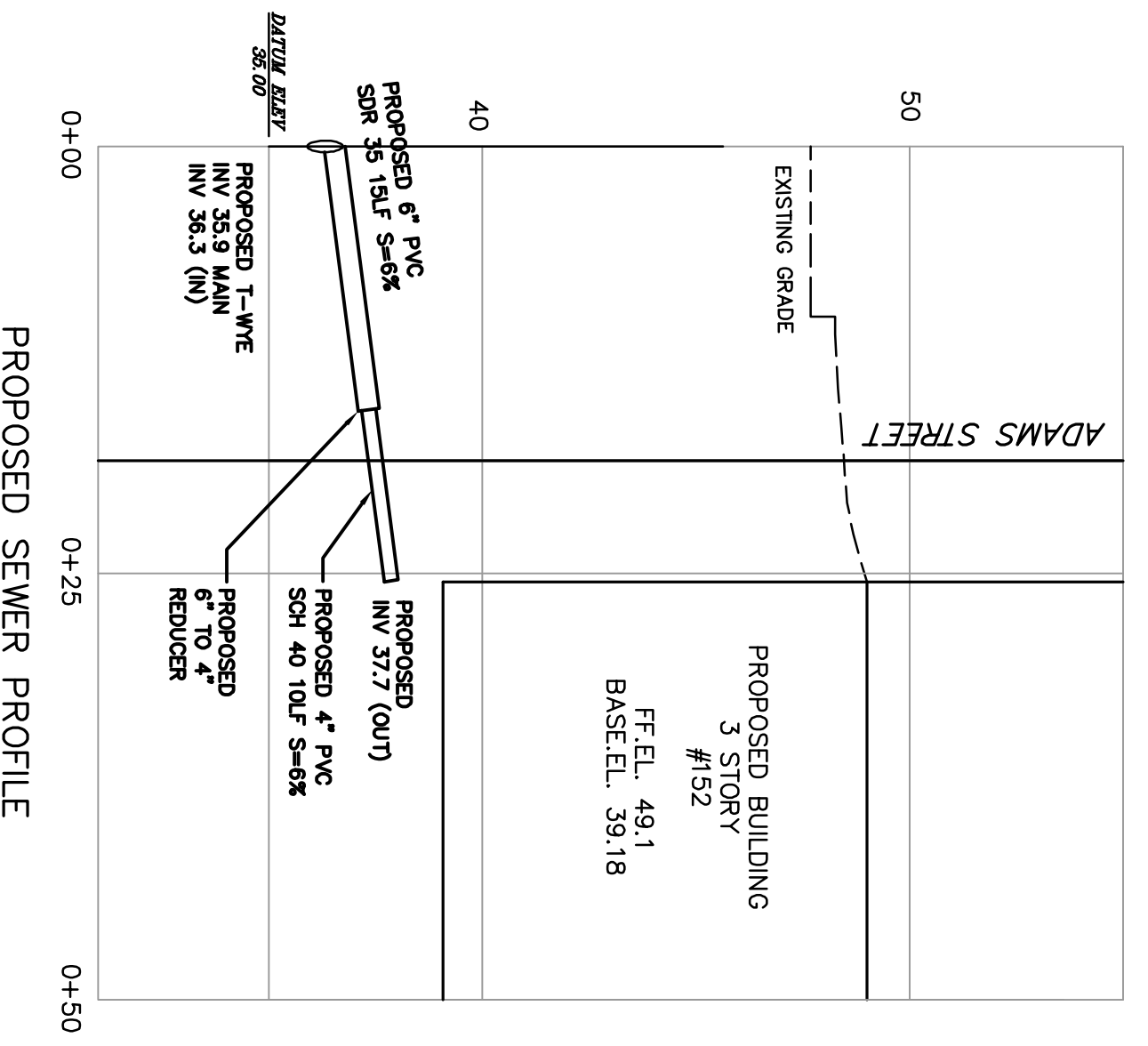

PROPOSED SEWER PROFILE

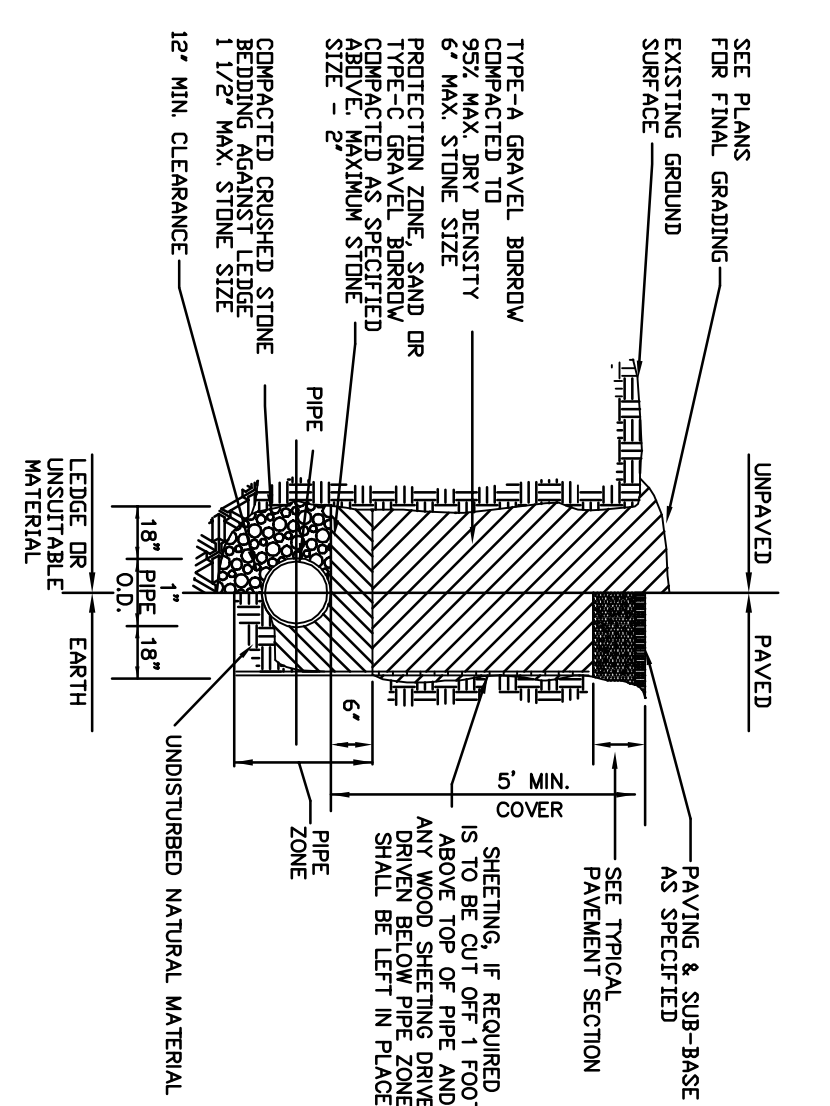

TYPICAL WATER TRENCH DETAIL

- 1. GRAVEL BORROW SHALL CONFORM TO MASS HIGHWAY SPECIFICATION M.03.0. 2. CRUSHED STONE BEDDING SHALL CONFORM TO MASS HIGHWAY SPECIFICATION M.20.1.1.

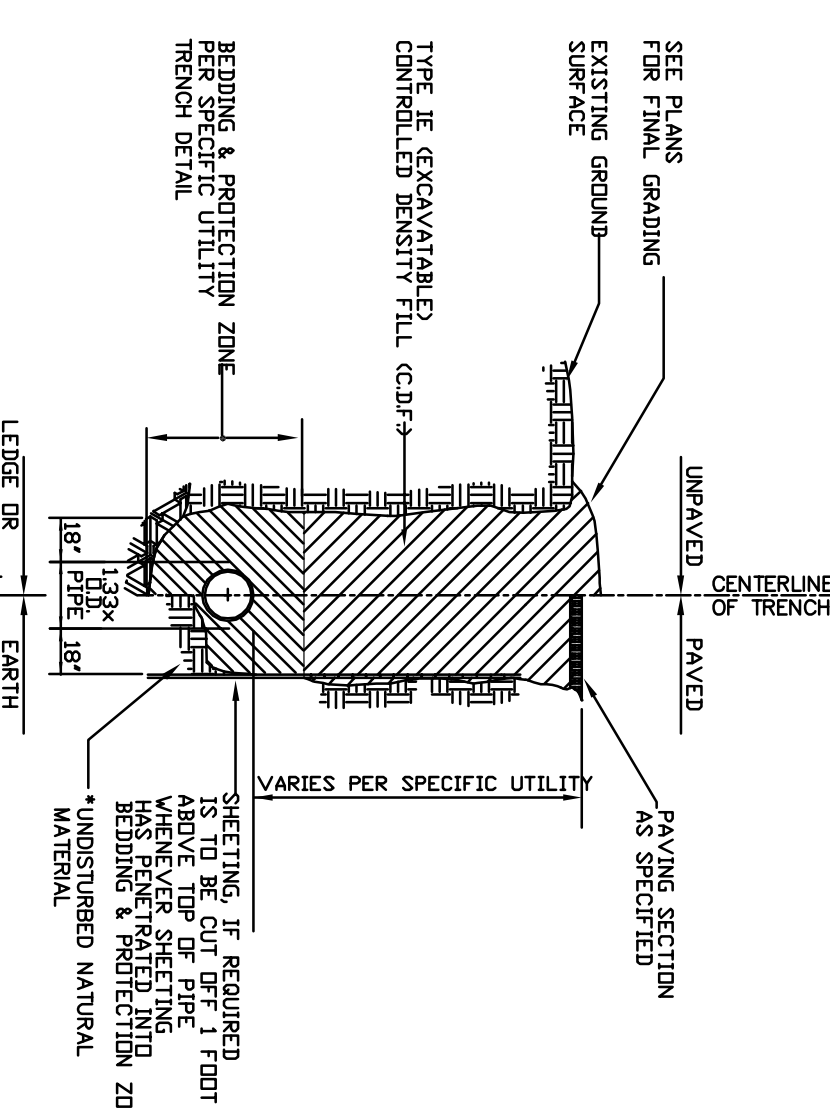

TYPICAL C.D.F. TRENCH DETAIL

- 1. GRAVEL BORROW SHALL CONFORM TO MASS HIGHWAY SPECIFICATION M.03.0. 2. CRUSHED STONE BEDDING SHALL CONFORM TO MASS HIGHWAY SPECIFICATION M.20.1.1.

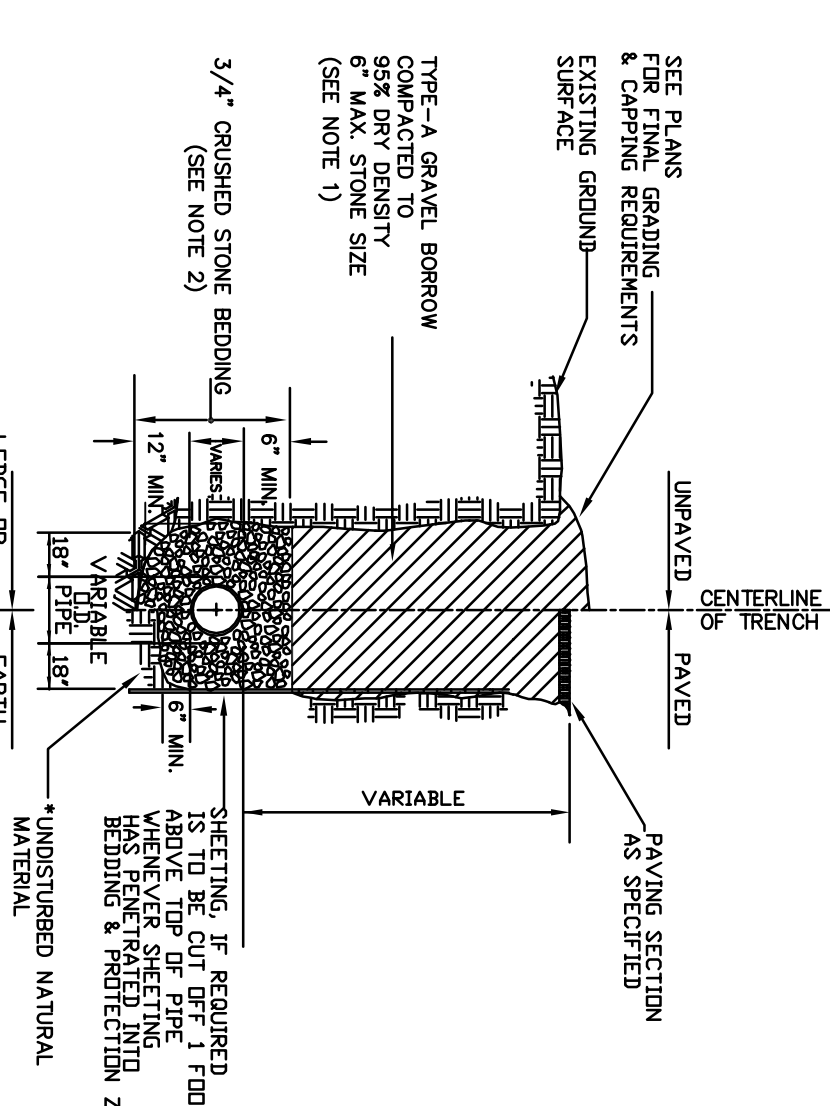

GRAVITY SEWER TRENCH DETAIL

- 1. GRAVEL BORROW SHALL CONFORM TO MASS HIGHWAY SPECIFICATION M.03.0. 2. CRUSHED STONE BEDDING SHALL CONFORM TO MASS HIGHWAY SPECIFICATION M.20.1.1.

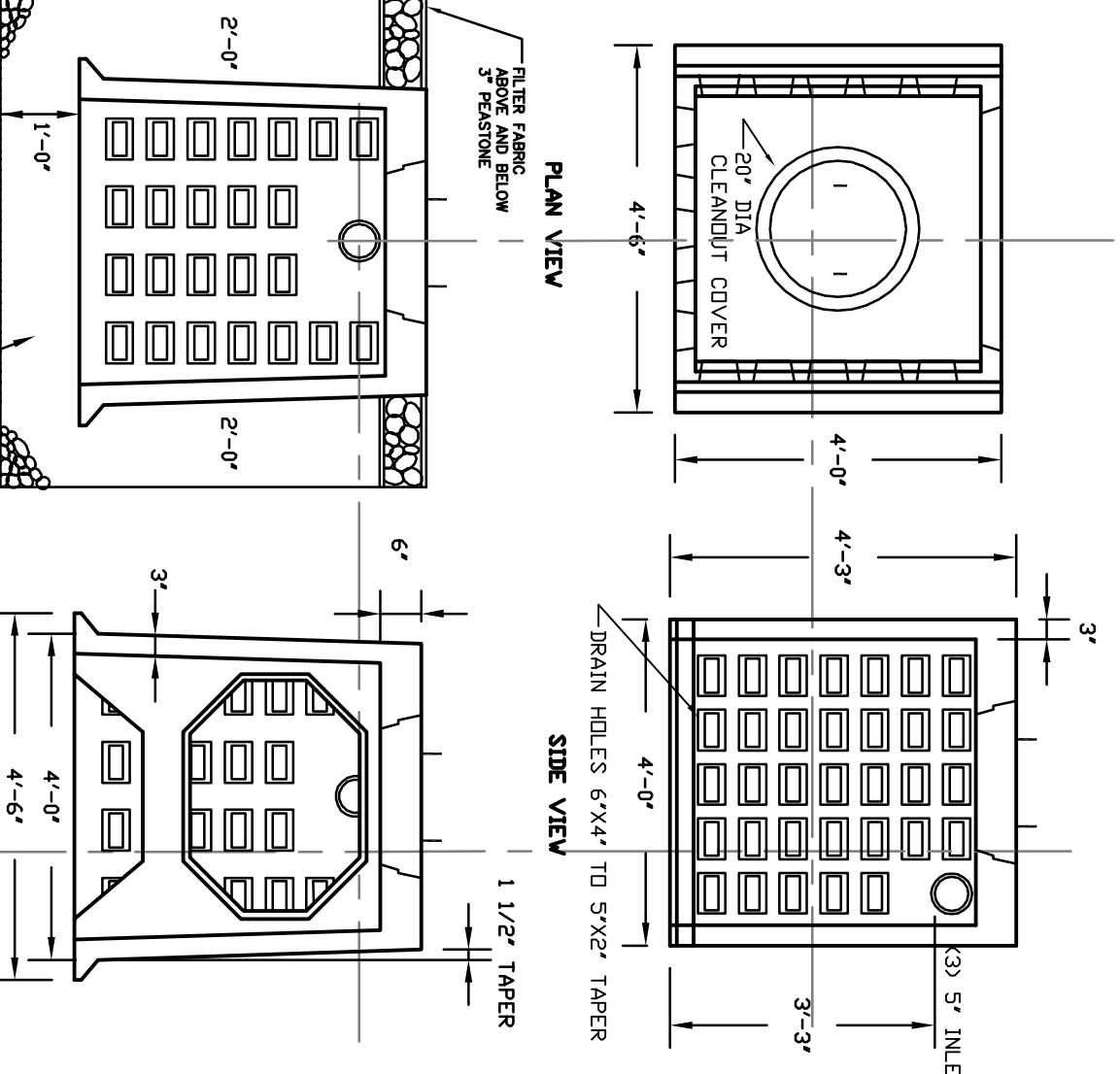

GALLEY-END SECTION

- 1. CONCRETE 4,000 PSI MINIMUM AFTER 28 DAYS. 2. ALSO AVAILABLE IN H-20 LOADING. 3. SECTIONS AVAILABLE WITHOUT 2\"/>

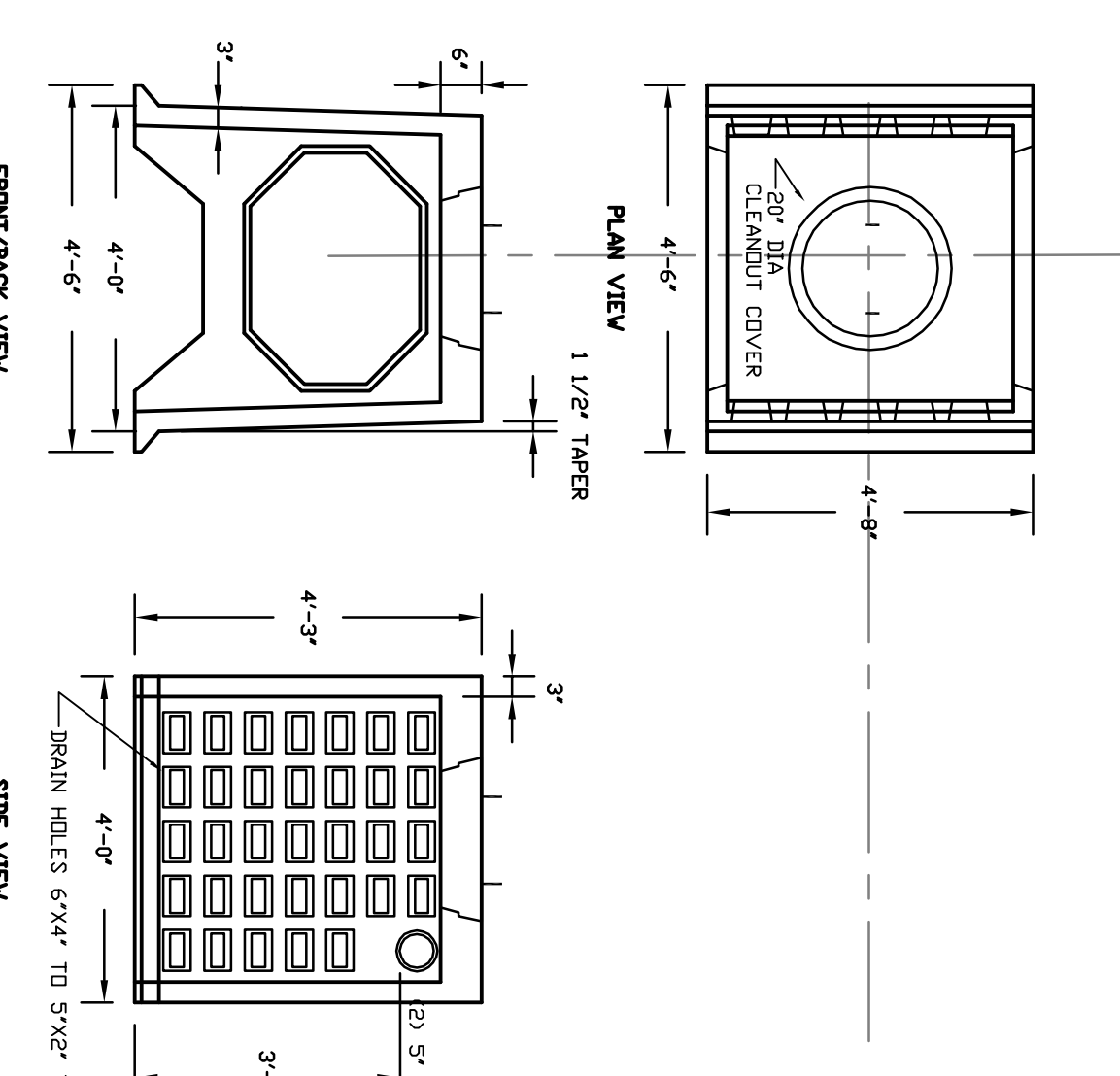

GALLEY-CENTER SECTION

- 1. CONCRETE 4,000 PSI MINIMUM AFTER 28 DAYS. 2. ALSO AVAILABLE IN H-20 LOADING. 3. SECTIONS AVAILABLE WITHOUT 2\"/>

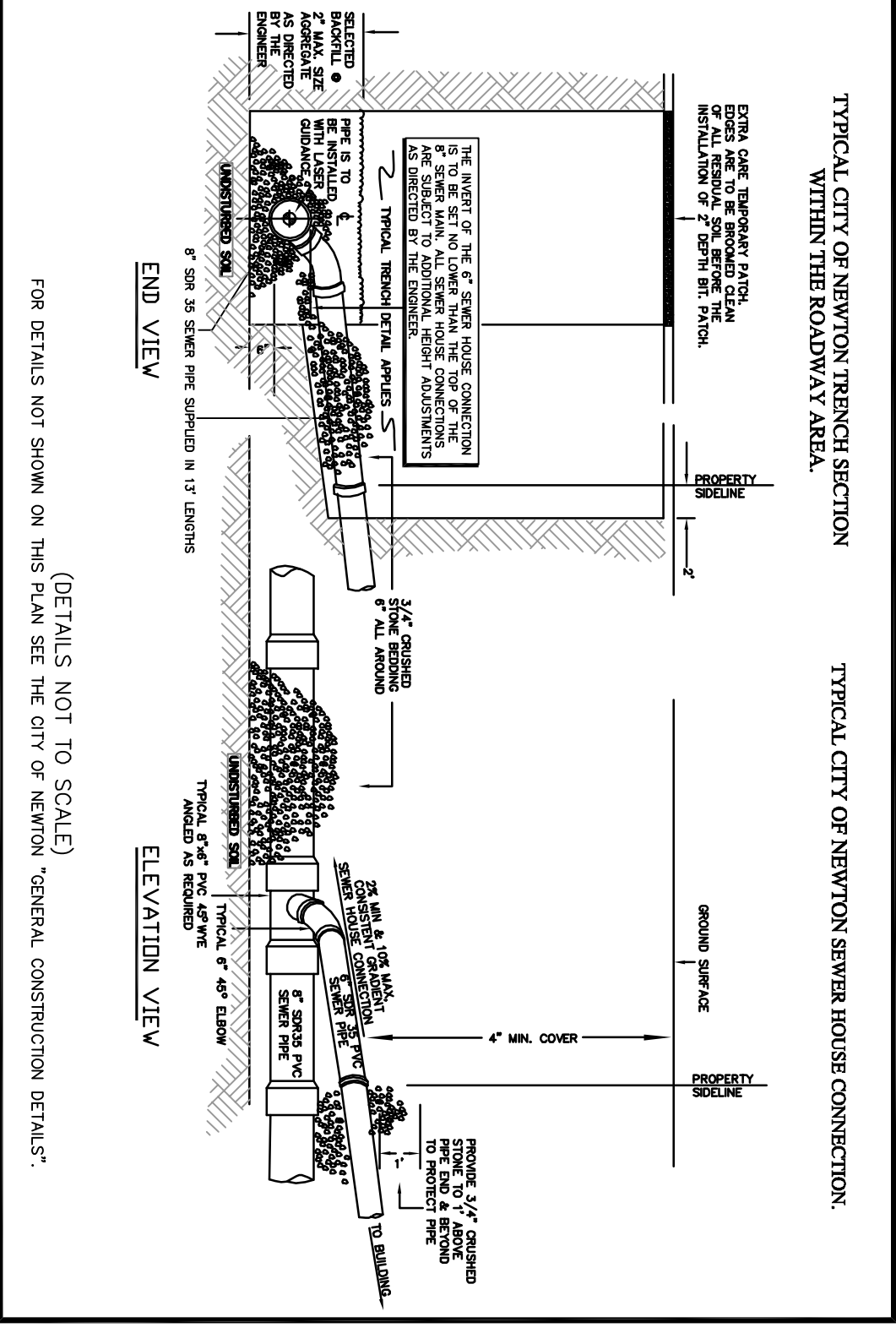

TYPICAL CITY OF NEWTON TRENCH SECTION WITHIN THE ROADWAY AREA.

FOR DETAILS NOT SHOWN ON THIS PLAN SEE THE CITY OF NEWTON GENERAL CONSTRUCTION DETAILS.

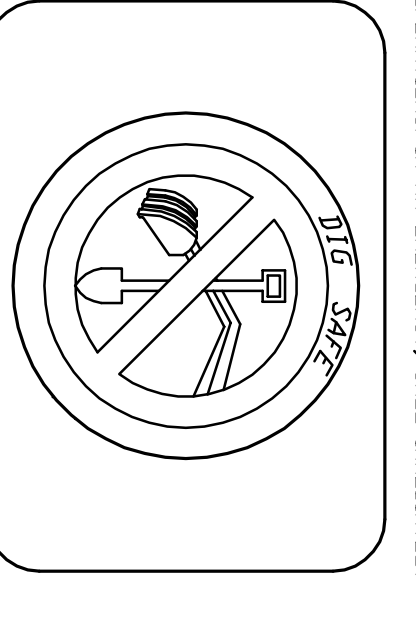

DIG SAFE

BEFORE YOU EXCAVATE THE DIG SAFE CENTER TO PREVENT DAMAGE TO TELEPHONE, GAS OR ELECTRIC UNDERGROUND FACILITIES...

DETAIL SHEET NEWTON, MASSACHUSETTS SHOWING PROPOSED CONDITIONS AT #152 ADAMS STREET DATE: AUGUST 29, 2012 PROJECT: 206124

VTP ASSOCIATES INC. LAND SURVEYORS - CIVIL ENGINEERS 132 ADAMS STREET 2ND FLOOR NEWTON, MA 02458 (617) 332-8271