

253 LEASABLE SPACES FOR THIRD PARTY USER

243 LEASABLE SPACES AT TOP LEVEL FOR THIRD PARTY USER

SEE SHEETS C-1 FOR SITE PLANS

PARKING AREA	EXISTING SPACES	PROPOSED MALL SPACES	PROPOSED LEASED SPACES
EXISTING GARAGE PARKING ABOVE GRADE	711	468	243
ON GRADE PARKING	1,405	1,152	253
TOTAL PARKING PROPOSED (INCLUDING 36 HANDICAP ACCESSIBLE SPACES)	2,116	1,620	496

LEGEND

- PEDESTRIAN ACCESS/BICYCLE ROUTE
- BICYCLE ROUTE
- NOTICE PANEL

	REQUIRED	EXISTING	PROPOSED
LOT AREA	10,000 SF	939,546 SF	939,546 SF
FRONTAGE	80 FT	1,635 FT	1,635 FT
FRONT YARD	10 FT	82.42 FT	82.42 FT
SIDE YARD	24.54 FT	1.69 FT	1.69 FT
REAR YARD	24.54 FT	64.61 FT	64.61 FT
F.A.R.	1.0	0.842	0.842
HEIGHT	24 FT, 36 FT (W/SPECIAL PERMIT)	49.08 FT	49.08 FT
STORIES	3 (W/SPECIAL PERMIT)	3	3

	REQUIRED	EXISTING	PROPOSED
LOT AREA	10,000 SF	324,691 SF	324,691 SF
FRONTAGE	80 FT	485.86 FT	485.86 FT
FRONT YARD	10 FT	66.30 FT	66.30 FT
SIDE YARD	0 FT	0 FT	0 FT
REAR YARD	19.09 FT	98.26 FT	98.26 FT
F.A.R.	1.0	0.704	0.704
HEIGHT	24 FT, 36 FT (W/SPECIAL PERMIT)	38.18 FT	38.18 FT
STORIES	3 (W/SPECIAL PERMIT)	2	2

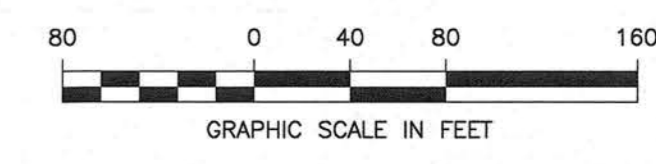

Date	Revision	No.
04/25/18	REVISION	
04/09/18	ISSUED FOR SPECIAL PERMIT	
02/22/18	ISSUED FOR ZONING REVIEW	
06/04/13	ADDED HP ACCESSIBLE STALLS	
04/07/13	ADDED VESTIBULE	
11/27/12	REMOVED PER LAND USE COMMITTEE COMMENTS	
10/02/12	ISSUED FOR SPECIAL PERMIT AND SITE PLAN APPROVAL	
08/09/12	ISSUED FOR PRELIMINARY CITY REVIEW	

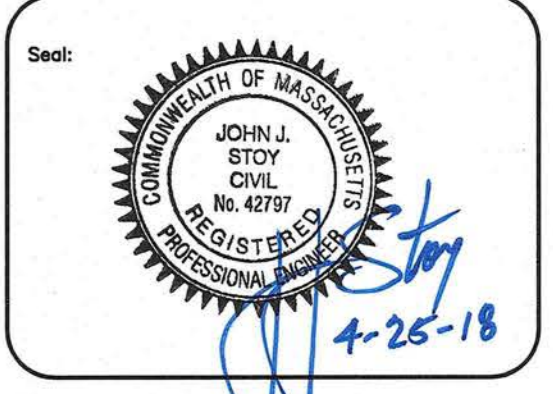

Designed by: SPG
 Drawn by: BMS
 Checked by: SPG
 Scale: 1"=80'
 Date: 08/09/2012

Prepared for:
MALL AT CHESTNUT HILL, LLC
 199 BOYLSTON STREET
 CHESTNUT HILL, MA 02167

Prepared by:
RJO'CONNELL & ASSOCIATES, INC.
 CIVIL ENGINEERS, SURVEYORS & LAND PLANNERS
 80 MONTVALE AVE
 STONEHAM, MA 02180
 781-279-0180
 FAX: 781-279-0173

Project Name:
THE MALL AT CHESTNUT HILL NEWTON, MA

Drawing Name:
OVERALL SITE PLAN

Drawing No.:
OSP-1
 Project No.: 18003

Drawing name: C:\VA\Newton\Simon\The Mall At Chestnut Hill\Main\00A\18003_OSP-1 OVERALL SITE PLAN.dwg
 Apr 30, 2018 15:48pm

Drawing name: C:\Users\simon\OneDrive\Documents\The Mall At Chestnut Hill\ADA\18003_C-1 SITE PLAN BLOW UP.dwg
Apr 26, 2018 - 13:10pm

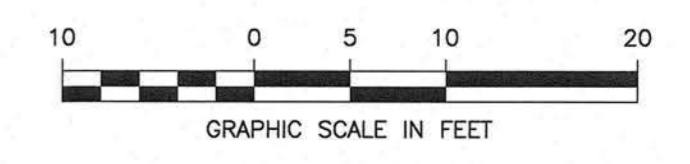
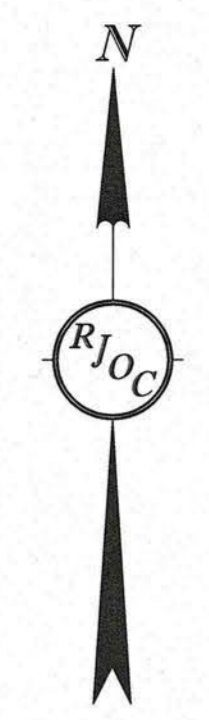
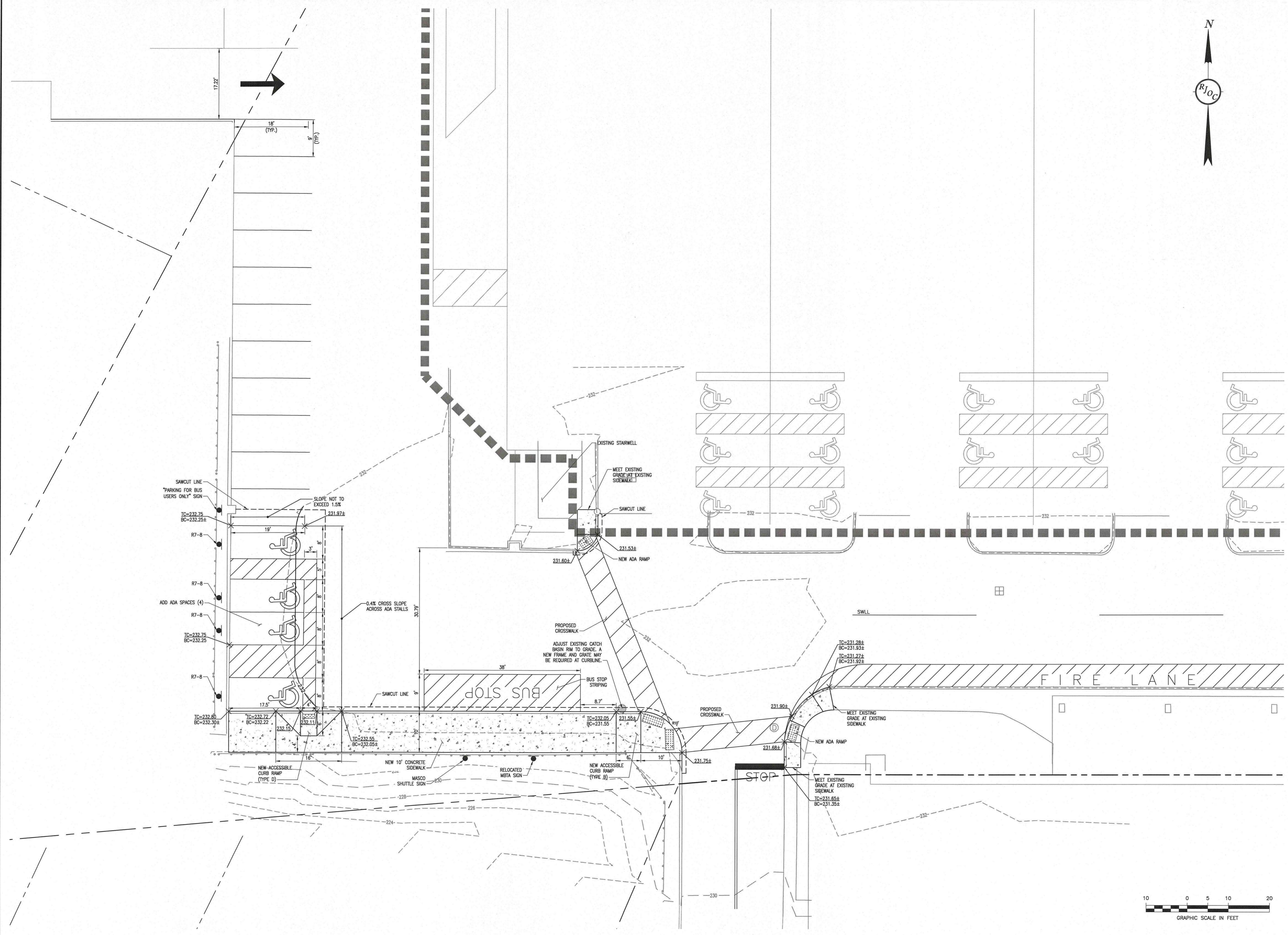

Date	
Revision	
No.	
2	04/25/2018
1	04/29/18
1	02/22/18
Revision	
Date	
No.	
ISSUED FOR ZONING REVIEW	
ISSUED FOR SPECIAL PERMIT	
REVISED	

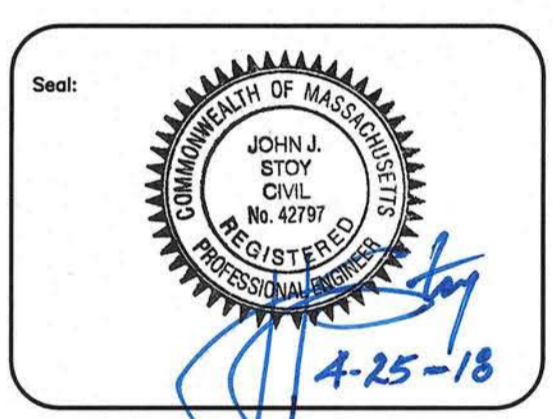

Designed by: SPG
 Drawn by: WJH/BGE
 Checked by: SPG
 Scale: 1"=10'
 Date: 02/22/2018

Prepared for:
MALL AT CHESTNUT HILL, LLC
 199 BOYLSTON STREET
 CHESTNUT HILL, MA 02167

Prepared by:
RJO'CONNELL & ASSOCIATES, INC.
 CIVIL ENGINEERS, SURVEYORS & LAND PLANNERS
 80 MONTVALE AVE
 STONEHAM, MA 02180
 781-279-0180
 FAX: 781-279-0173

Project Name:
**THE MALL AT CHESTNUT HILL
 NEWTON, MA**

Drawing Name:
SITE PLAN

Drawing No.:
C-1
 Project No.: 18003