



PRELLWITZ CHILINSKI ASSOCIATES
221 Hampshire Street Cambridge MA 02139
t: 617-547-8120 f: 617-661-4986
www.prellwitzchilinski.com

Washington Place Option B

Washington Street at Walnut Street, Newtonville

November 1, 2016



B Ground Floor Plan

Washington Place
 Washington Street at Walnut Street, Newtonville

11.01.2016





B1 East Building Looking North on Walnut Street



B2 West Building on Washington Street



B3 West Building along Washington Terrace



B4 Internal Courtyard Looking West



B5 Internal Courtyard Looking East



B6 Walnut Street Looking South



B7 Walnut Street View from Across the Street



City of Newton

FOSTER ST

Bette White

Ellen Fitzpatrick

John Gallagher

John and Mari Wilson

David and Francine Smith

Robert and Elizabeth Smith

BAILEY PL

WASHINGTON ST

0 101 feet

Washington Place Option B
Washington Street at Walnut Street, Newtonville

11.01.2016



14-16 Foster St. - Bette White
Existing



14-16 Foster St. - Bette White



14-16 Foster St. - Bette White
Estimated 3-Year Growth



20 Foster St. - Ellen Fitzpatrick
Existing



20 Foster St. - Ellen Fitzpatrick



20 Foster St. - Ellen Fitzpatrick
Estimated 3-Year Growth



24-26 Foster St. - John Gallagher
Existing



24-26 Foster St. - John Gallagher



24-26 Foster St. - John Gallagher
Estimated 3-Year Growth



30 Foster St. - John & Mari Wilson
Existing



30 Foster St. - John & Mari Wilson



30 Foster St. - John & Mari Wilson
Estimated 3-Year Growth



34 Foster St. - David & Francine Smith
Existing



34 Foster St. - David & Francine Smith



34 Foster St. - David & Francine Smith
Estimated 3-Year Growth



40 Foster St. - Robert & Elizabeth Smith
Existing



40 Foster St. - Robert & Elizabeth Smith



40 Foster St. - Robert & Elizabeth Smith
Estimated 3-Year Growth

Existing Conditions



Proposed Conditions



March / September - 9am

March / September - 12pm
Shadow Study

Existing Conditions



Proposed Conditions



March / September - 3pm

March / September - 6pm
Shadow Study

Existing Conditions



Proposed Conditions



June - 9am

June - 12pm
Shadow Study

Existing Conditions



Proposed Conditions



June - 3pm

June - 6pm
Shadow Study

Existing Conditions

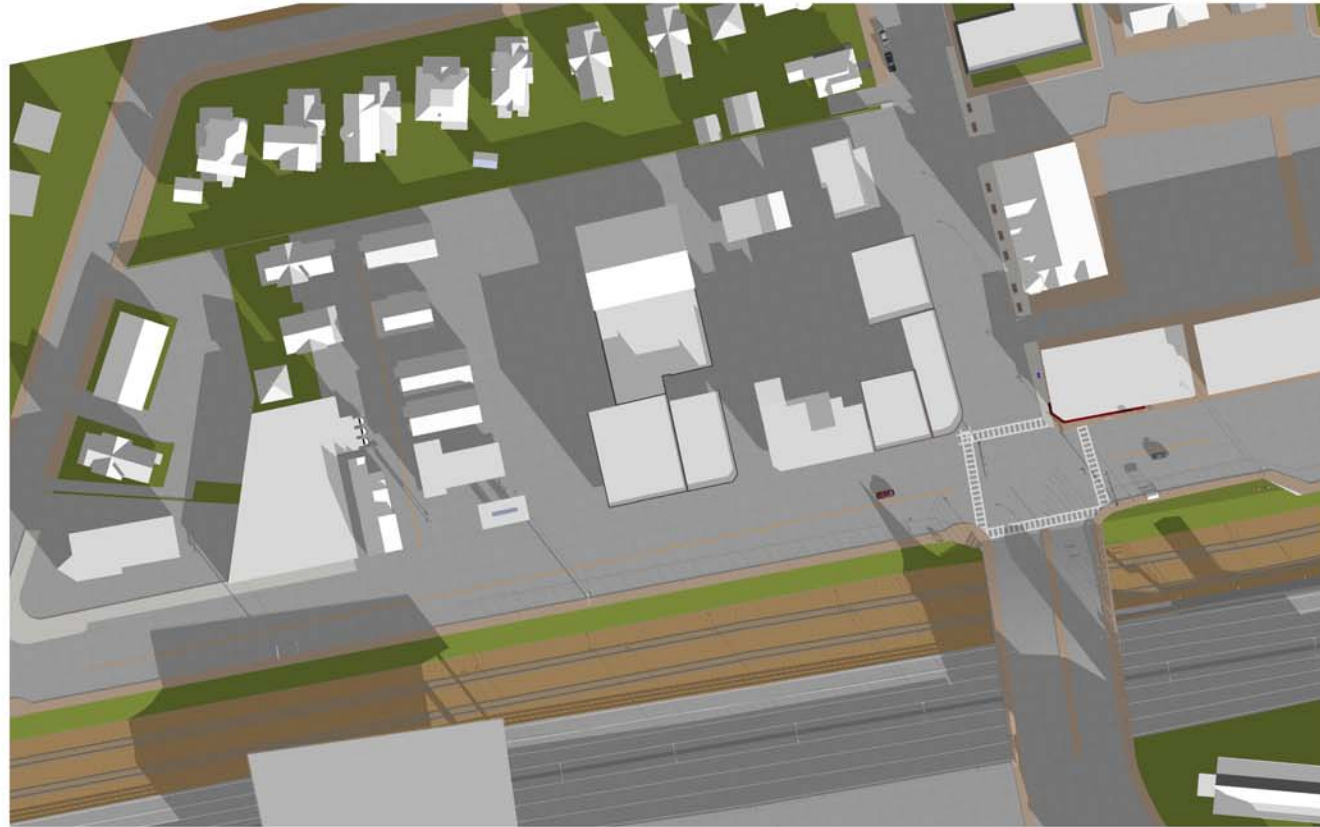

Proposed Conditions



December - 9am

December - 12pm
Shadow Study

Existing Conditions

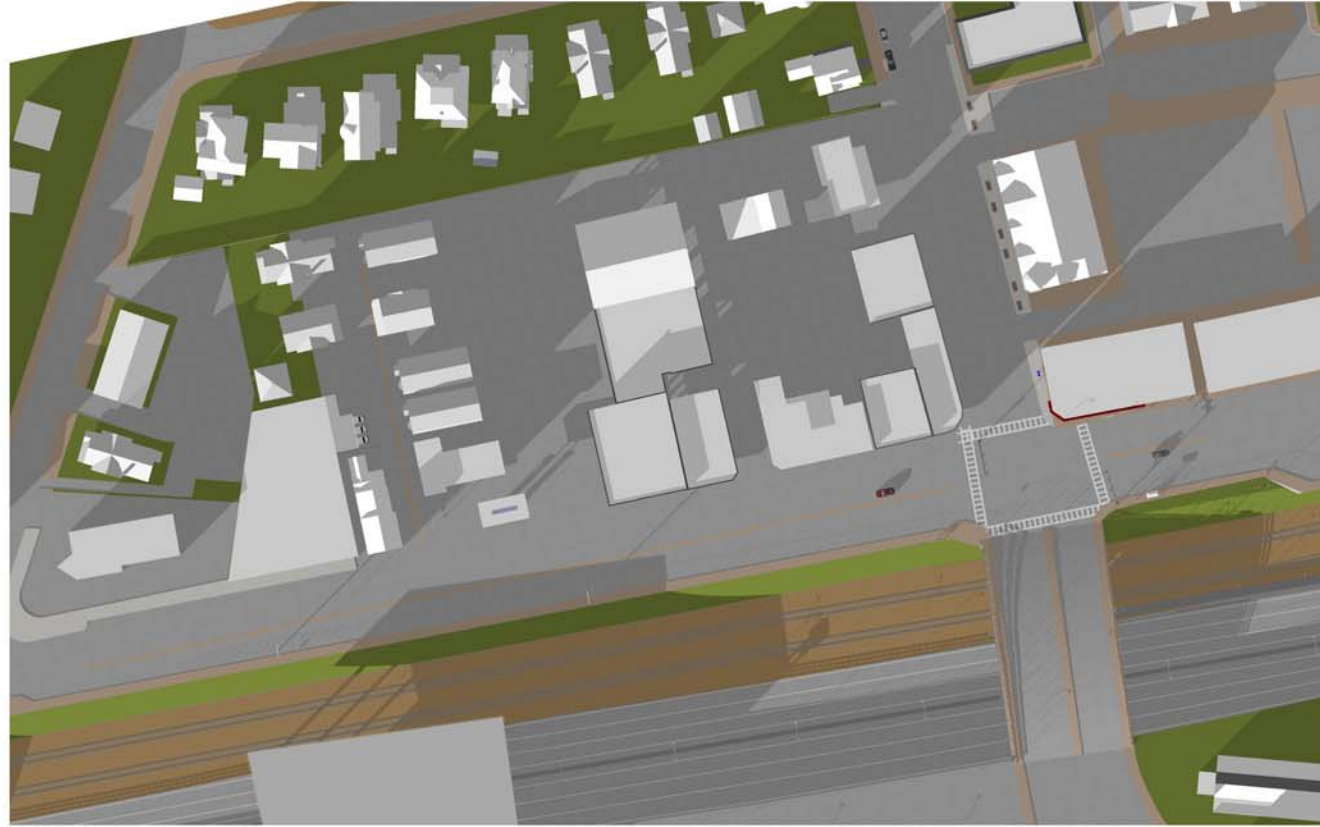

Proposed Conditions

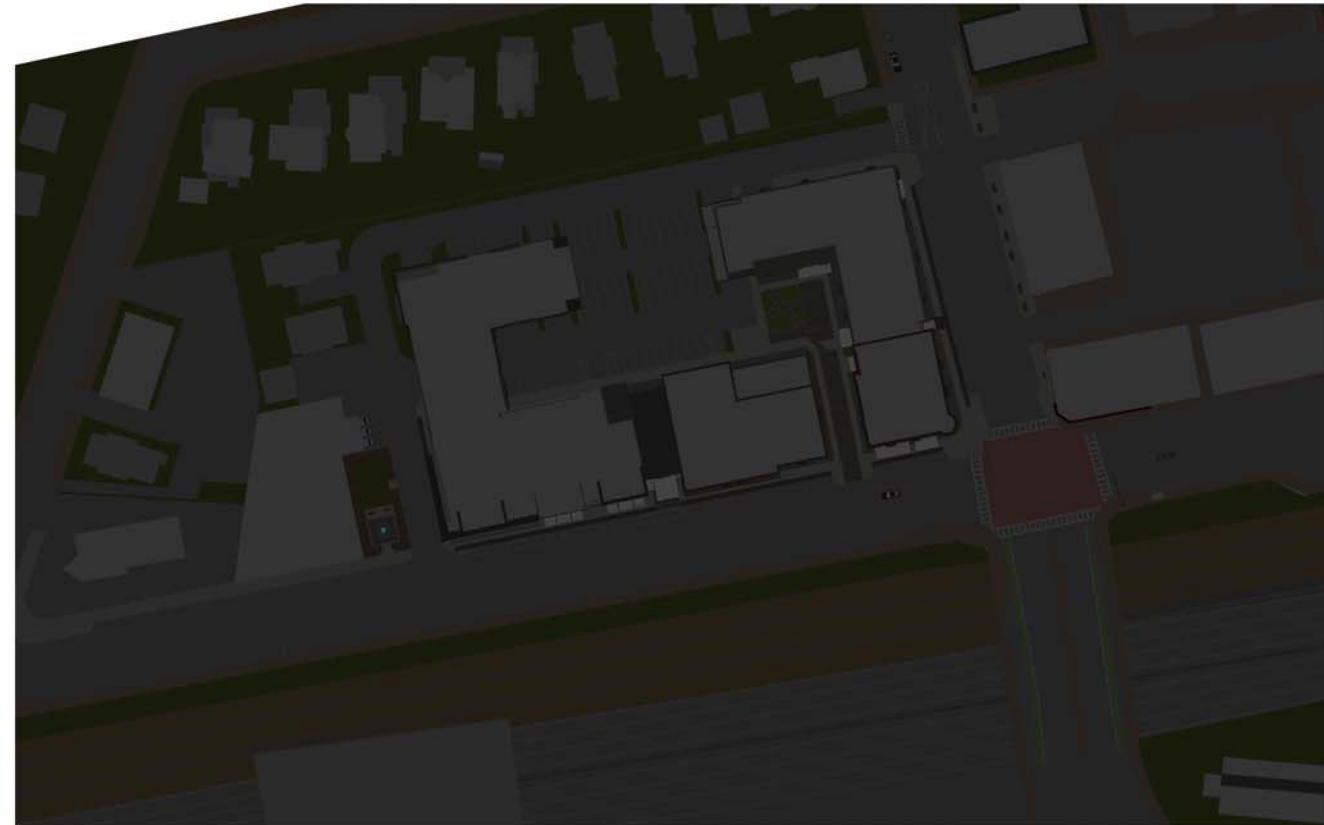
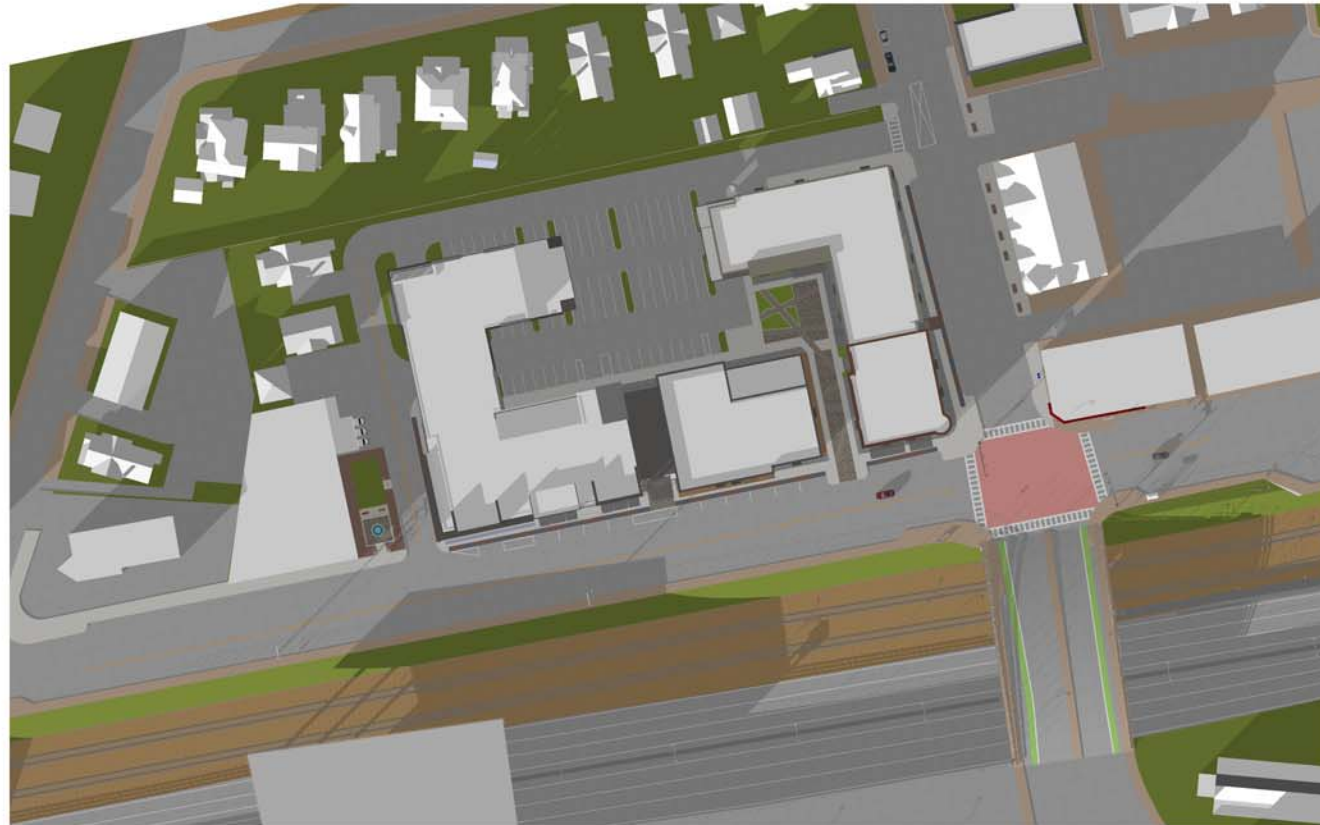

December - 3pm

December - 6pm
Shadow Study