

# The Station at Riverside

*A green, transit-oriented community*



# EXISTING CONDITION



# OVERVIEW OF PROJECT

**225,000 square feet of office space**

**571 parking spaces**

**290 Apartment Units (including 44 Affordable Units)**

**18 studios**

**157 one-bedrooms**

**103 two-bedrooms**

**12 three-bedrooms**

**441 parking spaces**

**20,000 square feet of retail space**

**11,000 square feet of community space**

**181,400 square feet of open space**

# MASTER PLAN : DETAIL AREAS

**ISSUES:**

**Redesign/refinements**

- Pedestrian Views along Grove Street



# RIVERSIDE RESIDENTIAL : Basement Level I Plan

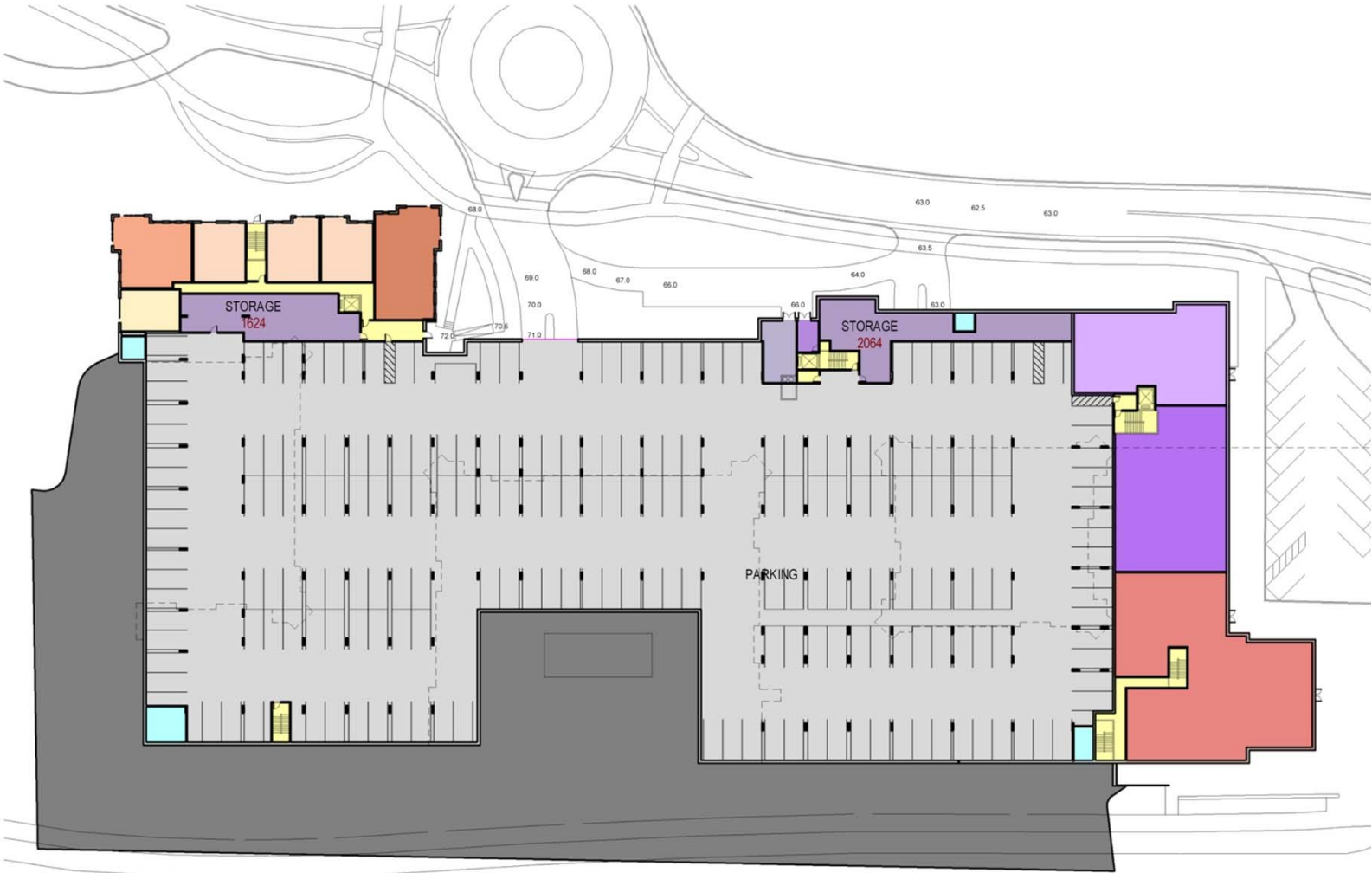

# RIVERSIDE RESIDENTIAL : Residential Floor I



# RIVERSIDE RESIDENTIAL : Massing



# RIVERSIDE RESIDENTIAL : Top of the Hill





# RIVERSIDE RESIDENTIAL : Top of the Hill



# RIVERSIDE RESIDENTIAL : Bottom of the Hill



# RIVERSIDE RESIDENTIAL : Bottom of the Hill



# The Station at Riverside

*A green, transit-oriented community*

