

Quantity	Common Name	Scientific Name	Size	Comments
1	Male Upright	A	20' Ht. 4" - 6" W.	Remove Male Cherry, 17' Diameter in front of house. 1/2" DBH. 1/2" DBH. 1/2" DBH. 1/2" DBH.
1	Female Upright	B	20' Ht. 4" - 6" W.	Remove Female Cherry, 17' Diameter in front of house. 1/2" DBH. 1/2" DBH. 1/2" DBH. 1/2" DBH.
1	Male Upright	C	20' Ht. 4" - 6" W.	Remove Male Cherry, 17' Diameter in front of house. 1/2" DBH. 1/2" DBH. 1/2" DBH. 1/2" DBH.
1	Female Upright	D	20' Ht. 4" - 6" W.	Remove Female Cherry, 17' Diameter in front of house. 1/2" DBH. 1/2" DBH. 1/2" DBH. 1/2" DBH.
1	Male Upright	E	20' Ht. 4" - 6" W.	Remove Male Cherry, 17' Diameter in front of house. 1/2" DBH. 1/2" DBH. 1/2" DBH. 1/2" DBH.
1	Female Upright	F	20' Ht. 4" - 6" W.	Remove Female Cherry, 17' Diameter in front of house. 1/2" DBH. 1/2" DBH. 1/2" DBH. 1/2" DBH.
1	Male Upright	G	20' Ht. 4" - 6" W.	Remove Male Cherry, 17' Diameter in front of house. 1/2" DBH. 1/2" DBH. 1/2" DBH. 1/2" DBH.
1	Female Upright	H	20' Ht. 4" - 6" W.	Remove Female Cherry, 17' Diameter in front of house. 1/2" DBH. 1/2" DBH. 1/2" DBH. 1/2" DBH.

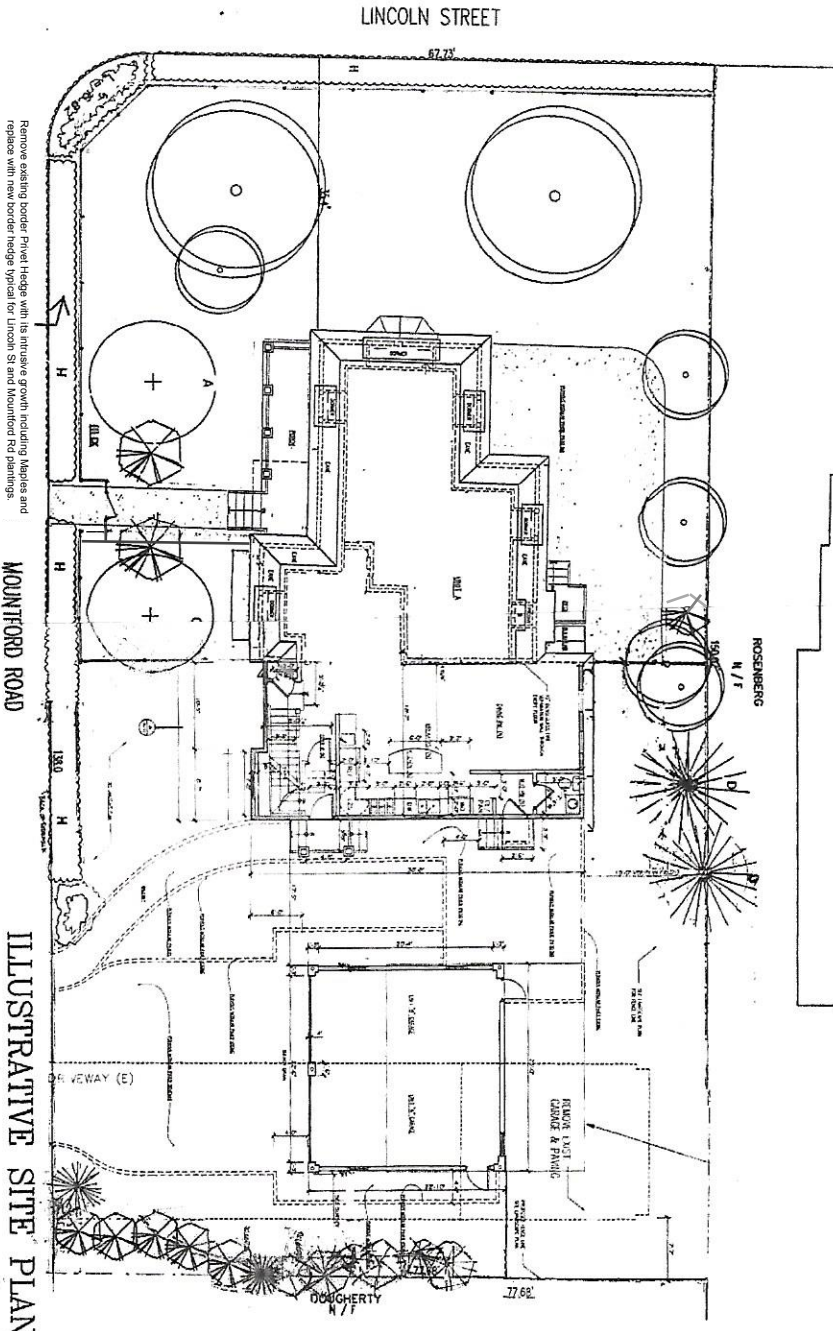
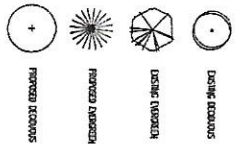

Remove existing border Pivotal Hedge with its intrusive growth including Maples and replace with new border hedge typical for Lincoln St and Mountford Rd plantings.

180'

ILLUSTRATIVE SITE PLAN

1/8" = 1'

LEGEND / SYMBOLS

- DESIGN CONSTRUCTION TO EXIST
- DESIGN CONSTRUCTION TO BE DEMOL
- NEW CONSTRUCTION
- NEW CONSTRUCTION
- DESIGN

D&A DeMarco & Associates
 Associate & President
 10 Newell Street
 Newton Highlands, MA 02461
 Phone: 617/552-4141
 Fax: 617/552-1588

Project Title:
 ADDITIONS & ALTERATIONS TO
 CHITCHEAN RESIDENCE
 145 LINCOLN STREET
 NEWTON HIGHLANDS, MA 02461
 Owner:
 ABRAHAM CHITCHEAN
 79 BRANDEIS RD
 NEWTON CENTRE MA 02459

Sheet Title:
 LANDSCAPE PLAN

Issue: 05/15
 No. 36840-D
 05/15

LA-1

Proposed Landscape Materials

Trees



White Fir
Abies concolor



Kousa Dogwood
Cornus kousa

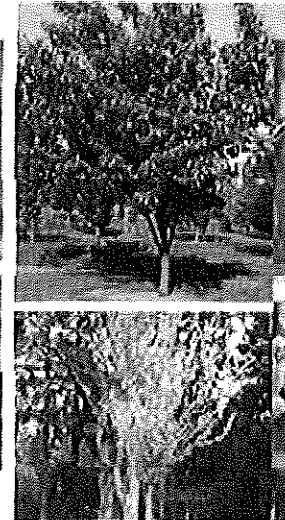
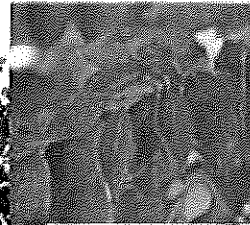

Sargent Cherry
Prunus sargentii



Pyramidal Arborvitae
Thuja occidentalis 'Pyramidalis'



Shrubs

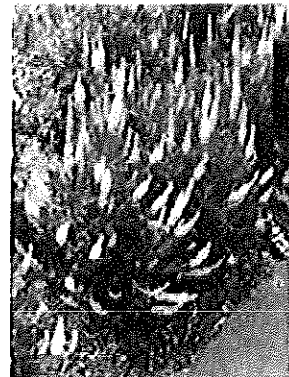

Dwarf Summersweet Clethra
Clethra alnifolia 'compacta'

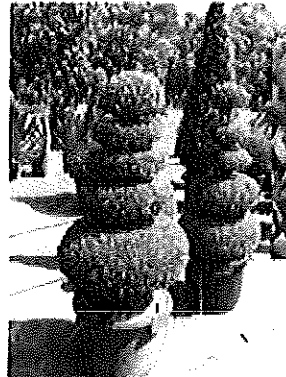

Upright English Boxwood
Buxus sempervirens 'fastigiata'



Dwarf Azalea
Rhododendron allanticum



Plant Images

Client Name: Arman Chirchian
Project Name: 143 Lincoln Street
Newton Highlands MA 02461
December 18, 2011

Quantity	Common Name	Scientific Name	Size	Comments
Trees				
1	Kousa Dogwood	<i>Cornus kousa</i>	20-30 ft. 20-30" w	Spreading habit. Creamy white flowers 2-4". Flowers in April/May. Red fruit in Sept/Oct. Sun-Partial shade. Deep red fall color.
2	Pyramidal Arborvitae	<i>Thuja occidentalis 'Pyramidalis'</i>	20-30 ft. 1-4" w	Easy to prune and suitable hedging plant, select upright/pyramidal forms as listed.
1	Sargent Cherry	<i>Prunus sargentii</i>	20-30 ft. 20-30" w	10-20 ft. spreading habit. Dark pink flowers 1.5-2" x 2-2.5". Flowers in May. Purple fruit in September. Branded red fall color.
2	White Fir	<i>Abies concolor</i>	10-30 ft. 11-20" w	1-1 1/2" x 1 1/2" long needles.
Shrubs				
2	Dwarf Summersweet Clethra	<i>Clethra alnifolia 'compacta'</i>	2-3' x 3' ft. variable spread	Very fragrant. Spring flowering (4/5-8/5). August. Densely rounded habit. Yellow fall color. Fragrant, white flowers 2-4" long. select dwarf form as listed.
1	English Boxwood	<i>Buxus sempervirens 'fastigiata'</i>	6-10 ft. 3-4" w	Select special, pointed varieties from nursery.
2	Dwarf Azalea	<i>Rhododendron allanticum</i>	4-5' ft. 3-4" w	Flowers in late spring. White flowers.
TOTAL				
11				



LA-2

Jessica Wolf
Designer 2011