

LOT AREA:  
23,540±s.f.

EXISTING  
1 STORY  
BRICK  
#377  
F.F.LR.EL.=000.00

ZONING CHART		
NEWTON, MASSACHUSETTS		
ZONE:	MR-1 (OLD)	SUBMISSION: EXISTING
REGULATION	REQUIRED	EXISTING
LOT AREA	7,000s.f.	23,540s.f.
LOT FRONTAGE	70.0'	51.7'
FRONT SETBACK	25.0'	27.5'
SIDE SETBACK	7.5'	38.7'
REAR SETBACK	15.0'	82.7'
BUILDING HEIGHT	36.0'	-
AVERAGE GRADE	30.0%	4.6%
LOT COVERAGE	50.0%	83.5%

TOPOGRAPHIC SITE PLAN  
NEWTON, MASSACHUSETTS  
SHOWING EXISTING CONDITIONS  
AT #377 LANGLEY ROAD  
SCALE: 1in.=10ft. DATE: SEPTEMBER 9, 2016

PROJECT: 216168

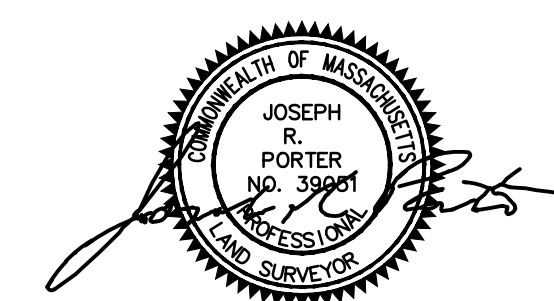

**VTP**  
ASSOCIATES  
INC.

LAND SURVEYORS - CIVIL ENGINEERS. 132  
ADAMS STREET 2ND FLOOR SUITE 3  
NEWTON, MA 02458  
(617) 332-8271

SHEET 1 OF 1

- 216168\_ac.dwg (2.2016)
- LEGEND**
- BUILDING
  - PROPERTY LINE W/  
BEARING DISTANCE
  - CONTOUR
  - STOCKADE FENCE
  - CHAINLINK FENCE
  - PICKET FENCE
  - SEWER LINE
  - DRAIN LINE
  - WATER LINE
  - GAS LINE
  - GAS VALVE
  - WATER VALVE
  - DRAIN MANHOLE
  - SEWER MANHOLE
  - CATCH BASIN
  - UTILITY POLE
  - LIGHT POLE
  - DECIDUOUS TREE
  - CONIFEROUS TREE

