

KEY	QTY	BOTANICAL NAME	COMMON NAME	PLANT SIZE	ROOT	COMMENTS
TREES						
AG	1	Amelanchier x grandiflora 'Autumn Brilliance'	Apple Serviceberry	6'-8' ht	B&B	Multi-stem
HV	2	Hamamelis virginiana	Witch-hazel	6'ht	B&B	Multi-stem
TH	15	Taxus x media 'Hicksii'	Hicks Yew	4'-6' ht	B&B	Column 12"
SHRUBS						
Co	11	Cephalanthus occidentalis	Buttonbush	3 gal	Cont.	
Ca	12	Clethra alnifolia 'Hummingbird'	Summersweet	3 gal	Cont.	
Hq	14	Hydrangea quercifolia 'Pee Wee'	Dwarf Oakleaf Hydrangea	5 gal	Cont.	
lv	22	Itea virginica 'Little Henry'	Little Henry® Dwarf Virginia Sweetspire	1 gal	Cont.	24-30" o.c.
Rb	14	Rhododendron 'Blaauw's Pink'	Blaauw's Pink Azalea	1 gal	Cont.	4' ht evergreen
Rc	12	Rhododendron calendulaceum	Flame Azalea	1 gal	Cont.	6' ht deciduous
PERENNIALS						
aab	11	Astilbe x arendsii 'Bridal Veil'	Astilbe	1 gal	Cont.	
at	21	Amonia tabernaemontana	Bluestar	1 gal	Cont.	
hh	16	Hosta x 'Halcyon'	Hosta	1 gal	Cont.	
hm	37	Hakonechloa macra 'Aureola'	Japanese Forest Grass	1 gal	Cont.	
hs	26	Heucherella x 'Stoplight'	Foamy Bell	1 gal	Cont.	
nj	57	Nepeta 'Junior Walker'	Catmint	1 gal	Cont.	
GROUNDCOVER						
cp	546	Carex pensylvanica	Pennsylvania sedge	1 gal	Cont.	
gm	99	Geranium macrorrhizum	Geranium	2qt	Cont.	
VINE						
ha	8	Hydrangea anomala	Japanese Climbing-hydrangea	2qt	Cont.	

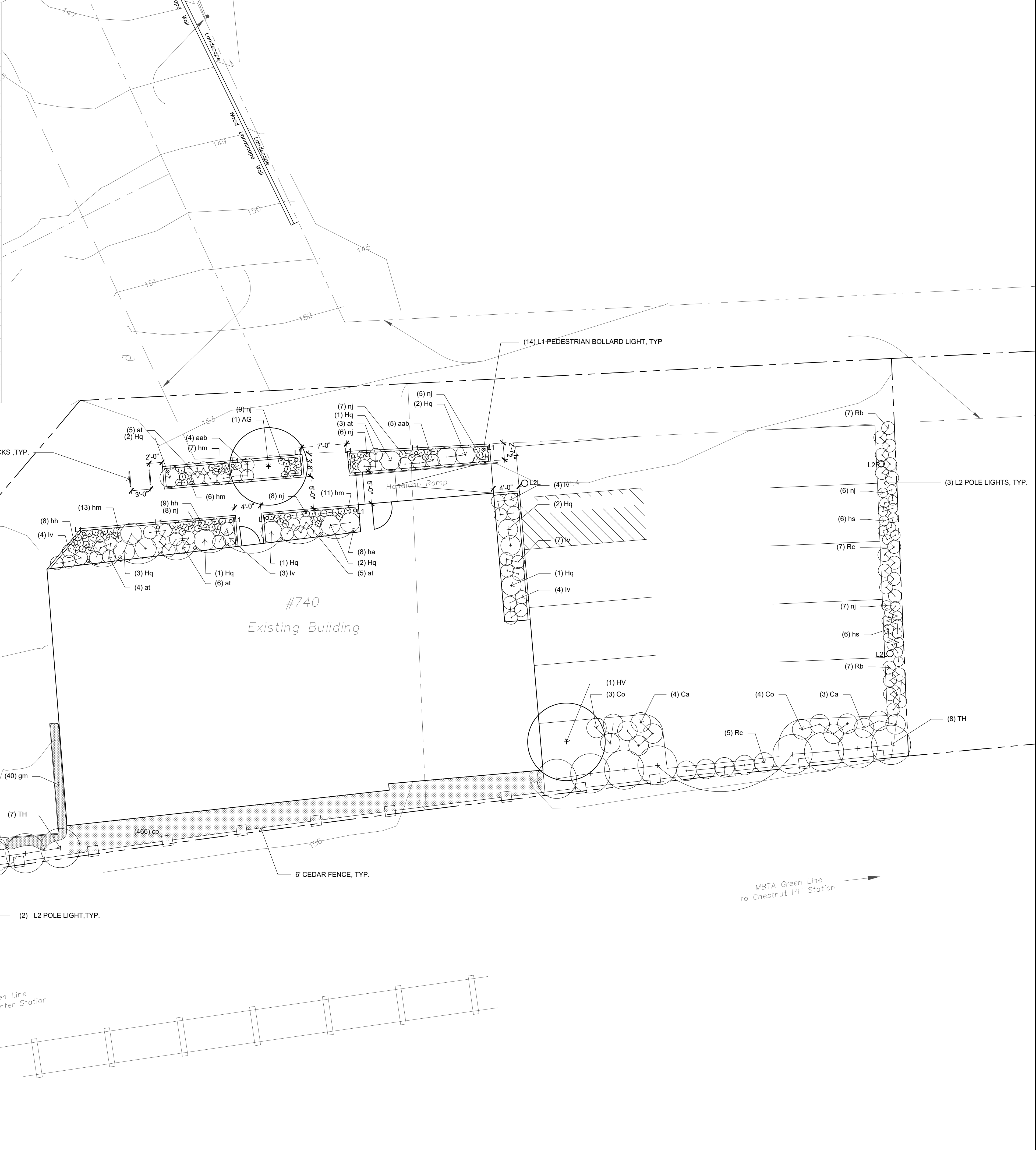

PROJECT:
The Green Lady Dispensary
740 Beacon Street
Newton, MA

MARK	DATE	DESCRIPTION
	04/01/2021	FOR REVIEW

G2 PROJ. #: 2106
 FILE NAME:
 DRAWN BY: YQ
 CHECKED BY: LS
 © 2021 COPYRIGHT G2 COLLABORATIVE

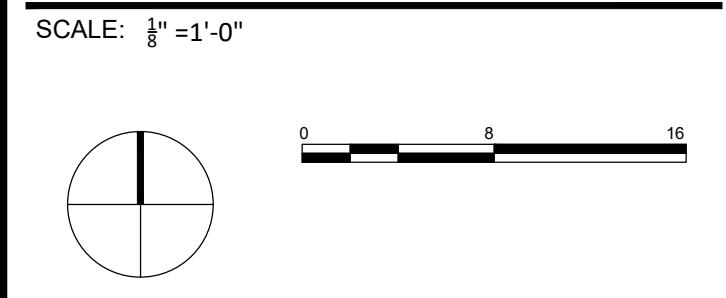

SHEET TITLE:
SITE PLAN
L1.0