

NEEDHAM STREET

4'-0" MINIMUM WIDTH ACCESSIBLE ROUTE TO SIDEWALK CONSISTENT WITH 2003 CITY OF NEWTON PLANNING BOARD ORDER #437-03 & BOARD ORDER #231-17

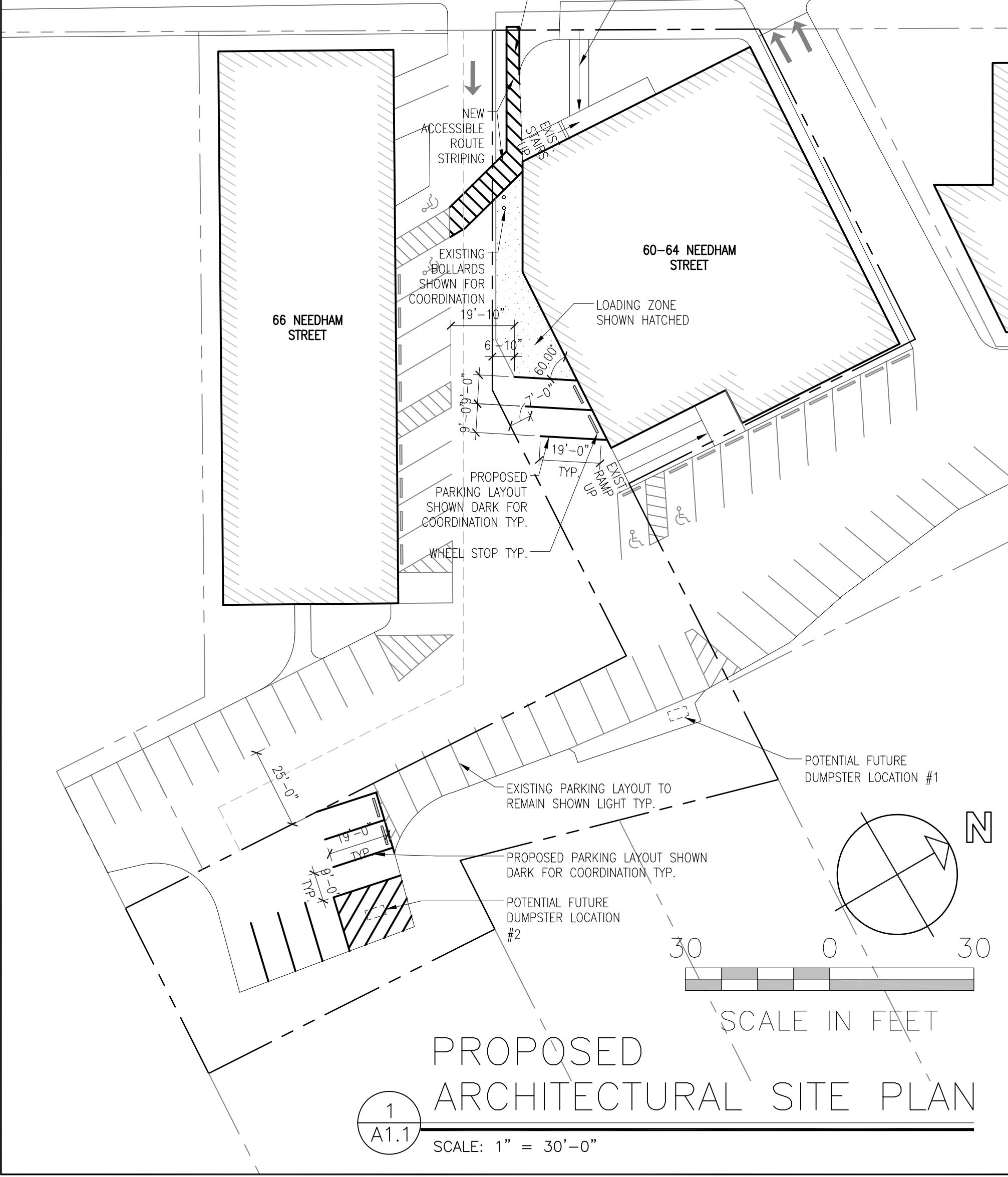

1
A1.1

SCALE: 1" = 30'-0"

PARTIAL SITE PLAN
 64 NEEDHAM STREET PARKING LAYOUT
 64 NEEDHAM STREET
 NEWTON, MA

Scale: NOTED
 Date: 11/24/20
 Drawn By: CDS
 Checked By: KEU
 Job No: 20060

Drawing:
A1.1

U D A ARCHITECTS
 486 HIGH PLAIN STREET
 WALPOLE, MASSACHUSETTS 02081
 P. 508-734-5236 F. 508-734-5256