

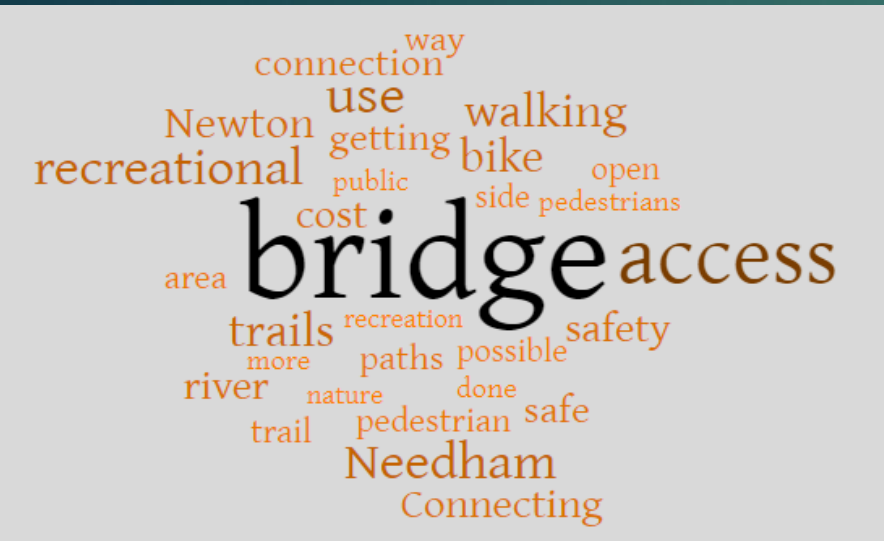

# Christina Street Rail Bridge Shared-Use Pathway Feasibility Study

Community Engagement Meeting  
May 26, 2021



# Project Team

## City of Newton Staff

- Jennifer Steel, *Chief Environmental Planner*
- Claire Rundelli, *Assistant Environmental Planner*
- Nicole Freedman, *Director Transportation Planning*
- Barney Heath, *Director of Planning & Development*

## Design Consultant, VHB

- Shanta Keller, *Project Manager*
- Kaleigh Rowe-Stutz, *Bridge Lead*
- Scott Brunner, *Civil Lead*
- Kris Kretsch, *Technical Advisor*
- Chris Wagner, *Environmental Permitting*

# Community Partners

## Dept. of Conservation and Recreation

## Town of Needham

## Newton City Councilors

## Barry Price Center

## Newton Highlands and Newton Upper Falls Area Councils



# Christina Street Rail Bridge in Context



# Project Background

- The bridge was closed due to the safety and liability concerns it posed to the Barry Price Center.
- Newton has grant funding to conduct feasibility study and develop concept plans for a preferred scenario.
- No final designs or construction have been funded yet.



# Community Engagement Survey Results

Q1 Have you used the bridge in the past? (check all that apply)

Answered: 262 Skipped: 0

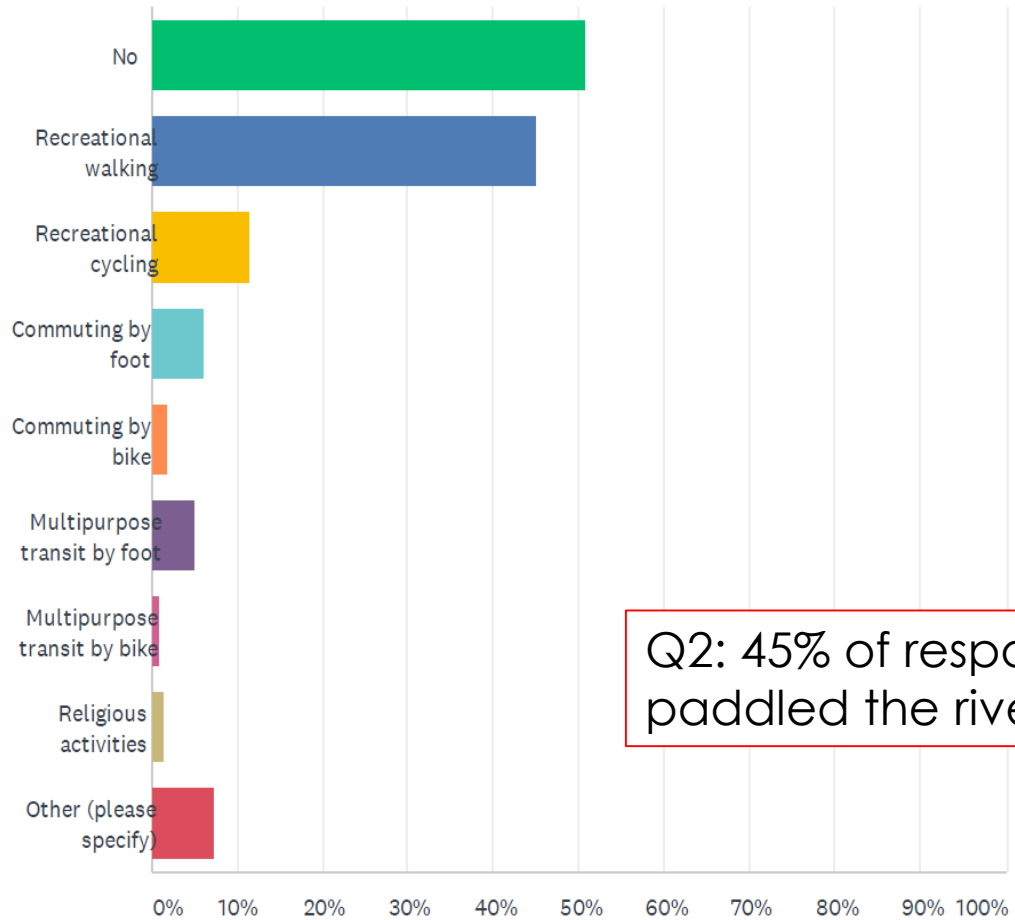

Q2: 45% of respondents have paddled the river below.

Q3 How would you use a new or upgraded shared use pathway bridge in the future? (check all that apply)

Answered: 262 Skipped: 0

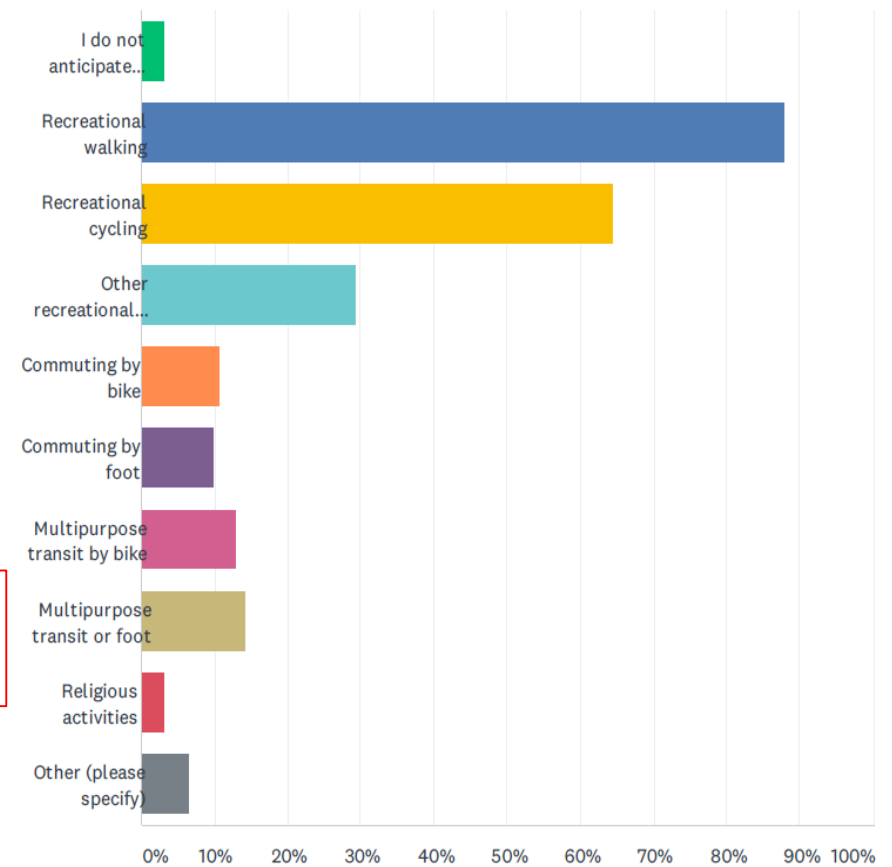

# Community Engagement Survey Results

## What interests or goals of this bridge feasibility study are most important to you?

- **Accessibility** : Ensure that there is full-ADA and all-age friendly access from both sides of the River.
- **Connectivity** : Reopen and enhance this connection to serve area residents and businesses; pursue possible future connections.
- **Safety** : Ensure appropriate railings, visibility, and approaches for safe passage by bridge users and to deter delinquent activity.
- **Timing** : Ensure this project is a high priority in future budget/funding requests so that final design/construction will occur in a timely manner.

# Feasibility Study Scope

- ▶ VHB assesses **3 scenarios**
  1. Re-use / Rehabilitation
  2. New Bridge at Same Location (Demolish Existing Bridge)
  3. New Bridge at Adjacent Location (Retain Existing Bridge)
- ▶ Newton & Needham select **preferred scenario**
- ▶ VHB develops **concept plans**

*Note: No final design or construction has been funded at this point.*

# Approach to Feasibility Study

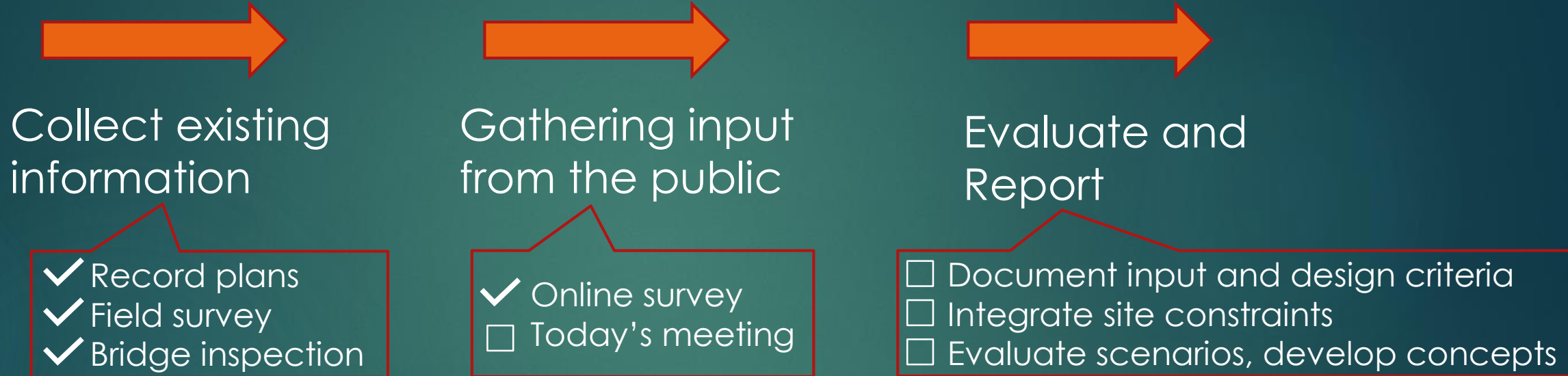



# Existing Conditions - Bridge



# Existing Conditions - Bridge

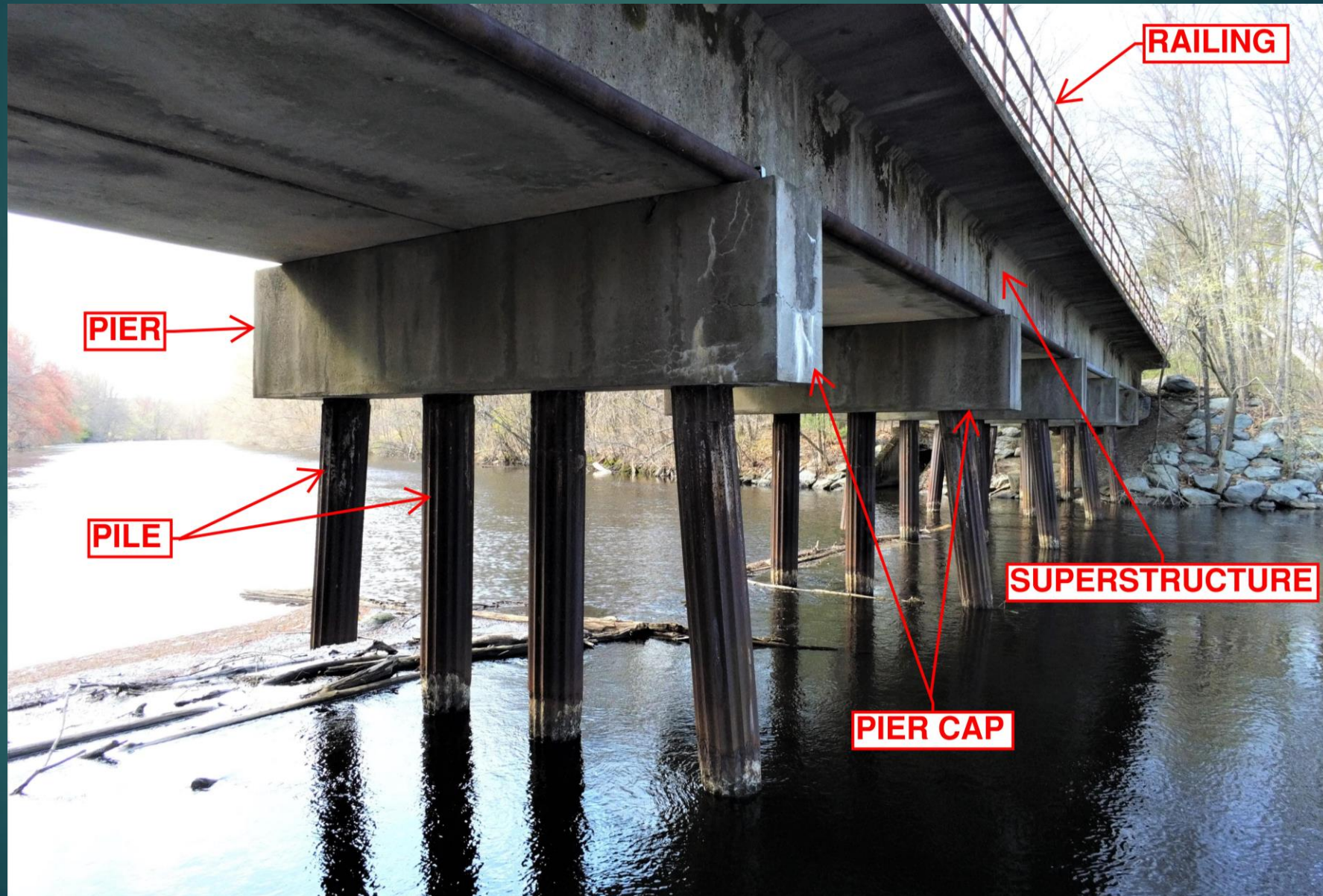

# Existing Conditions - Bridge

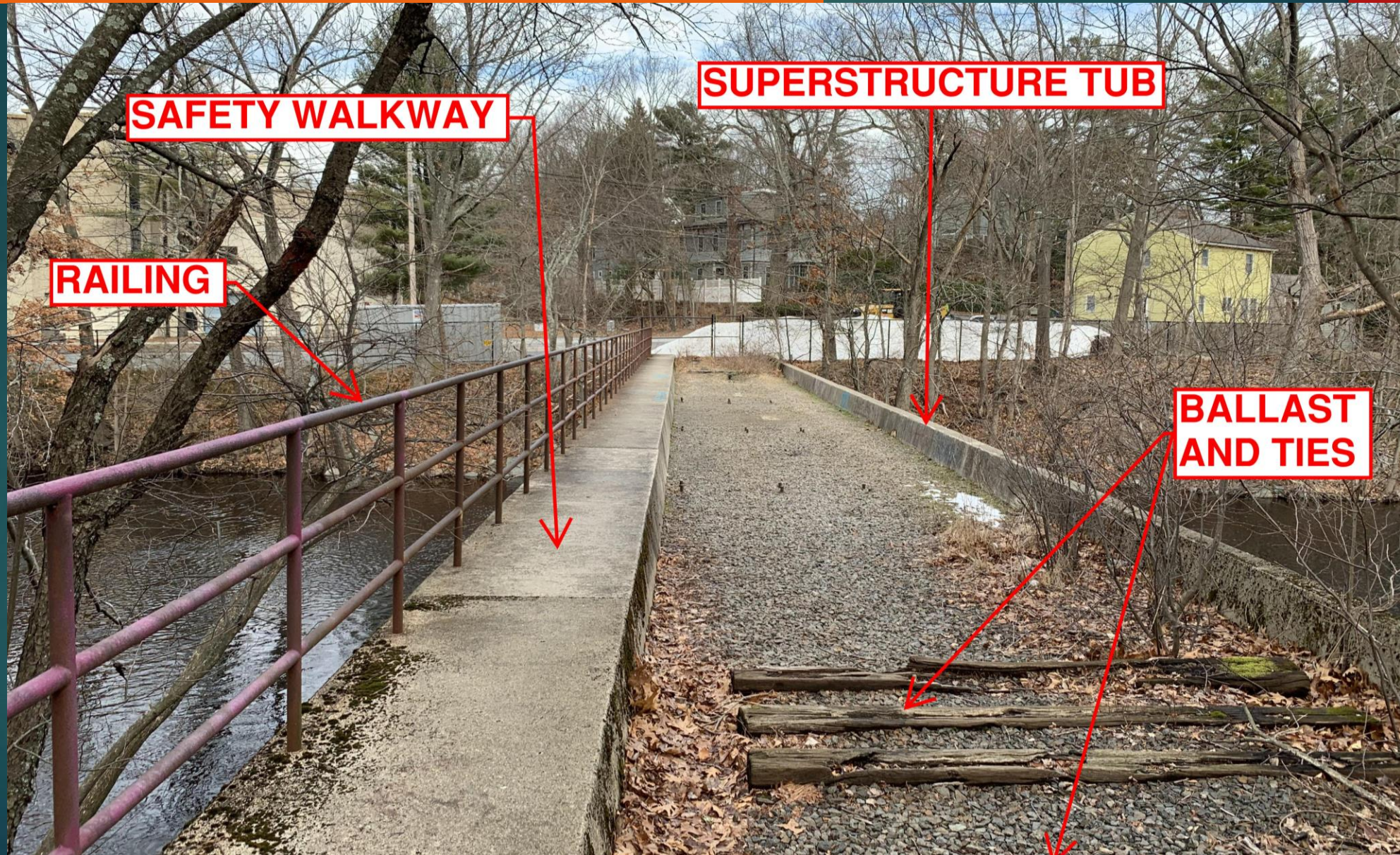

# Existing Conditions - Bridge

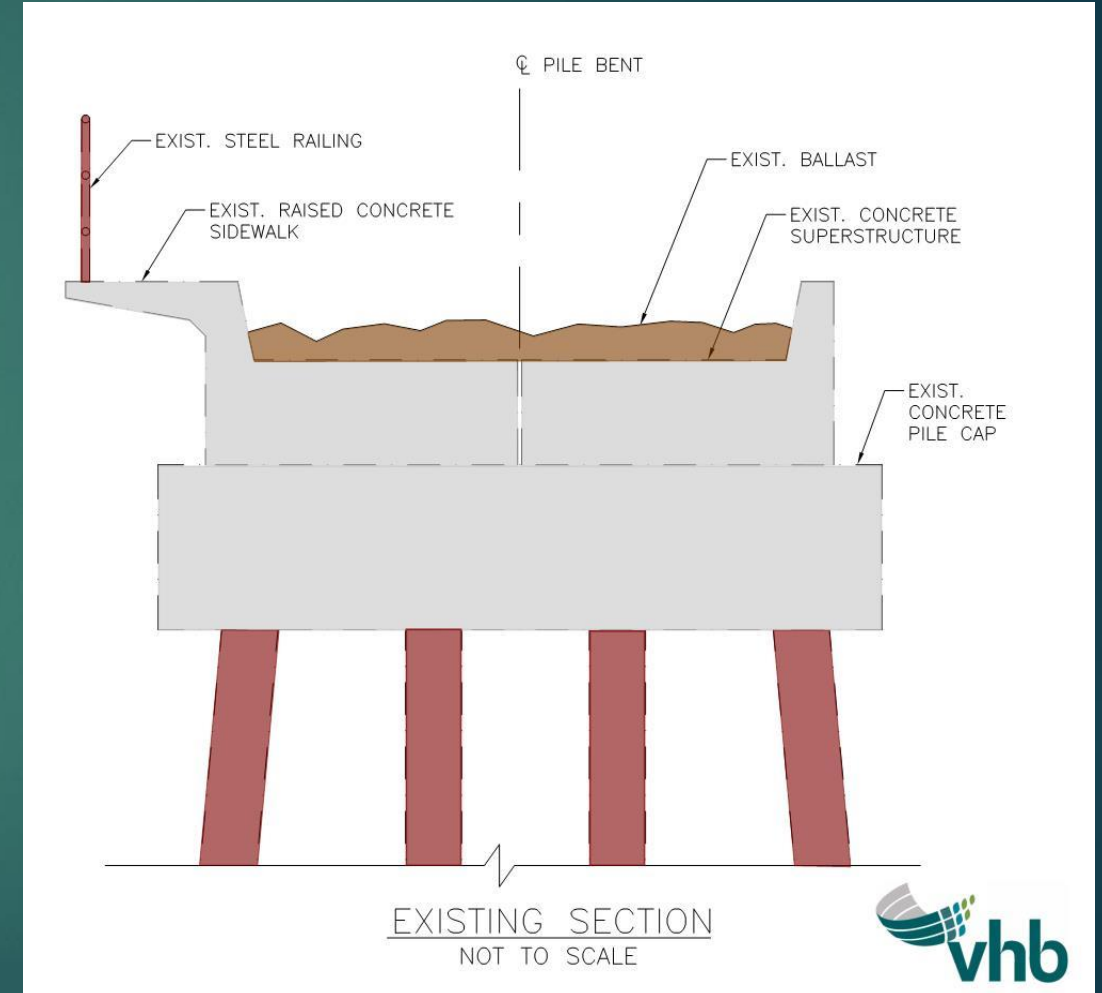
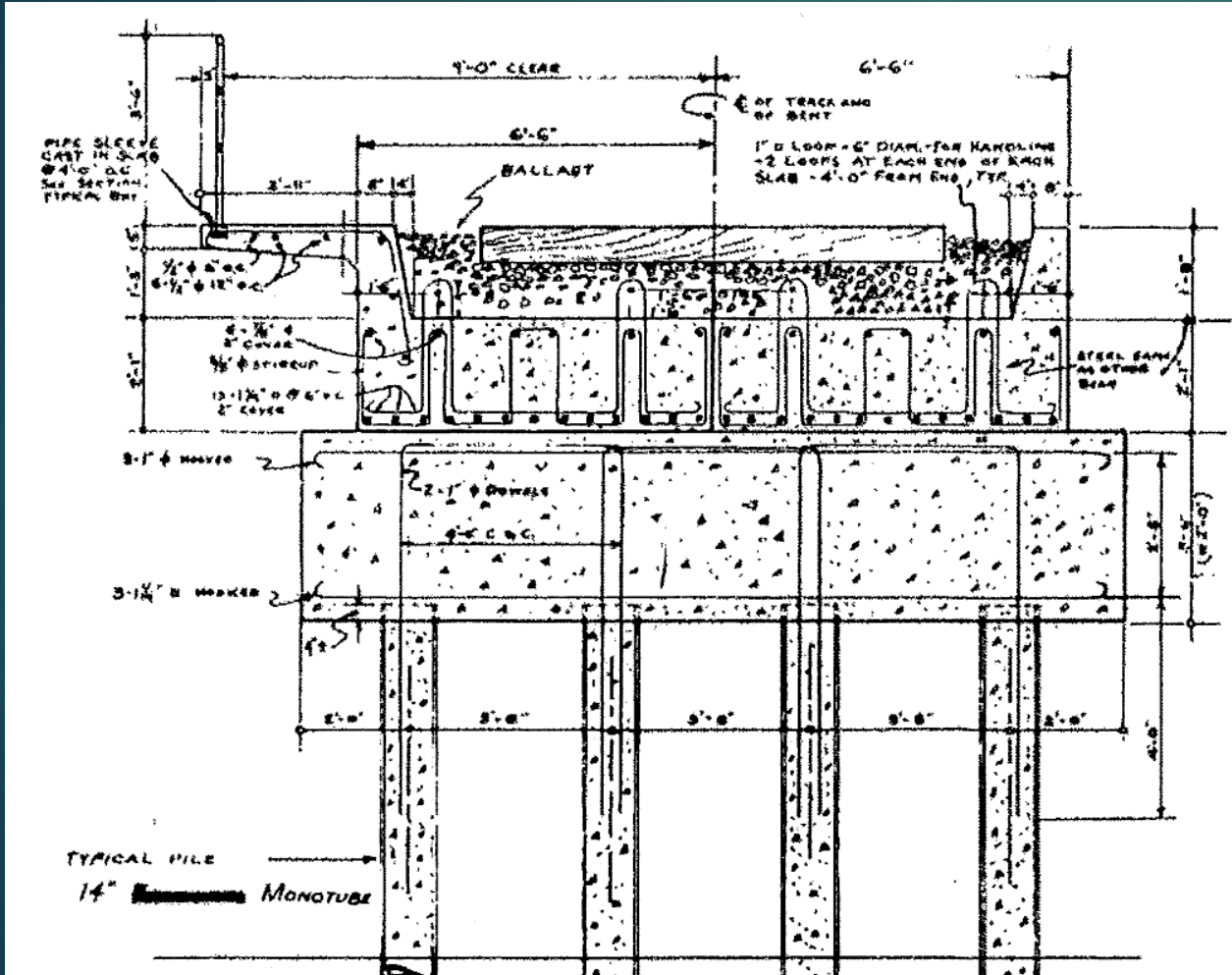

# Existing Conditions - Bridge

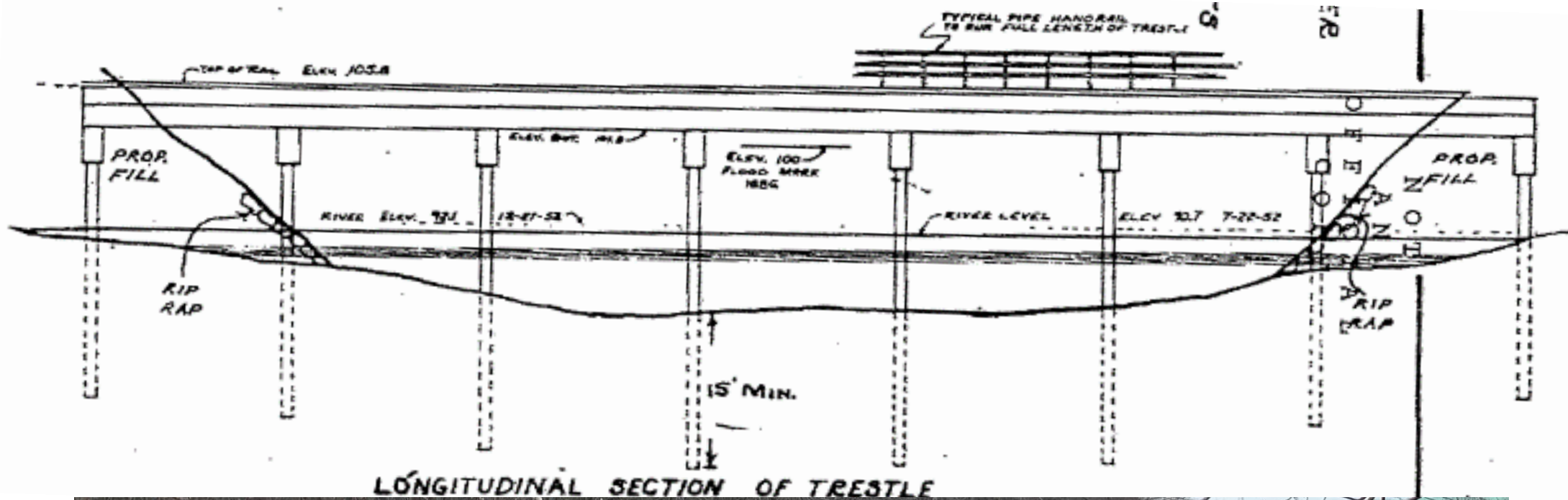

# Existing Conditions – Bridge Piles



# Existing Conditions – Bridge Concrete



# Shared Use Path Goals

## ► Required Design Criteria

- 1. Accessibility
- 2. Railing Design
- 3. Bridge Loading
- 4. Regulatory Requirements

## ► Preferred Design Criteria

- 1. Width
- 2. Lifespan and Maintenance
- 3. Minimize Impacts
- 4. Minimize Costs
- 5. Other amenities

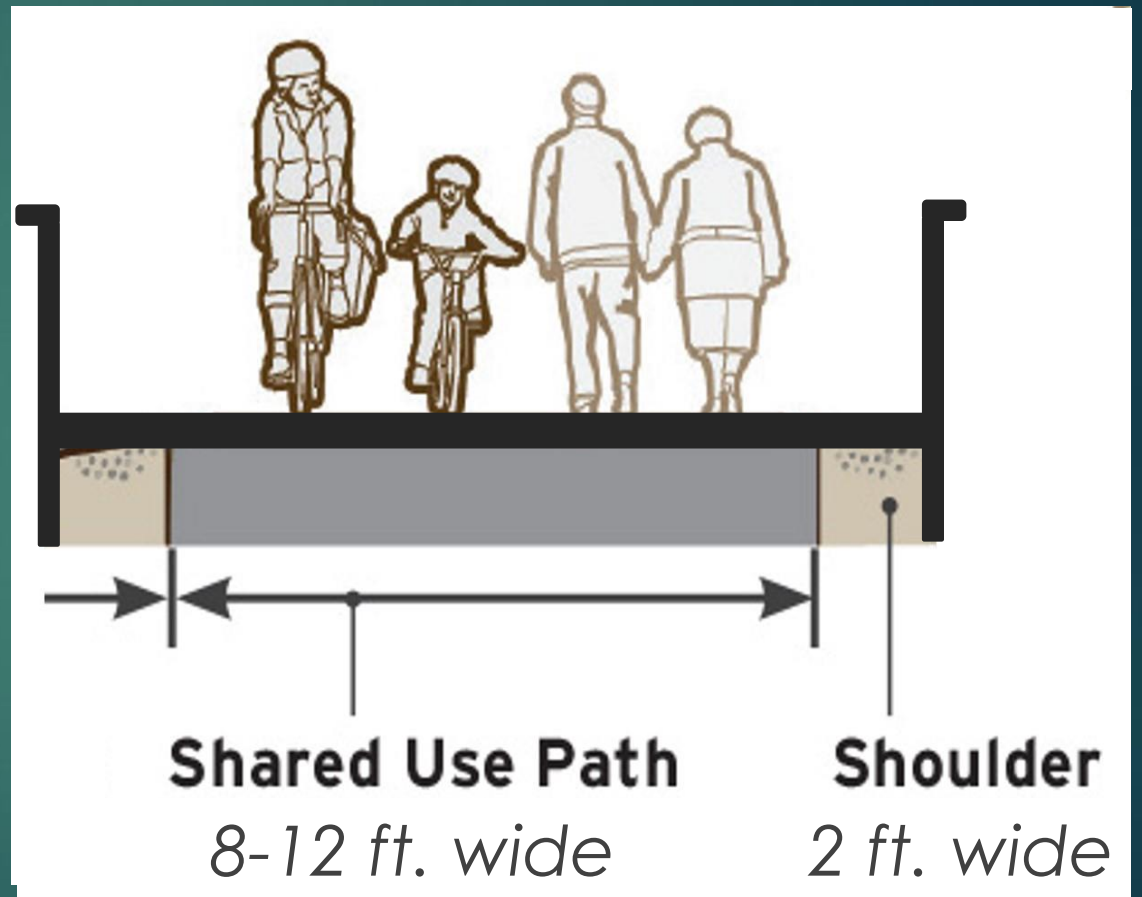



# Scenarios to Evaluate

- 1. Re-use/Rehabilitation**
- 2. New Bridge at Same Location**
- 3. New Bridge Adjacent**

# Scenario 1 – Bridge Re-use / Rehabilitation

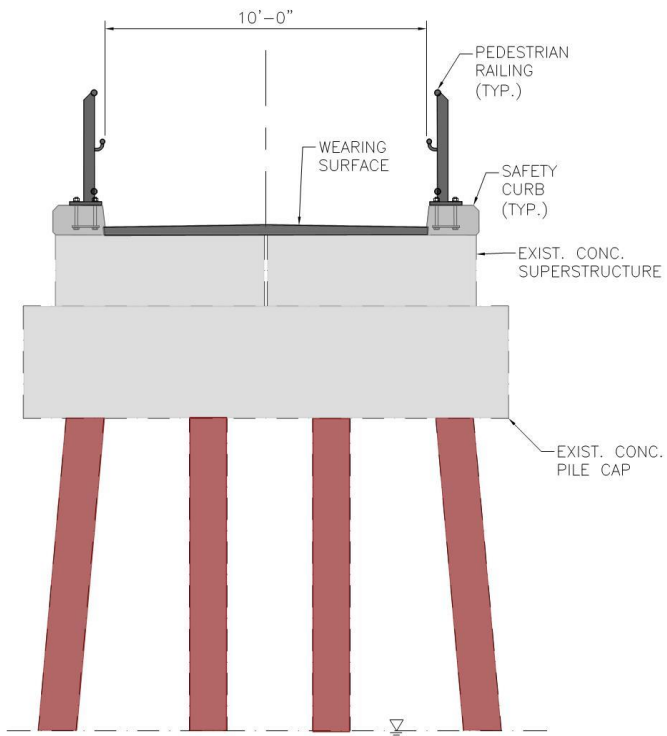

10 FT REHAB OPTION  
NOT TO SCALE



10 Feet Wide



14 Feet Wide

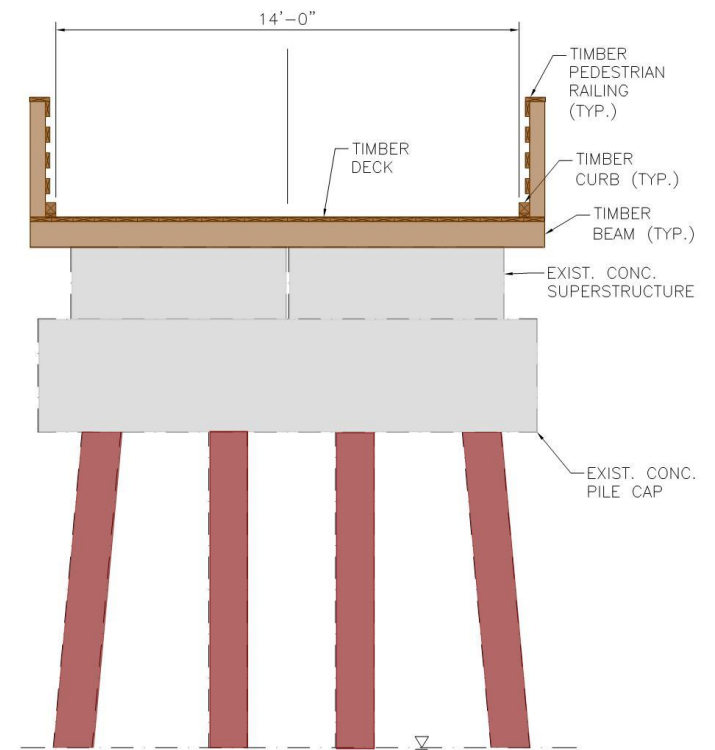

14 FT TIMBER REHAB OPTION  
NOT TO SCALE



# Scenarios 2/3 – New Bridge

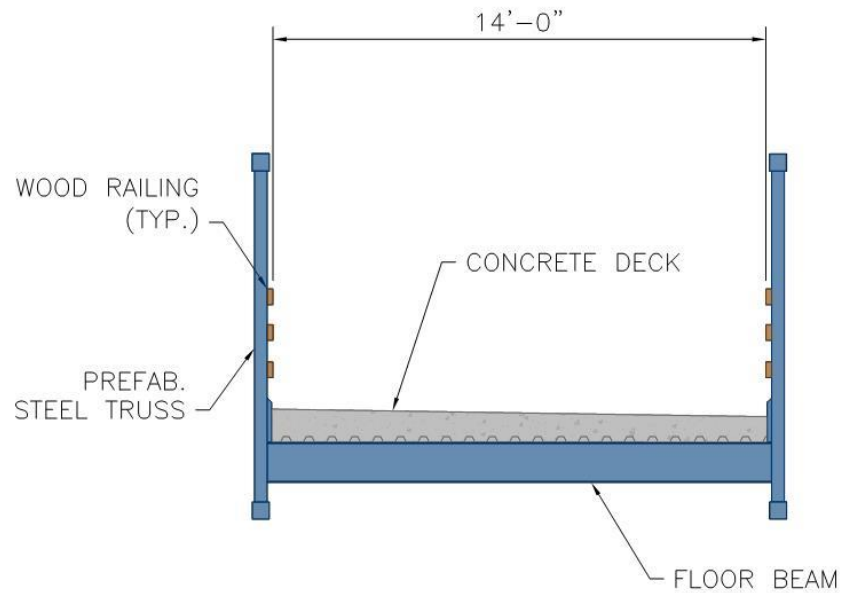

14 FT NEW TRUSS  
NOT TO SCALE



# Path Approaches at Bridge



# Culvert Outlet SW Corner



# DCR Blue Heron Trail Connection

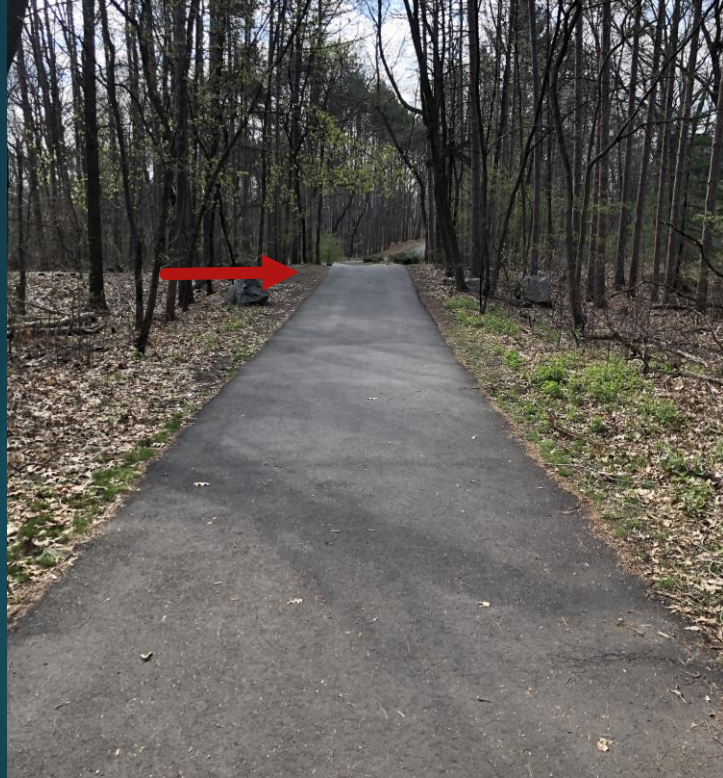

# Barry Price Center Parking Lot & Driveway



# Path Connections – Scenarios 1 & 2 – using existing alignment





# Path Connections – Scenario 3



# Future Christina Street Crossing Considerations



# Questions/Comments

- ▶ We will now open it up to your questions and comments.
- ▶ For those which we cannot respond to now, or if you prefer writing, please send any comments and questions to [crundelli@newtonma.gov](mailto:crundelli@newtonma.gov) prior to next Wednesday, June 2<sup>nd</sup> at 5pm!

