



Friends of Crystal Lake

CPC Meeting, June 8, 2021



Louise Levingston with Ray, Sonya and Lorriane Sciegienny, April 2006

(The original Friends of Crystal Lake)



Levingston Cove is in dire straits



- Last renovation was in 2000.
- Last renovation left gaps in erosion control measures.
- Heavy usage and rainfall have eroded the Cove.
- Walking through the Cove, the most popular activity enjoyed by visitors, has become less enjoyable and precarious.

We fully endorse the basic goals of The Task Force recovery plan. However, it is expansive, potentially overwhelming the area with crowds, traffic and parked cars. It creates a deck and beach at the shore (*in the middle of the walking path?*) enabling active recreation. All of these undermine conservation.

Basic Goals

- Ensure through pedestrian movement.
- Preserve and enhance opportunities for passive recreation and fishing.
- Improve how storm water moves through and is collected on site.
- Create a landscape that is stable and sustainable.
- Enhance and protect views.
- Improve water quality.
- Ensure accessibility across the site.

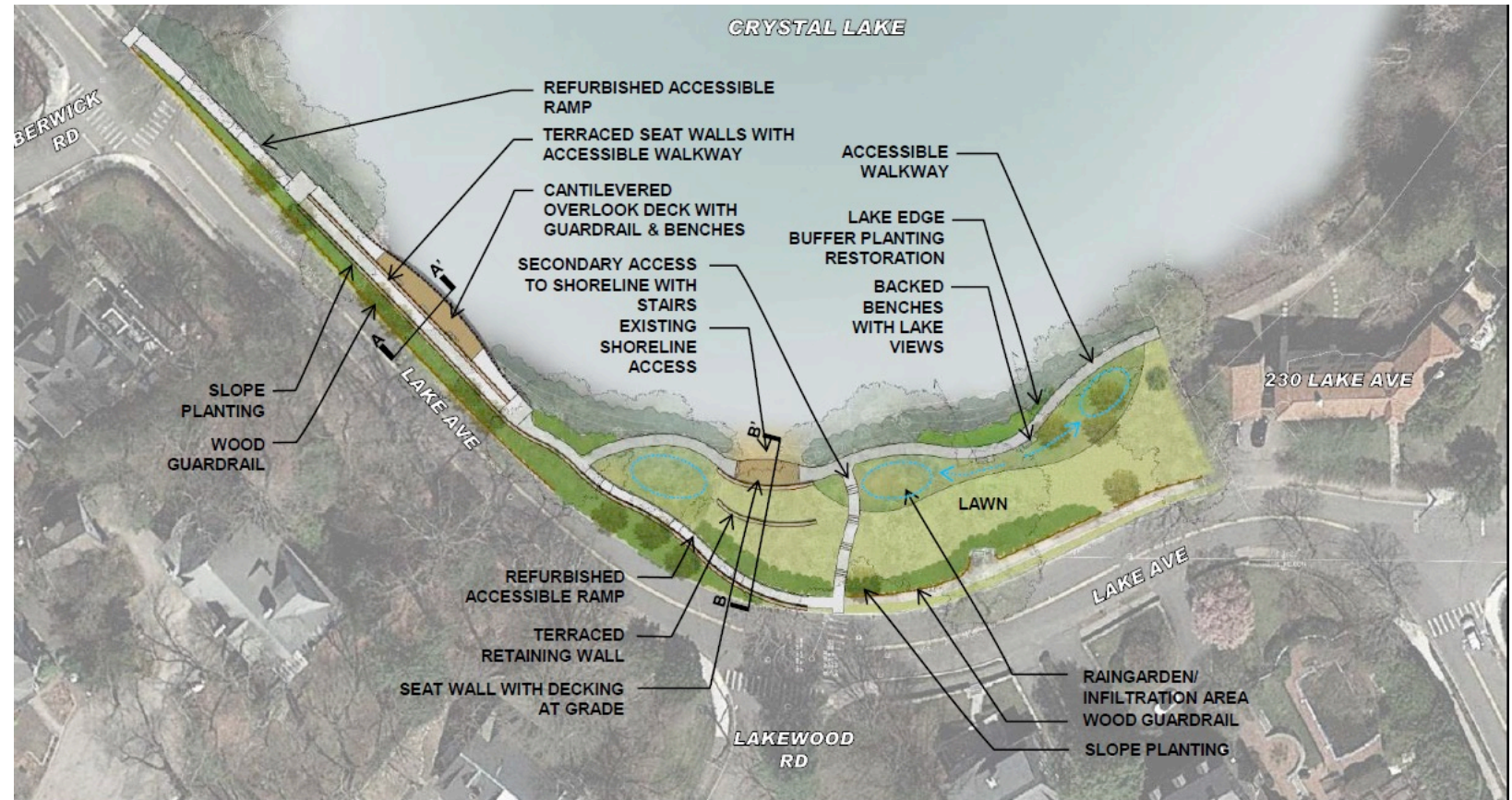

The Task Force Plan changes the naturalistic character of the Cove its namesake would wish to preserve with extensive hardscapes. The estimated cost is 1,440,344. The cost of naturalistically restoring the Cove in 2000 was about 80k.

PROPOSED OVERLOOK DECK

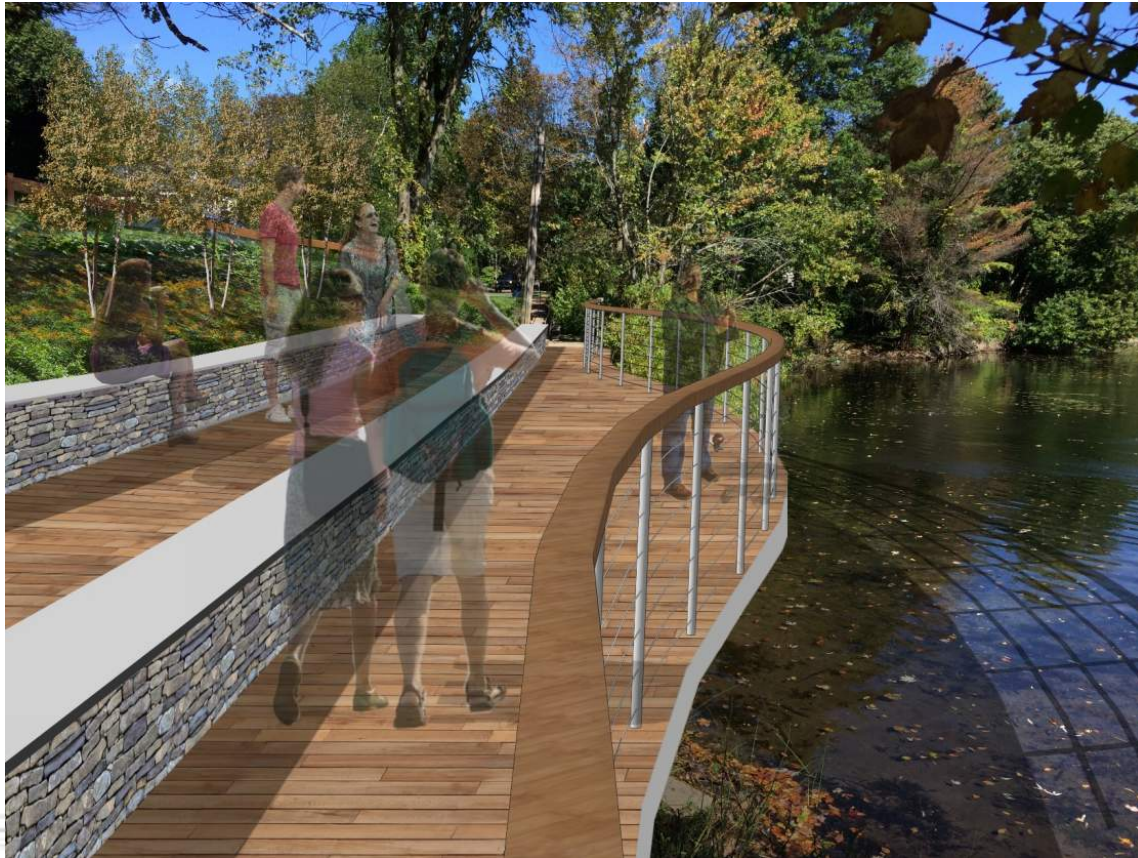

New Deck and Beach at Shore

Levingston Cove Improvements at Crystal Lake

PROPOSED SHORELINE ACCESS AREA



Friends of Crystal Lake proposes: Alternative Levingston Cove Preservation and Conservation Plan

Basic Goals

Ensure pedestrian movement through the entire Cove.

Provide a naturalistic open space with limited hardscapes.

Improve how storm water moves through the Cove and is collected on site.

Create a landscape that is stable and sustainable especially at the shore.

Enhance and protect views.

Improve water quality.

Ensure accessibility across the site.

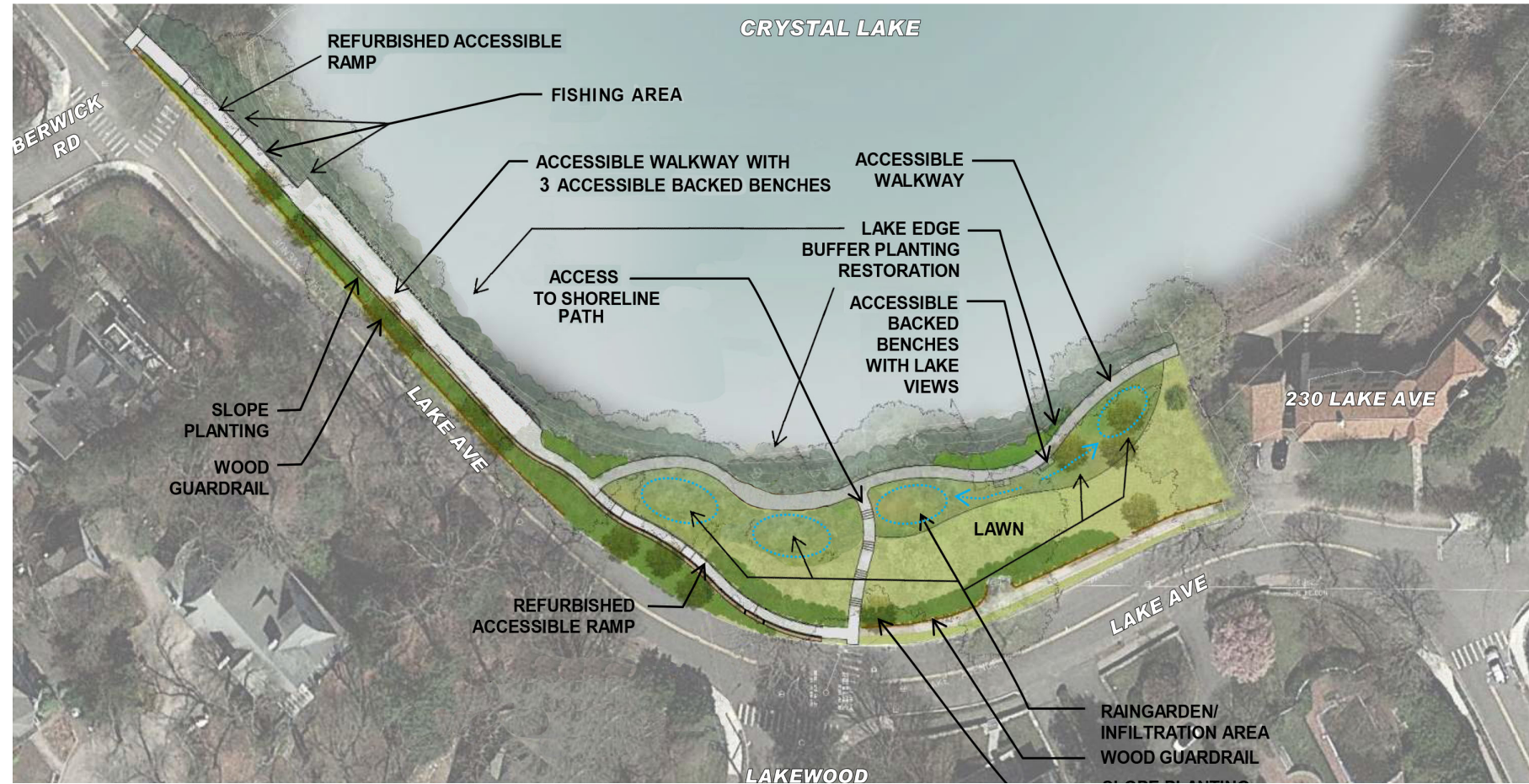

Friends of Crystal Lake

© 2021 CONFIDENTIAL & PROPRIETARY – NOT FOR DISTRIBUTION

Friends of Crystal Lake

Shore treatment: Naturalistic features rather than walls, decking and amphitheatre steps to a beach would be less costly and align better with conservation goals

Main Features

- Rain garden plantings surround path
- Accessible path possibly crushed sandstone with metal edge
- Large rocks, small rocks, stones, etc. to stabilize shore
- Possibly replace birch trees
- Existing bench seating



Friends of Crystal Lake

Friends of Crystal Lake

Viewing/Fishing Area: Naturalistic improvements aligned with preservation and conservation goals would be many times less costly than the Task Force plan

Main Features

- Fishing may be accessed at the far section which would be partially cleared as well as along the wall as it has been
- All three benches are accessible
- Buffer zone plantings provide filtration and beautification
- There are no added deck, rails or wall to detract from the views
- Terracing features contain erosion on the adjacent slope
- Rebuilding the wall provides ample additional seating. It could be set further back to widen the walkway.

Viewing/Fishing Area

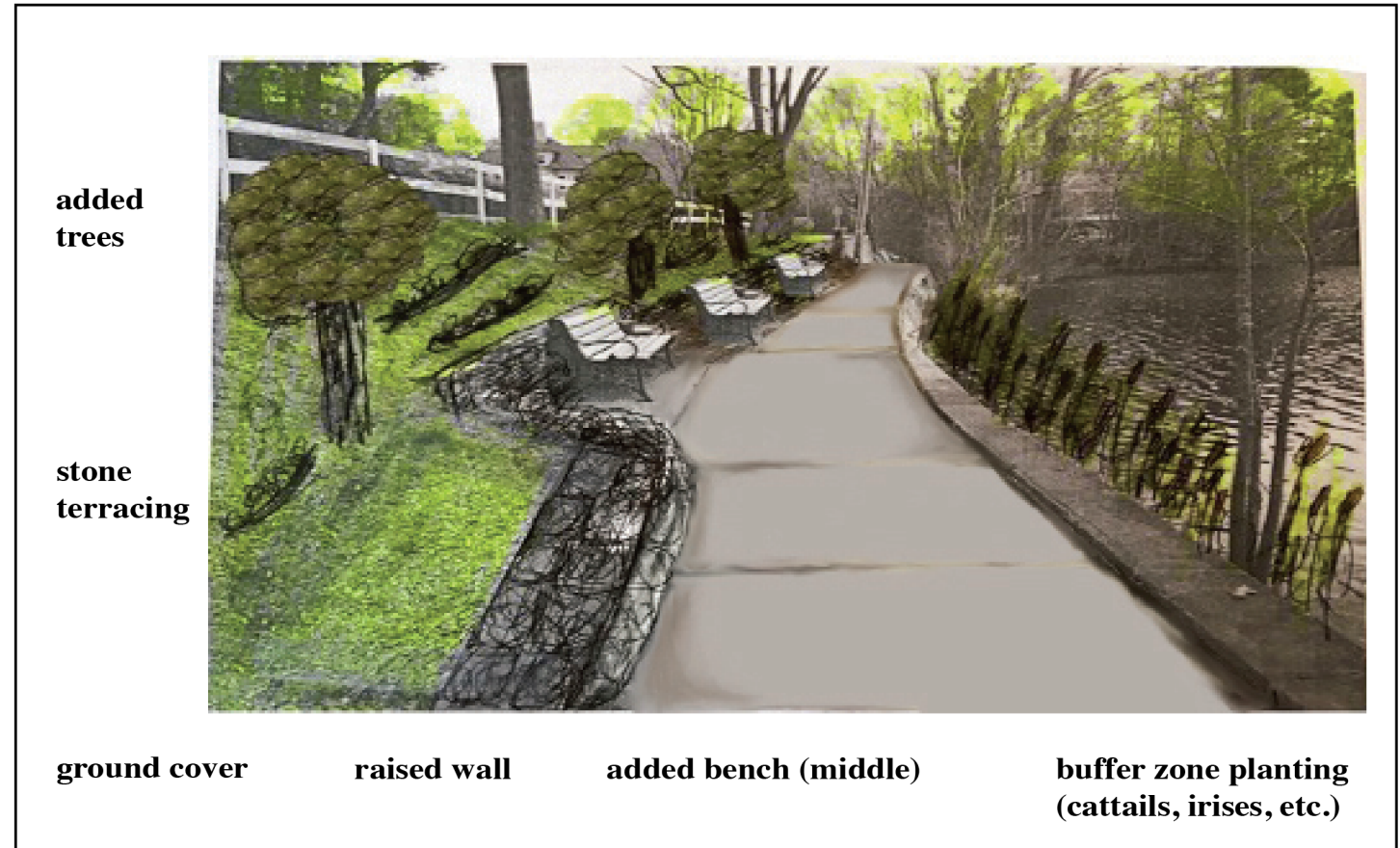

Friends of Crystal Lake

Improvements can be sustained with greater access to the shore from the official beach



Last summer, with the Bathhouse closed, we experienced a paradigm change

Without the historical limited schedule & programming, people used the entire park and enjoyed the freedom of open water swimming or staying near the shore with children

With unlocking one additional gate between May and October, except when the swim program is in session, visitors may enjoy shore access from the official beach throughout the year.

Excessive traffic may be drawn away from Levingston and Cronin Coves, thereby supporting posted regulations and conservation goals across the lake

Improvements may be further sustained with the following measures:

- **Reposting rules and regulations. We feel this is very important.** We have established laws going back a very long time regarding swimming. We have a boating ordinance from 1990 and decades of no after dark use of facilities. These and other long standing regulations should be reposted. Many are recent ordinances and carry fines.
- **Educational panels**—Educating visitors regarding sources of erosion, rain garden filtration, storm water issues, ecological restoration, water quality testing, etc. would promote healthy practices for visitors and the environment.
- Enlisting “**park rangers**” to assist visitors in understanding educational panels and regulations will better enable compliance with protective regulations.

How FOCL may support the Levingston Cove Project

- Rain gardens and plantings will need maintenance. FOCL may adopt gardens and help with this.
- Financial support for immediate Beach improvements at the Bathhouse, e.g. remove ugly metal benches and wooden boxes to allow for a natural shoreline.
- Discussion regarding shore access to the official beach in the off season. The ins and outs on this need to be thought through and we can work on this with PR&C.

Friends of Crystal Lake

What we are asking for:

1. Adjustment to the Task Force Plan in keeping with the rationale presented.
2. Measures to sustain improvements, including reposting regulations.
3. A public-private partnership going forward to collaborate on common goals of preservation, conservation and recreation at Crystal Lake.

For Friends of Crystal Lake

Sonya Kurzweil, President

Atilla Habip, Vice President

Ray Kurzweil, Secretary

Bob Beal, Treasurer