

DRIVING IN

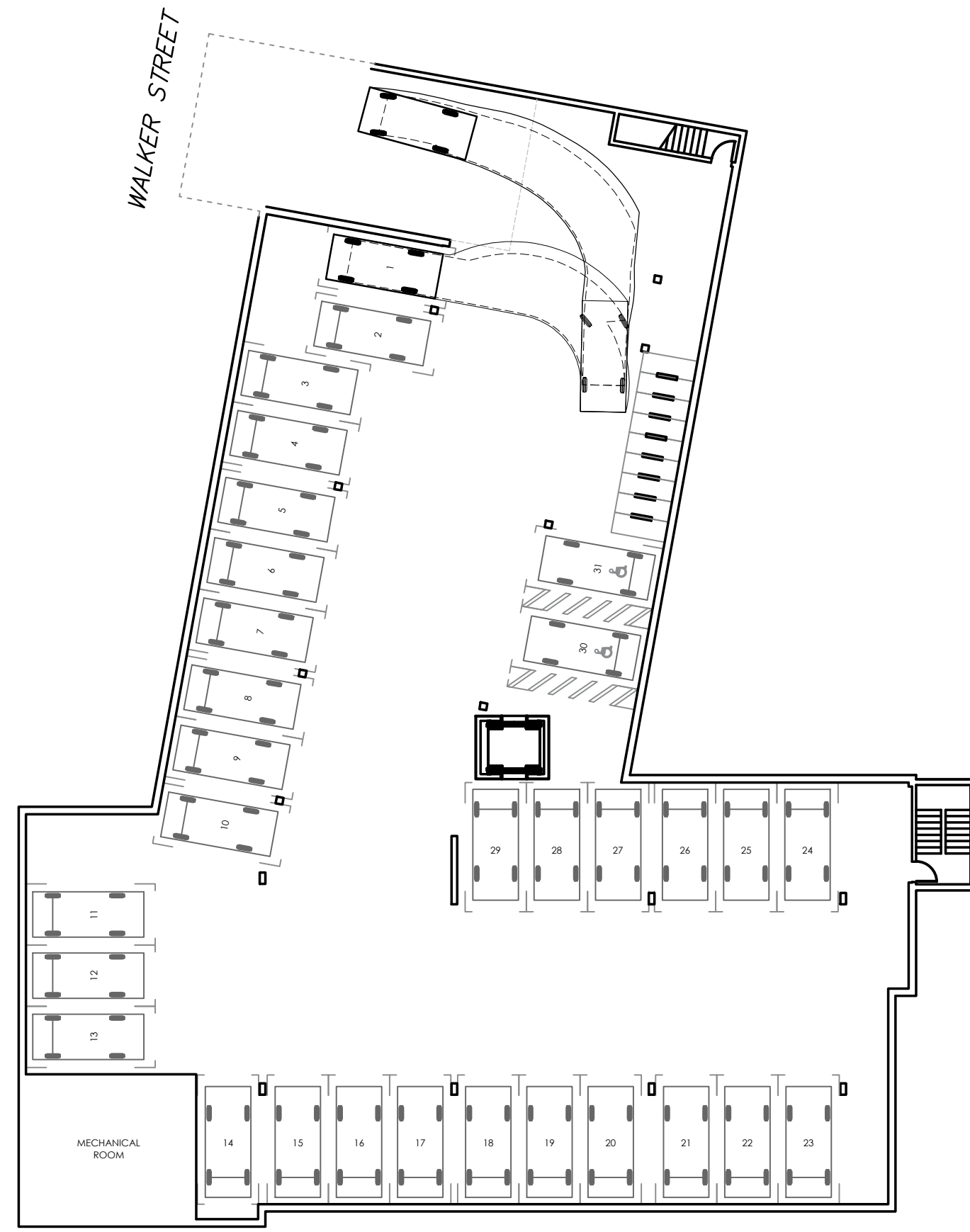

DRIVING OUT

PARKING SPOT #1

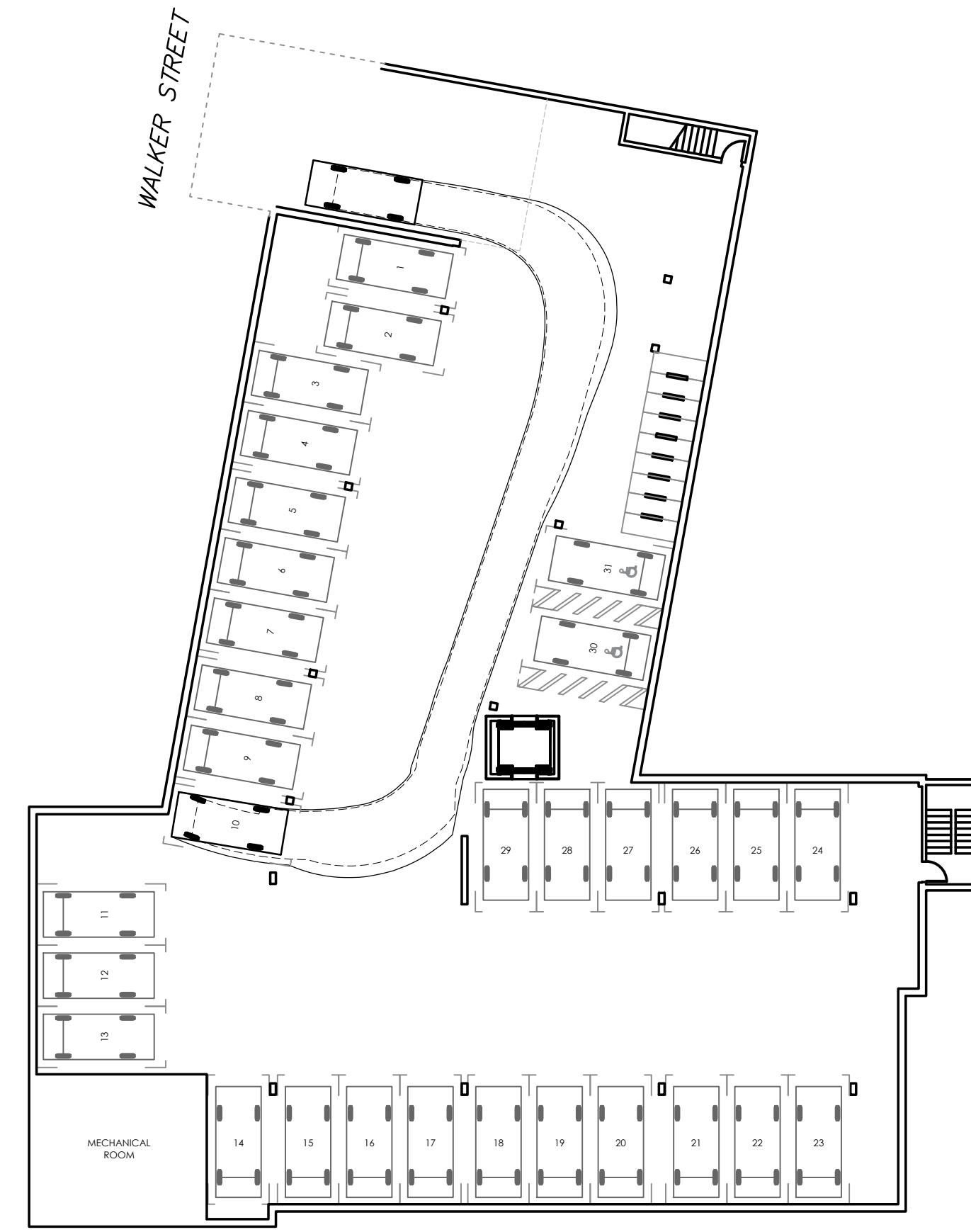

DRIVING IN

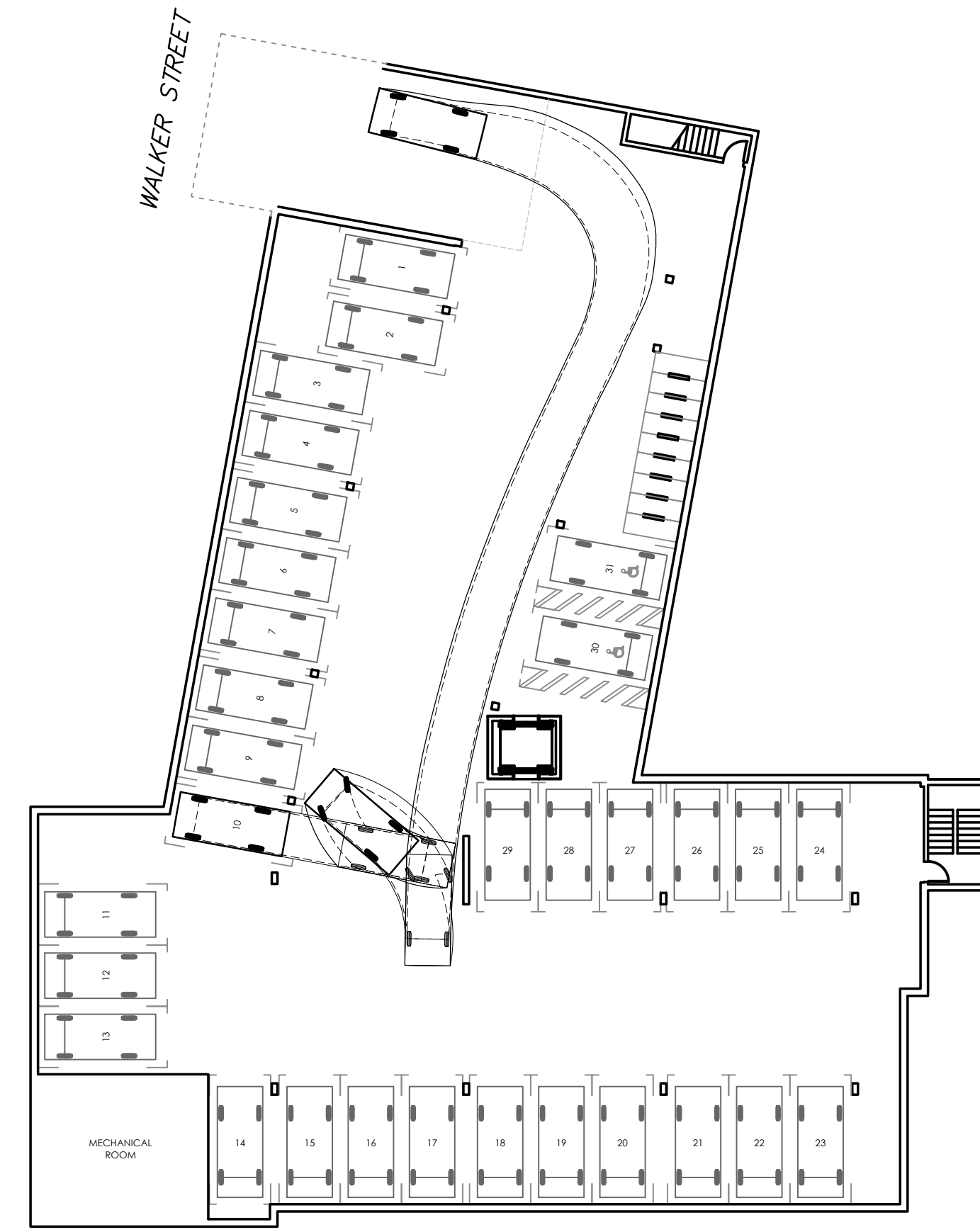

DRIVING OUT

PARKING SPOT #10

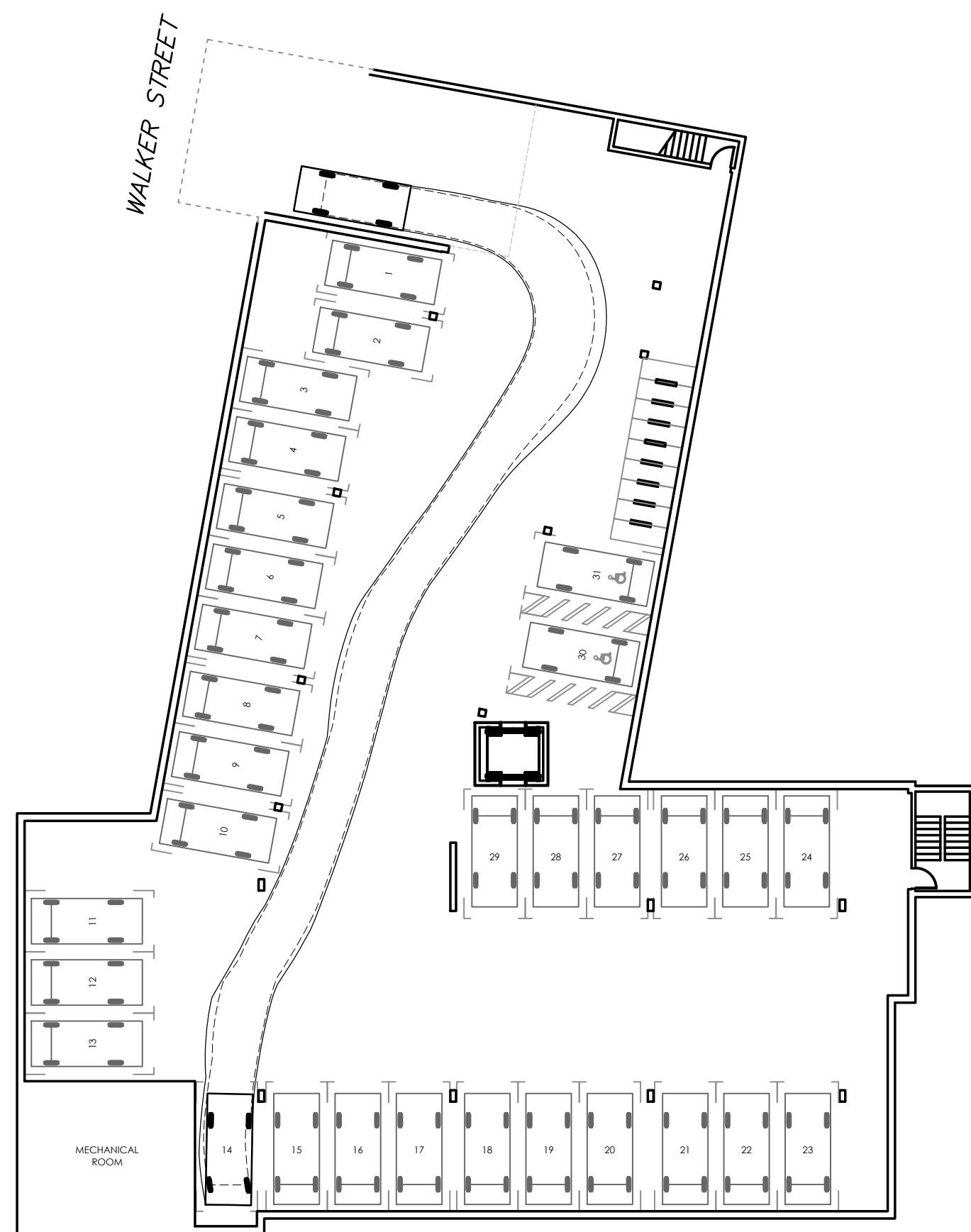

DRIVING IN

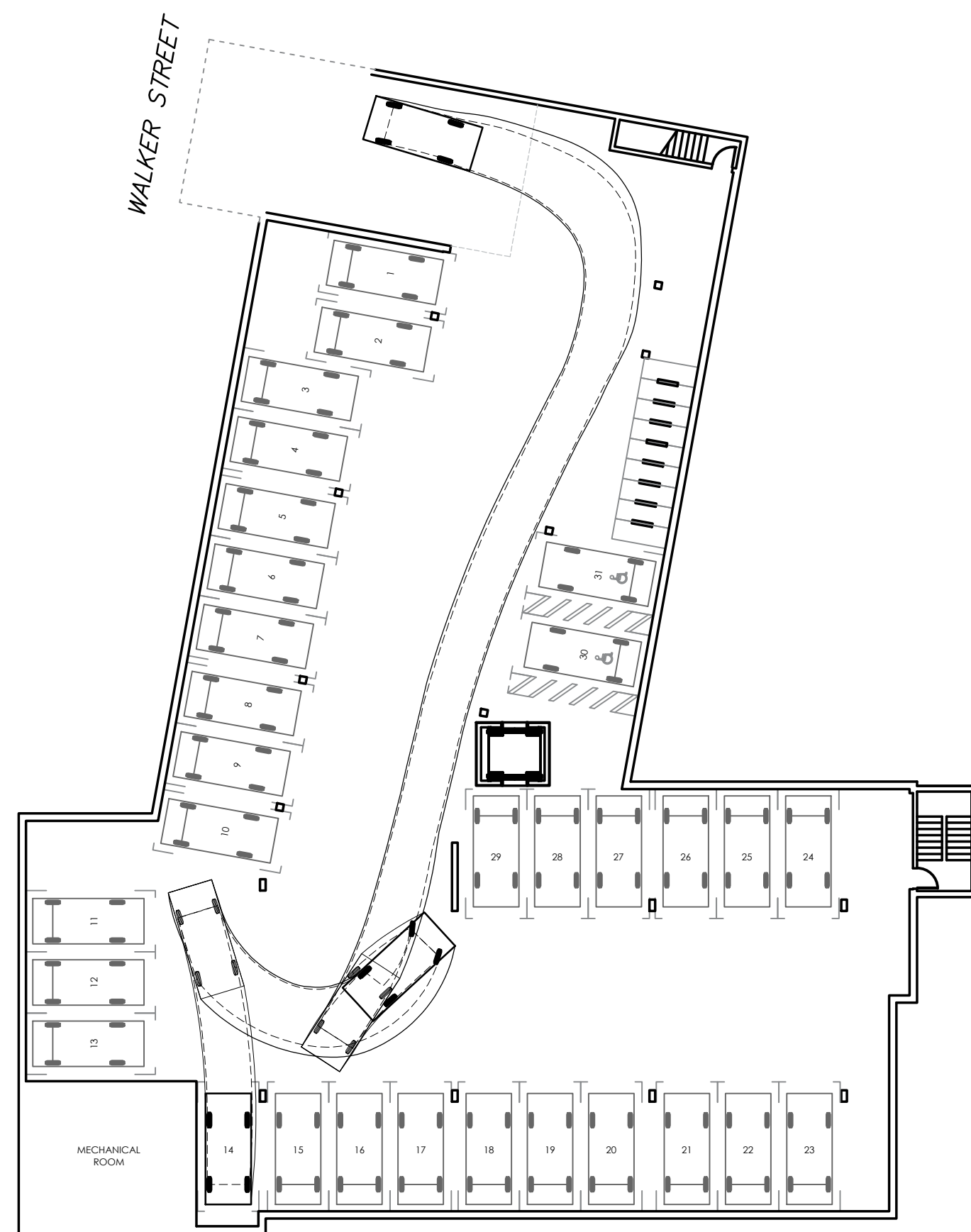

DRIVING OUT

PARKING SPOT #14

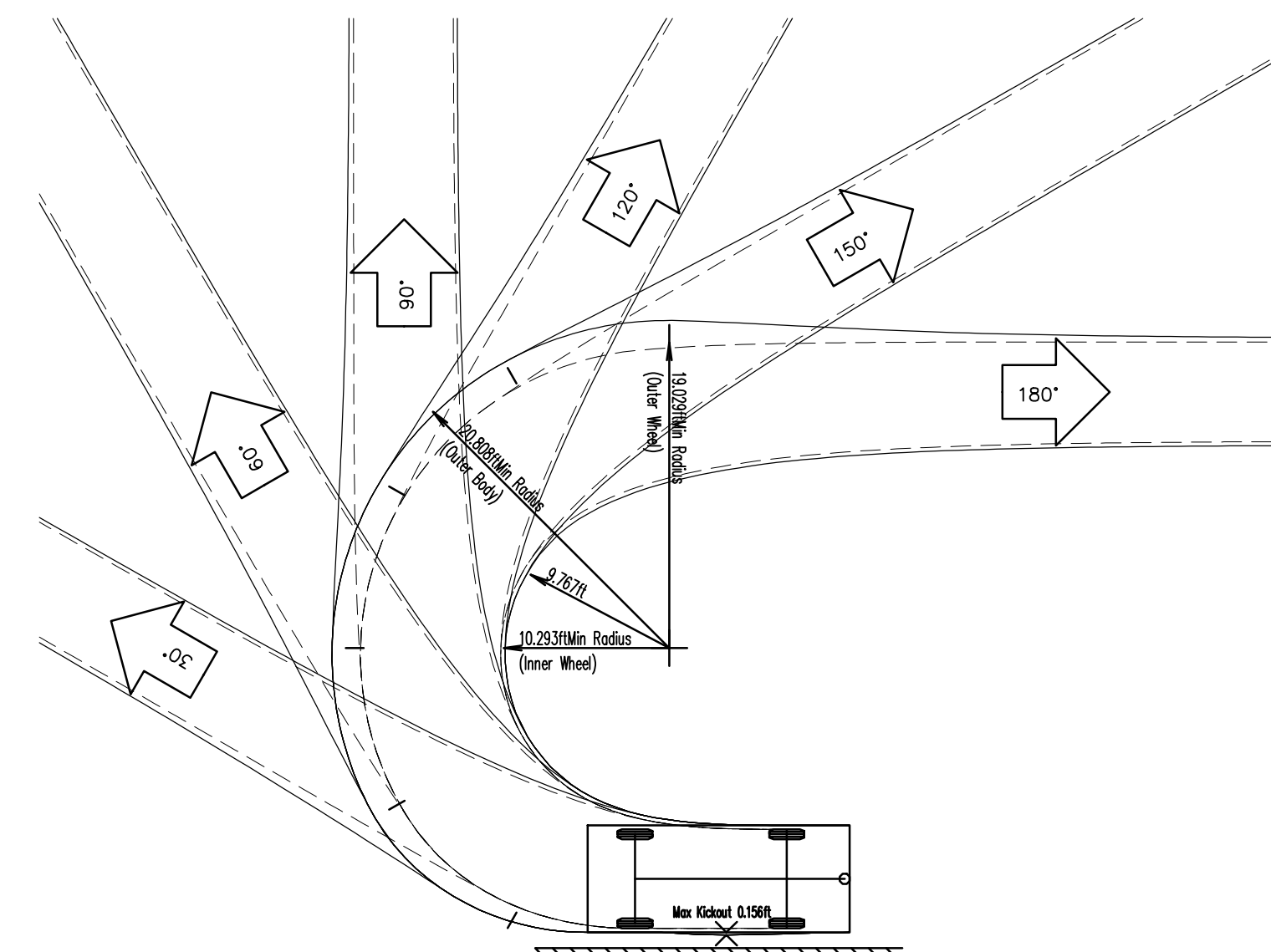

GENERIC SUV TURNING TEMPLATE
Turn(s) based upon a design speed of 5.00mph.

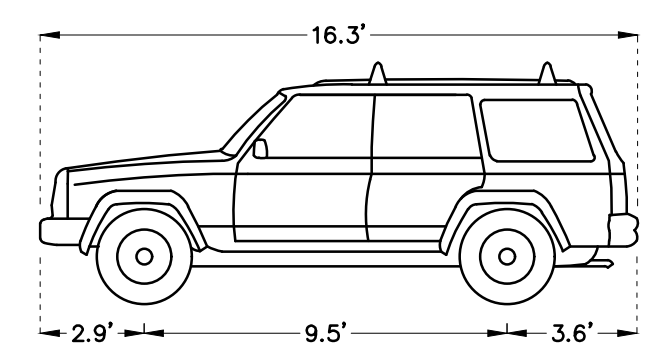

GENERIC SUV DIMENSIONS

Overall Length	16.312ft
Overall Width	6.673ft
Overall Body Height	6.249ft
Min Body Ground Clearance	0.917ft
Max Track Width	6.181ft
Lock-to-lock time	4.00s
Curb to Curb Turning Radius	19.029ft

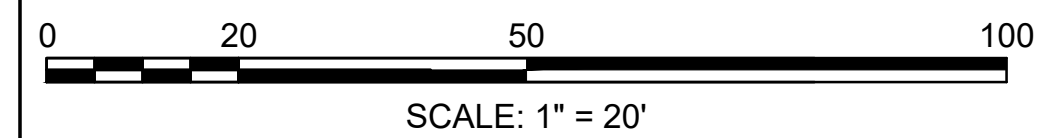

TURNING PLAN
NEWTON, MASSACHUSETTS
 SHOWING PROPOSED CONDITIONS AT
 #967-979 WASHINGTON STREET AND #92 & #96 WALKER STREET
 SCALE: 1" = 20' DATE: NOVEMBER 9, 2021

PROJECT: 220133

VTP
ASSOCIATES
 INC.

LAND SURVEYORS - CIVIL ENGINEERS.
 132 ADAMS STREET 2ND FLOOR SUITE 3
 NEWTON, MA 02458
 (617) 332-8271