

# NEWTON GIS DATA

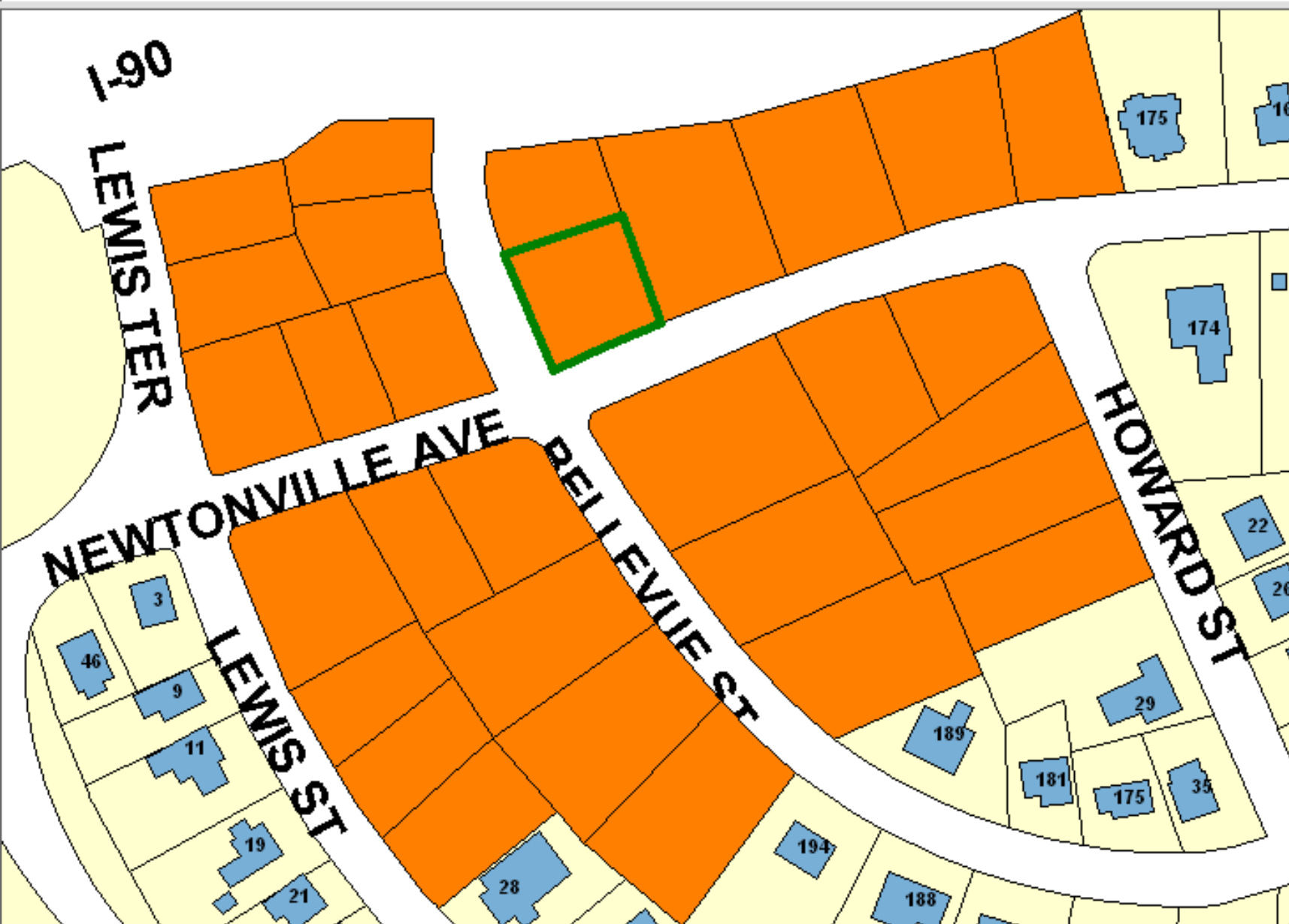

The information on this map is from the Newton Geographic Information System (GIS). The City of Newton cannot guarantee the accuracy of this information. Each user is responsible for determining the data's suitability for its intended purpose.

City departments will not approve applications based solely on GIS data. City staff correct errors as they are identified.

-  Buildings
-  Property Lines
-  Lakes & Rivers
-  Easements

Property Location:  
**229 BELLEVUE ST**

Property ID:  
**12017 0029**

Land Use: Lot Size:  
101 9700 Sq. Ft.



1 inch = Approximately 125 Feet

MAP DATE: November 08, 2021