

OTIS STREET

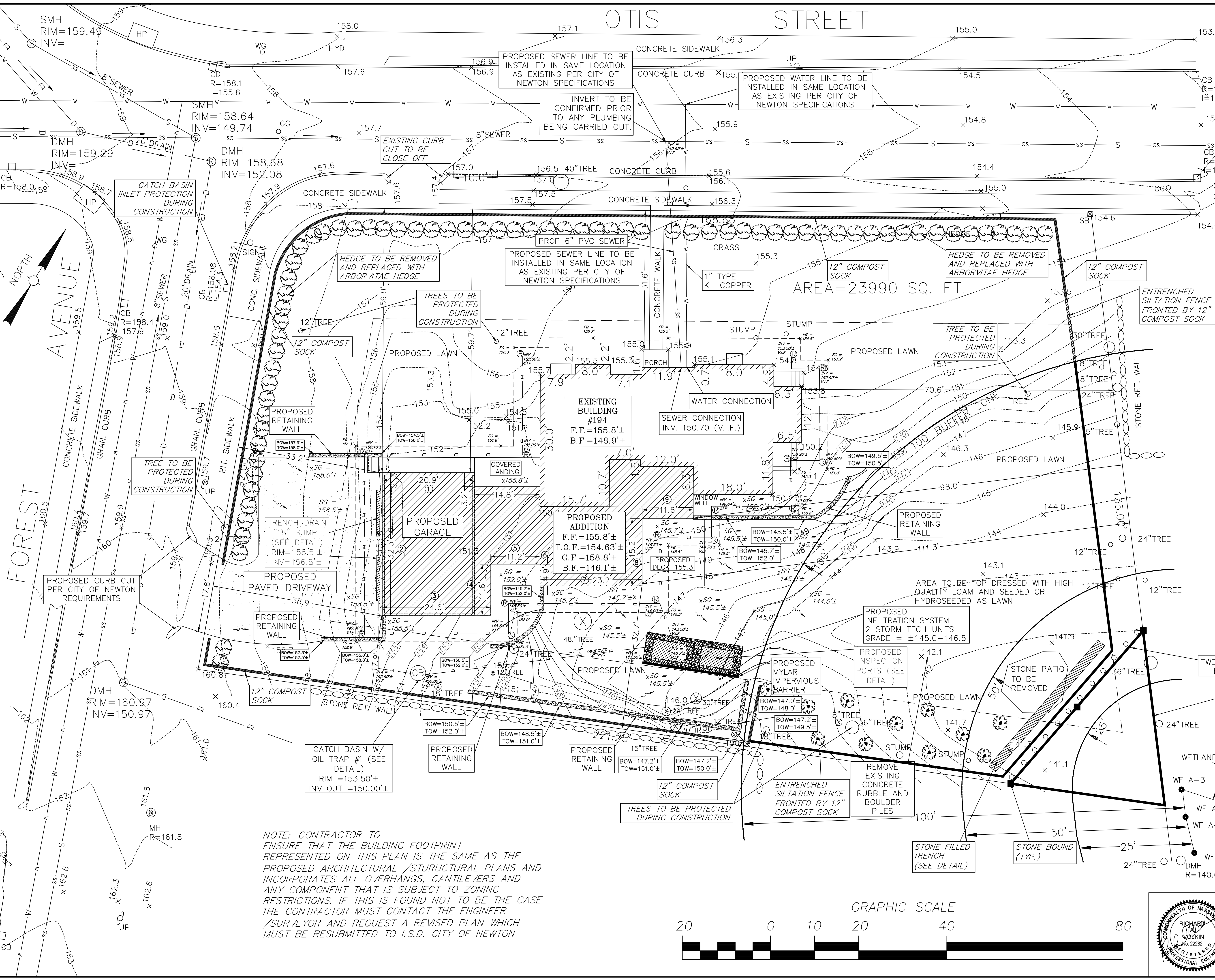

NOTE: RAV & ASSOCIATES, INC. ACCEPT NO LIABILITY FOR GROUND WATER OR OTHER SURFACE WATER IN BASEMENT

LEGEND:

⊠	CATCH BASIN
CONC	CONCRETE
○	TREE
○	DMH
○	EMH
○	GG
GRAN.	GRANITE
HYD	HYDRANT
I=102.5	INVERT ELEVATION
☆	LP
R=105.65	RIM ELEVATION
○	SMH
○	SIGN
○	MH
○	WG
—12"D—	DRAIN LINE AND SIZE OF PIPE IN INCHES
—E—	ELECTRIC LINES
—6"G—	GAS LINE AND SIZE OF PIPE IN INCHES
—12"S—	SEWER LINE AND SIZE OF PIPE IN INCHES
—T—	TELEPHONE
—12"W—	WATER LINE AND SIZE OF PIPE IN INCHES
⊗	ROOF DRAIN AT THE DOWNSPOUTS
⊗	TREE TO BE REMOVED
⊗	PROPOSED WHITE SPRUCE 8' HEIGHT

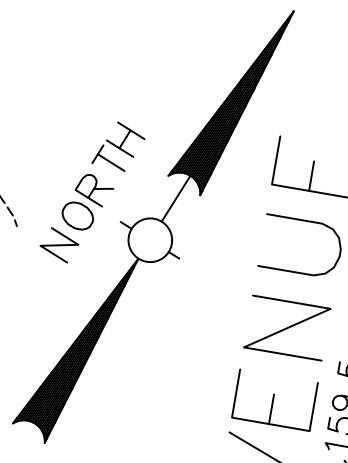

AREA=23990 SQ. FT.

NOTE: CONTRACTOR TO ENSURE THAT THE BUILDING FOOTPRINT REPRESENTED ON THIS PLAN IS THE SAME AS THE PROPOSED ARCHITECTURAL /STRUCTURAL PLANS AND INCORPORATES ALL OVERHANGS, CANTILEVERS AND ANY COMPONENT THAT IS SUBJECT TO ZONING RESTRICTIONS. IF THIS IS FOUND NOT TO BE THE CASE THE CONTRACTOR MUST CONTACT THE ENGINEER /SURVEYOR AND REQUEST A REVISED PLAN WHICH MUST BE RESUBMITTED TO I.S.D. CITY OF NEWTON



DATE	REVISION

SITE PLAN

194 OTIS STREET,
NEWTON, MASSACHUSETTS

RAV & Assoc., Inc.
21 HIGHLAND AVENUE
NEEDHAM, MASSACHUSETTS 02494
TELEPHONE: (781) 449-8200 FAX: (781) 449-8205

SCALE: 1"=10'

APPROVED: R.A.V.	DESIGNED BY: R.A.V.	DRAWING No.
DATE: 04/08/22	DRAWN BY: R.A.V.	1 OF 4
	CHECKED BY: R.A.V.	

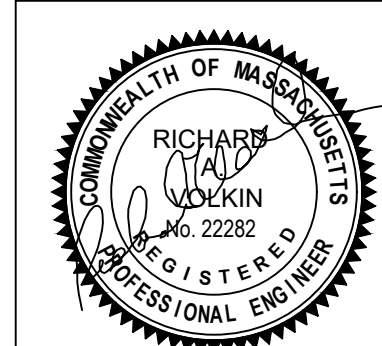

NOTES

- ELEVATIONS REFER TO CITY OF NEWTON DATUM.
- THE LOCATIONS AND ELEVATIONS OF ALL EXISTING UTILITIES SHALL BE CONSIDERED APPROXIMATE AND MUST BE VERIFIED BY THE CONTRACTOR PRIOR TO ANY CONSTRUCTION. THE CONTRACTOR SHALL VERIFY THE LOCATIONS OF ANY CROSSINGS OF PROPOSED AND EXISTING UTILITIES.
- MASSACHUSETTS STATE LAW REQUIRES UTILITY NOTIFICATION AT LEAST THREE BUSINESS DAYS PRIOR TO CONSTRUCTION. THE CONTRACTOR SHALL CALL DIG-SAFE AT 1-888-344-7233 IN ORDER TO COMPLY WITH STATE LAW.
- ALL UTILITY CONSTRUCTION SHALL CONFORM TO THE CITY OF NEWTON GENERAL CONSTRUCTION DETAILS, LATEST EDITION, PREPARED AND ISSUED BY THE NEWTON ENGINEERING DEPARTMENT. COPIES MAY BE OBTAINED AT THE OFFICE OF THE CITY ENGINEER. REFER TO NOTE 29 FOR DETAILS. NOTE: A TRENCH PERMIT MUST BE OBTAINED PRIOR TO ANY EXCAVATION BEING CARRIED OUT.
- PROPOSED SEWER PIPE SHALL BE 6" PVC SDR 35.
- PROPOSED WATER SERVICE SHALL BE 1" TYPE K COPPER.
- THIS PLAN IS BASED ON PREVIOUS SURVEY PERFORMED IN MARCH 2022 BY ANTONI SZERSZUNOWICZ (LICENSE #36394).
- ALL WORK SHALL BE SUBJECT TO THE INSPECTION BY AND APPROVAL OF THE CITY ENGINEER.
- NO EXCAVATION SHALL BE MADE BY THE CONTRACTOR IN ANY PUBLIC WAY OR UTILITY EASEMENT UNLESS AT LEAST FORTY-EIGHT (48) HOURS, EXCLUSIVE OF SATURDAYS, SUNDAYS, AND HOLIDAYS, BEFORE THE PROPOSED EXCAVATION IS TO BE MADE, HE HAS SUBMITTED, BY REGISTERED MAIL, WRITTEN NOTICE OF THE PROPOSED EXCAVATION TO THE FOLLOWING:
 - SUCH PUBLIC UTILITY COMPANIES AS SUPPLY GAS, ELECTRICITY, AND TELEPHONE SERVICE IN THE TOWN.
 - SUCH PRIVATE COMPANIES AS PROVIDE CABLE TELEVISION SERVICE IN THE CITY.
 - CITY OF NEWTON WATER & SEWER DEPARTMENT. SUCH NOTICE SHALL SET FORTH THE STREET NAME AND A REASONABLY ACCURATE DESCRIPTION OF THE LOCATION OF THE EXCAVATION.
- THE CONTRACTOR SHALL PROVIDE CITY OF NEWTON POLICE OFFICERS FOR THE DIRECTION AND CONTROL OF TRAFFIC, AS REQUIRED BY THE CITY ENGINEER.
- NO WORK SHALL BE PERFORMED UNTIL THE NECESSARY PERMITS ARE OBTAINED FROM THE CITY OF NEWTON PUBLIC WORKS DEPARTMENT.
- ALL TRENCHES IN PAVED STREETS SHALL BE TEMPORARILY PATCHED WITH 1.5 INCH DEPTH OF BITUMINOUS CONCRETE, LAID HOT AND MAINTAINED UNTIL THE PERMANENT PATCH IS INSTALLED.
- WARNING SIGNS SHALL CONFORM TO PAGE 66 OF THE CITY OF NEWTON GENERAL CONSTRUCTION DETAILS.
- ALL TOPSOIL, SUBSOIL OR IMPERVIOUS SOIL MUST BE EXCAVATED AND REMOVED BELOW THE LEACHING SYSTEM AND TO A DISTANCE 5' LATERALLY IN ALL DIRECTIONS BEYOND THE SIDES OF THE GALLEYS. BACKFILL AS REQUIRED WITH A CLEAN GRANULAR SAND, FREE FROM ORGANIC MATTER AND DELETERIOUS SUBSTANCES. THE SAND SHALL HAVE A PERCOLATION RATE OF 2 MINUTES PER INCH OR FASTER.
- IN CASES WHERE LEDGE OR BOULDERS ARE ENCOUNTERED, RAV & ASSOCIATES, INC. WILL NOT BE RESPONSIBLE FOR THE AMOUNT OF ROCK ENCOUNTERED.
- IF ANY PART OF THIS DESIGN IS TO BE ALTERED IN ANY WAY, THE DESIGN ENGINEER, AS WELL AS THE APPROVING AUTHORITIES, SHALL BE NOTIFIED IN WRITING BEFORE CONSTRUCTION.
- THE ROOF RUNOFF FROM THE ROOF SURFACES SHALL BE COLLECTED BY GUTTERS AND DIRECTED TO THE STORM WATER DRAINAGE SYSTEM.
- PRIOR TO AN OCCUPANCY PERMIT BEING ISSUED, AN AS-BUILT PLAN MUST BE SUBMITTED TO THE ENGINEERING DIVISION IN BOTH DIGITAL FORMAT AND HARD COPY. THE PLAN SHOULD SHOW ALL UTILITIES AND FINAL GRADES, TIES TO ALL GATES, VALVES, CLEAN-OUTS, CONNECTION POINTS AT MAINS, STRUCTURE ACCESS/MAINTENANCE COVERS, ANY EASEMENTS AND FINAL GRADING.
- THE APPLICANT WILL HAVE TO APPLY FOR A STREET OPENING & UTILITIES CONNECTION PERMITS AS WELL AS A SIDEWALK CROSSING PERMIT AND A TRENCH PERMIT WITH THE DPW.
- THE CONTRACTOR IS RESPONSIBLE FOR NOTIFYING THE DESIGN ENGINEER FOR INSPECTIONS OR AS-BUILT LOCATIONS. A MINIMUM OF 48 HOURS NOTICE IS REQUIRED PRIOR TO INSPECTIONS.
- ANY PROPOSED PVC PIPES UNDER PAVING OR CONCRETE WITH LESS THAN 30" OF COVER MUST BE REMOVED FROM THE SITE. (SEE PAGE 21, TOWN OF BELMONT GENERAL CONSTRUCTION DETAILS.)
- THE EXISTING WATER & SEWER SERVICES SHALL BE CUT AND CAPPED AT THE MAIN AND BE COMPLETELY REMOVED FROM THE SITE, REPLACED AS SPECIFIED AND PROPERLY BACKFILLED. THE ENGINEERING DIVISION MUST INSPECT THIS WORK; FAILURE TO HAVE THIS WORK INSPECTED MAY RESULT IN THE DELAY OF ISSUANCE OF THE UTILITY CONNECTION PERMIT.
- THE CONTRACTOR SHALL NOTIFY THE ENGINEERING DIVISION 48 HOURS IN ADVANCE AND SCHEDULE AN APPOINTMENT TO HAVE THE DRAINAGE SYSTEM, WATER & SEWER SERVICES INSPECTED. THE SYSTEM & UTILITIES MUST BE FULLY EXPOSED FOR THE INSPECTOR. ONCE THE INSPECTOR IS SATISFIED, THE SYSTEM & UTILITIES MAY THEN BE BACKFILLED.
- NO WORK IS ALLOWED WITHIN A CITY OF NEWTON RIGHT-OF-WAY BETWEEN NOVEMBER 15TH AND APRIL 15TH. IF AN EMERGENCY EXISTS OR THERE ARE EXTENUATING CIRCUMSTANCES, APPLICANT MAY REQUEST PERMISSION FROM THE CITY ENGINEER. IF ALLOWED, SPECIAL CONSTRUCTION REQUIREMENTS WILL BE REQUIRED, AND AS SUCH IT IS RECOMMENDED THAT THE APPLICANT OR APPLICANT'S REPRESENTATIVE CONTACT THE CITY OF NEWTON ENGINEERING DEPARTMENT PRIOR TO START OF WORK FOR CLARIFICATION.
- AT THE END OF CONSTRUCTION, ALL DRAINAGE STRUCTURES ARE TO BE CLEANED OF SILT, STONES AND OTHER DEBRIS.
- DURING CONSTRUCTION, THE EROSION CONTROL MEASURES SHALL BE INSPECTED ONCE PER WEEK AND WITHIN 24 HOURS OF ANY STORM EVENT GENERATING MORE THAN 1/2" OF RAINFALL. THE EROSION CONTROL MEASURES SHALL BE CLEANED REGULARLY AND ADJUSTED IF NECESSARY TO ENSURE THAT NO SILT OR DEBRIS LEAVES THE SITE.
- WITH EXCEPTION OF GAS UTILITY SERVICES, ALL UTILITY TRENCHES WITHIN ANY CITY OF NEWTON RIGHT-OF-WAY WILL BE BACKFILLED WITH TYPE IE (EXCAVATABLE) CONTROLLED DENSITY FILL, AS SPECIFIED BY THE CITY OF NEWTON ENGINEERING SPECIFICATIONS.
- ALL CONSTRUCTION ACTIVITIES WITHIN THE CITY OF NEWTON RIGHT-OF-WAY MUST FULLY COMPLY WITH ALL OF CITY OF NEWTON CONSTRUCTION SPECIFICATIONS AS WELL AS 521 CMR 21.00 AND 22.00
- THE NEW SEWER SERVICE LINE MUST BE PRESSURE TESTED PRIOR TO USE. THE RESULT OF THE TEST MUST BE PROVIDED TO THE ENGINEERING DIVISION PRIOR TO THE ISSUANCE OF A CERTIFICATE OF OCCUPANCY. THE CONTRACTOR NEEDS TO NOTIFY THE ENGINEERING DIVISION 48 HOURS IN ADVANCE AND SCHEDULE AN APPOINTMENT TO HAVE THE PRESSURE TEST WITNESSED BY A CITY OF NEWTON ENGINEERING DEPARTMENT REPRESENTATIVE.
- THE CONTRACTOR NEEDS TO NOTIFY THE ENGINEERING DIVISION 48 HOURS IN ADVANCE AND SCHEDULE AN APPOINTMENT TO HAVE THE DRAINAGE SYSTEM INSPECTED. THE SYSTEM MUST BE FULLY EXPOSED FOR THE INSPECTOR. ONCE THE INSPECTOR IS SATISFIED, THE SYSTEM MAY THEN BE CONSTRUCTED.
- ALL SILTATION CONTROL NEEDS TO BE INSTALLED PRIOR TO ANY CONSTRUCTION. THE CONTRACTOR SHALL CONTACT THE CITY ENGINEER'S OFFICE FOR APPROVAL PRIOR TO COMMENCEMENT.
- ALL TRENCH EXCAVATION CONTRACTORS SHALL COMPLY WITH MGL CHAPTER 82A, TRENCH EXCAVATION SAFETY REQUIREMENTS, TO PROTECT THE GENERAL PUBLIC FROM UNAUTHORIZED ACCESS TO UNATTENDED TRENCHES. A TRENCH EXCAVATION PERMIT IS REQUIRED.
- APPROVAL OF THIS PLAN BY CITY OF NEWTON ENGINEERING DIVISION IMPLIES THAT THE PLAN MEETS THE MINIMAL DESIGN STANDARDS OF THE CITY OF NEWTON. HOWEVER, THE ENGINEERING DIVISION MAKES NO REPRESENTATION AND ASSUMES NO RESPONSIBILITY FOR THE DESIGN(S) IN TERMS OF SUITABILITY FOR THE PARTICULAR SITE CONDITIONS OR OF THE FUNCTIONABILITY OR PERFORMANCE OF ANY ITEMS CONSTRUCTED IN ACCORDANCE WITH THE DESIGN(S). THE TOWN OF BELMONT ASSUMES NO LIABILITIES FOR DESIGN ASSUMPTION, ERRORS OR OMISSIONS BY THE ENGINEER OF RECORD.
- PER CITY OF NEWTON ORDINANCE NO.B-42, COUNCIL ITEM #251-19, BUILDING SEWER, WATER SERVICE PIPE & SIDEWALK/CURB REPLACEMENT ORDINANCE. THE APPLICANT IS REQUIRED TO INSTALL/REPLACE SIDEWALK & CURB ALONG THE ENTIRE FRONTAGE. THIS SHALL INCLUDE APPROPRIATE TRANSITION TO ADJOINING CURBING & WALKWAYS, INCLUDING ACCESSIBLE CURB CUTS & OTHER ACCESS AS REQUIRED. THE ENGINEERING CONSTRUCTION INSPECTOR MAKES A DETERMINATION, BASED ON THE MATERIAL AND MANNER OF CONSTRUCTION OF THE EXISTING SIDEWALK AND CURB, THAT THE EXISTING SIDEWALK AND CURB HAS THE ABILITY TO BE RE-SET OR REUSED WITHOUT REPLACEMENT.

ZONING LEGEND		
ZONING DISTRICT: SR2 SINGLE FAMILY-2		
	REQUIRED	PROPOSED
MIN. AREA	10,000 S.F	23,990 S.F.±
MIN. FRONTAGE	70'	168.65' / 92.00'
MIN. YARD FRONT	25'	31.5' (EXIST.)/33.2' (NEW)
SIDE	7.5'	17.9'
REAR	15'	70.6'
MAX. LOT COV.	30%	15%
MIN. OPEN SPACE	50%	21%
MAX. BLDG. HEIGHT	36'	35.42'±

IMPERVIOUS AREA	
EXISTING	PROPOSED
3,577 SF	4,596 SF
OPEN SPACE	
EXISTING	PROPOSED
3,811.20 SF (16%)	5,060.18 SF (21%)
LOT OVERAGE	
EXISTING	PROPOSED
1,529 SF (6.5%)	3,455 SF (15%)

IMPERVIOUS AREA	S.F.
EXIST BUILDING	1,529 SF
EXIST GARAGE	524 SF (TO BE REMOVED)
PROPOSED BUILDING	1,612 SF
EXIST/ PROPOSED DRIVEWAY	1,524 SF / 1,460 SF
TOTAL PROPOSED:	4,501 SF

INFORMATION ON THIS PLAN IS A RESULT ON A FIELD SURVEY PREFORMED BY LICENSED LAND SURVEYOR ANTONI SZERSZUNOWICZ, LICENSE NUMBER 36394 ON MARCH 2022

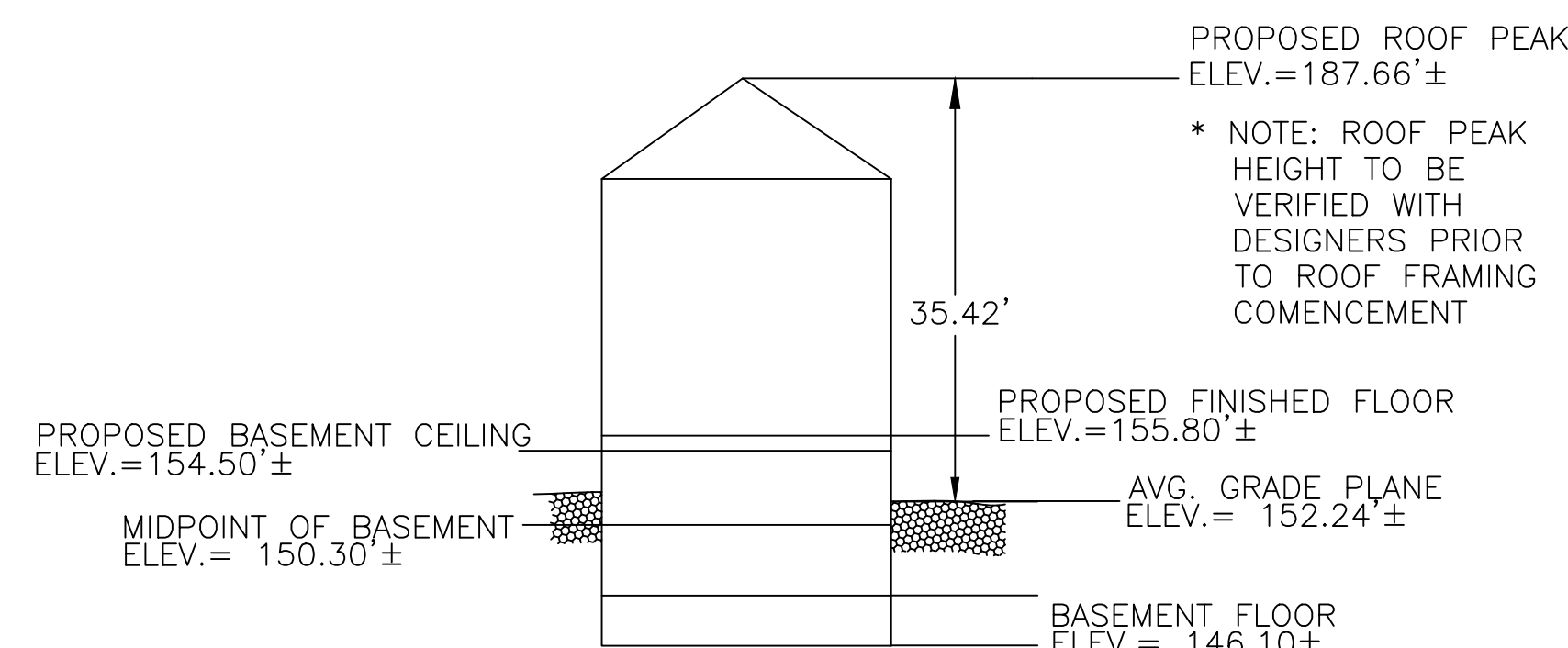

PROPOSED PROFILE

NOT TO SCALE

* MIDPOINT OF BASEMENT ELEVATION LOWER THAN AVERAGE GRADE ELEVATION THEREFORE PROPOSED BASEMENT MEETS DEFINITION OF BASEMENT

AVERAGE GRADE PLANE (ALL UNITS IN FEET)

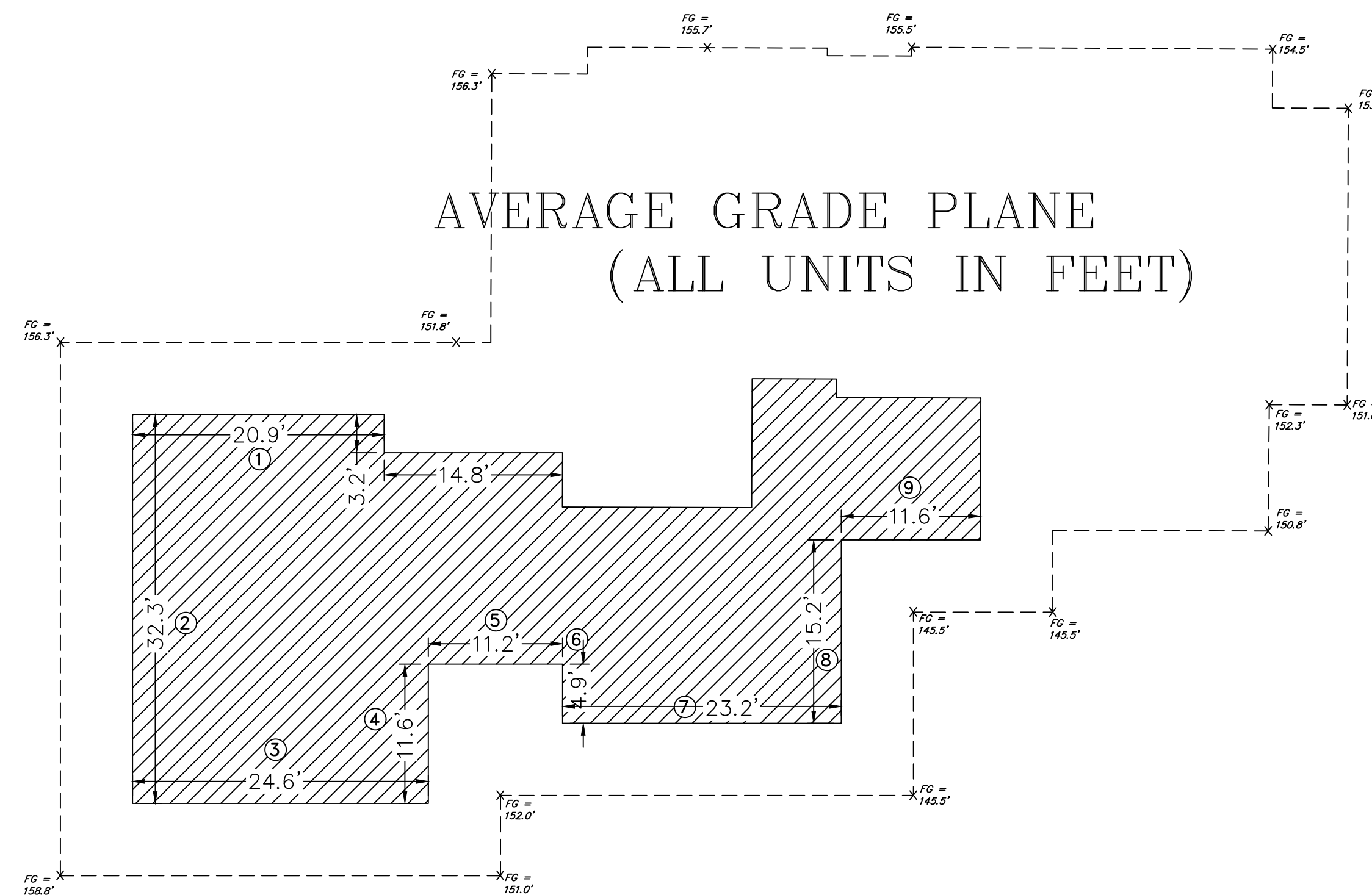

NOTE: DRAINAGE SYSTEM IS DESIGNED FOR 100 YEAR STORM EVENT FOR ALL RUNOFF FROM PROPOSED IMPERVIOUS AREAS SHOWN. CONTRACTOR SHALL NOT CONNECT SUMP PUMP TO THE SYSTEM WITHOUT APPROVAL FROM ENGINEERING DEPARTMENT.

NOTE: ANY PROPOSED RETAINING WALL IN SETBACK SHALL NOT EXCEED 4 FEET IN HEIGHT IN REFERENCE TO EXISTING GRADES.

NOTE: ANY TREE BEING REMOVED SHALL COMPLY WITH CITY OF NEWTON TREE ORDINANCE

NOTE: CONTRACTOR TO CONFIRM LOCATION OF DOWN SPOUTS PRIOR TO CARRYING OUT ANY DRAINAGE WORKS

NOTE: CONTRACTOR TO ENSURE ALL RAIN WATER FROM SPLASH BLOCKS (IF ANY) IS DIVERTED AWAY FROM BUILDING FOUNDATION AND DIVERTED AWAY FROM NEIGHBORING PROPERTIES

NOTE: ALL DRAIN LINES TO BE 4" PVC (SDR 35) UNLESS OTHERWISE NOTED

NOTE: SURFACE WATER TO BE DIVERTED FROM ALL SIDES OF FOUNDATION WALL

NOTE: ANY PROPOSED RETAINING WALLS SHALL BE DESIGNED BY OTHERS.

DATE	REVISION

All legal rights including, but not limited to, copyright and design patent rights, in the designs, arrangements and plans shown on this document are the property of RAV&Assoc., Inc. They may not be used or reused in whole or in part, except in connection with this project, without the prior written consent of RAV&Assoc., Inc. Written dimensions on these drawings shall have precedence over scaled dimensions. Contractors shall verify and be responsible for all dimensions and conditions on this project, and RAV&Assoc., Inc. must be notified of any variation from the dimensions and conditions shown by these drawings.

NOTES AND DETAILS
194 OTIS STREET,
NEWTON, MASSACHUSETTS

RAV & Assoc., Inc.
21 HIGHLAND AVENUE
NEEDHAM, MASSACHUSETTS 02494
TELEPHONE: (781) 449-8200 FAX: (781) 449-8205

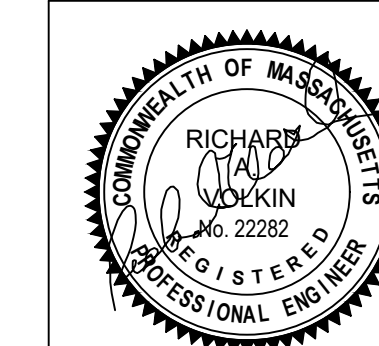

SCALE: 1"=10'	APPROVED: R.A.V.	DESIGNED BY: R.A.V.	DRAWING No. 2 OF 4
	DATE: 04/08/22	CHECKED BY: R.A.V.	

ACCEPTABLE FILL MATERIALS: STORMTECH SC-740 CHAMBER SYSTEMS

MATERIAL LOCATION	DESCRIPTION	AASHTO MATERIAL CLASSIFICATIONS	COMPACTION / DENSITY REQUIREMENT
D	FINAL FILL: FILL MATERIAL FOR LAYER 'D' STARTS FROM THE TOP OF THE 'C' LAYER TO THE BOTTOM OF FLEXIBLE PAVEMENT OR UNPAVED FINISHED GRADE ABOVE. NOTE THAT PAVEMENT SUBBASE MAY BE PART OF THE 'D' LAYER	N/A	PREPARE PER SITE DESIGN ENGINEER'S PLANS. PAVED INSTALLATIONS MAY HAVE STRINGENT MATERIAL AND PREPARATION REQUIREMENTS.
C	INITIAL FILL: FILL MATERIAL FOR LAYER 'C' STARTS FROM THE TOP OF THE EMBEDMENT STONE ('B' LAYER) TO 18" (450 mm) ABOVE THE TOP OF THE CHAMBER. NOTE THAT PAVEMENT SUBBASE MAY BE A PART OF THE 'C' LAYER.	AASHTO M145' A-1, A-2-4, A-3 OR AASHTO M43' 3, 357, 4, 467, 5, 56, 57, 6, 67, 68, 7, 78, 8, 89, 9, 10	BEGIN COMPACTIONS AFTER 12" (300 mm) OF MATERIAL OVER THE CHAMBERS IS REACHED. COMPACT ADDITIONAL LAYERS IN 6" (150 mm) MAX LIFTS TO A MIN. 95% PROCTOR DENSITY FOR WELL GRADED MATERIAL AND 90% RELATIVE DENSITY FOR PROCESSED AGGREGATE MATERIALS. ROLLER GROSS VEHICLE WEIGHT NOT TO EXCEED 12,000 lbs (53 kN). DYNAMIC FORCE NOT TO EXCEED 20,000 lbs (89 kN).
B	EMBEDMENT STONE: FILL SURROUNDING THE CHAMBERS FROM THE FOUNDATION STONE ('A' LAYER) TO THE 'C' LAYER ABOVE.	AASHTO M43' 3, 357, 4, 467, 5, 56, 57	NO COMPACTION REQUIRED.
A	FOUNDATION STONE: FILL BELOW CHAMBERS FROM THE SUBGRADE UP TO THE FOOT (BOTTOM) OF THE CHAMBER.	AASHTO M43' 3, 357, 4, 467, 5, 56, 57	PLATE COMPACT OR ROLL TO ACHIEVE A FLAT SURFACE.

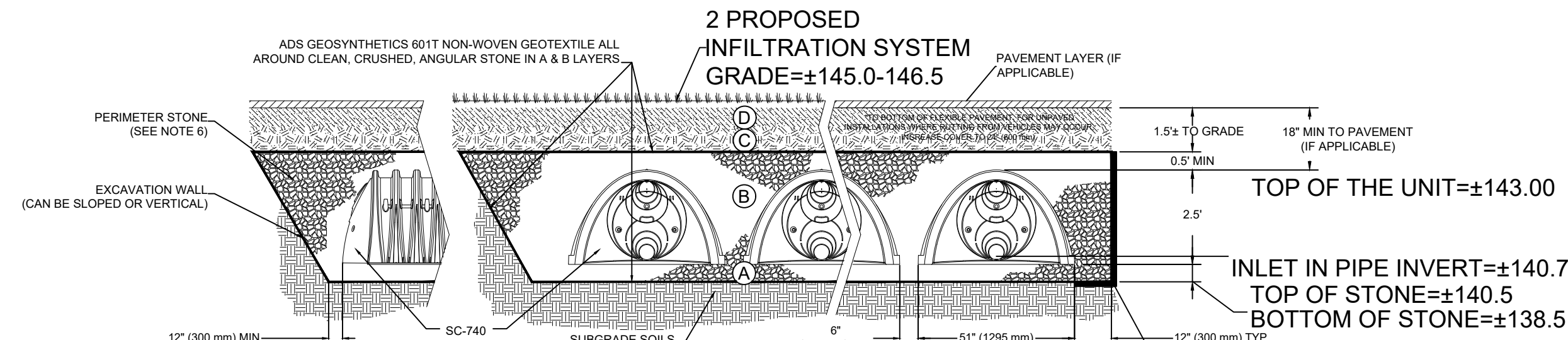

NOTES:

- SC-740 CHAMBERS SHALL CONFORM TO THE REQUIREMENTS OF ASTM F2418 "STANDARD SPECIFICATION FOR POLYPROPYLENE (PP) CORRUGATED WALL STORMWATER COLLECTION CHAMBERS", OR ASTM F2922 "STANDARD SPECIFICATION FOR POLYETHYLENE (PE) CORRUGATED WALL STORMWATER COLLECTION CHAMBERS".
- SC-740 CHAMBERS SHALL BE DESIGNED IN ACCORDANCE WITH ASTM F2787 "STANDARD PRACTICE FOR STRUCTURAL DESIGN OF THERMOPLASTIC CORRUGATED WALL STORMWATER COLLECTION CHAMBERS".
- "ACCEPTABLE FILL MATERIALS" TABLE ABOVE PROVIDES MATERIAL LOCATIONS, DESCRIPTIONS, GRADATIONS, AND COMPACTION REQUIREMENTS FOR FOUNDATION, EMBEDMENT, AND FILL MATERIALS.
- THE "SITE DESIGN ENGINEER" REFERS TO THE ENGINEER RESPONSIBLE FOR THE DESIGN AND LAYOUT OF THE STORMTECH CHAMBERS FOR THIS PROJECT.
- THE SITE DESIGN ENGINEER IS RESPONSIBLE FOR ASSESSING THE BEARING RESISTANCE (ALLOWABLE BEARING CAPACITY) OF THE SUBGRADE SOILS AND THE DEPTH OF FOUNDATION STONE WITH CONSIDERATION FOR THE RANGE OF EXPECTED SOIL MOISTURE CONDITIONS.
- PERIMETER STONE MUST BE EXTENDED HORIZONTALLY TO THE EXCAVATION WALL FOR BOTH VERTICAL AND SLOPED EXCAVATION WALLS.
- ONCE LAYER 'C' IS PLACED, ANY SOIL MATERIAL CAN BE PLACED IN LAYER 'D' UP TO THE FINISHED GRADE. MOST PAVEMENT SUBBASE SOILS CAN BE USED TO REPLACE THE MATERIAL REQUIREMENTS OF LAYER 'C' OR 'D' AT THE SITE DESIGN ENGINEER'S DISCRETION.

PROPOSED IMPERVIOUS BARRIER ALONG ALL SIDES OF STORAGE SYSTEM. FIRESTONE POND GUARD 45 MIL EPDM LINE (OR EQUAL)

STORMTECH GENERAL NOTES

- STORMTECH LLC ("STORMTECH") REQUIRES INSTALLING CONTRACTORS TO USE AND UNDERSTAND STORMTECH'S LATEST INSTALLATION INSTRUCTIONS PRIOR TO BEGINNING SYSTEM INSTALLATION.
- STORMTECH'S REQUIREMENTS FOR SYSTEMS WITH PAVEMENT DESIGN (ASPHALT, CONCRETE PAVERS, ETC.): MINIMUM COVER IS 18 INCHES NOT INCLUDING PAVEMENT; MAXIMUM COVER IS 96 INCHES INCLUDING PAVEMENT. FOR INSTALLATIONS THAT DO NOT INCLUDE PAVEMENT, WHERE RUTTING FROM VEHICLES MAY OCCUR, MINIMUM REQUIRED COVER IS 24 INCHES, MAXIMUM COVER IS 96 INCHES.
- THE CONTRACTOR MUST REPORT ANY DISCREPANCIES WITH CHAMBER FOUNDATION MATERIALS BEARING CAPACITIES TO THE DESIGN ENGINEER.
- AASHTO M288 CLASS 2 NON-WOVEN GEOTEXTILE (FILTER FABRIC) MUST BE USED AS INDICATED IN THE PROJECT PLANS.
- STONE PLACEMENT BETWEEN CHAMBERS ROWS AND AROUND PERIMETER MUST FOLLOW INSTRUCTIONS AS INDICATED IN THE MOST CURRENT VERSION OF STORMTECH'S INSTALLATION INSTRUCTIONS.
- BACKFILLING OVER THE CHAMBERS MUST FOLLOW REQUIREMENTS AS INDICATED IN THE MOST CURRENT VERSION OF STORMTECH'S INSTALLATION INSTRUCTIONS.
- THE CONTRACTOR MUST REFER TO STORMTECH'S INSTALLATION INSTRUCTIONS FOR A TABLE OF ACCEPTABLE VEHICLE LOADS AT VARIOUS DEPTHS OF COVER. THIS INFORMATION IS ALSO AVAILABLE AT STORMTECH'S WEBSITE. CONTRACTOR IS RESPONSIBLE FOR PREVENTING VEHICLES THAT EXCEED STORMTECH'S REQUIREMENTS FROM TRAVELING ACROSS OR PARKING OVER THE STORMWATER SYSTEM. TEMPORARY FENCING, WARNING TAPE AND APPROPRIATELY LOCATED SIGNS ARE COMMONLY USED TO PREVENT UNAUTHORIZED VEHICLES FROM ENTERING SENSITIVE CONSTRUCTION AREAS.
- THE CONTRACTOR MUST APPLY EROSION AND SEDIMENT CONTROL MEASURES TO PROTECT THE STORMWATER SYSTEM DURING ALL PHASES OF SITE CONSTRUCTION PER LOCAL CODES AND DESIGN ENGINEER'S SPECIFICATIONS.

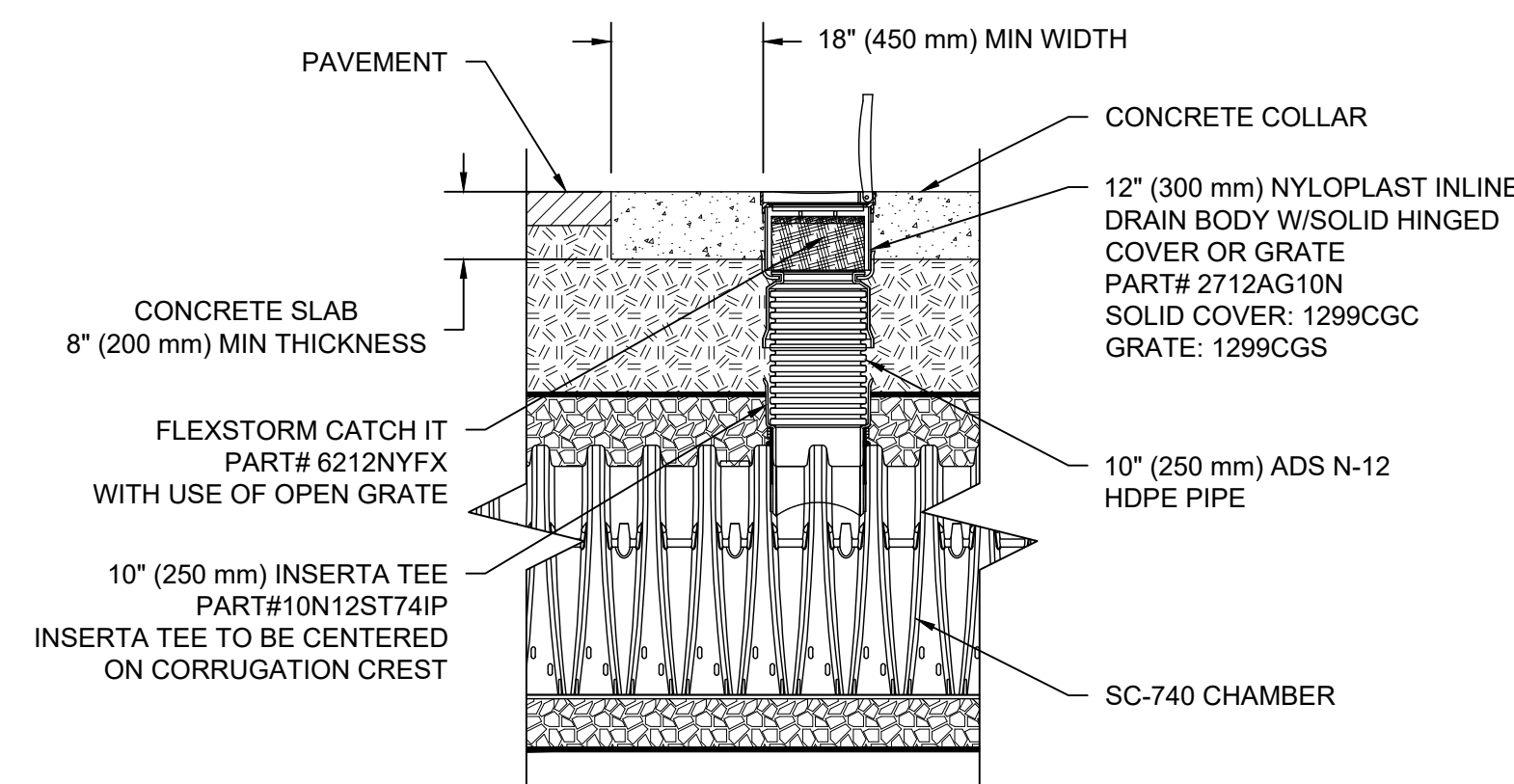

SC-740 INSPECTION PORT DETAIL

NTS

SC-740 TECHNICAL SPECIFICATION

NTS

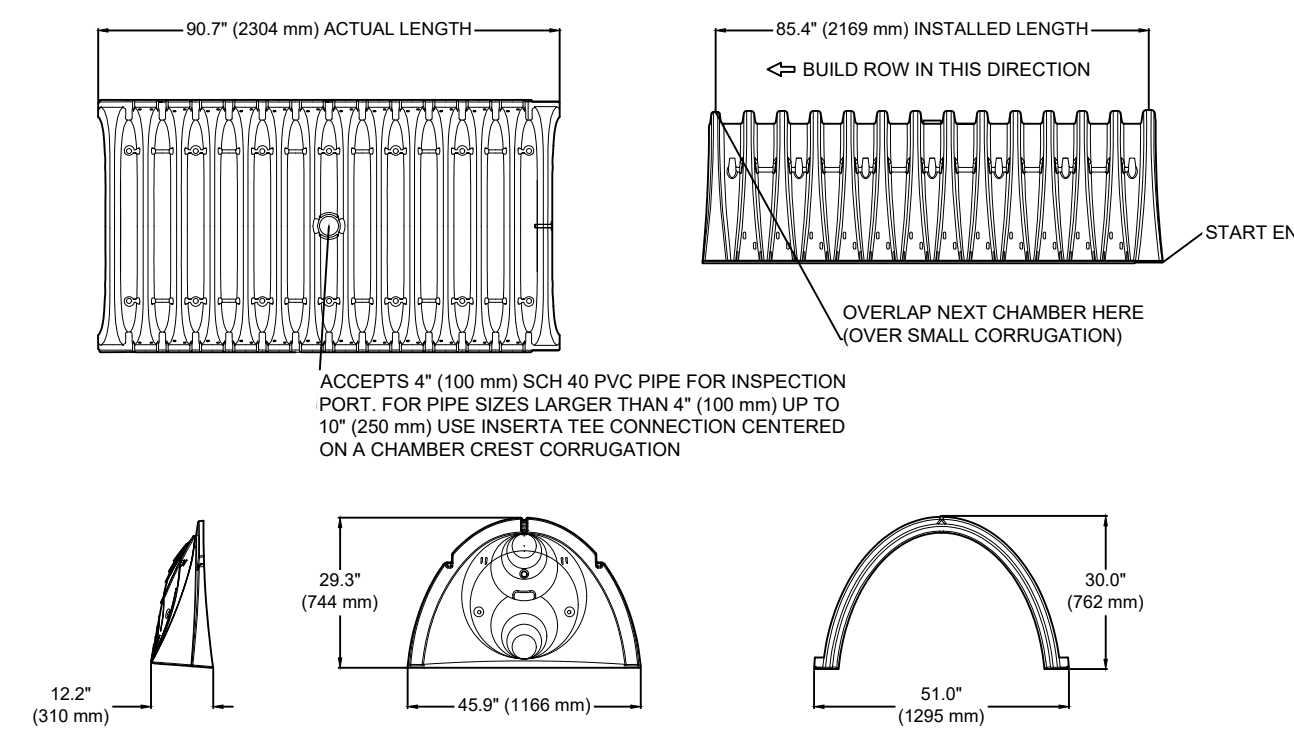

NOMINAL CHAMBER SPECIFICATIONS

SIZE (W X H X INSTALLED LENGTH)	51.0" X 30.0" X 85.4" (1295 mm X 762 mm X 2169 mm)
CHAMBER STORAGE	45.9 CUBIC FEET (1.30 m ³)
MINIMUM INSTALLED STORAGE*	74.9 CUBIC FEET (2.12 m ³)
WEIGHT	75.0 lbs. (33.6 kg)

*ASSUMES 6" (152 mm) STONE ABOVE, BELOW, AND BETWEEN CHAMBERS

STUBS AT BOTTOM OF END CAP FOR PART NUMBERS ENDING WITH "B"
STUBS AT TOP OF END CAP FOR PART NUMBERS ENDING WITH "T"

PART #	STUB	A	B	C
SC740EPE06T / SC740EPE06TPC	6" (150 mm)	10.9" (277 mm)	18.5" (470 mm)	---
SC740EPE06B / SC740EPE06BPC	---	---	---	0.5" (13 mm)
SC740EPE08T / SC740EPE08TPC	8" (200 mm)	12.2" (310 mm)	16.5" (419 mm)	---
SC740EPE08B / SC740EPE08BPC	---	---	---	0.6" (15 mm)
SC740EPE10T / SC740EPE10TPC	10" (250 mm)	13.4" (340 mm)	14.5" (368 mm)	---
SC740EPE10B / SC740EPE10BPC	---	---	---	0.7" (18 mm)
SC740EPE12T / SC740EPE12TPC	12" (300 mm)	14.7" (373 mm)	12.5" (318 mm)	---
SC740EPE12B / SC740EPE12BPC	---	---	---	1.2" (30 mm)
SC740EPE15T / SC740EPE15TPC	15" (375 mm)	18.4" (467 mm)	9.0" (229 mm)	---
SC740EPE15B / SC740EPE15BPC	---	---	---	1.3" (33 mm)
SC740EPE18T / SC740EPE18TPC	18" (450 mm)	19.7" (500 mm)	5.0" (127 mm)	---
SC740EPE18B / SC740EPE18BPC	---	---	---	1.6" (41 mm)
SC740EPE24B*	24" (600 mm)	18.5" (470 mm)	---	0.1" (3 mm)

ALL STUBS, EXCEPT FOR THE SC740EPE24B ARE PLACED AT BOTTOM OF END CAP SUCH THAT THE OUTSIDE DIAMETER OF THE STUB IS FLUSH WITH THE BOTTOM OF THE END CAP. FOR ADDITIONAL INFORMATION CONTACT STORMTECH AT 1-888-892-2694.

* FOR THE SC740EPE24B THE 24" (600 mm) STUB LIES BELOW THE BOTTOM OF THE END CAP APPROXIMATELY 1.75" (44 mm). BACKFILL MATERIAL SHOULD BE REMOVED FROM BELOW THE N-12 STUB SO THAT THE FITTING SITS LEVEL.

NOTE: ALL DIMENSIONS ARE NOMINAL

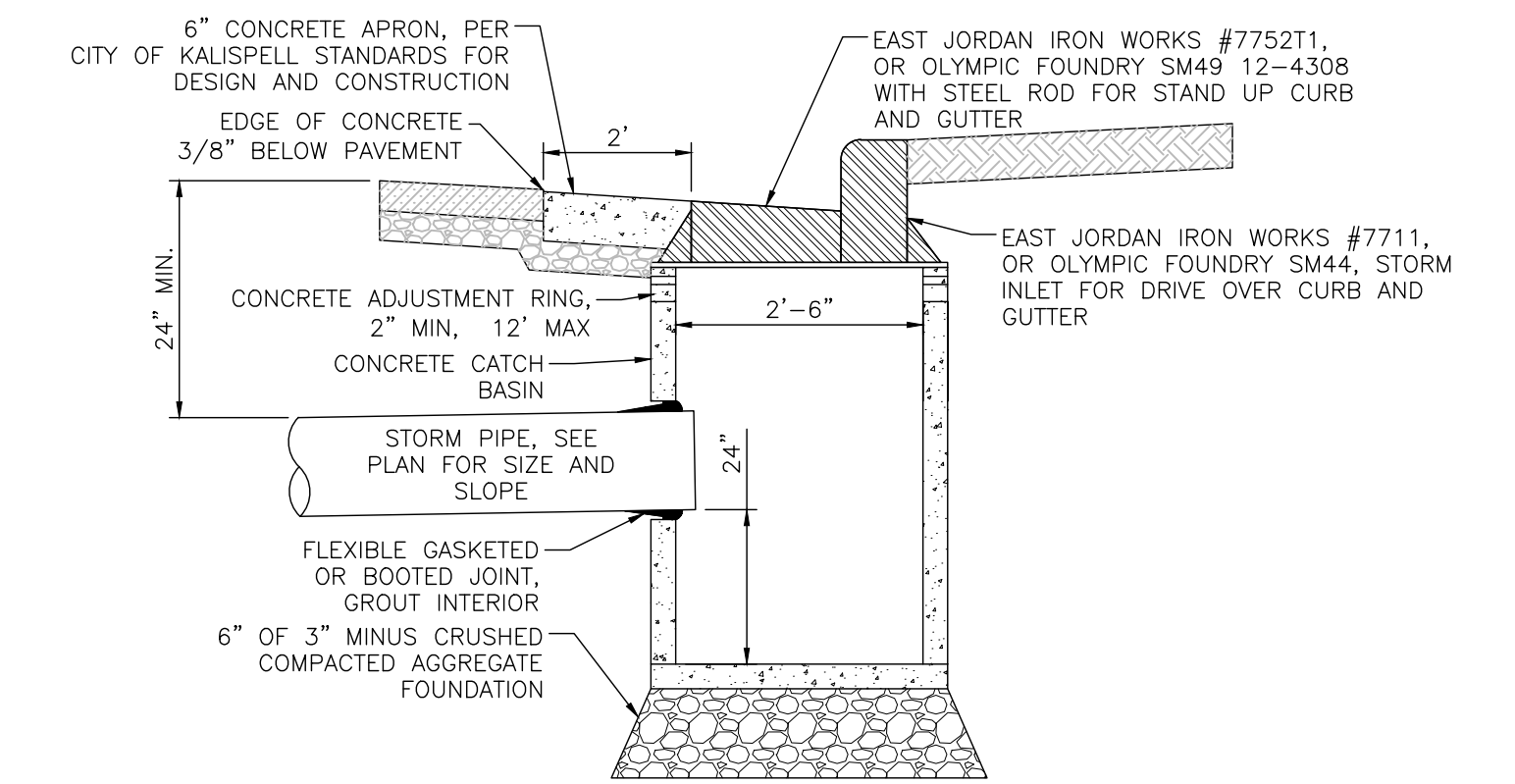

NOTE:

- ALL JOINTS BETWEEN CATCH BASIN, ADJUSTMENT RINGS, CASTING, AND SEWER PIPE SHALL BE WATER TIGHT. JOINING MATERIAL SHALL BE RAM-NEK OR EQUAL FOR ALL JOINTS OTHER THAN JOINTS BETWEEN SEWER PIPE AND CATCH BASIN.
- ALL PIPE CONNECTIONS NOT CONSTRUCTIBLE AS DETAILED SHALL BE SUBMITTED TO CITY ENGINEER FOR REVIEW.

TYPICAL STORMWATER CATCH BASIN DETAIL

DR.1

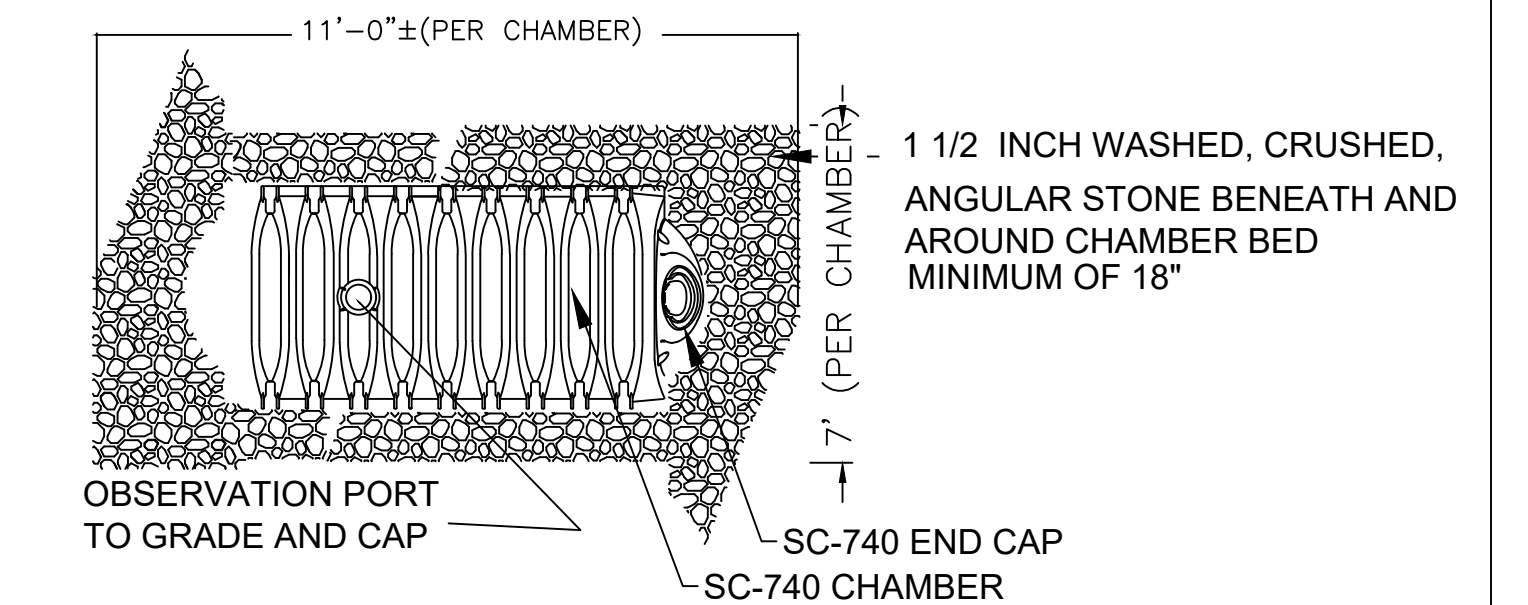

STORMTECH SC-740 CHAMBER SYSTEM PLAN VIEW DETAIL

NOT TO SCALE

DATE	REVISION

All legal rights including, but not limited to, copyright and design patent rights, in the designs, arrangements and plans shown on this document are the property of RAV&Assoc., Inc. They may not be used or reused in whole or in part, except in connection with this project, without the prior written consent of RAV&Assoc., Inc. Written dimensions on these drawings shall have precedence over scaled dimensions. Contractors shall verify and be responsible for all dimensions and conditions on this project, and RAV&Assoc., Inc. must be notified of any variation from the dimensions and conditions shown by these drawings.

STORMTECH DETAILS

194 OTIS STREET,
NEWTON, MASSACHUSETTS

RAV & Assoc., Inc.
21 HIGHLAND AVENUE
NEEDHAM, MASSACHUSETTS 02494
TELEPHONE: (781) 449-8200 FAX: (781) 449-8205

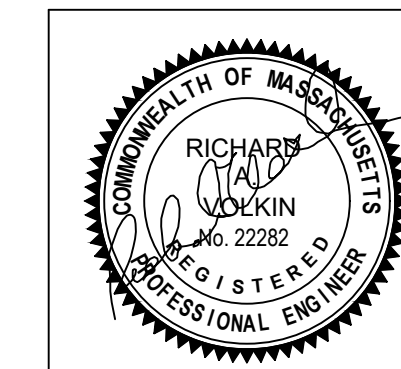

SCALE: 1"=10'	APPROVED: R.A.V.	DESIGNED BY: R.A.V.	DRAWING No.
	DATE: 04/08/22	DRAWN BY: R.A.V.	3 OF 4
		CHECKED BY: R.A.V.	

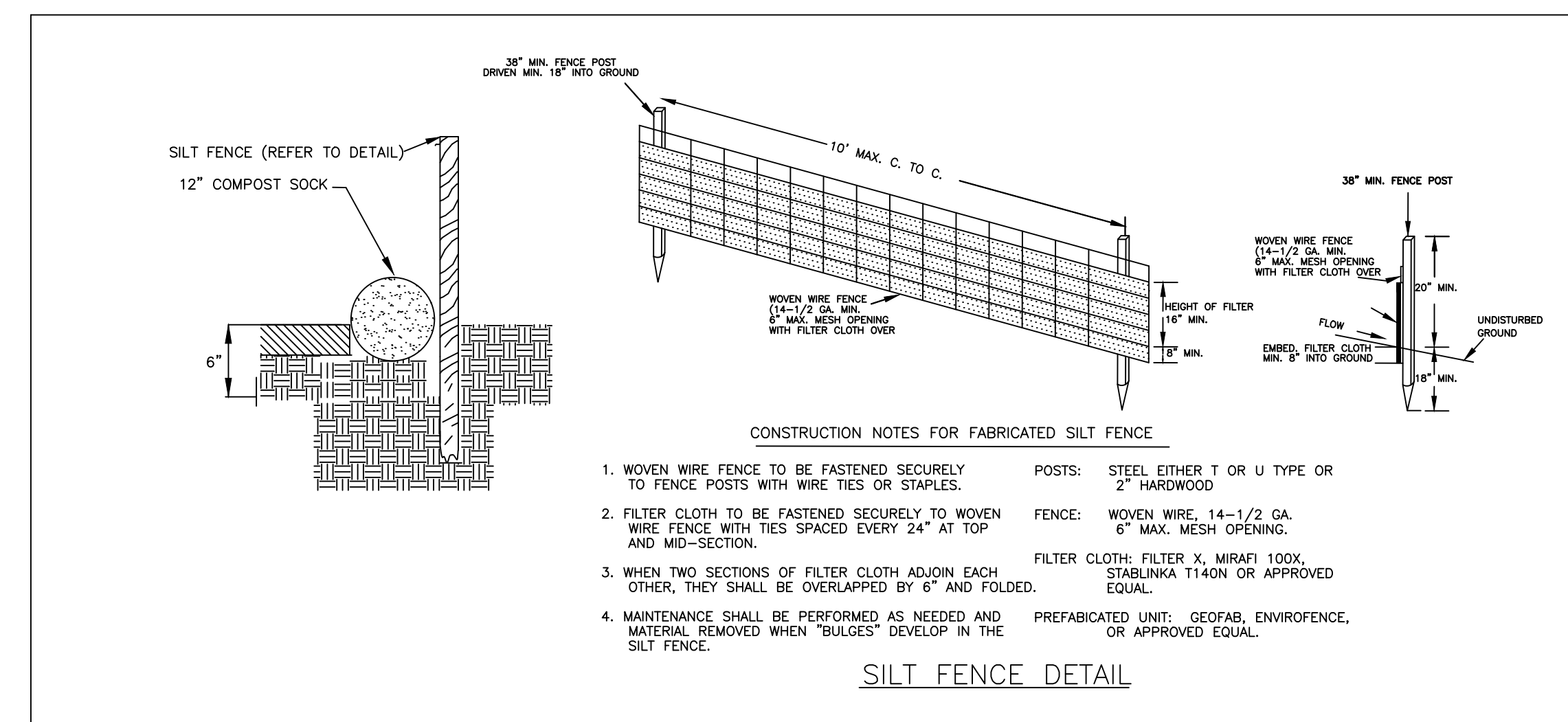
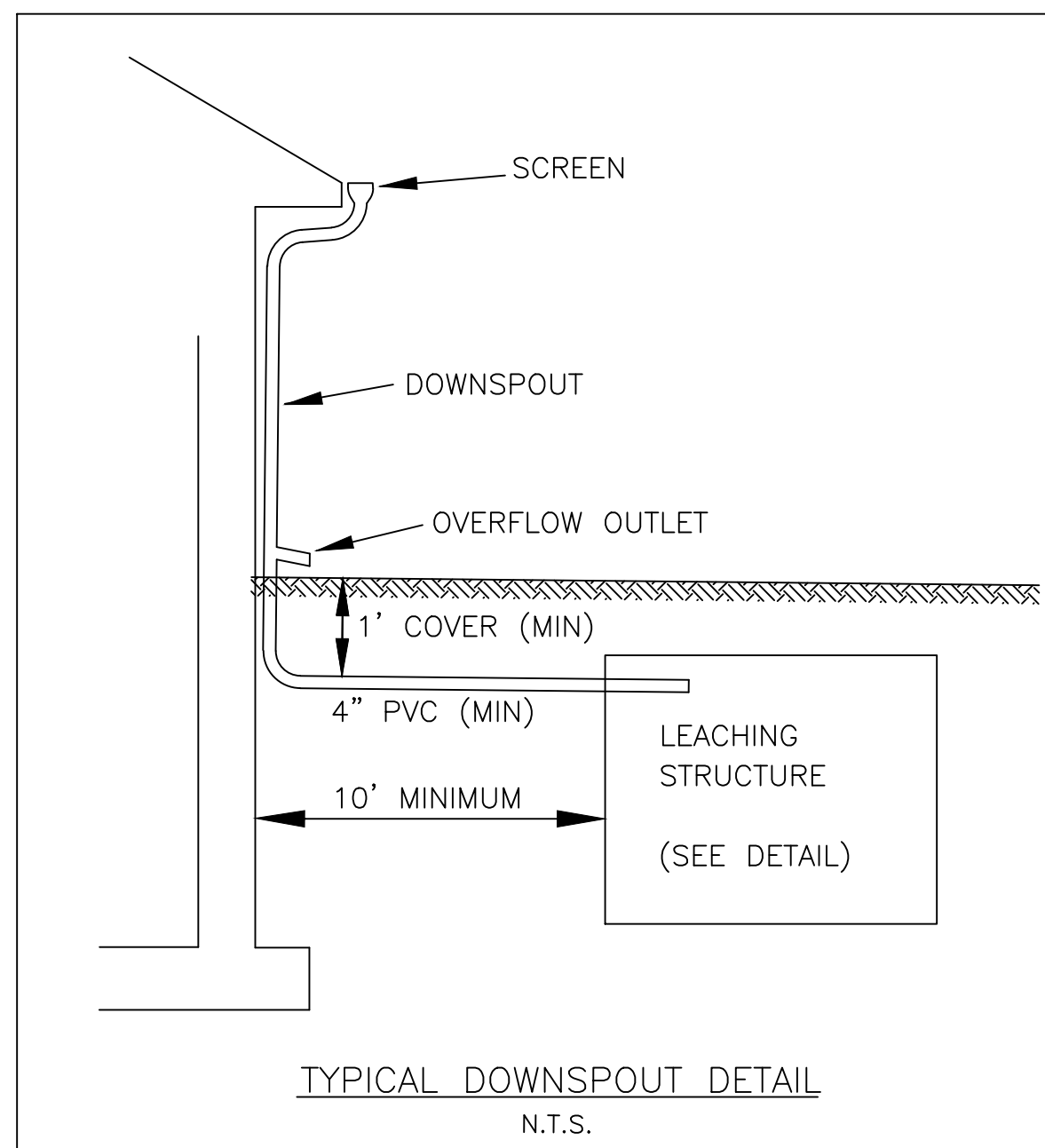
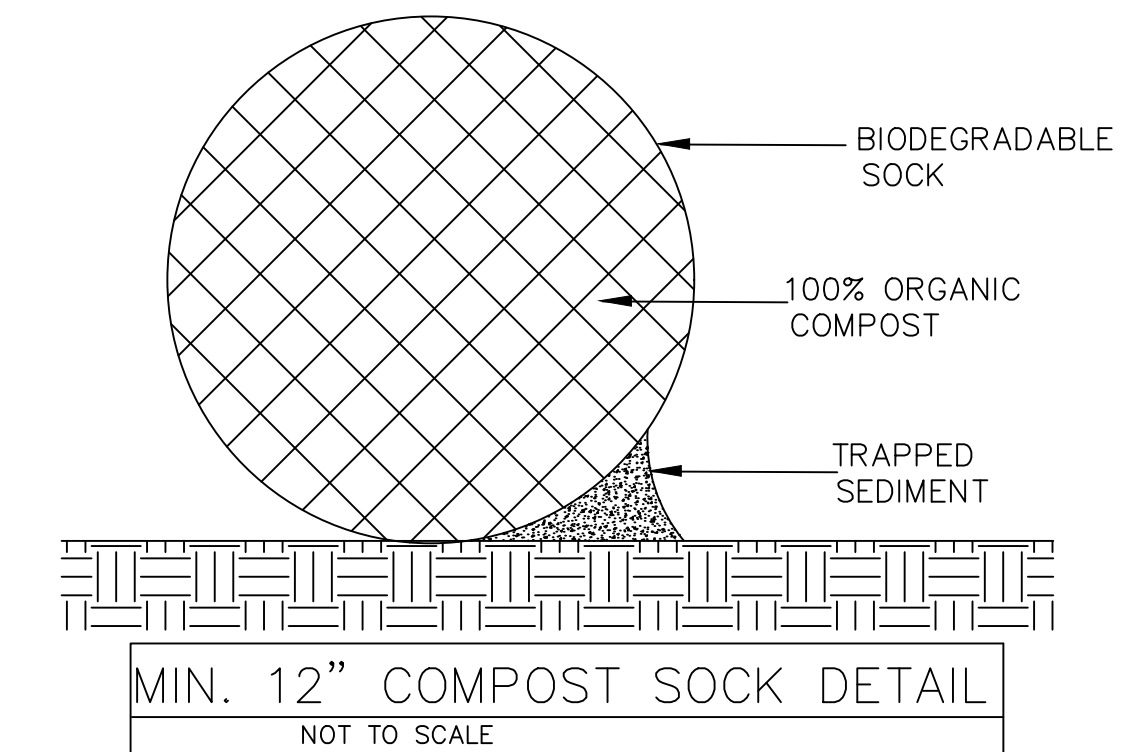
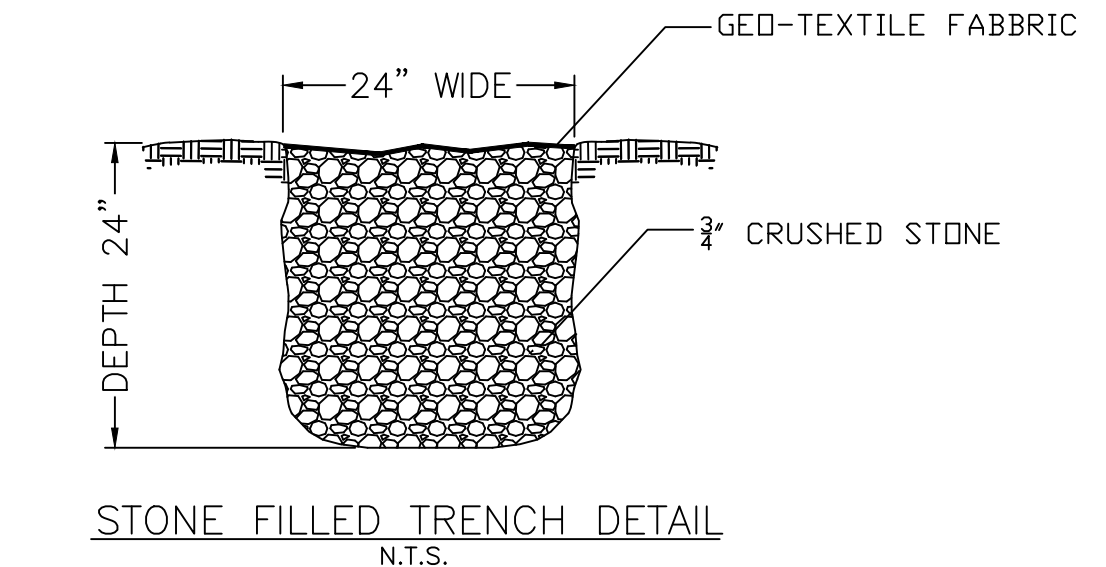
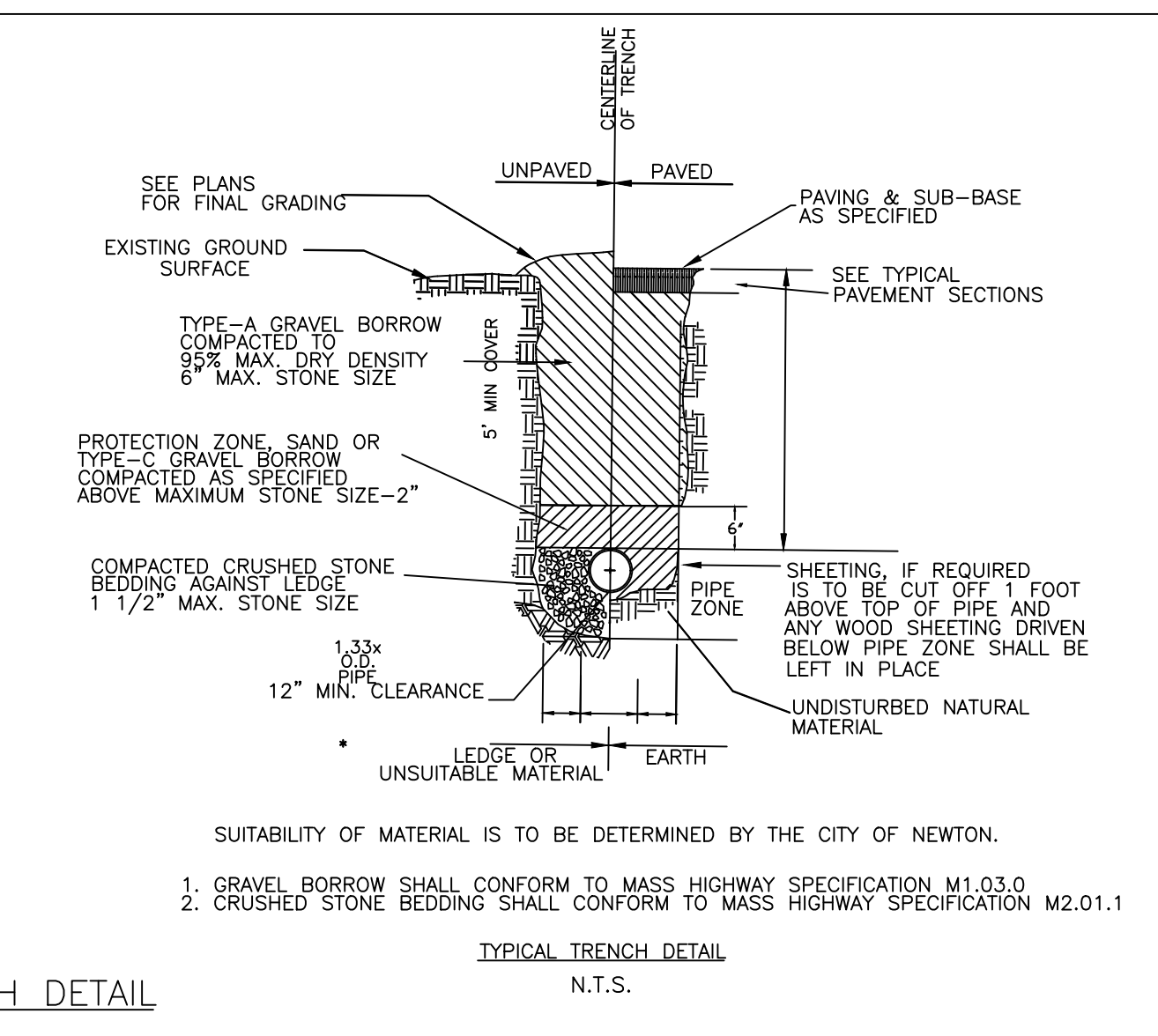
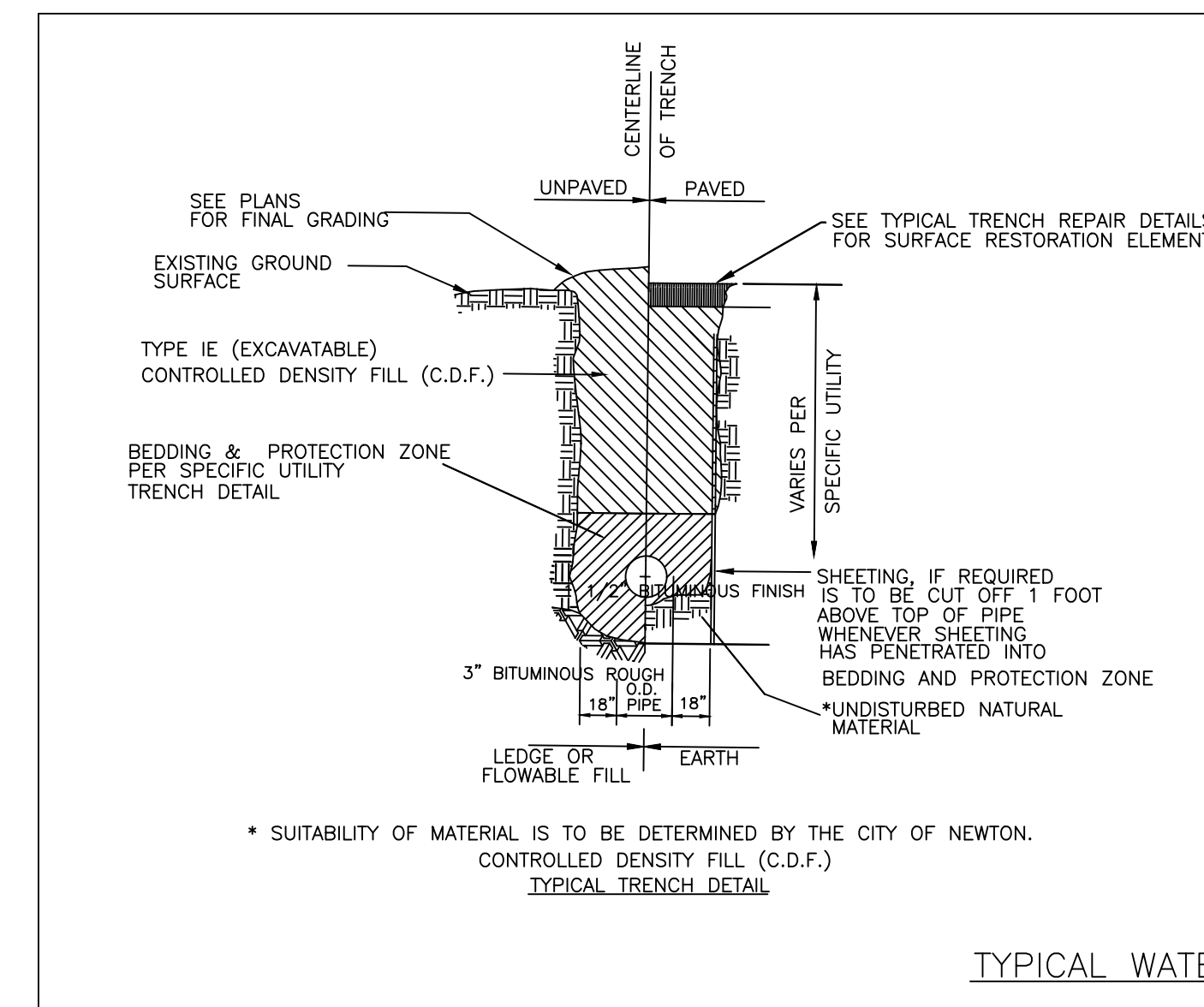
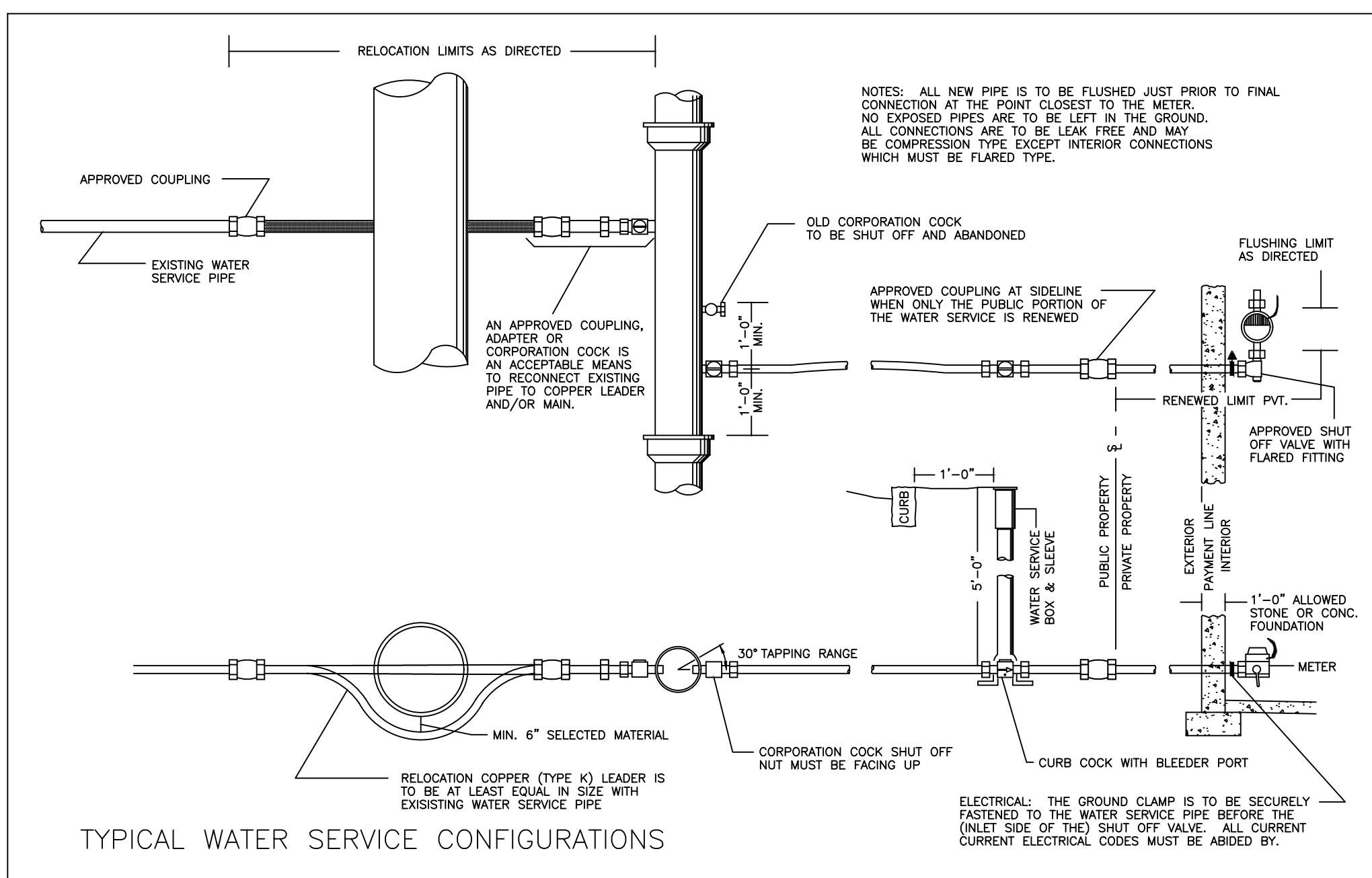
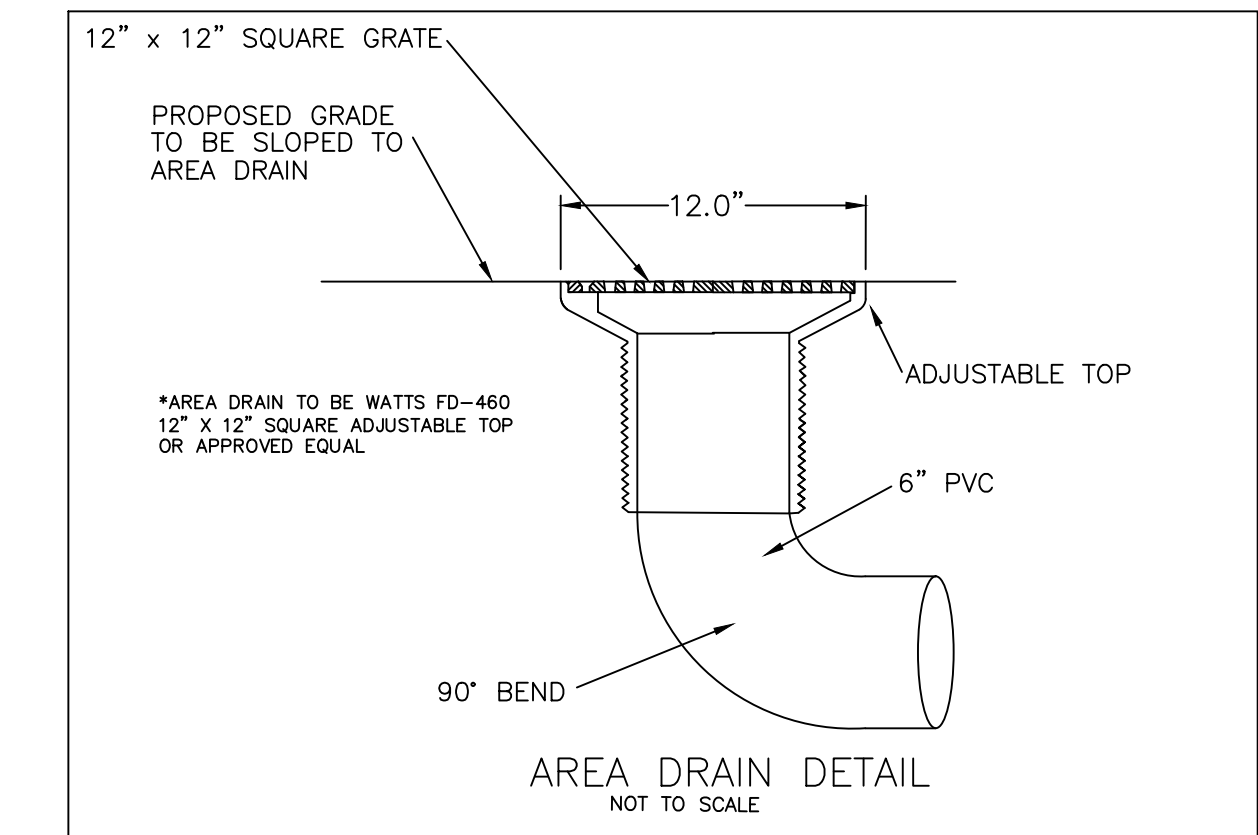
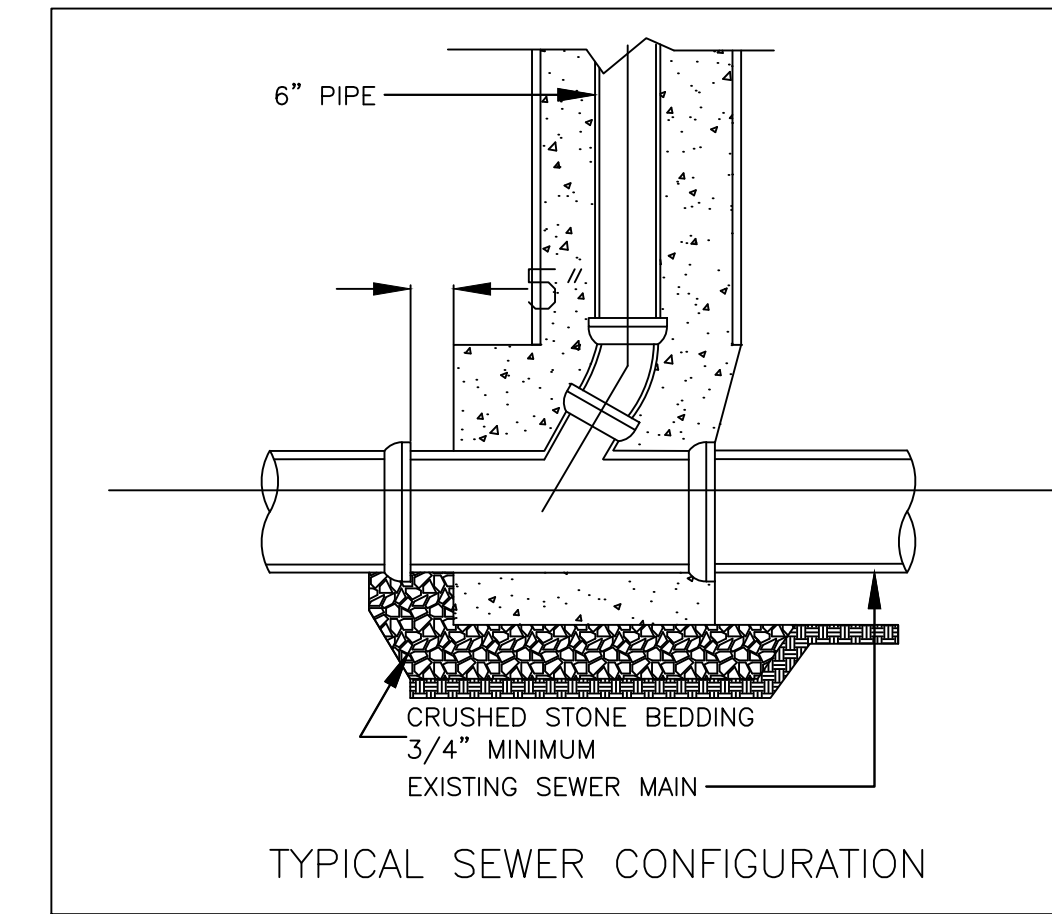
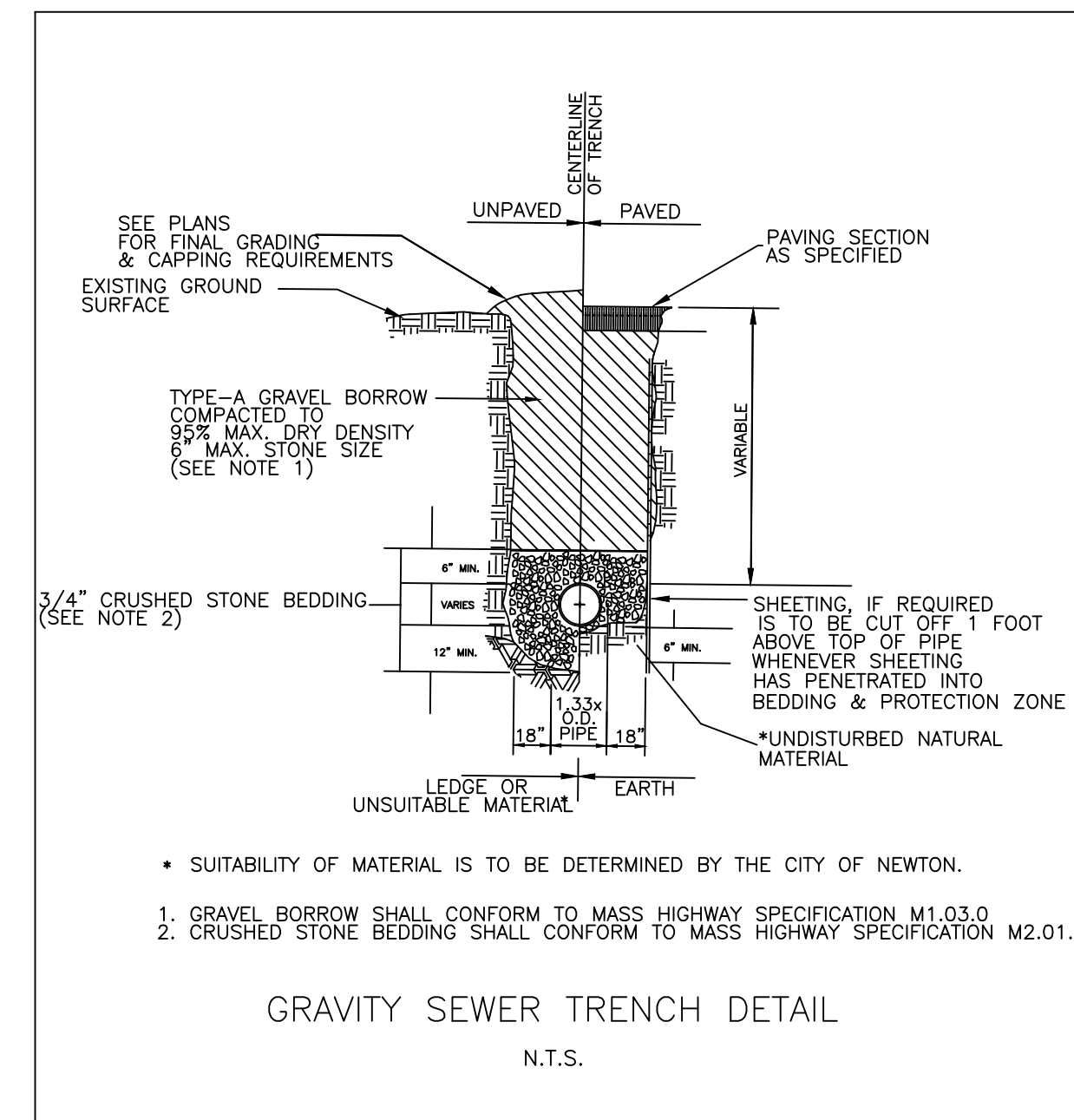
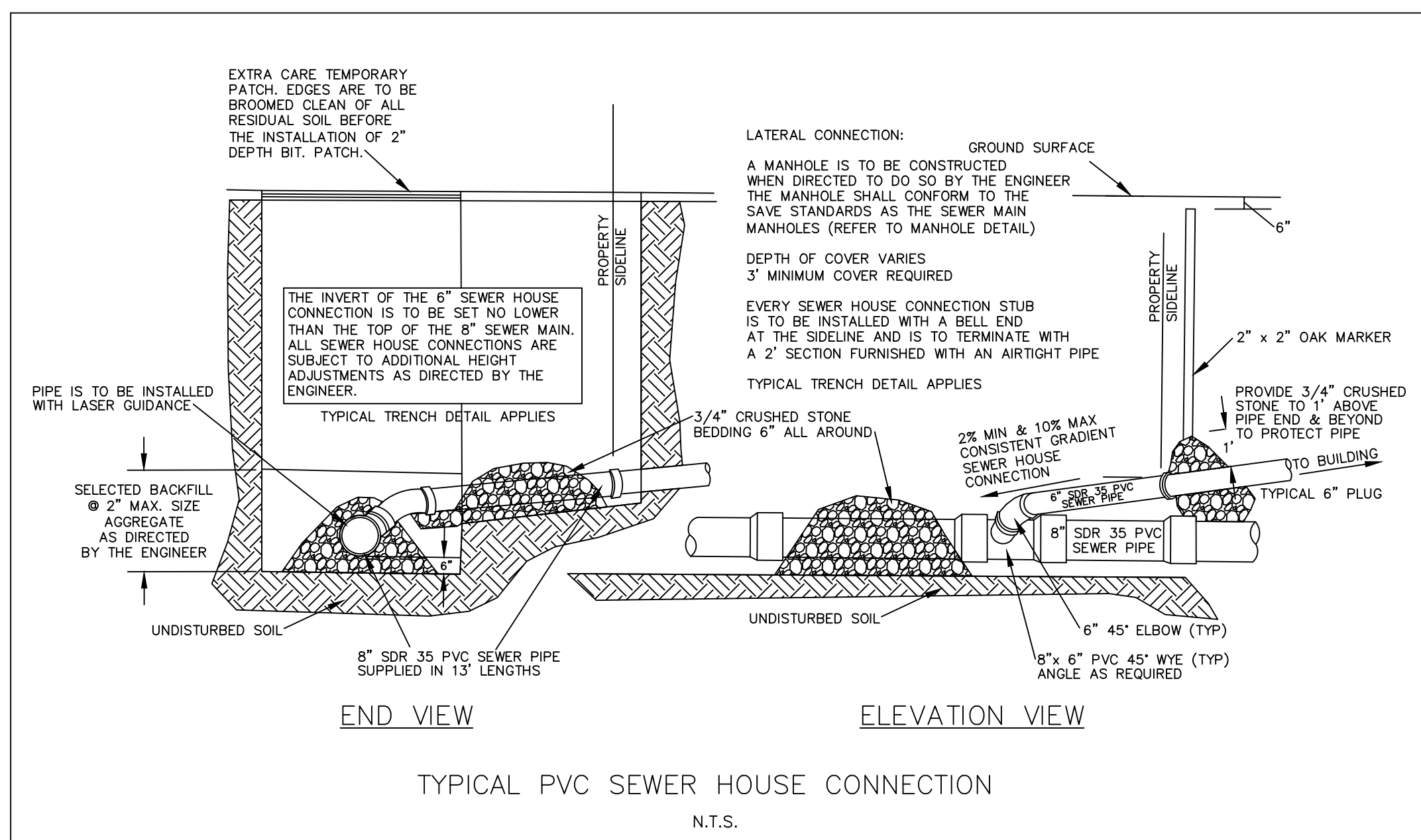

DATE	REVISION

All legal rights including, but not limited to, copyright and design patent rights, in the designs, arrangements and plans shown on this document are the property of RAV&Assoc., Inc. They may not be used or reused in whole or in part, except in connection with this project, without the prior written consent of RAV&Assoc., Inc. Written dimensions on these drawings shall have precedence over scaled dimensions. Contractors shall verify and be responsible for all dimensions and conditions on this project, and RAV&Assoc., Inc. must be notified of any variation from the dimensions and conditions shown by these drawings.

DETAILS

**194 OTIS STREET,
NEWTON, MASSACHUSETTS**

RAV & Assoc., Inc.
21 HIGHLAND AVENUE
NEEDHAM, MASSACHUSETTS 02494
TELEPHONE: (781) 449-8200 FAX: (781) 449-8205

SCALE: 1"=10'

APPROVED: R.A.V.	DESIGNED BY: R.A.V.	DRAWING No.
DATE: 04/08/22	DRAWN BY: R.A.V.	4 OF 4
	CHECKED BY: R.A.V.	

