

**SURVEY NOTES:**  
 1. UNDERGROUND UTILITIES NOT SHOWN. BEFORE CONSTRUCTION, CALL "DIG SAFE" 1-888-344-7233.  
 2. THIS PLAN WAS PREPARED USING AN AERIAL PHOTOGRAMMATIC SURVEY TAKEN IN FALL OF 2015.  
 3. WETLAND RESOURCE AREAS GPS LOCATED BY B+T ON JULY 26, 2022 WITH TRIMBLE SPECTRA SP20 SUBMETER UNIT.  
 4. ALL ELEVATIONS REFER TO NEWTON CITY BASE DATUM WHICH IS 6.53' BELOW NAVD88.

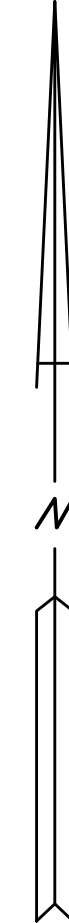

PREPARED FOR:  
**BRAE BURN COUNTRY CLUB**  
 326 FULLER STREET  
 WEST NEWTON, MASSACHUSETTS

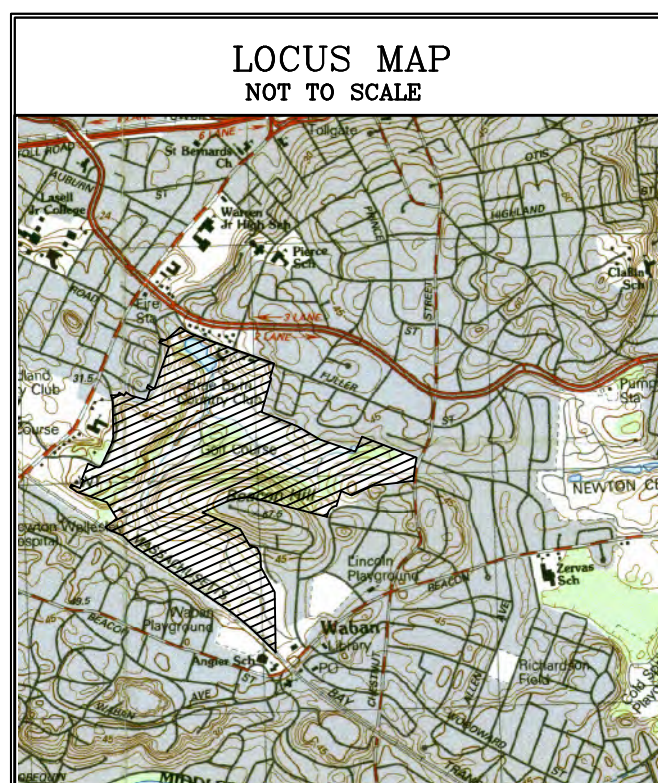

Kenneth Conte  
 8/11/22  
 COPYRIGHT (C) BY BEALS AND THOMAS, INC.  
 ALL RIGHTS RESERVED

PREPARED BY:  
**BEALS + THOMAS**  
 Civil Engineers + Landscape Architects +  
 Land Surveyors + Planners +  
 Environmental Specialists  
 BEALS AND THOMAS, INC.  
 Reservoir Corporate Center  
 144 Turnpike Road  
 Southborough, Massachusetts 01772-2104  
 T 508.366.0560 | www.bealsandthomas.com

**FOR PERMITTING ONLY**

5	
4	
3	
2	
1	
0	08/11/2022 ISSUED FOR PERMITTING
	ISSUE DATE DESCRIPTION
	ELC AMG KCC
DES	DWN CHK'D APP'D

PROJECT:  
**COURSE-WIDE DRAINAGE IMPROVEMENTS**  
 WEST NEWTON, MASSACHUSETTS

SCALE: 1" = 200' DATE: AUGUST 11, 2022

**OVERALL SITE PLAN**

B+T JOB NO.0797.48  
 B+T PLAN NO. 079748P092A-001  
**C1.0**

FOR NOTES, REFERENCES AND LEGEND SEE SHEET C2.1  
 BEALS AND THOMAS, INC. SHALL NOT BE RESPONSIBLE FOR CONSTRUCTION MEANS, METHODS, TECHNIQUES, OR PROCEDURES UTILIZED BY THE CONTRACTOR, NOR FOR THE SAFETY OF PUBLIC OR CONTRACTOR'S EMPLOYEES; OR FOR THE FAILURE OF THE CONTRACTOR TO CARRY OUT THE WORK IN ACCORDANCE WITH THE CONTRACT DOCUMENTS.  
 NO PART OF THIS DOCUMENT MAY BE REPRODUCED, STORED IN A RETRIEVAL SYSTEM, OR TRANSMITTED IN ANY FORM OR BY ANY MEANS, ELECTRONIC, MECHANICAL, PHOTOCOPYING, RECORDING OR OTHERWISE WITHOUT THE PRIOR WRITTEN PERMISSION OF BEALS AND THOMAS, INC. EXCEPT THAT ANY REGULATORY AUTHORITY MAY REPRODUCE AND TRANSMIT COPIES AS REQUIRED IN CONJUNCTION WITH PERFORMANCE OF OFFICIAL BUSINESS UNDER ITS JURISDICTION. ANY MODIFICATIONS TO THIS DOCUMENT WITHOUT THE WRITTEN PERMISSION OF BEALS AND THOMAS, INC. SHALL RENDER IT INVALID AND UNUSABLE.



PREPARED FOR:

**BRAE BURN  
COUNTRY CLUB**

326 FULLER STREET  
WEST NEWTON, MASSACHUSETTS

LOCUS MAP  
NOT TO SCALE

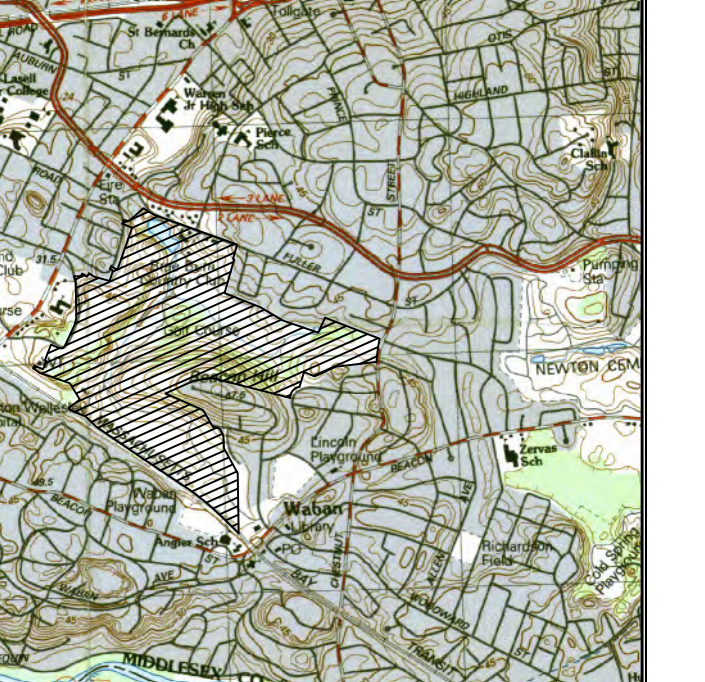

*Kenneth Conte*  
8/11/22

COPYRIGHT (C) BY BEALS AND THOMAS, INC.  
ALL RIGHTS RESERVED

PREPARED BY:



BEALS AND THOMAS, INC.  
Reservoir Corporate Center  
144 Turnpike Road  
Southborough, Massachusetts 01772-2104  
T 508.366.0560 | www.bealsandthomas.com

**FOR PERMITTING  
ONLY**

5			
4			
3			
2			
1			
0	08/11/2022	ISSUED FOR PERMITTING	
	ISSUE DATE	DESCRIPTION	
DES	DWN	CHK'D	APP'D

PROJECT:  
**COURSE-WIDE  
DRAINAGE  
IMPROVEMENTS**  
WEST NEWTON, MASSACHUSETTS

SCALE: 1" = 40' DATE: AUGUST 11, 2022  
METERS  
0 5 10 25  
FEET  
0 20 40 80 120

**DRAINAGE  
IMPROVEMENT AREA 1**

B+T JOB NO.0797.48  
B+T PLAN NO.  
079748P092A-002

**C1.1**

FOR NOTES, REFERENCES AND LEGEND SEE SHEET C2.1  
BEALS AND THOMAS, INC. SHALL NOT BE RESPONSIBLE FOR CONSTRUCTION MEANS, METHODS, TECHNIQUES, OR PROCEDURES UTILIZED BY THE CONTRACTOR, NOR FOR THE SAFETY OF PUBLIC OR CONTRACTOR'S EMPLOYEES; OR FOR THE FAILURE OF THE CONTRACTOR TO CARRY OUT THE WORK IN ACCORDANCE WITH THE CONTRACT DOCUMENTS.  
NO PART OF THIS DOCUMENT MAY BE REPRODUCED, STORED IN A RETRIEVAL SYSTEM, OR TRANSMITTED IN ANY FORM OR BY ANY MEANS, ELECTRONIC, MECHANICAL, PHOTOCOPYING, RECORDING OR OTHERWISE WITHOUT THE PRIOR WRITTEN PERMISSION OF BEALS AND THOMAS, INC. EXCEPT THAT ANY REGULATORY AUTHORITY MAY REPRODUCE AND TRANSMIT COPIES AS REQUIRED IN CONJUNCTION WITH PERFORMANCE OF OFFICIAL BUSINESS UNDER ITS JURISDICTION. ANY MODIFICATIONS TO THIS DOCUMENT WITHOUT THE WRITTEN PERMISSION OF BEALS AND THOMAS, INC. SHALL RENDER IT INVALID AND UNUSABLE.

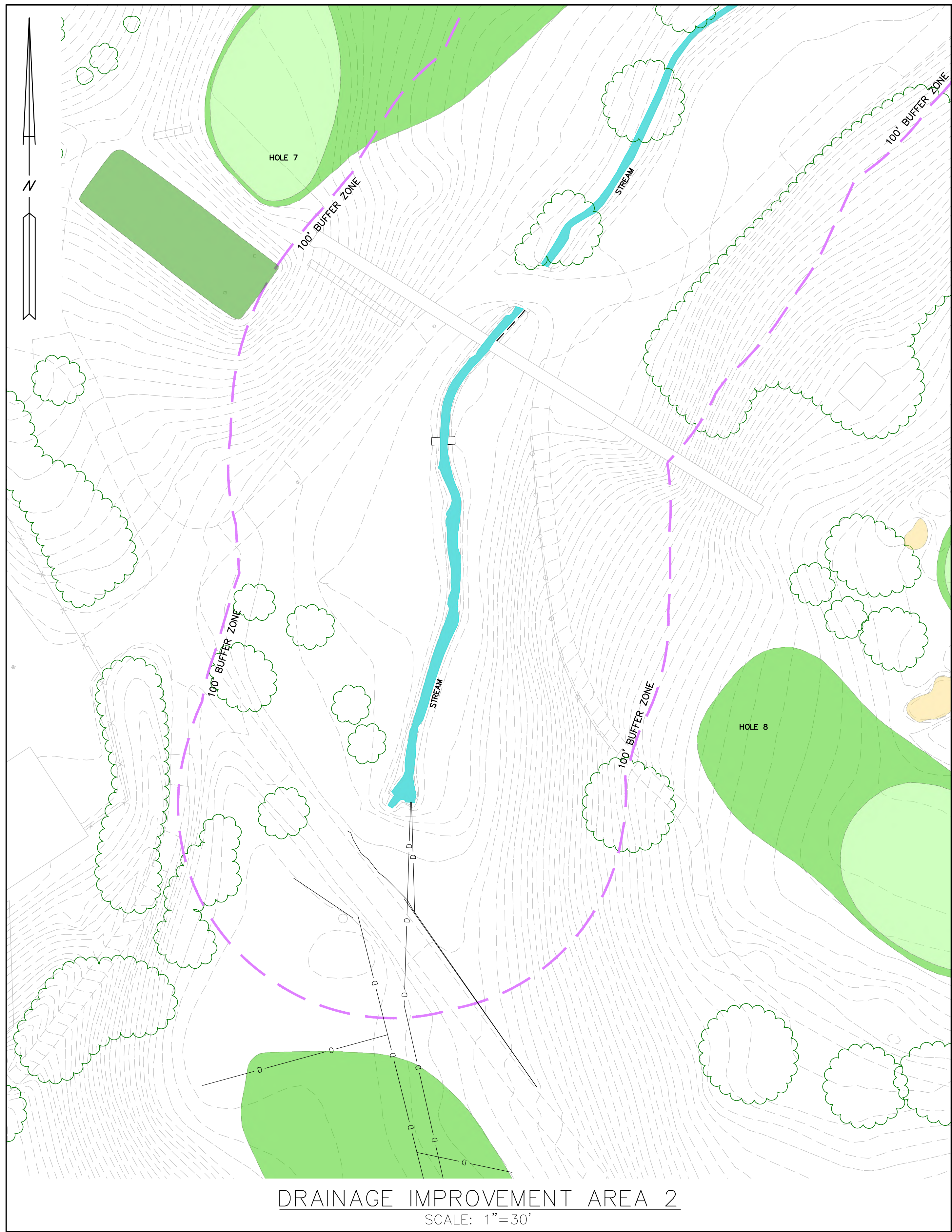

DRAINAGE IMPROVEMENT AREA 2  
SCALE: 1"=30'

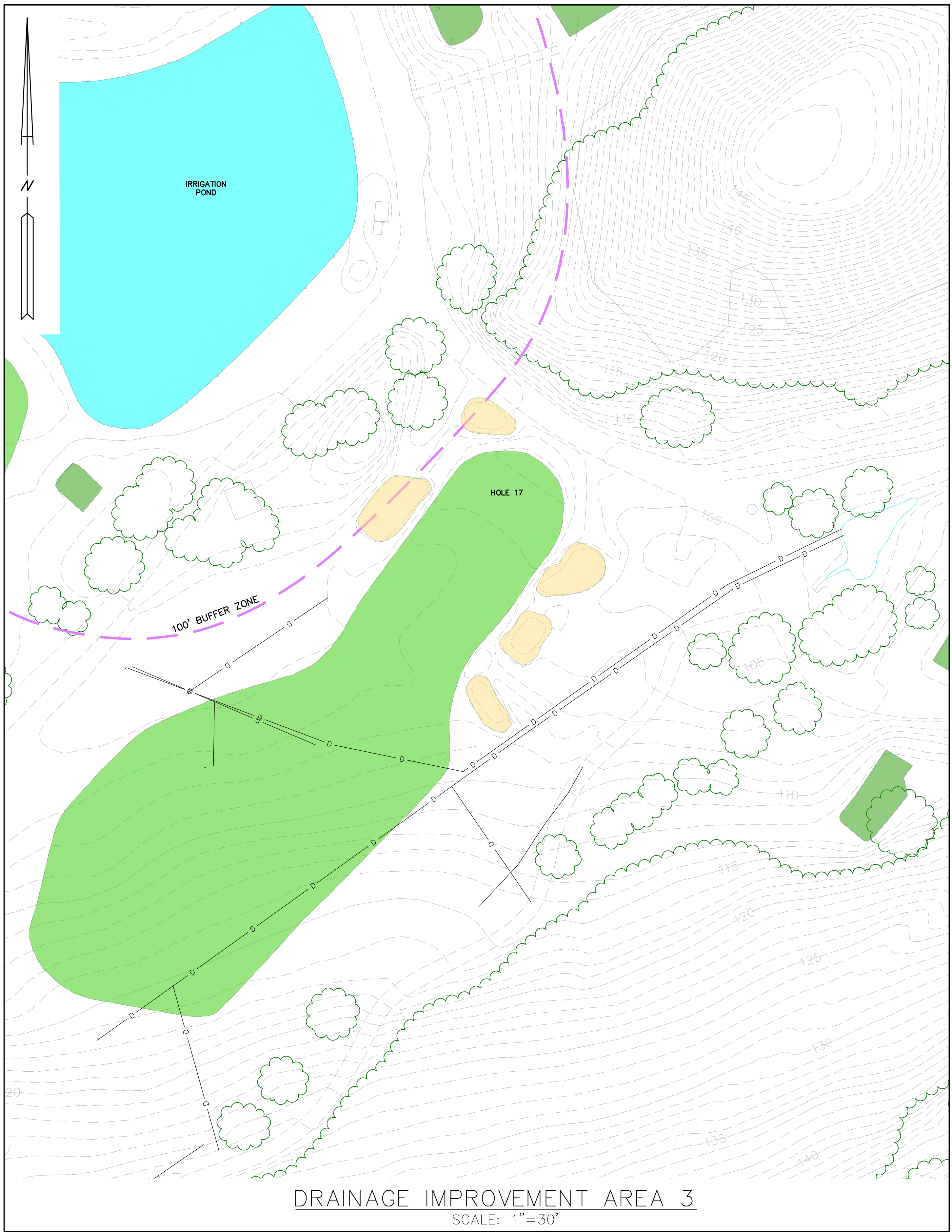

DRAINAGE IMPROVEMENT AREA 3  
SCALE: 1"=30'

FOR NOTES, REFERENCES AND LEGEND SEE SHEET C2.1

BEALS AND THOMAS, INC. SHALL NOT BE RESPONSIBLE FOR CONSTRUCTION MEANS, METHODS, TECHNIQUES, OR PROCEDURES UTILIZED BY THE CONTRACTOR, NOR FOR THE SAFETY OF PUBLIC OR CONTRACTOR'S EMPLOYEES; OR FOR THE FAILURE OF THE CONTRACTOR TO CARRY OUT THE WORK IN ACCORDANCE WITH THE CONTRACT DOCUMENTS.

NO PART OF THIS DOCUMENT MAY BE REPRODUCED, STORED IN A RETRIEVAL SYSTEM, OR TRANSMITTED IN ANY FORM OR BY ANY MEANS, ELECTRONIC, MECHANICAL, PHOTOCOPYING, RECORDING OR OTHERWISE WITHOUT THE PRIOR WRITTEN PERMISSION OF BEALS AND THOMAS, INC. EXCEPT THAT ANY REGULATORY AUTHORITY MAY REPRODUCE AND TRANSMIT COPIES AS REQUIRED IN CONJUNCTION WITH PERFORMANCE OF OFFICIAL BUSINESS UNDER ITS JURISDICTION. ANY MODIFICATIONS TO THIS DOCUMENT WITHOUT THE WRITTEN PERMISSION OF BEALS AND THOMAS, INC. SHALL RENDER IT INVALID AND UNUSABLE.

PREPARED FOR:

**BRAE BURN COUNTRY CLUB**  
326 FULLER STREET  
WEST NEWTON, MASSACHUSETTS

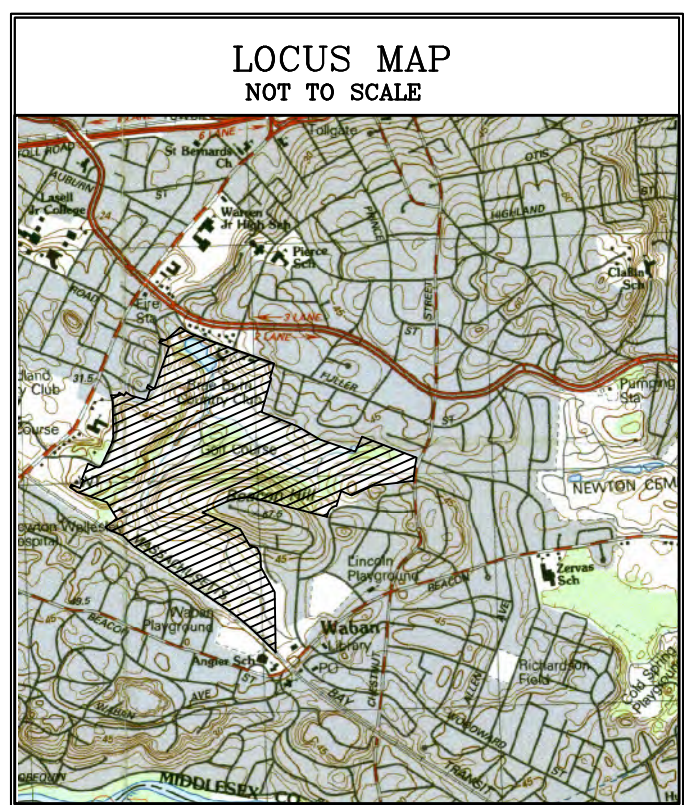

*Kenneth Conte*  
8/11/22

COPYRIGHT (C) BY BEALS AND THOMAS, INC.  
ALL RIGHTS RESERVED

PREPARED BY:

**BEALS + THOMAS**  
Civil Engineers + Landscape Architects +  
Land Surveyors + Planners +  
Environmental Specialists

BEALS AND THOMAS, INC.  
Reservoir Corporate Center  
144 Turnpike Road  
Southborough, Massachusetts 01772-2104  
T 508.366.0560 | www.bealsandthomas.com

**FOR PERMITTING ONLY**

5	
4	
3	
2	
1	
0	08/11/2022 ISSUED FOR PERMITTING
ISSUE DATE	DESCRIPTION
DES	ELC
DWN	AMG
CHK'D	KCC
APP'D	

PROJECT:

**COURSE-WIDE DRAINAGE IMPROVEMENTS**  
WEST NEWTON, MASSACHUSETTS

SCALE: 1" = 30' DATE: AUGUST 11, 2022

**DRAINAGE IMPROVEMENT AREA 2 AND AREA 3**

B+T JOB NO.0797.48

B+T PLAN NO.  
079748P092A-003

**C1.2**



FOR NOTES, REFERENCES AND LEGEND SEE SHEET C2.1

BEALS AND THOMAS, INC. SHALL NOT BE RESPONSIBLE FOR CONSTRUCTION MEANS, METHODS, TECHNIQUES, OR PROCEDURES UTILIZED BY THE CONTRACTOR, NOR FOR THE SAFETY OF PUBLIC OR CONTRACTOR'S EMPLOYEES; OR FOR THE FAILURE OF THE CONTRACTOR TO CARRY OUT THE WORK IN ACCORDANCE WITH THE CONTRACT DOCUMENTS.

NO PART OF THIS DOCUMENT MAY BE REPRODUCED, STORED IN A RETRIEVAL SYSTEM, OR TRANSMITTED IN ANY FORM OR BY ANY MEANS, ELECTRONIC, MECHANICAL, PHOTOCOPIING, RECORDING OR OTHERWISE WITHOUT THE PRIOR WRITTEN PERMISSION OF BEALS AND THOMAS, INC. EXCEPT THAT ANY REGULATORY AUTHORITY MAY REPRODUCE AND TRANSMIT COPIES AS REQUIRED IN CONJUNCTION WITH PERFORMANCE OF OFFICIAL BUSINESS UNDER ITS JURISDICTION. ANY MODIFICATIONS TO THIS DOCUMENT WITHOUT THE WRITTEN PERMISSION OF BEALS AND THOMAS, INC. SHALL RENDER IT INVALID AND UNUSABLE.

PREPARED FOR:

**BRAE BURN COUNTRY CLUB**  
 326 FULLER STREET  
 WEST NEWTON, MASSACHUSETTS

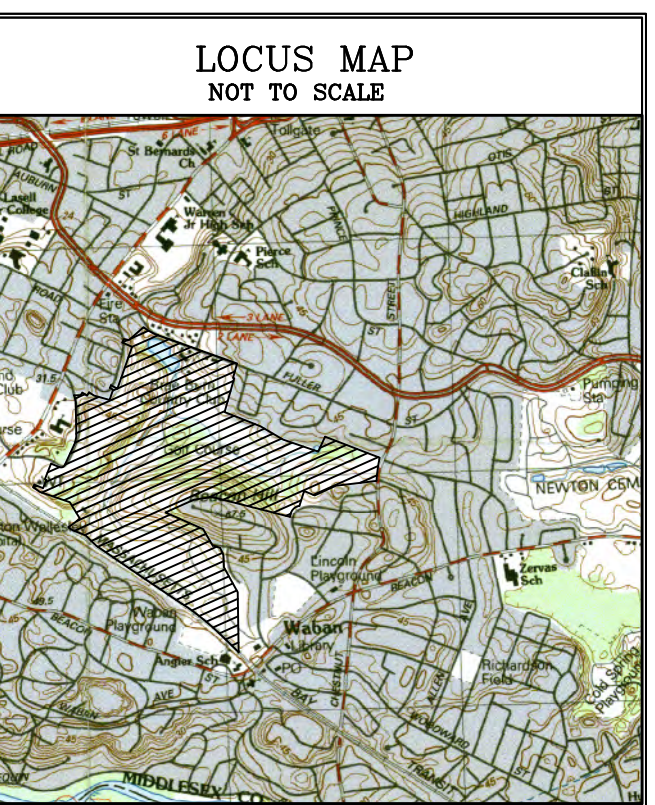

*Kenneth Conte*  
 8/11/22

COPYRIGHT (C) BY BEALS AND THOMAS, INC.  
 ALL RIGHTS RESERVED

PREPARED BY:

**BEALS + THOMAS**  
 Civil Engineers + Landscape Architects +  
 Land Surveyors + Planners +  
 Environmental Specialists

BEALS AND THOMAS, INC.  
 Reservoir Corporate Center  
 144 Turnpike Road  
 Southborough, Massachusetts 01772-2104  
 T 508.366.0560 | www.bealsandthomas.com

**FOR PERMITTING ONLY**

5	
4	
3	
2	
1	
0	08/11/2022 ISSUED FOR PERMITTING
ISSUE DATE	DESCRIPTION
DES	ELC
DWN	AMG
CHK'D	KCC
APP'D	

PROJECT:

**COURSE-WIDE DRAINAGE IMPROVEMENTS**  
 WEST NEWTON, MASSACHUSETTS

SCALE: 1" = 40' DATE: AUGUST 11, 2022

**DRAINAGE IMPROVEMENT AREA 4**

B+T JOB NO.0797.48

B+T PLAN NO. 079748P092A-004

**C1.3**

**GENERAL NOTES**

1. THE CONTRACTOR SHALL MAKE NECESSARY CONSTRUCTION NOTIFICATIONS AND OBTAIN NECESSARY CONSTRUCTION PERMITS. THE CONTRACTOR SHALL PAY FEES AND POST BONDS ASSOCIATED WITH THE SAME, AND COORDINATE WITH THE ENGINEER AND ARCHITECT AS REQUIRED.
2. CONTRACTOR SHALL BE SOLELY RESPONSIBLE FOR JOB SITE SAFETY AND CONSTRUCTION MEANS AND METHODS.
3. LIMIT OF WORK SHALL BE SEDIMENT CONTROL BARRIERS, LIMIT OF GRADING, SITE PROPERTY LINES, AND/OR AS INDICATED ON DRAWINGS.
4. ANY AREA OUTSIDE THE LIMIT OF WORK THAT IS DISTURBED SHALL BE RESTORED TO ITS ORIGINAL CONDITION AT NO COST TO OWNER.
5. CONTRACTOR SHALL VERIFY UTILITY LOCATIONS AND ELEVATIONS IN THE FIELD PRIOR TO COMMENCING WORK.
6. ANY ALTERATION TO THESE DRAWINGS MADE IN THE FIELD DURING CONSTRUCTION SHALL BE RECORDED BY THE CONTRACTOR ON RECORD DRAWINGS.
7. EXISTING TREES AND SHRUBS OUTSIDE THE LIMITS OF GRADING SHALL BE REMOVED ONLY UPON PRIOR APPROVAL OF THE OWNER.
8. FOR DRAWING LEGIBILITY, ALL EXISTING TOPOGRAPHIC FEATURES, EXISTING UTILITIES, PROPERTY BOUNDARIES, EASEMENTS, ETC. MAY NOT BE SHOWN ON ALL DRAWINGS. REFER TO ALL REFERENCED DRAWINGS AND OTHER DRAWINGS IN THIS SET FOR ADDITIONAL INFORMATION.

**EROSION CONTROL AND SEDIMENTATION NOTES**

1. A SEDIMENT CONTROL BARRIER SHALL BE INSTALLED ALONG THE EDGE OF PROPOSED WORK AS INDICATED ON THE PLANS PRIOR TO THE COMMENCEMENT OF DEMOLITION OR CONSTRUCTION.
2. CONTRACTOR SHALL CLEAN AND MAINTAIN ALL SEDIMENT AND EROSION CONTROL MEASURES FOR THE DURATION OF CONSTRUCTION TO ENSURE THEIR CONTINUED FUNCTIONALITY.
3. ADDITIONAL EROSION CONTROL MEASURES AND/OR SEDIMENT CONTROL BARRIERS SHALL BE IMPLEMENTED AS CONDITIONS WARRANT OR AS DIRECTED BY THE OWNER OR OWNER'S REPRESENTATIVE.
4. EROSION AND SEDIMENTATION CONTROL MEASURES SHALL BE INSPECTED AND MAINTAINED ON A DAILY BASIS DURING CONSTRUCTION TO ENSURE THAT CHANNELS, DITCHES, AND PIPES REMAIN CLEAR OF DEBRIS AND THAT THE EROSION AND SEDIMENTATION CONTROL MEASURES ARE INTACT.
5. ALL STOCKPILE AREAS SHALL BE LOCATED WITHIN LIMIT OF WORK LINE AND STABILIZED TO PREVENT EROSION.
6. ALL DEBRIS GENERATED DURING SITE PREPARATION ACTIVITIES SHALL BE LEGALLY DISPOSED OF OFF SITE.
7. CONTRACTOR SHALL PROVIDE DUST CONTROL BY SPRINKLING OR OTHER APPROVED METHODS NECESSARY AND/OR AS DIRECTED BY THE OWNER OR THEIR REPRESENTATIVE.
8. CONTRACTOR SHALL PREVENT ANY SOIL AND MATERIALS FROM ENTERING WETLANDS, STREAMS, AND OTHER RESOURCE AREAS.
9. WHERE TEMPORARY TRENCHING IS REQUIRED WITHIN BVW OR IVW, CONTRACTOR SHALL SURROUND CORRIDOR OF DRAIN TRENCH WITH PERIMETER SEDIMENT CONTROLS
10. ALL TEMPORARY SOIL STOCKPILES SHALL BE STORED OUTSIDE OF WETLAND RESOURCE AREAS AND OUTSIDE OF THE 100-FOOT BUFFER ZONE.

**LAYOUT AND MATERIALS NOTES**

1. CONTRACTOR SHALL VERIFY ALL CONDITIONS IN THE FIELD AND REPORT ANY DISCREPANCIES TO THE OWNER AND OWNER'S REPRESENTATIVE FOR RESOLUTION.
2. THE CONTRACTOR SHALL NOTIFY THE ENGINEER OF ANY DISCREPANCIES BETWEEN SITE PLAN DIMENSIONS AND BUILDING PLANS BEFORE PROCEEDING WITH ANY PORTION OF SITE WORK WHICH MAY BE AFFECTED SO THAT PROPER ADJUSTMENTS TO THE SITE LAYOUT CAN BE MADE IF NECESSARY.

**GRADING, DRAINAGE AND UTILITY NOTES**

1. BEFORE COMMENCING SITE WORK CONTACT "DIG SAFE" AT 1-888-344-7233 TO LOCATE UNDERGROUND UTILITIES. ANY DAMAGE TO EXISTING UTILITIES OR STRUCTURES SHALL BE THE CONTRACTOR'S RESPONSIBILITY. NO EXCAVATION SHALL BE PERFORMED UNTIL UTILITY COMPANIES ARE PROPERLY NOTIFIED.
2. CONTRACTOR SHALL BE RESPONSIBLE FOR VERIFYING THAT THE PROPOSED IMPROVEMENTS SHOWN ON THE PLANS DO NOT CONFLICT WITH ANY KNOWN EXISTING OR OTHER PROPOSED IMPROVEMENTS. IF ANY CONFLICTS ARE DISCOVERED, THE CONTRACTOR SHALL NOTIFY THE OWNER AND THE ENGINEER PRIOR TO INSTALLATION OF ANY PORTION OF THE SITE WORK WHICH COULD BE AFFECTED.
3. WORK PERFORMED AND MATERIALS FURNISHED SHALL CONFORM WITH THE LINES, GRADES AND OTHER SPECIFIC REQUIREMENTS AND SPECIFICATIONS OF THE CITY OF NEWTON DPW.
4. WHERE AN EXISTING UTILITY IS FOUND TO CONFLICT WITH THE PROPOSED WORK, THE LOCATION, ELEVATION AND SIZE OF THE UTILITY SHALL BE ACCURATELY DETERMINED WITHOUT DELAY BY THE CONTRACTOR, AND THE INFORMATION FURNISHED TO THE OWNER AND ENGINEER FOR RESOLUTION.
5. UTILITY COVERS, GRATES, ETC. SHALL BE ADJUSTED TO BE FLUSH WITH THE FINISH GRADE UNLESS OTHERWISE NOTED.
6. CONTRACTOR SHALL PROTECT UNDERGROUND UTILITIES FROM EXCESSIVE VEHICULAR LOADS DURING CONSTRUCTION. ANY DAMAGE TO THE UTILITIES RESULTING FROM CONSTRUCTION LOADS SHALL BE RESTORED TO ORIGINAL CONDITION.
7. EXCAVATION WITHIN THE PROXIMITY OF EXISTING UTILITY LINES SHALL BE PERFORMED BY HAND. CONTRACTOR SHALL REPAIR ANY DAMAGE TO EXISTING UTILITY LINES OR STRUCTURES INCURRED DURING CONSTRUCTION OPERATIONS AT NO COST TO THE OWNER.
8. CONTRACTOR SHALL REMOVE ALL EROSION AND SEDIMENT CONTROL BARRIERS AFTER RE-VEGETATION AND STABILIZATION OF DISTURBED AREAS, FOLLOWING APPROVAL OF THE CONSERVATION COMMISSION AND WETLAND SPECIALIST.
9. WETLANDS SHALL REMAIN UNDISTURBED; NO ENCRoACHMENT PERMITTED.

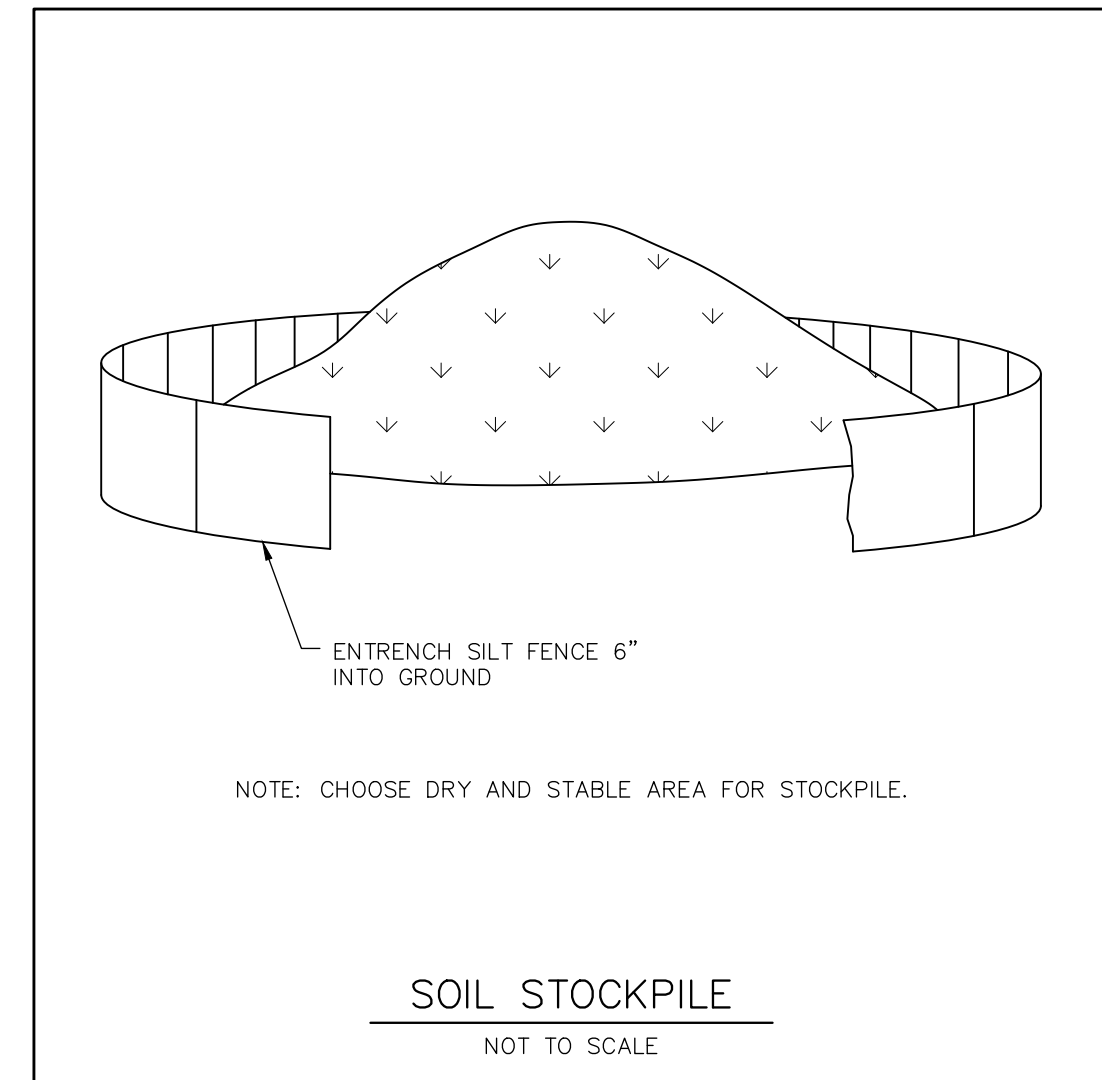
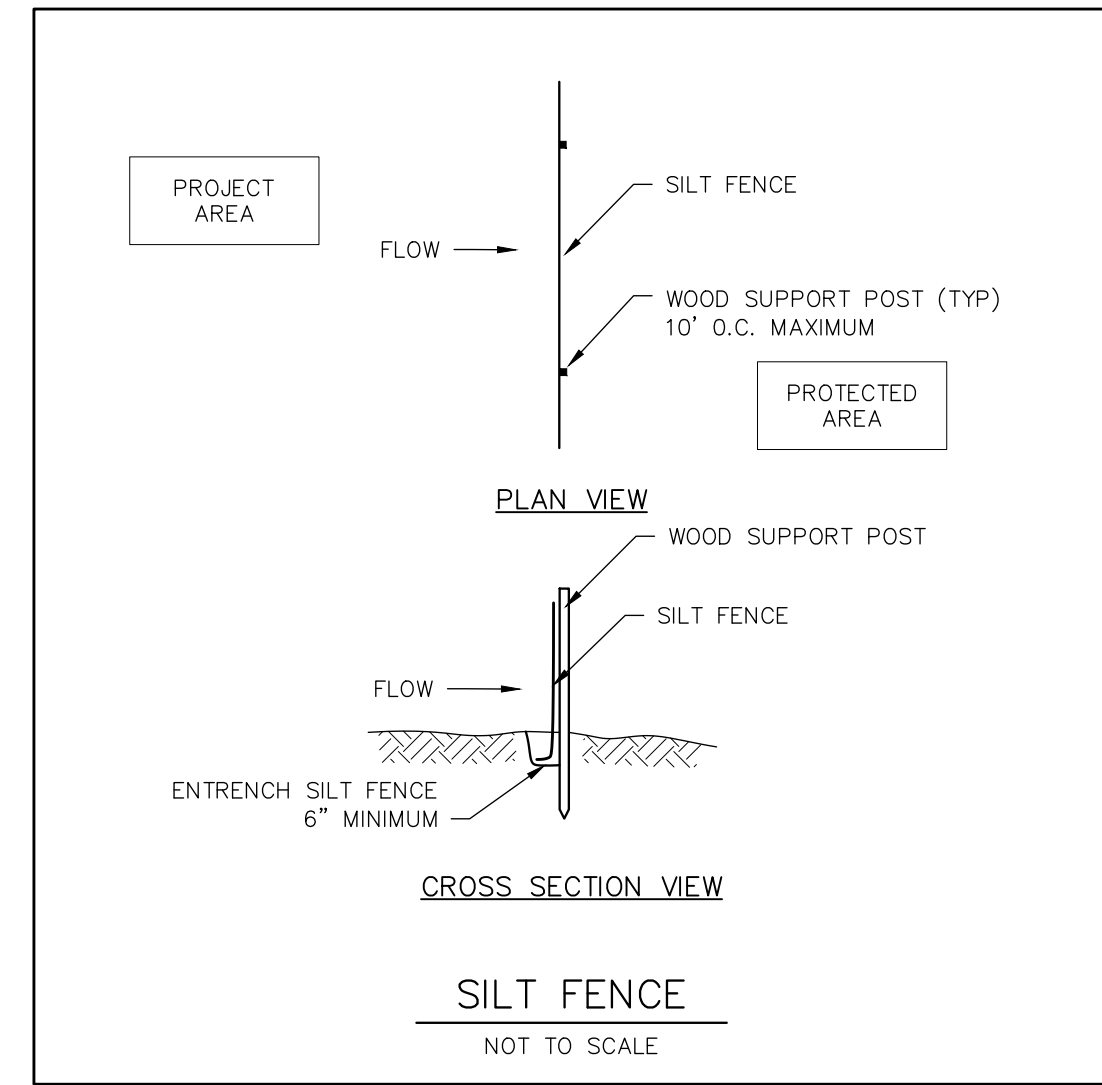
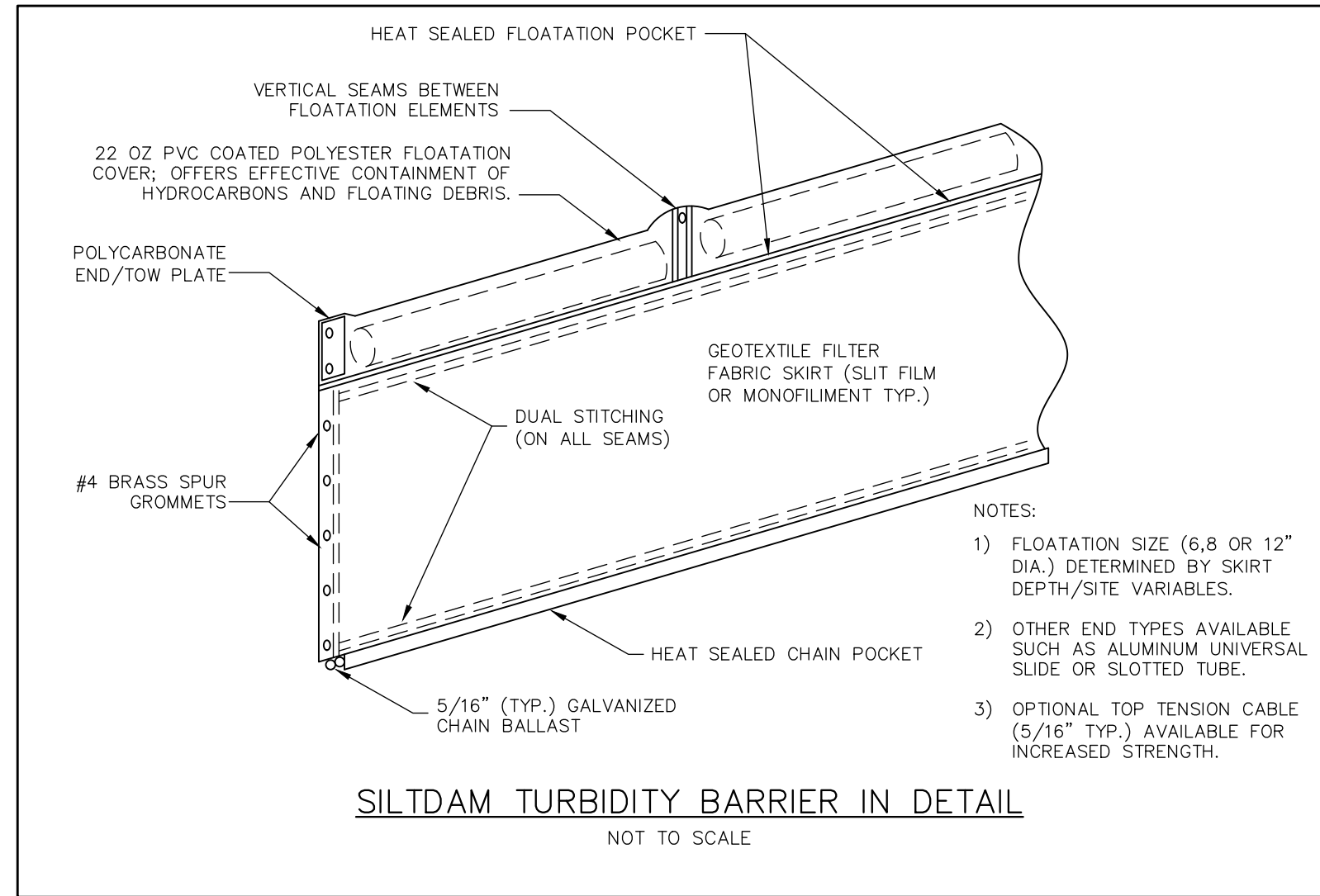
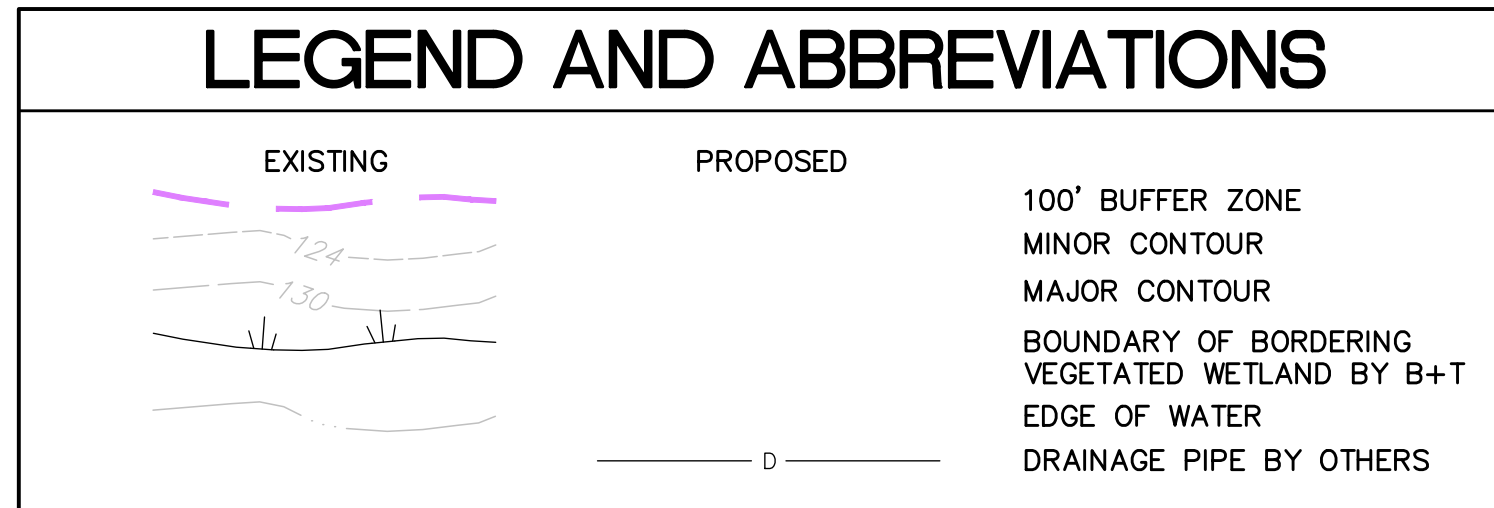

PREPARED FOR:

## BRAE BURN COUNTRY CLUB

326 FULLER STREET  
WEST NEWTON, MASSACHUSETTS

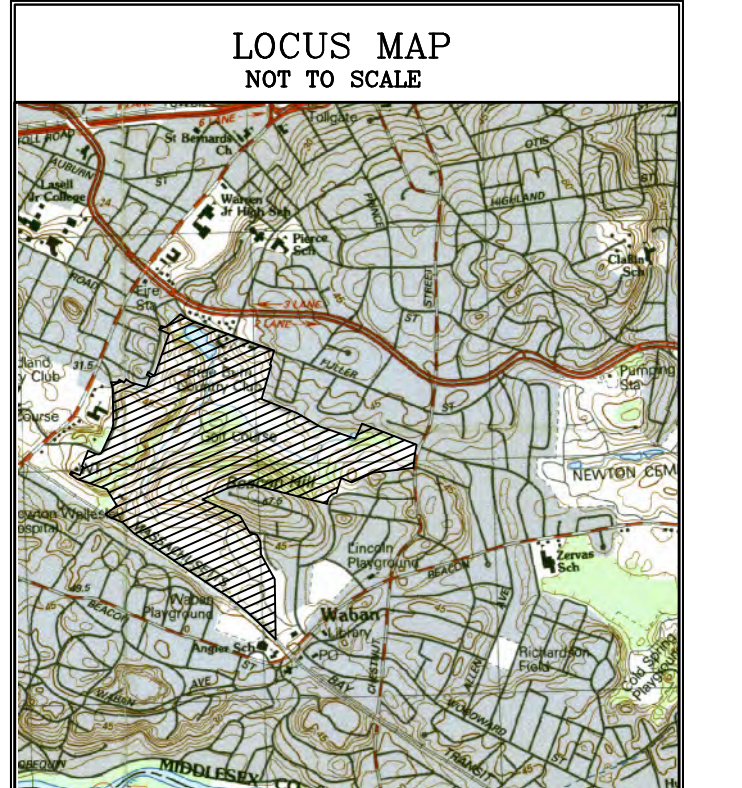

*Kenneth Conte*  
 8/11/22  
 COPYRIGHT (C) BY BEALS AND THOMAS, INC.  
 ALL RIGHTS RESERVED

PREPARED BY:

**BEALS + THOMAS**  
 Civil Engineers + Landscape Architects +  
 Land Surveyors + Planners +  
 Environmental Specialists

BEALS AND THOMAS, INC.  
 Reservoir Corporate Center  
 144 Turnpike Road  
 Southborough, Massachusetts 01772-2104  
 T 508.366.0560 | www.bealsandthomas.com

**FOR PERMITTING ONLY**

5					
4					
3					
2					
1					
0	08/11/2022	ISSUED FOR PERMITTING			
ISSUE DATE		DESCRIPTION			
	ELC	AMG	KCC		
DES	DWN	CHK'D	APP'D		

PROJECT:

## COURSE-WIDE DRAINAGE IMPROVEMENTS

WEST NEWTON, MASSACHUSETTS

SCALE: 1" = 40'    DATE: AUGUST 11, 2022

**NOTES, REFERENCES AND LEGEND**

B+T JOB NO.0797.48	<b>C2.1</b>
B+T PLAN NO. 079748P092A-005	

BEALS AND THOMAS, INC. SHALL NOT BE RESPONSIBLE FOR CONSTRUCTION MEANS, METHODS, TECHNIQUES, OR PROCEDURES UTILIZED BY THE CONTRACTOR, NOR FOR THE SAFETY OF PUBLIC OR CONTRACTOR'S EMPLOYEES; OR FOR THE FAILURE OF THE CONTRACTOR TO CARRY OUT THE WORK IN ACCORDANCE WITH THE CONTRACT DOCUMENTS.

NO PART OF THIS DOCUMENT MAY BE REPRODUCED, STORED IN A RETRIEVAL SYSTEM, OR TRANSMITTED IN ANY FORM OR BY ANY MEANS, ELECTRONIC, MECHANICAL, PHOTOCOPIING, RECORDING OR OTHERWISE WITHOUT THE PRIOR WRITTEN PERMISSION OF BEALS AND THOMAS, INC. EXCEPT THAT ANY REGULATORY AUTHORITY MAY REPRODUCE AND TRANSMIT COPIES AS REQUIRED IN CONJUNCTION WITH PERFORMANCE OF OFFICIAL BUSINESS UNDER ITS JURISDICTION. ANY MODIFICATIONS TO THIS DOCUMENT WITHOUT THE WRITTEN PERMISSION OF BEALS AND THOMAS, INC. SHALL RENDER IT INVALID AND UNUSABLE.