



IMPROVEMENTS TO CRYSTAL LAKE PARK

**COMMUNITY MEETING #1
SEPTEMBER 15, 2022**



Weston & SampsonSM
design studio

AGENDA

INTRODUCTIONS

PHASED APPROACH TO IMPLEMENTATION

PROJECT GOALS

PROJECT TARGET DATES

EXISTING CONDITIONS PLAN

DESIGN CONSIDERATIONS

PRECEDENTS

CONCEPTUAL PLAN ALTERNATIVES

DISCUSSION AND NEXT STEPS

INTRODUCTIONS

PARKS, RECREATION & CULTURE

Nicole Banks Commissioner, Parks, Recreation and Culture

Luis Perez Demorizi Director of Parks and Open Space

Carol Stapleton Program Director

Greg Mellett Assistant Director of Parks and Open Space

Derek Mannion Superintendent of Public Grounds and Maintenance

Robert McClary Assistant Superintendent of Public Grounds and Maintenance

LAW DEPARTMENT

Jini Fairley City of Newton
ADA/504 Coordinator

MAYOR'S OFFICE

Jonathan Yeo Chief Operating Officer

Jennifer Steel Conservation Agent,
Wetland Coordinator,
Chief Environmental
Engineer

WESTON & SAMPSON

Cheri Ruane Discipline Leader

Cassie Bethoney Project Manager and
Landscape Architect

Gracie Villa Landscape Designer

PHASED APPROACH TO IMPLEMENTATION

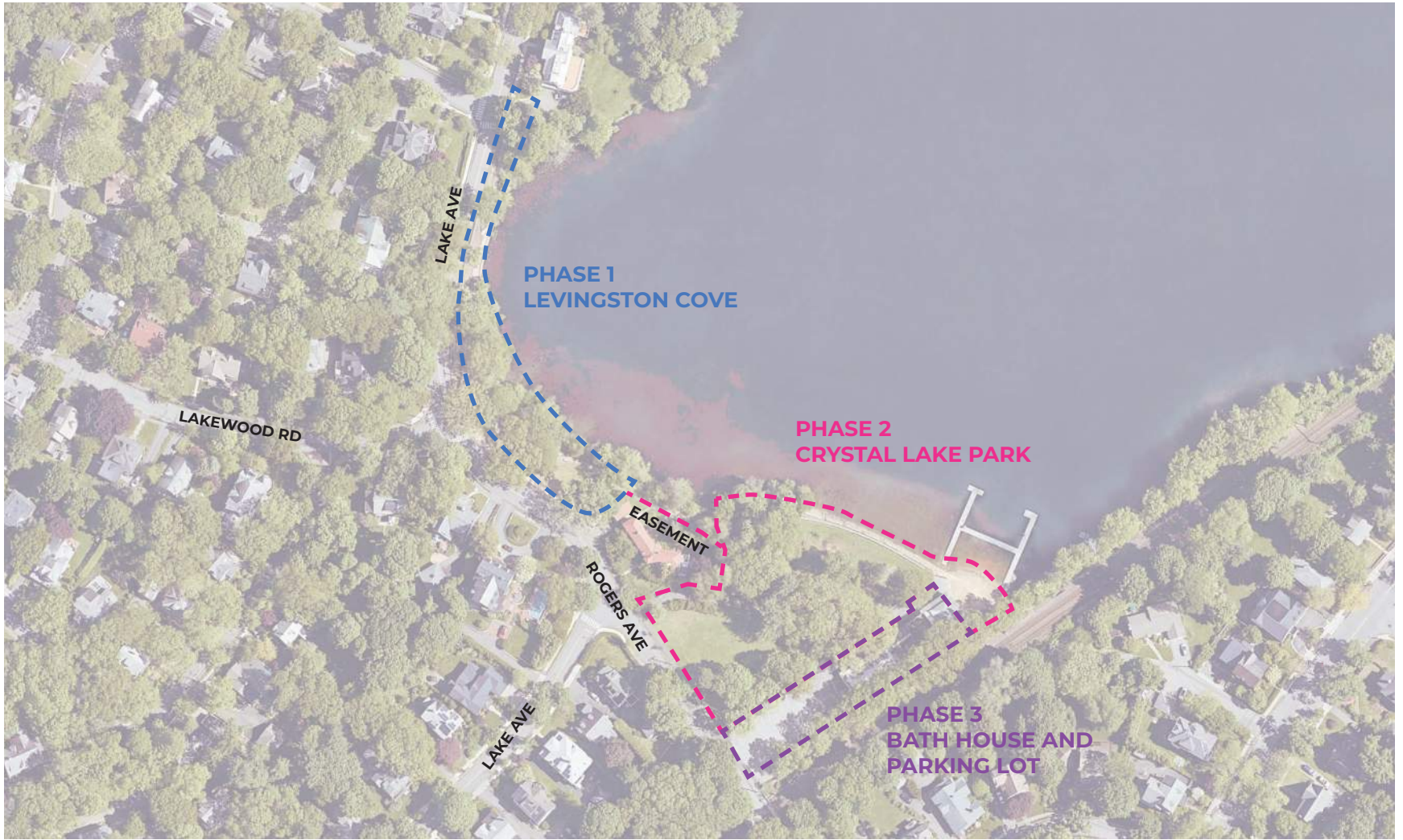

PROJECT GOALS

- **IMPROVE COMMUNITY USE:** Improve community access to the lake along Left Beach and provide an opportunity for boating or gathering with a platform / boardwalk. Make the beach and park more user friendly overall.
- **EXPAND ACCESSIBILITY:** Provide universally-accessible pathway connections, seating options, and water access within the park and between Levingston Cove, Crystal Lake Park, and the surrounding neighborhood.
- **INVEST IN THE LANDSCAPE:** Plant new trees, restore lawns, protect and prune existing trees for health and reinvigoration, and protect the shoreline.
- **CLIMATE RESILIENCY:** Provide on-site stormwater management strategies (akin to strategies proposed at Levingston Cove) and accommodate changing water levels over time.
- **BATH HOUSE / PARKING:** Ensure that the plan for improvements is compatible with the current and future bathhouse and parking lot configurations.
- **IMPLEMENTATION:** Provide a staged approach to implementation.

PROJECT TARGET DATES

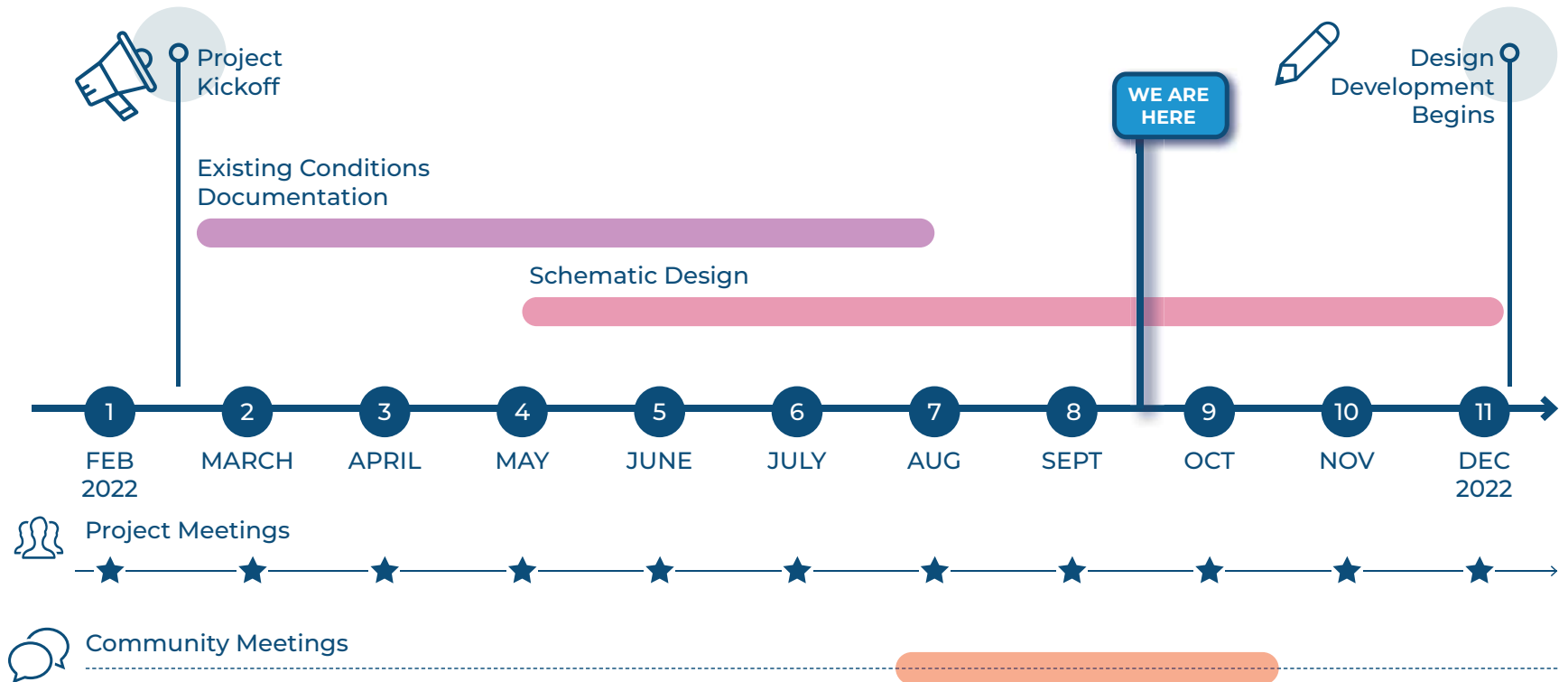

Future Project Hearings (dates TBD):

- Parks & Rec Commission Hearing
- Conservation Commission Hearing







EXISTING CONDITIONS PLAN



DESIGN CONSIDERATIONS



LEFT BEACH BOARDWALK



CONNECTION TO LEVINGSTON COVE VIA THE EASEMENT



PARK CIRCULATION



DOCK FOR BOAT LAUNCHING



FENCING



EROSION CONTROL

PRECEDENTS - BOARDWALK DESIGN

HERTER PARK AT THE CHARLES RIVER, BOSTON (DCR PROPERTY)



FIEDLER DOCK ON THE ESPLANADE, CHARLES RIVER, BOSTON (DCR PROPERTY)

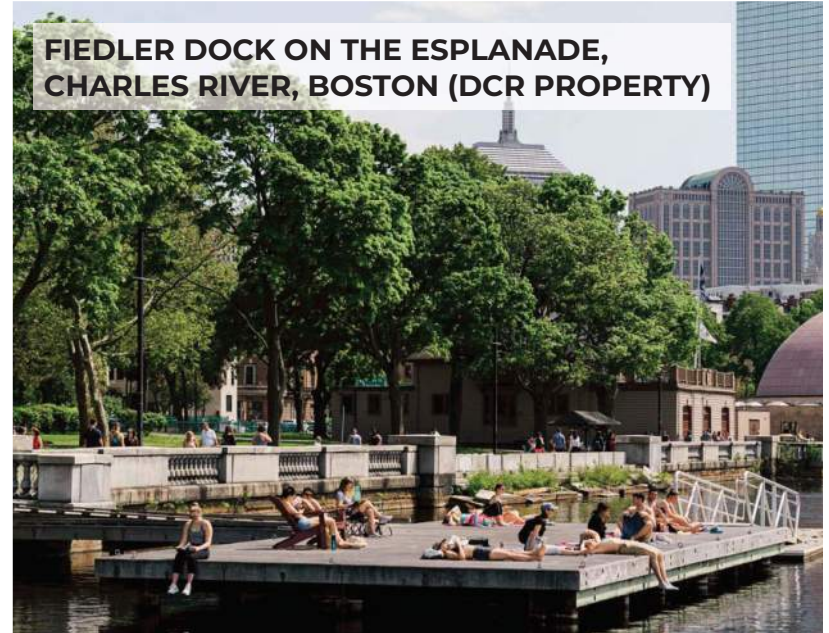

KALVEBOD WAVES, COPENHAGEN, DENMARK



DECK SIZE (SF)
Upper - 1892 sf
Stairs - 100 sf
Lower - 2663 sf



ACCESSIBLE PATHWAY CONNECTION

230 LAKE AVE

PROPOSED EVERGREEN SCREEN TREE

LAWN RESTORATION

PICNIC AREA

EXISTING PARKING AREA

HIGH

STAIRS

LOW

EXISTING BATHHOUSE FOOTPRINT

BENCH SEATING WITH VIEWS

STORMWATER INFILTRATION PLANTING AREAS

ACCESSIBLE PICNIC TABLES (2)

LIFEGUARD CHAIR LOCATION

DECK ACCESS FROM BEACH

WALL UPGRADES TO CAPTURE GRADE & EXTEND LAWN AREA

ACCESSIBLE SERVICE ACCESS - 15' WIDE
AQUILATOR LOCATION

RESTORED BEACH AREA

ACCESSIBLE RAMP REMOVED, BEACH EXPANDED
PLANTING BUFFER

HERTER PARK PRECEDENT

CONCEPT A



CONCEPT A Fencing and Gates

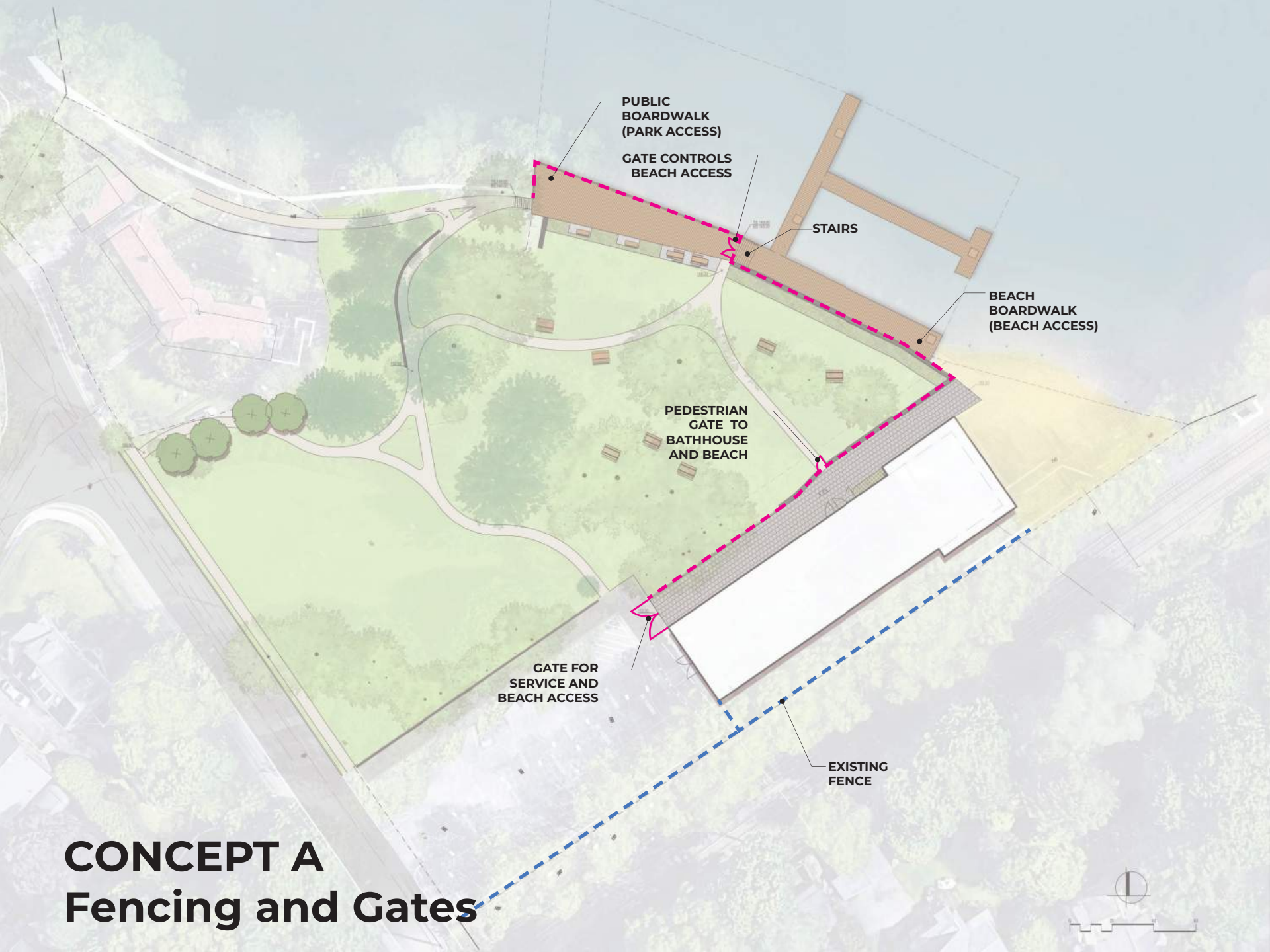

DECK SIZE (SF)
 Upper / ramp - 1872 sf
 Stairs - 110 sf
 Lower - 2408 sf

CONCEPT B



230 LAKE AVE

ACCESSIBLE PATHWAY CONNECTION

PROPOSED EVERGREEN BUFFER PLANTING

LAWN RESTORATION

PICNIC AREA

2 ACCESSIBLE PICNIC TABLES
 LOWER DECK ACCESS
 STAIRS

PUBLIC WATER ACCESS

RAMP

LOW

LIFEGUARD CHAIR LOCATION

ACCESSIBLE PATHWAY DOWN TO BEACH

EXISTING SERVICE ROAD

AQUILATOR LOCATION

RESTORED BEACH AREA

ACCESSIBLE RAMP REMOVED, BEACH EXPANDED

EXISTING BATHHOUSE FOOTPRINT

ROGERS STREET

EXISTING PARKING AREA

MBTA TRACK - GREEN LINE



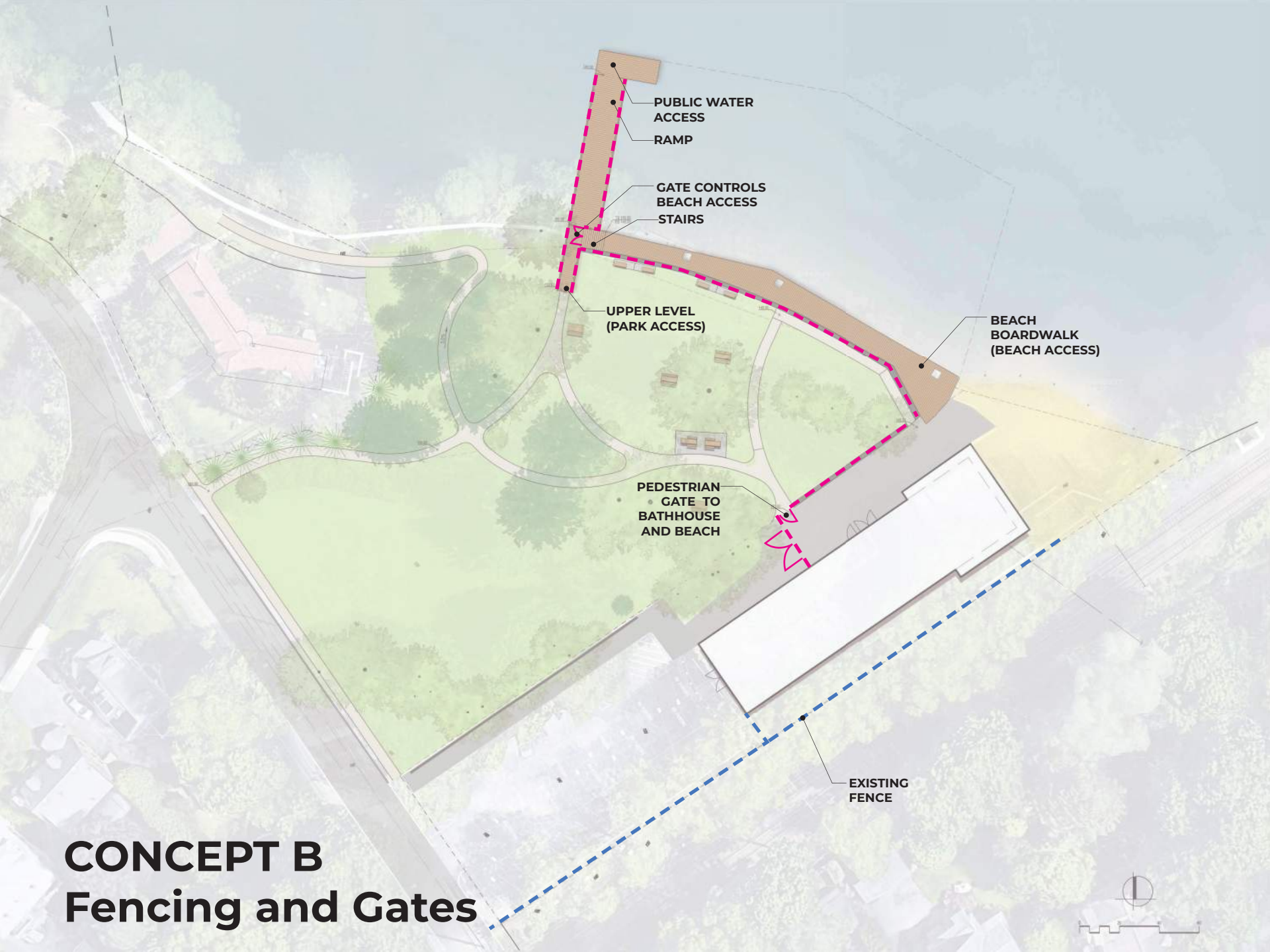

PUBLIC WATER
ACCESS
RAMP

GATE CONTROLS
BEACH ACCESS
STAIRS

UPPER LEVEL
(PARK ACCESS)

BEACH
BOARDWALK
(BEACH ACCESS)

PEDESTRIAN
GATE TO
BATHHOUSE
AND BEACH

EXISTING
FENCE

CONCEPT B

Fencing and Gates



DECK SIZE (SF)
Upper - 2650 sf
Lower/ramp - 2380 sf

BENCH SEATING WITH VIEWS
ACCESSIBLE PATHWAY

DECK ACCESS

LIFEGUARD CHAIR LOCATION

ADA RAMP ACCESS TO LOWER DECK

DECK ACCESS

230 LAKE AVE

HIGH

LOW

PICNIC AREA

RETAINING WALL

AQUILATOR LOCATION

RESTORED BEACH AREA

ACCESSIBLE RAMP REMOVED, BEACH EXPANDED

PLANTING BUFFER

PROPOSED EVERGREEN BUFFER PLANTING

ACCESSIBLE SERVICE ROAD

PLAZA SPACE WITH SEAT WALLS

LAWN RESTORATION

EXISTING BATHHOUSE FOOTPRINT

EXISTING PARKING AREA

MBTA TRACK - GREEN LINE

ROGERS STREET

KALVEBOD WAVES PRECEDENT



CONCEPT C



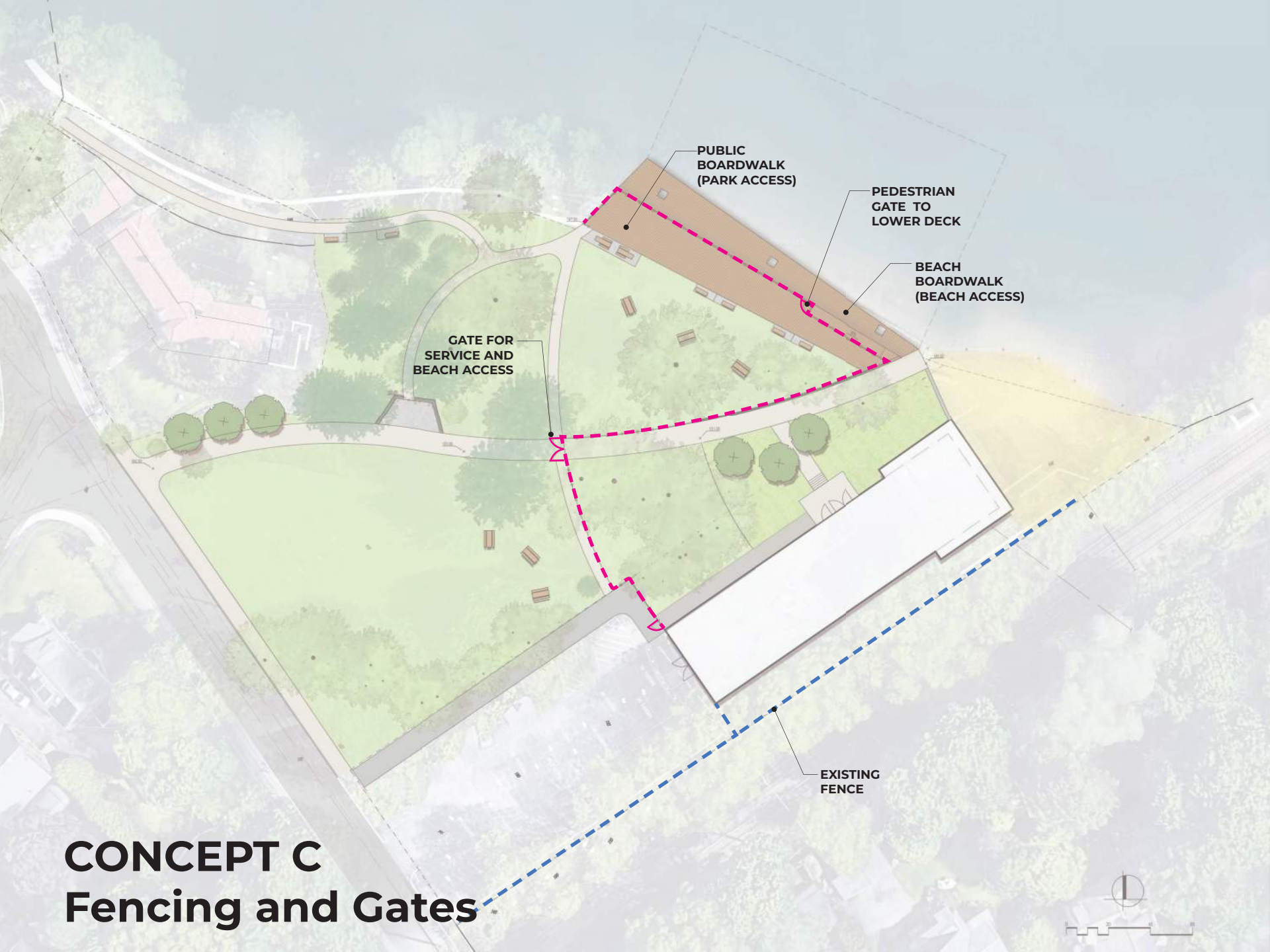

PUBLIC BOARDWALK (PARK ACCESS)

PEDESTRIAN GATE TO LOWER DECK

BEACH BOARDWALK (BEACH ACCESS)

GATE FOR SERVICE AND BEACH ACCESS

EXISTING FENCE

CONCEPT C Fencing and Gates



CONCEPT PLAN COMPARISON

DESIGN CONSIDERATIONS	CONCEPT A	CONCEPT B	CONCEPT C
LEFT BEACH BOARDWALK	High to low boardwalk with permanent T Dock	Water level boardwalk with extension out into the lake	Stacked high to low boardwalk
ADA ACCESS TO THE LAKE	Service road doubles as ADA access	New ADA pathway and ramp added to the park	New ADA ramp added within the boardwalk and Service road doubles as ADA access
FENCING	Fencing is kept to the perimeter of the park space to maximize the open area.	Fencing is kept to the perimeter of the park space to maximize the open area.	Fencing is kept to the perimeter of the park space to maximize the open area.
CONNECTION TO LEVINGSTON COVE VIA THE EASEMENT	New ADA pathway added to the park	New ADA pathway added to the park	New ADA pathway added to the park
BOAT ACCESS	Opportunity to launch off the T Dock or from the beach	Opportunity to launch off the boardwalk extension or from the beach	Opportunity to launch off the water level boardwalk or from the beach
EROSION CONTROL	On-site stormwater management strategies include grading adjustments and new plantings	On-site stormwater management strategies include grading adjustments and new plantings	On-site stormwater management strategies include grading adjustments and new plantings



THANK YOU!
LET'S DISCUSS.



Weston & SampsonSM
design studio