

Crafts Street Elderly Housing with Services

Land Use Presentation

October 25, 2022

Drop-off & Pick-Up

Revised Proposal - with Drop-off & Pick-up Area

September 19, 2022

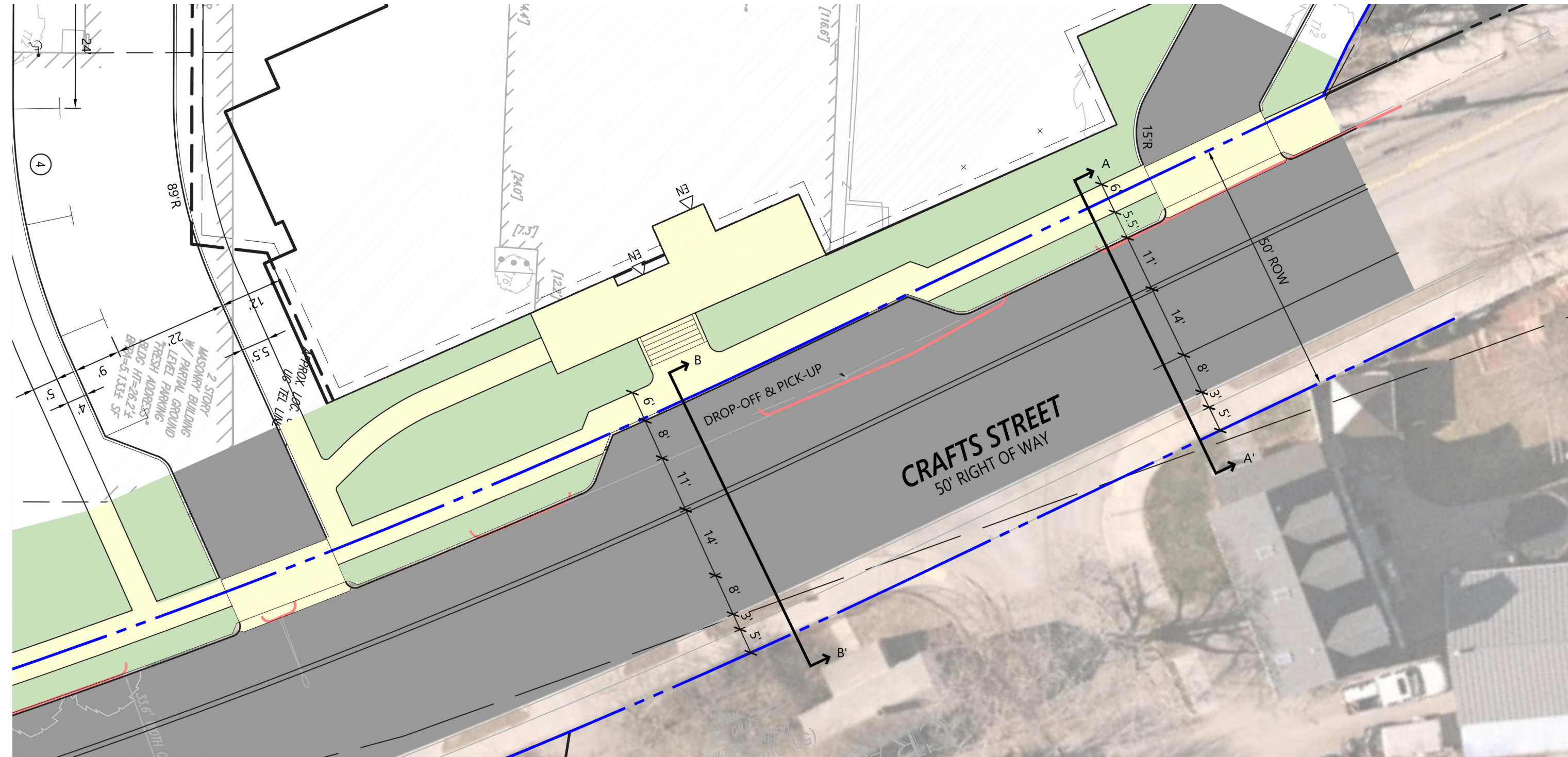

Revised Proposal - without Drop-off & Pick-up Area

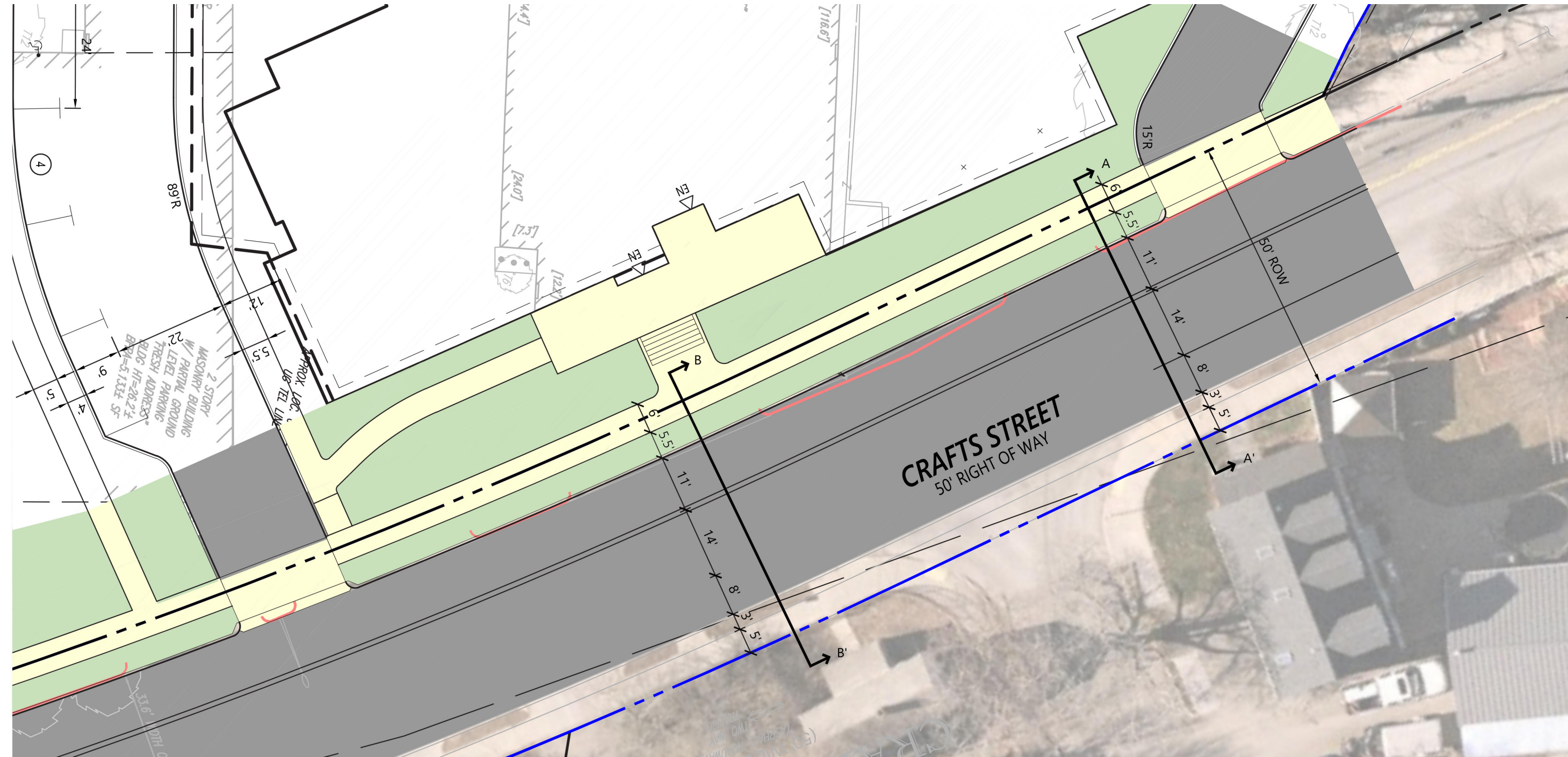

Beech Tree

Location of Beech Tree



Beech Tree located on Benenson's land.

Owner: Benenson



Image of assessed beech tree taken on September 27, 2022.

October 3, 2022

Mark Development
Suite 2-150
Newton, MA 02466



Suitability for Tree Preservation at 21 Court St, Newton, MA

You contacted arborist representative John Murphy about a beech tree located in front of 21 Court St, Newton, MA. Your concerns were of the suitability of preserving the tree when planning work at the house. Mr. Murphy visited the site, took measurements, and took pictures of the tree on September 27, 2022. This letter outlines our observations and recommendations concerning this tree from that inspection.

The tree is a European beech which is 45 inches in diameter. The tree is growing against the driveway of 21 Court St and the sidewalk along Court St. The canopy of the beech tree is very thin with most of the foliage having already dropped early in the season. The remaining foliage is undersized for this species of tree. **Approximately half the canopy is dead**, with the largest dead portion of stem being 18" +/- . It is uncertain if the remaining canopy will leaf out next season.

Due to the restricted root zone of the tree, soil therapies to slow decline will not be effective. Additionally, Beech Leaf Disease, a new invasive pest to beech trees, is in the area and expected to affect this tree in the near future. Beech leaf disease is shown to quickly cause mortality in trees in poor condition such as this tree.

I conclude that this tree is of very low suitability for preservation and should be removed as soon as possible to eliminate the potential for branch failures.

If you have any questions about my observations or recommendations, please contact me.

Timothy Armstrong
ISA Board Certified Master Arborist NE-7132B
ISA Tree Risk Assessment Qualified
tim.armstrong@bartlett.com

Mitigation

