

| Symbol | Label      | Quantity | Manufacturer             | Light Loss Factor | Lumens Per Lamp | Wattage |
|--------|------------|----------|--------------------------|-------------------|-----------------|---------|
| □      | BFLS - T3M | 2        | First Light Technologies | 0.9               | 4650            | 0       |
| □      | BFLS - T4  | 2        | First Light Technologies | 0.9               | 4675            | 0       |
| □      | BFLS - T5  | 1        | First Light Technologies | 0.9               | 4925            | 0       |
| □      | F8         | 6        | Lithonia Lighting        | 0.9               | 2222            | 34.75   |
| □      | F9         | 9        | Lithonia Lighting        | 0.9               | 6689            | 50      |

### Statistics

| Description   | Symbol | Avg    | Max     | Min    | Max/Min | Avg/Min |
|---------------|--------|--------|---------|--------|---------|---------|
| Calc Zone #2  | +      | 4.3 fc | 65.6 fc | 0.1 fc | 656.0:1 | 43.0:1  |
| Stat Zone # 1 | ✕      | 2.3 fc | 31.1 fc | 0.6 fc | 51.8:1  | 3.8:1   |

**Note**

1. Mounting Height (SCL2) = 20 ft
2. Calculation zone = Ground
3. Grid Spacing = 4ft
4. Pole Spacing = As Shown
5. Profile = TM2100B0600
6. LED Color Temp = 4000K

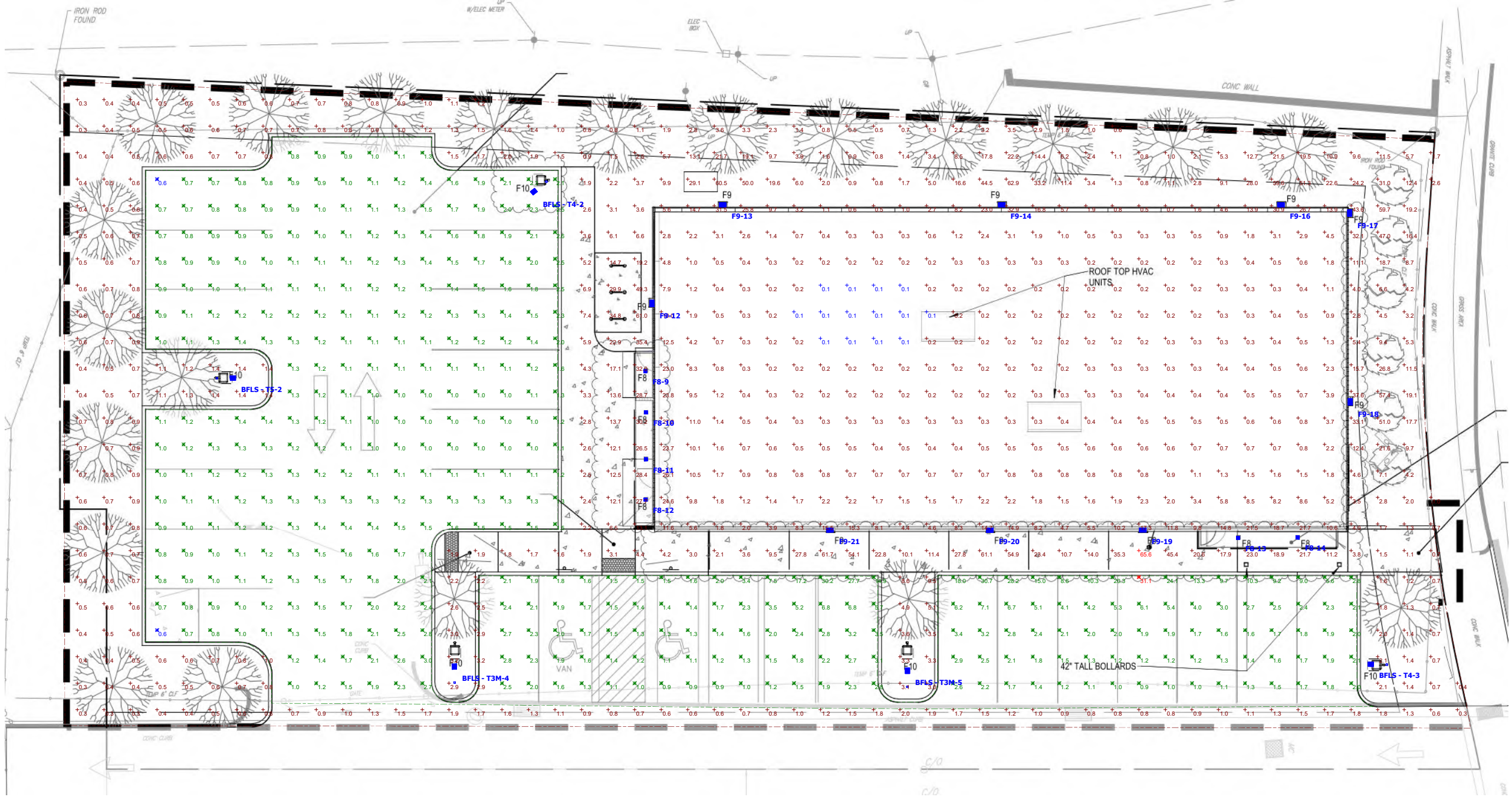

Pharmacann  
 BFL Series Lights  
 First Light Technologies Ltd.

**Designer**  
 I Gillies  
**Date**  
 2021-11-07  
**Scale**  
 Not to Scale  
**Drawing No.**  
  
**Approved by**  
 (TBD)